

get started

INSTANT™
RICE AND GRAIN COOKER

Instant™

Welcome

to your new Instant™ Rice and Grain Cooker!

This Instant Rice and Grain Cooker can help you cook delicious meals more easily and in less time. We hope you fall in love with Instant cooking, and enjoy it in your kitchen for years to come!

Get started with your new Rice and Grain Cooker!



CONTENTS

Important safeguards	2
What's in the Box	5
Using your Rice and Grain Cooker	7
Initial setup	9
Using the lid	10
White or Brown Rice	11
CarbReduce™	13
Mixed Grains	15
Quinoa	16
Steam	17
Slow Cook	19
Sauté	21
Keep warm	23
Grain cooking table	24
Troubleshooting	25
Cleaning	26
Learn more	27
Warranty	28
CarbReduce™ study	30

IMPORTANT SAFEGUARDS

⚠ WARNING

READ ALL INSTRUCTIONS

Placement

- **DO** place the appliance on a countertop only. Always operate the appliance on a stable, non-combustible, level surface.
- **DO** make sure all parts are dry and free of food debris before placing the cooking pot on the cooker base.
- **DO NOT** place the appliance on or close to a hot gas or electric burner, or a heated oven.
- **DO NOT** use the appliance near water or flame.
- **DO NOT** use outdoors. Keep out of direct sunlight.
- **DO NOT** place on anything that may block the vents on the sides of the appliance.

General Use

The removable cooking pot is extremely hot during use, and can be extremely heavy when full of ingredients.

- **DO** use oven mitts when handling the cooking pot and CarbReduce basket, and when removing accessories.
- **DO** place hot accessories on a heat-resistant surface or cooking plate.
- **DO** use care when lifting the cooking pot or CarbReduce basket from the cooker base to avoid burn injury.
- **DO** use extreme caution when the cooking pot and CarbReduce™ basket contain hot food, hot oil or other hot liquids.
- **DO NOT** use the appliance without the removable cooking pot installed.
- **DO NOT** touch the metal portion of the lid, the appliance's hot surfaces, or any accessories during or immediately after cooking because they will be hot. Only use the side handles for carrying or moving.
- **DO NOT** use this appliance for deep frying with oil.
- **DO NOT** move the appliance while it is in use and use extreme caution when disposing of hot grease.

⚠ WARNING

- **DO NOT** allow children or persons with reduced physical, sensory or mental capabilities to operate this appliance. Close supervision is necessary when any appliance is used by or near children and persons with reduced physical, sensory or mental capabilities. Children should not play with this appliance.
- **DO NOT** use the appliance for anything other than household use. It is not intended for commercial use.
- **DO NOT** leave the appliance unattended while in use.
- The heating element surface is subject to residual heat after use.
- Avoid spillage on the connector.

Accessories

- **DO** use only accessories or attachments authorised by Instant Brands LLC. The use of parts, accessories or attachments not recommended by the manufacturer may cause a risk of personal injury, property damage, fire or electric shock.
- **DO** only replace the inner lid cover with an authorised Instant inner lid cover to prevent personal injury, property damage, and/or damage to the appliance.
- **DO NOT** use the included accessories in a microwave, toaster oven, convection or conventional oven, or on a ceramic cooktop, electric coil, gas range or outdoor grill.

Care and Storage

- **DO** let the appliance cool to room temperature before cleaning or storage.
- **DO NOT** store any materials in the cooker base when not in use.
- **DO NOT** place any combustible materials in the cooker base, such as paper, cardboard, plastic, Styrofoam or wood.

Power Cord

A short power-supply cord is used to reduce the risk resulting from it being grabbed by children, becoming entangled in, or tripping over a longer cord.

WARNING: Spilled food can cause serious burns. Keep appliance and cord away from children.

Never drape cord over edge of counter, never use outlet below counter, and never use with an extension cord.

- **DO NOT** let the power cord touch hot surfaces or open flame, including the stovetop.
- **DO NOT** use with power converters or adapters, timer switches or separate remote-control systems.

⚠ WARNING

If the unit includes a detachable power cord:

- To connect, always attach the power cord to the appliance first, then plug the power cord into the wall outlet.

Electrical Warning

The cooker base contains electrical components that are an electrical shock hazard. Failure to follow these instructions may result in electric shock.

To protect against electrical shock:

- To disconnect, select **Cancel**, then remove plug from power source. Always unplug when not in use, as well as before adding or removing parts or accessories, and before cleaning. To unplug, grasp the plug and pull from the outlet. Never pull from the power cord.
- **DO** regularly inspect the appliance and power cord. **DO NOT** operate the appliance if the power cord or plug is damaged, or after the appliance malfunctions or is dropped or damaged in any manner. For assistance, contact Customer Care by email at **support@instantpot.com.au**.
- **DO NOT** attempt to repair, replace or modify components of the appliance, as this may cause electric shock, fire property damage, or personal injury, and will void the warranty.
- **DO NOT** tamper with any of the safety mechanisms, as this may result in personal injury or property damage.
- **DO NOT** put liquid or food of any kind into cooker base without the cooking pot.
- **DO NOT** immerse power cord, plug or the appliance in water or other liquid.
- **DO NOT** use the appliance in electrical systems other than 220-240V~ 50-60Hz.
- **DO NOT** clean the appliance by rinsing it under a tap.

SAVE THESE INSTRUCTIONS

WHAT'S IN THE BOX

Lid

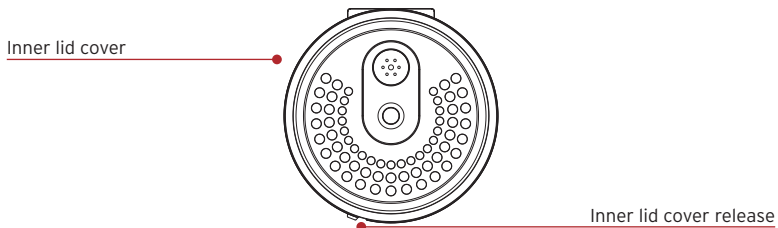
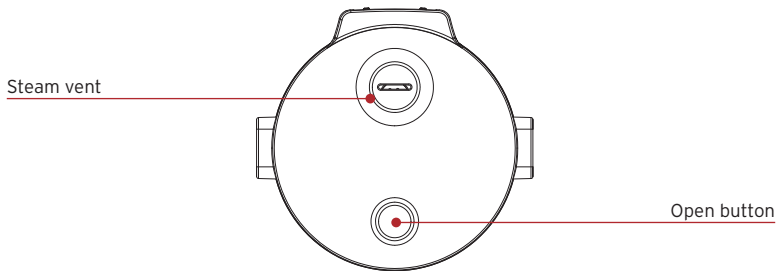

Cooker Base

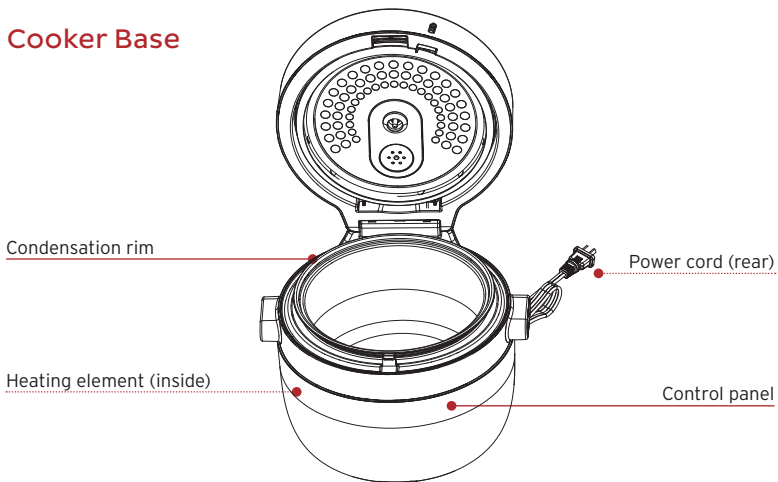

Parts and Accessories

Inner lid cover

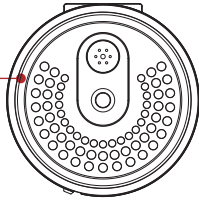

Coated aluminum cooking pot

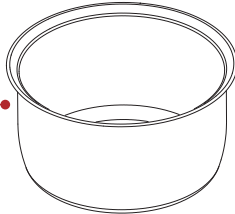

CarbReduce™ stainless steel steam basket

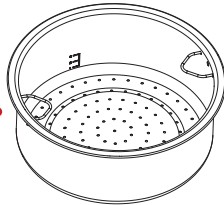

Measuring cup



Rice spoon



Illustrations are for reference only and may differ from the actual product.

Remember to recycle!

We designed this packaging with sustainability in mind. Please recycle everything that can be recycled where you live.

USING YOUR RICE AND GRAIN COOKER

Control panel

We've designed the control panel to be simple to use and easy to read.

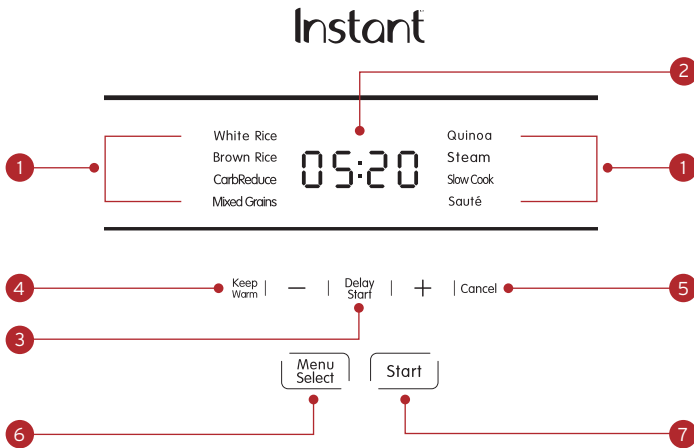

1. Smart Programme Settings
2. Time
 - Cooking time
 - Delay Start time
 - Keep Warm time
3. Delay Start
 - Shows Delay Start is active
4. Keep Warm
 - Shows Keep Warm is active
5. Cancel
6. Menu Select
7. Start

Delay the start of cooking

You can set a Delay Start timer for a minimum of 10 minutes or a maximum of 24 hours.

1. Select a Smart Programme, then press **Delay Start**.
2. When the timer flashes, press **+** or **-** to set the minutes (in 10 minute increments) and press **Start** to select.
3. Delay Start begins automatically and the timer counts down.
4. When Delay Start ends, the Smart Programme begins.

Cancel cooking

Press **Cancel** to stop cooking at any time.

INITIAL SETUP

Unpack

1. Remove your new Rice and Grain Cooker from the box.
2. Remove all the packaging material from in and around the cooker.
3. Make sure to remove all the accessories from inside the cooker.
4. **Do Not** remove the safety warning stickers or the rating label from the cooker.

Clean before use

1. Wipe the interior with a damp cloth. Use a clean, soft cloth to dry.
2. Wash the accessories with hot water and dish soap or wash on the top rack of the dishwasher. Rinse with warm, clear water and use a soft cloth to dry.

Placement

1. Place your Rice and Grain Cooker on a stable, level surface, away from combustible material and external heat sources. **Do Not** place the unit on top of another appliance.
2. Make sure to leave at least 13 cm of space above and around all sides of the appliance to allow for sufficient air flow.

Turn on

1. Plug the unit into an electric outlet. The control panel will light up.

USING THE LID

How to close the lid

Push the lid down lightly until you feel it snap into place. If you push too hard or too fast the lid will bounce back open.

How to open the lid

When cooking is finished, push the button on top of the lid to open.

Do Not open the lid during cooking as hot steam can burn.

About the inner lid cover

The inner lid cover is removable for easy cleaning. When cooking, the cover must be in place on the lid.

- To remove the cover, press the release button and the cover will pop off.
- To replace the cover, place the flat edge of the cover into the slot and press the cover onto the inner lid until it clicks into place

About the condensation channel

During cooking, steam will condense, and the condensation will collect in the channel of the base. After cooking, open the lid slowly to avoid spillage. When you open the lid, condensation will flow into the collection space. You can let it evaporate or clean it up with a paper towel.

⚠ WARNING

HOT SURFACES To prevent electric shock or personal injury, unplug before cleaning.

DO NOT immerse power cord, plug or the appliance in water or other liquid, which may result in electric shock or personal injury.

WHITE OR BROWN RICE

The White Rice and Brown Rice programmes cook rice quickly and evenly, and automatically adjust cooking times for the amount of rice in the cooking pot.

Choose from these Smart Programmes:

Programme	Cook Time	Min Dry Rice	Max Dry Rice	Rice to Water Ratio
White Rice	5 minutes (00:05)	1 cup*	10 cups*	1 cup rice to 1 cup water
Brown Rice	10 minutes (00:10)	1 cup*	6 cups*	1 cup rice to 1.5 cups water

** Please measure in the rice cup included with the cooker and not a standard measuring cup*

Other settings

- Automatic Keep Warm is set to ON by default for both Rice programmes.
- Delay Start is available for both Rice programmes.

How to cook rice

1. Add dry rice and water to the cooking pot and place the cooking pot into the cooker base.
2. Close the lid on top of the cooker base.
3. Press **Menu Select** on the control panel; press again until **White Rice** or **Brown Rice** is highlighted.
4. You can delay cooking if you want. Press **Delay Start**, then press **+** or **-** to select the delay time.
5. Keep Warm setting is ON by default.
6. Press **Start**.

The cooking timer for white rice will start counting down during the last 5 minutes of the cooking cycle, the cooking timer for brown rice will start counting down during the last 10 minutes of the cooking cycle.

You can press **Cancel** to stop cooking at any time.

Stop cooking

1. When cooking time reaches 00:00, cooking stops.
2. Keep Warm comes on and the display reads **END**.
3. Press **Cancel** to end Keep Warm when you're ready to serve.

CarbReduce™

The CarbReduce programme cooks rice and uses special technology to reduce the amount of carbohydrates and sugar.

Programme	Cook Time	Min Dry Rice	Max Dry Rice	Grains to Water Ratio
CarbReduce	40 minutes (00:40)	1 cup*	4 cups*	Use the measure marks in the basket for the amount of grains you want to cook

* Please measure in the rice cup included with the cooker and not a standard measuring cup

Other settings

- Automatic Keep Warm is set to ON by default for CarbReduce programme.
- Delay Start is available for CarbReduce programme.

How to cook using CarbReduce

1. Add dry rice to the CarbReduce steam basket and place the basket into the cooking pot.
2. Fill the basket with water according to the measure marks for the amount of rice you want to cook.
3. Close the lid on top of the cooker base.
4. Press **Menu Select** on the control panel; press again until **CarbReduce** is highlighted.
5. You can delay cooking if you want. Press **Delay Start**, then press + or - to select the delay time.
6. Keep Warm setting is ON by default.
7. Press **Start**. The cooking time starts counting down.

You can press **Cancel** to stop cooking at any time.

Stop cooking

1. When cooking time reaches 00:00, cooking stops.
2. Keep Warm comes on and the display reads **END**.
3. Press **Cancel** to end Keep Warm when you're ready to serve.

CarbReduce results based on 2 cups (uncooked) of long grain white rice, long grain brown rice, short grain white rice, arborio rice, and basmati white rice varieties, using recommended cooking process and water ratio.

Results may vary depending on batch quantity and rice variety used.

CarbReduce not recommended for long grain white rice variety batches greater than 2 cups due to diminished carbohydrate reduction.

MIXED GRAINS

The Mixed Grains programme cooks a variety of grains quickly and evenly.

Programme	Cook Time	Min Dry Grains	Max Dry Grains	Grains to Water Ratio
Mixed Grains	10 minutes (00:10)	1 cup*	6 cups*	1 cup grains to 1.2 cups water

* Please measure in the rice cup included with the cooker and not a standard measuring cup

Other settings

- Automatic Keep Warm is set to ON by default.
- Delay Start is available.

How to cook mixed grains

1. Add dry grains and water to the cooking pot and place the cooking pot into the cooker base.
2. Close the lid on top of the cooker base.
3. Press **Menu Select** on the control panel; press again until **Mixed Grains** is highlighted.
4. You can delay cooking if you want. Press **Delay Start**, then press **+** or **-** to select the delay time.
5. Keep Warm setting is ON by default.
6. Press **Start**.

The cooking timer will start counting down during the last 10 minutes of the cooking cycle.

You can press Cancel to stop cooking at any time.

Stop cooking

1. When cooking time reaches 00:00, cooking stops.
2. Keep Warm comes on and the display reads **END**.
3. Press **Cancel** to end Keep Warm when you're ready to serve.

QUINOA

The Quinoa programme cooks quinoa quickly and evenly.

Programme	Cook Time	Min Dry Quinoa	Max Dry Quinoa	Quinoa to Water Ratio
Quinoa	5 minutes (00:05)	1 cup*	6 cups*	1 cup quinoa to 1.5 cups water

* Please measure in the rice cup included with the cooker and not a standard measuring cup

Other settings

- Automatic Keep Warm is set to ON by default.
- Delay Start is available.

How to cook quinoa

1. Add dry quinoa and water to the cooking pot and place the cooking pot into the cooker base.
2. Close the lid on top of the cooker base.
3. Press **Menu Select** on the control panel; press again until **Quinoa** is highlighted.
4. You can delay cooking if you want. Press **Delay Start**, then press **+** or **-** to select the delay time.
5. Keep Warm setting is ON by default.
6. Press **Start**.

The cooking timer will start counting down during the last 5 minutes of the cooking cycle.

You can press Cancel to stop cooking at any time.

Stop cooking

1. When cooking time reaches 00:00, cooking stops.
2. Keep Warm comes on and the display reads **END**.
3. Press **Cancel** to end Keep Warm when you're ready to serve.

STEAM

The Steam programme cooks food using steam; it's especially useful for vegetables like broccoli, zucchini, carrots, and others.

Programme	Default Cook Time	Min Cook Time	Max Cook Time
Steam	10 minutes (00:10)	5 minutes (00:05)	1 hour (01:00)

Other settings

- Automatic Keep Warm is set to ON by default for Steam programme.
- Delay Start is available for Steam programme.

How to steam

Prep

Cut, chop or season your ingredients according to your recipe.

Cook

1. Add water (minimum 1/2 cup, maximum to just below the CarbReduce steam basket) to the cooking pot and place it into the cooker base.
2. Add food to the CarbReduce steam basket and place the steam basket into the cooking pot, then place that into the cooker base.
3. Close the lid on top of the cooker base.
4. Press **Menu Select** on the control panel; press again until **Steam** is highlighted. Then press **Start** to select it.
5. The default cooking time flashes. To select it, press **Start**. Or press **+** or **-** to change it, then press **Start** to select it. The cooking time starts counting down.
6. You can delay cooking if you want. Press **Delay Start**, then press **+** or **-** to select the delay time.
7. Keep Warm setting is ON by default.

*You can press **Cancel** to stop cooking at any time.*

Stop cooking

1. When cooking time reaches 00:00, cooking stops.
2. Keep Warm comes on and the display reads **END**.
3. Press **Cancel** to end Keep Warm when you're ready to serve.

SLOW COOK

Slow cooking lets you make your favourite simmering and stewing recipes - just like grandma used to make.

Programme	Default Cook Time	Min Cook Time	Max Cook Time
Slow Cook	6 hours (06:00)	30 minutes (00:30)	24 hours (24:00)

Other settings

- Automatic Keep Warm is set to ON by default for Slow Cook programme.
- Delay Start is available for Slow Cook programme.

How to slow cook

Prep

Cut, chop, season or marinate your ingredients according to your recipe.

Cook

1. Add ingredients to the cooking pot and place the cooking pot into the cooker base.
2. Close the lid on top of the cooker base.
3. Press **Menu Select** on the control panel; press again until **Slow Cook** is highlighted. Then press Start to select it.
4. If you want to delay cooking, press **Delay Start** before pressing Start, then press **+** or **-** to select the delay time.
5. The default cooking time flashes. To select it, press **Start**. Or press **+** or **-** to change it, then press **Start** to select it. The cooking time starts counting down.
6. Keep Warm setting is ON by default.

*You can press **Cancel** to stop cooking at any time.*

Stop cooking

1. When cooking time reaches 00:00, cooking stops.
2. Keep Warm comes on and the display reads **END**.
3. Press **Cancel** to end Keep Warm when you're ready to serve.

SAUTÉ

Use Sauté in place of a frying or saucepan. Sautéing can deepen the flavours of your food, or can simmer, thicken or reduce sauces.

Programme	Default Cook Time	Min Cook Time	Max Cook Time
Sauté	30 minutes (00:30)	1 minute (00:01)	30 minutes (00:30)

Other settings

- Automatic Keep Warm is OFF by default.
- Delay Start is not available.

How to sauté

Prep

Cut, chop, season or marinate your ingredients according to your recipe.

Cook

1. Place the cooking pot into the cooker base.
2. Add oil to the cooking pot and press **Start**.
3. Press **Menu Select** on the control panel; press again until **Sauté** is highlighted. Then press **Start** to select it.
4. The default cooking time flashes. To select it, press **Start**. Or press **+** or **-** to change it, then press **Start** to select it. The cooking time starts counting down.

*You can press **Cancel** to stop cooking at any time.*

Stop cooking

1. When cooking time reaches 00:00, cooking stops.

Keep warm

1. Keep Warm setting is OFF by default. To use it, press **Cancel** when the Sauté cooking programme is finished, then press **Keep Warm**. Use **+** and **-** to set the keep warm time.

Sautéing before Slow Cooking

Quite often, you'll want to sauté foods to brown them before further cooking them.

1. Sauté ingredients.
2. Press **Cancel**.

*You can deglaze the cooking pot now before switching to **Slow Cook** (see **Deglazing** below)*

3. When you're ready, start the process for Slow Cooking.

Deglazing

Deglazing is the process of adding a liquid to a hot pan, releasing all of the delicious, caramelised pieces stuck to the bottom.

1. Remove food from cooking pot.
2. Add water, broth, or wine.
3. Use wooden spoon or silicone spatula to loosen food stuck to bottom of the cooking pot.

KEEP WARM

You can choose to have Keep Warm turn on automatically after cooking on most Smart Programmes. You can also use Keep Warm to reheat foods.

To keep warm

1. When cooking is finished for most programs, Keep Warm begins.
2. To turn Keep Warm off, press **Cancel**.

To reheat

1. Place the cooking pot with the food you want to reheat into the cooker base.
2. Press **Keep Warm** once to set the cooking temperature to Low.
3. Or press **Keep Warm** twice to set the cooking temperature to High.
4. The default Keep Warm time flashes. To select it, press **Start**. Or press **+** or **-** to change it, then press **Start** to select it.
5. To turn Keep Warm off, press **Cancel**.

Programme	Default Time	Min Time	Max Time
Keep Warm	10 hours (10:00)	1 hour (01:00)	10 hours (10:00)

RICE AND GRAIN COOKING TABLE

10 Cup Rice and Grain Cooker

Grain Type	Cooking Programme	MINIMUM			MAXIMUM		
		Grain Amount	Water Amount	Cooking Time	Grain Amount	Water Amount	Cooking Time
White Rice (long grain)	White Rice	1 cup (min)	1 cup	32 min	10 cups (max)	10 cups	53 min
Brown Rice	Brown Rice	1 cup (min)	1 1/2 cups	52 min	6 cups (max)	9 cups	1 hr 6 min
Quinoa	Quinoa	1 cup (min)	1 1/2 cups	32 min	6 cups (max)	9 cups	50 min
Barley (pearl barley)	Brown Rice	1 cup (min)	2 cups	56 min	3 cups (max)	6 cups	1 hr 3 min
Bulgur (#3 light bulgur)	Mixed Grains	1 cup (min)	1 cup	42 min	6 cups (max)	6 cups	1 hr 2 min
Red Rice	Brown Rice	1 cup (min)	1 1/2 cups	54 min	6 cups (max)	9 cups	1 hr 10 min
Black Rice	Brown Rice	1 cup (min)	1 3/4 cups	56 min	6 cups (max)	10 1/2 cups	1 hr 8 min
Millet	Quinoa	1 cup (min)	2 cups	32 min	6 cups (max)	12 cups	49 min
Spelt	Mixed Grains	1 cup (min)	1 1/2 cups	59 min	6 cups (max)	9 cups	1 hr 17 min
Oats (rolled oats)	Steam <i>no steam basket</i>	1 cup (min)	2 cups	10-12 min	5 cups (max)	10 cups	20-25 min
Mixed grains	Mixed Grains	1 cup (min)	1 1/2 cups	46 min	6 cups (max)	9 cups	51 min
Lentil (green) Note: Drain extra water after cooking	Steam <i>no steam basket</i>	1 cup (min)	2 cups	15-18 min	4 cups (max)	8 cups	22-25 min

Note: Measurements use the included measuring cup, which is equivalent to 180 ml. Exceeding the maximum amount of grain may lead to overflow.

STEAMING TIMETABLE

You can cook more than just rice in your Instant Rice and Grain Cooker. Here are some suggested times for common foods.

Food	Prep	Amount (with 1 cup water)	Cook Time
Fresh			
Asparagus	Whole	226 g	10-12 min
Baby White Potatoes	Whole	226 g	20-22 min
Bok Choy	Halves	226 g	13-5 min
Broccoli	Florets	226 g	12-14 min
Cabbage	Quartered, wedges	454 g	25-30 min
Carrots	Individual baby size	226 g	15-17 min
Cauliflower	Florets	226 g	13-15 min
Green Beans	Whole	226 g	10-12 min
Salmon	Filet	2 pc (226 g)	18-20 min
Spinach	Leaves	113 g	5-6 min
Squash	Cubed	226 g	15-17 min
Sweet Potatoes, Potatoes	Diced, medium	226 g	13-15 min
White Button Mushrooms	Whole	226 g	12-14 min
White Fish (cod, haddock, bass)	Filet	2 pc (140 g each)	18-20 min
Zucchini	Sliced, 1.5cm rounds	226 g	8-10 min
Frozen			
Bao Buns		226 g	13-15 min
Dim Sum		226 g	15-17 min
Steamed Bun (meat or vegetable)		226 g	18-23 min

TROUBLESHOOTING

Problem	Cause	Solution
Difficulty closing lid	Push down too hard/ too fast	<ul style="list-style-type: none"> • Close lid slowly
	Inner lid plate is not installed properly	<ul style="list-style-type: none"> • Open lid and reinstall inner lid plate ensuring the lid plate is located in the positioning slot, is flat against the lid and snapped in place
	Open button is not completely depressed.	<ul style="list-style-type: none"> • Push firmly on the centre of the open button.
Steam leaks from side of lid	Inner lid plate is missing	<ul style="list-style-type: none"> • Install inner lid plate
	Inner lid plate gasket is damaged	<ul style="list-style-type: none"> • Replace inner lid plate.
	Lid not closed properly.	<ul style="list-style-type: none"> • Open, then close lid.
Display remains blank after connecting the power cord	Bad power connection or no power.	<ul style="list-style-type: none"> • Inspect power cord for damage. If damage is noticed, do not use the unit.
	Bad power connection or no power.	<ul style="list-style-type: none"> • Check home circuit breaker.
	No power to the unit	<ul style="list-style-type: none"> • Contact customer care.
Occasional clicking or light cracking sound	Bottom of the cooking pot is wet.	<ul style="list-style-type: none"> • Wipe exterior surfaces of cooking pot. Ensure heating element is dry before inserting cooking pot into cooker base.
E1, E2, E3 or E4 Error code appears on display and cooker beeps continuously	There is an issue with the cooker.	<ul style="list-style-type: none"> • Contact customer care.

CLEANING

Clean your Instant Rice and Grain Cooker after each use. Always unplug the unit and let all parts cool to room temperature before cleaning. Before use or storing, make sure all surfaces are dry.

⚠ WARNING

HOT SURFACES

To prevent electric shock or personal injury, unplug before cleaning.

DO NOT immerse power cord, plug or the appliance in water or other liquid, which may result in electric shock or personal injury.

Part	Cleaning instructions
Accessories <ul style="list-style-type: none">• Rice spoon• Measuring cup• Inner lid cover	<ul style="list-style-type: none">• Wash after each use• Hand wash with hot water and mild dish soap or wash in dishwasher, top rack• Never use harsh chemical detergents, powders or scouring pads on accessories
Cooking pot CarbReduce steam basket	<ul style="list-style-type: none">• Wash after each use.• Hand wash with hot water and mild dish soap or wash in dishwasher.• Hard water stains may need a vinegar-dampened sponge and scrubbing to remove• For tough or burned food residue, soak in hot water for a few hours before cleaning• Dry all exterior surfaces before placing in cooker base
Power cord	<ul style="list-style-type: none">• Use a barely-damp cloth to wipe any particles off cord
Cooker base with lid	<ul style="list-style-type: none">• Wipe the inside of the cooker base as well as the condensation rim with a barely-damp cloth, and allow to air dry• Clean the lid, outside of the cooker base and the control panel with a soft, barely-damp cloth or sponge

WARRANTY

Limited Warranty

This Limited Warranty is issued by Instant Brands (Australia) Pty Ltd (Instant Brands Australia) and is effective for one year from the date of original consumer purchase. Proof of original purchase date and return of your appliance is required to obtain service under this Limited. Return of your appliance to us will be done in accordance with our instructions only. Provided that this appliance is operated and maintained in accordance with written operating instructions attached to or furnished with the appliance or published operating instructions on www.instantpot.com.au, Instant Brands Australia will, in its sole and exclusive discretion, either: (i) repair defects in materials or workmanship; or (ii) replace the appliance. In the event that your appliance is replaced, the Limited Warranty on the replacement appliance will expire 12 months from the date of original consumer purchase.

We remind you the appliance you purchased is for personal use only (not commercial use).

Any modification/alteration or attempted modification/alteration to your appliance will void this Limited Warranty, unless such modification/alteration or attempted modification/alteration was expressly authorised by an Instant Brands Australia Representative in writing.

This Limited Warranty only covers Instant Brands Australia's appliances/products and is not extended to any other appliances, products, equipment, components, or devices that you use or may use in conjunction with the Instant Brands Australia's appliances.

To claim under this Limited Warranty:

1. Contact Instant Brands Australia at:
Sydney Corporate Park
Level 1, 182-184 Bourke Road, Alexandria, NSW 2015
Email: sales.australia@instantbrands.com
2. Provide a description of the appliance you believe has malfunctioned due to defective parts or workmanship.
3. If it is necessary for the appliance to be sent to Instant Brands Australia for repair or replacement, Instant Brands Australia will send you a pre-paid shipping label and you must send the appliance and your dated sales receipt to Instant Brands Australia along with the appliance. If you do not have your dated sales receipt, please advise Instant Brands Australia in advance, and Instant Brands Australia will attempt to verify your purchase.
4. If Instant Brands Australia determines that the appliance has malfunctioned due to defective parts or workmanship, and is covered under this Limited Warranty, Instant Brands Australia will repair and return the appliance, or send you a replacement appliance, at Instant Brands Australia's cost.
5. Any repaired or replaced appliance will be covered by this Limited Warranty for the remainder of the original warranty period or ninety (90) days following your receipt of the replacement or repaired appliance, whichever is greater.
6. If Instant Brands Australia confirms the appliance has not malfunctioned due to defective parts or workmanship, and/or is in working order, or if proof of purchase is not verified, Instant Brands Australia reserves the right to return the appliance to you at your pre-paid cost. If this cost is not met, Instant Brands Australia reserves the right to dispose of the appliance after 45 days' notice to you.

WARRANTY

Limitation and Exclusions

To the maximum extent permitted by law, the maximum liability of Instant Brands Australia, if any, for any, for any allegedly defective appliance or part shall in no circumstances exceed the purchase price of a comparable replacement appliance or part of the same age.

This Limited Warranty does not cover:

1. Damage resulting from accident, modification/alteration (unless expressly authorised by an Instant Brands Australia Representative in writing), misuse, abuse, neglect, unreasonable use, use contrary to the written operating instructions attached to or furnished with the appliance or published operating instructions on www.instantpot.com.au, normal wear and tear, commercial use, improper assembly by you or anyone, disassembly by you or anyone, repair by you or anyone, failure to provide reasonable and necessary maintenance, force majeure event including but not limited to fire, flood, acts of God;
2. Repairs where your appliance is used for other than normal, personal use or when it is used in a manner that is contrary to the written operating instructions attached to or furnished with the appliance or published operating instructions on www.instantpot.com.au; or
3. Use of unauthorised parts and accessories, or repairs to parts and systems resulting from unauthorised repairs or modifications/alterations made to your appliance.

The cost of repair or replacement under these excluded circumstances shall be borne by you. Our goods come with guarantees that cannot be excluded under the Australian Consumer Law. You are entitled to a replacement or refund for a major failure and compensation for any other reasonably foreseeable loss or damage. You are also entitled to have the goods repaired or replaced if the goods fail to be of acceptable quality and the failure does not amount to a major failure.

Distributed by Instant Brands (Australia) Pty Ltd.
Sydney Corporate Park
Level 1, 182-184 Bourke Road, Alexandria, NSW 2015.
1800 251 643 or (02) 9317 1000.
Email: sales.australia@instantbrands.com

LEARN MORE

There's a whole world of Instant Rice and Grain Cooker information and help just waiting for you. Here are some of the most helpful resources.

Register your product

instantpot.com.au/support/register

Contact Consumer Care

instantpot.com.au

support@instantpot.com.au

1800 251 643 or 02 9317 1000

Download the Instant Brands Connect App

- Recipes
- New User Tips
- Getting Started Videos



Join the community



Product specifications

Model	Volume	Wattage	Power	Weight	Dimensions
MRRC2001WE	10 Cups 5 Litres	860W	220-240V~ 50-60Hz	3.8 kg	cm: 32 L x 31 W x 25 H

CarbReduce™ STUDY

How it works

- CarbReduce is a two-step function that allows carbs and sugars to separate from the rice during the cooking process.
- The rice is both boiled and steamed, with the steaming being done later in the cooking process.
- This process works by placing the rice in the CarbReduce basket and adding extra water for cooking.
- As the rice absorbs the water, the boiling process turns to a steam process, separating and draining sugars and starches into the pot below.
- When the cooking process is complete, fluffy, delicious rice is left in the basket and starch and sugars are isolated in the bottom of the cooker.

The results

- Reduction of carbohydrates and sugar by up to 40%.

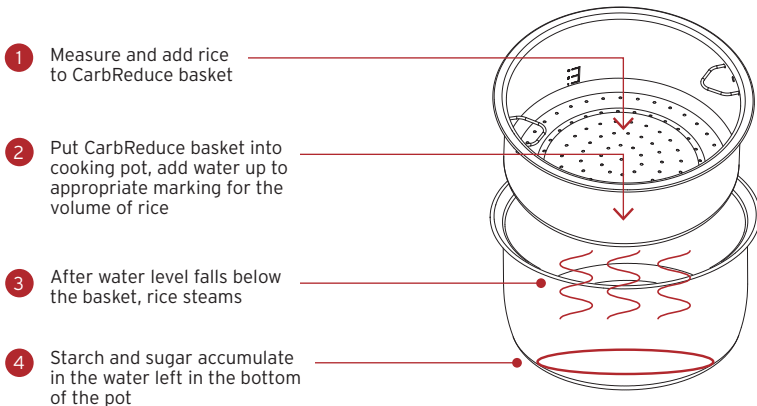

How we tested it

Objective

To test for the reduction of digestible starch in rice varieties when using the CarbReduce™ function.

Samples

The following commonly available rice varieties were tested.

Long Grain White | Long Grain White | Long Grain Brown |
Short Grain White | Basmati White | Arborio White

A total of 4 Instant Rice and Grain cookers were used in the testing.

Laboratory

Testing was conducted by:

Eurofins S-F Analytical Laboratories

2345 S. 170th St.

New Berlin, WI 53151

Procedure

Samples of rice were cooked by the traditional method using the White Rice and Brown Rice functions and compared to samples of rice cooked in the CarbReduce basket using the CarbReduce function. All tests use tap water unless otherwise specified.

Cooked rice samples are analysed for their resistant starch by “Official Methods of Analysis of AOAC International (2005), 18th Ed., AOAC International, Gaithersburg, Maryland, USA, Official Method 2002.02” and digestible starch by “Official Methods of Analysis of AOAC International (2005), 18th ED, AOAC International, Gaithersburg, MD, USA, Official Method 996.11 (mod.)”

Results in percent reduction of digestible starches are provided.

Conclusion

Using the CarbReduce cooking method can reduce the carbs in cooked rice by up to 40%.

©2023 Instant Brands (Australia) Pty Ltd.

Sydney Corporate Park
Level 1, 182-184 Bourke Road, Alexandria
NSW 2015, Australia.

instantpot.com.au

© 2023 Instant Brands LLC.

INSTANT and INSTANT BRANDS are registered
trademarks of Instant Brands Holdings Inc.