

# PLEASE INCLUDE IN STEP 3

## **XL INSERT ASSIST**

The XL INSERT ASSIST was designed specifically for the XL ANTLER INSERT. This NEW TOOL will assist you while installing the inserts into the antler. This part is meant for installation only and you can keep it for future usage. For questions, please check our RACK HUB® youtube channel or contact us via our website:

[www.rack-hub.com](http://www.rack-hub.com)



**XL INSERT ASSIST**

**XL ANTLER INSERT**

1) Install the XL INSERT ASSIST into the XL ANTLER INSERT.

2) Using a hammer, tap the XL ANTLER INSERT into the antler.

3) Grip the XL INSERT ASSIST, twist it and remove it.

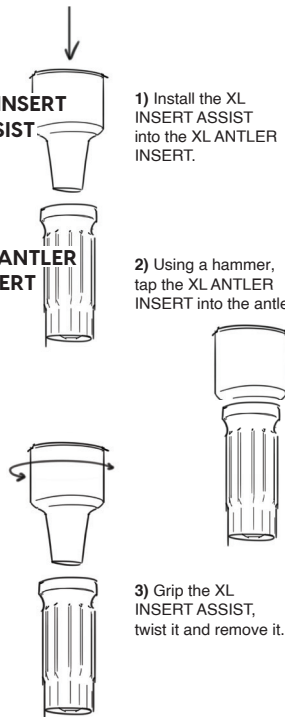

# RACK HUB®

## XL ANTLER BAR INSTRUCTIONS.

**CAUTION**  
SHARP OBJECTS INSIDE

Please follow these instructions. Your antlers will thank you.

### TOOLS NEEDED OR RECOMMENDED.

- Power drill
- 1/4" Hex driver
- Rubber mallet
- Safety glasses
- Vise
- Towel (something soft to wrap antlers while drilling)
- \*\*Saw or grinder for exceptionally rough pedicles



*Failure to use the recommended products and procedures could result in improper installation or cause serious injury.*

### PACKAGE INCLUDES.

- XL Antler Bar
- 1/2" Drill Bit
- XL Antler Insert
- (Antlers not included)

**1** Secure your antler with the pedicle (base) facing in an upright position. (We recommend wrapping something soft around the antler and placing it in a vise.)

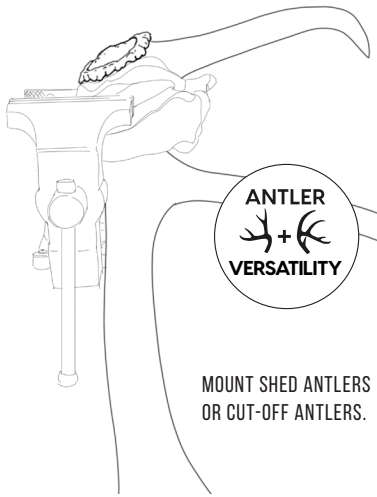

**2** Before drilling, mark your drill bit with a 1" marking (2A- shown below). Using the provided 1/2" drill bit, drill a hole starting at the center of the pedicle using the beam as an angle reference. The hole should be 1 1/2" in depth. Line up the beam from a few angles prior to drilling (do this to avoid drilling completely through the antler).

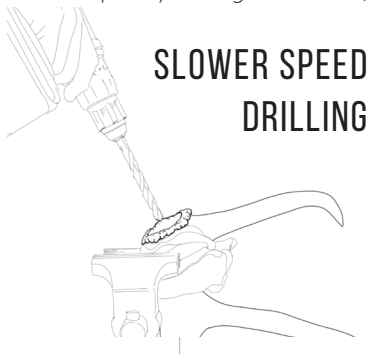

### 2A MARK THE DRILL BIT AT 1 1/2"

We recommend using tape, paint, or a marker to stripe the drill bit at 1 1/2" from the tip.

1 1/2" DEEP

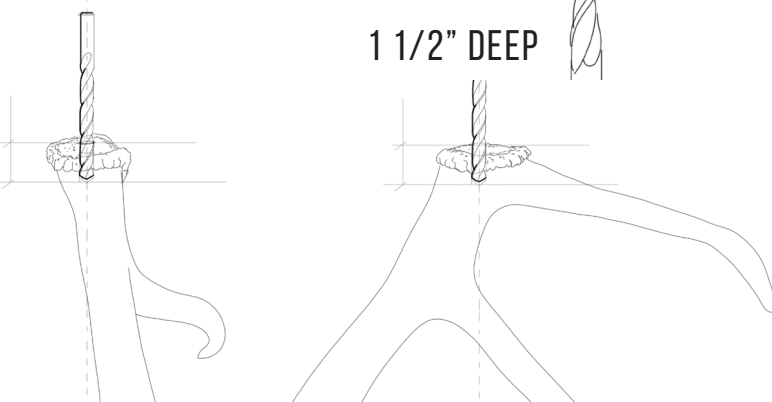

An improperly drilled hole may result in the need to add an adhesive to the antler insert.

**3** Starting with the small end, place the **XL Antler Insert** into the drilled hole. Press the insert in until it's snug, and then find a rubber mallet. Using the mallet, gently tap the insert into the antler until the top lip of the insert touches the antler base.

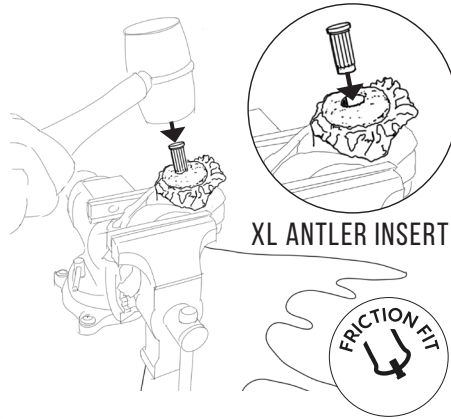

**4** Find a solid surface to mount your **XL Antler Bar**. This Antler Bar can be installed into a flat surface or vertical surface. (Optional: Use a drill with a 3/8" or 7/16" bit to pre-drill a hole into the desired surface). Use a 1/4" Hex driver to install the **XL Antler Bar**. (If you're installing it to drywall, be sure to fasten the product to a stud for a secure mount).

**Note: It helps to install the XL ANTLER BAR into the Antler prior to installation. You can align the XL ANTLER BAR at the proper angle prior to installing it into the desired surface.**

**5** Slide the antler onto the hex end of the **XL Antler Bar** by aligning the bar with the **XL Antler Insert** (mating hex features). Slide the antler down until it's fully engaged on the **XL Antler Bar**. Now you can tighten the **XL Antler Bar** slightly if needed to adjust your angle. Note: Because this is a hex feature, you have six sides of antler angle adjustment.

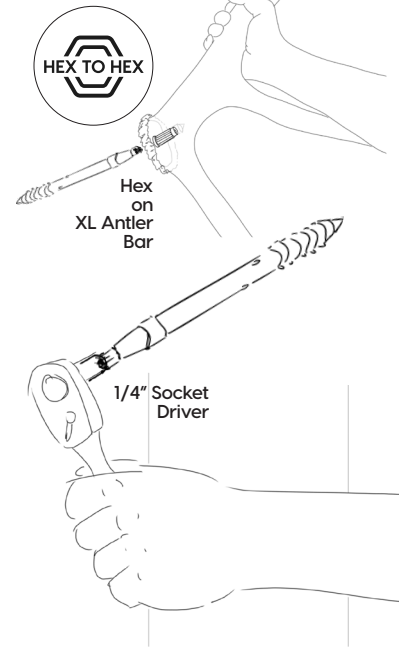

PATENT PENDING



You have now successfully installed your RACK HUB® product. Remember, your antler(s) can be removed at any time, and we highly encourage that interaction. We do sell extra **XL Antler Inserts** in case you have extra antlers.

Visit our website for more information or to see our online installation video.

[WWW.RACK-HUB.COM](http://WWW.RACK-HUB.COM)

Keep in touch, and follow us on our social media platforms. We would love to hear your feedback and see how our products are being used. We strive for quality, and we can only do that with your help. Please use **#RackHub** when sharing your photos.

**THANK YOU!**

