

## Stem Spring Change Guide (50 Degree)

This guide demonstrates how to remove and replace the spring in the Kinekt Suspension Stem. This guide applies to the 50-degree stem.

### Stem Spring Options (1.5" Length)

Firmness	Color Code
Soft	Blue
Medium	Black
Firm	Green

### Required Tools

- 2.5mm hex key
- 3mm hex key
- Torque wrench (recommended)

### Spring Removal

1. Undo cover screw (A) with a 3mm hex key.

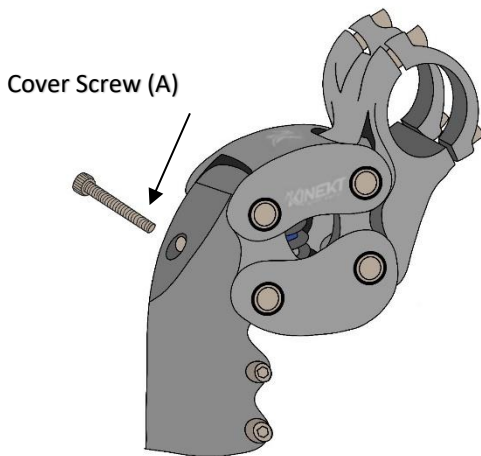

2. Remove back cover (B) and undo set screw (C) with a 2.5mm hex key.

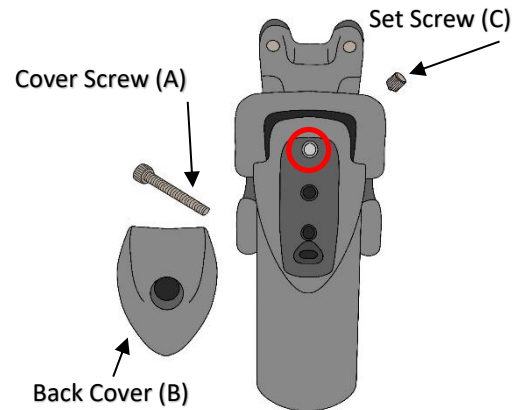

3. Push pivot pin (D) sideways to remove.

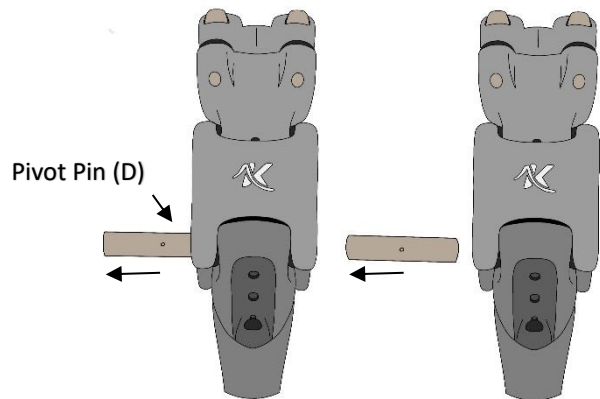

4. Rotate upper link (E) upwards to access spring assembly.

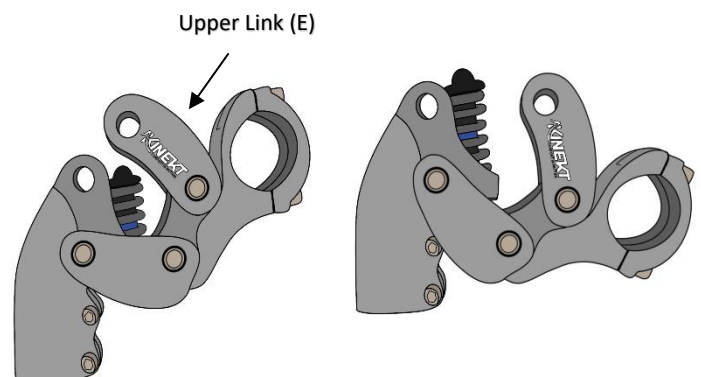

- Remove upper spring guide (F) with bottom out bumper (G) and 1.5" spring (H).

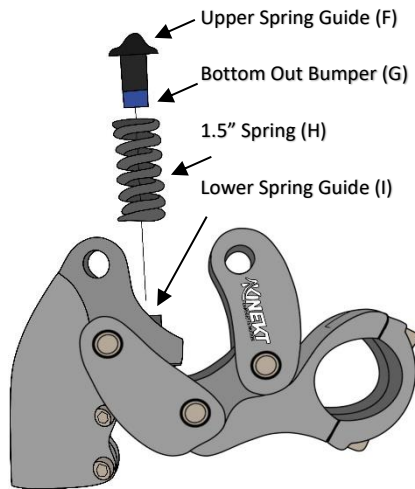

- Insert the pivot pin (D), making sure to line up the indent and set screw hole.

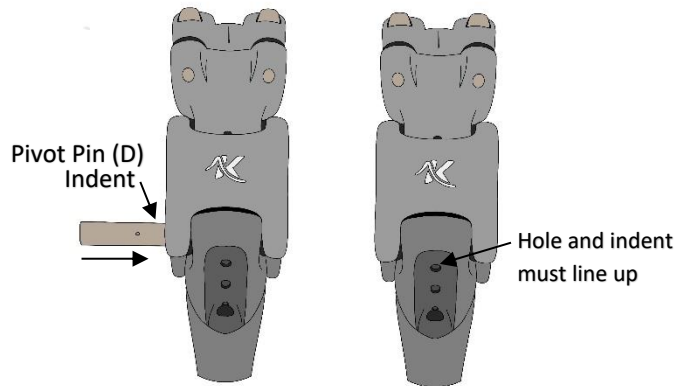

- Install the set screw (C) and tighten to 2.5Nm.

*Note: If the factory thread-locking treatment has worn off, apply a drop of medium strength threadlocker to the set screw threads. Treated replacement set screws are also available from our store.*

### Spring Installation and Reassembly

- Ensure that lower spring guide (I) is fully seated in the rear link.
- Put spring (H) in place.
- Top with upper spring guide (F).

*Note: Early units were assembled with the upper spring guide and bottom out elastomer glued together. If these parts have separated, install the bottom out elastomer (G) inside the spring (H) and top with the upper spring guide (F). Reglue elastomer to upper spring guide with super glue ((cyanoacrylate).*

- Rotate up on front link until it stops, then rotate upper link (E) into place. Note that there is a groove in the upper link that the upper spring guide slots into.

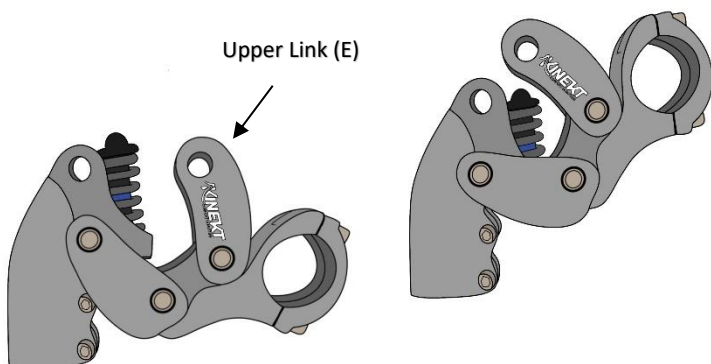
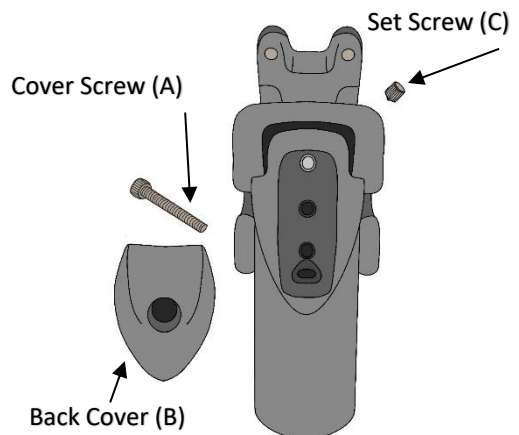

12. Replace the back cover (B). Install the cover screw (A) and tighten.

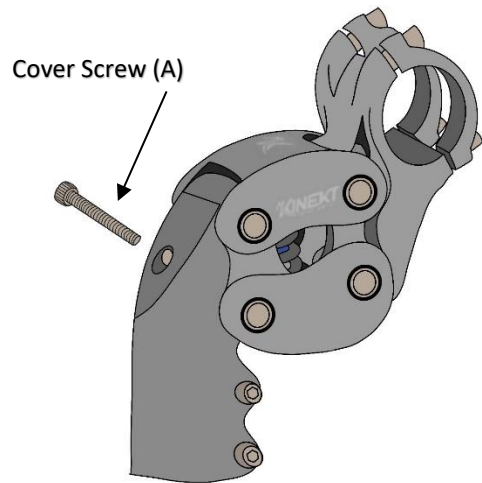

***Customer Support***

*For assistance, please contact us via email or phone:*

[info@cirruscycles.com](mailto:info@cirruscycles.com) / (360)-392-8302