

**Instruction manual**  
**Rechargeable 12" Yoga Fan**

iQ1200



Please read this manual carefully before using the product

## Control panel

LED DISPLAY



## Remote Control

ON/OFF



TIMER

SPEED



SWING



Redfern

## Structure diagram

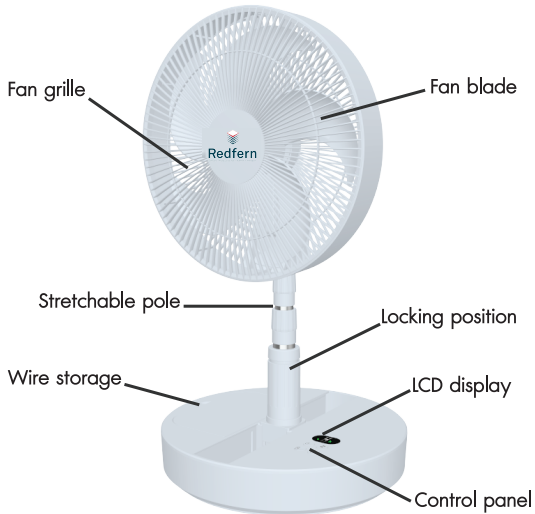

# Operation instruction

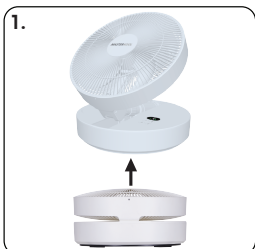

Unfold the fan by pulling it upwards

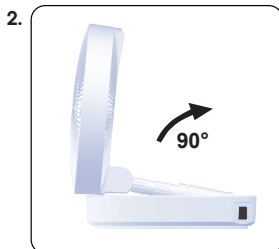

Extend the fan according to the arrow direction above and set the fan head upright

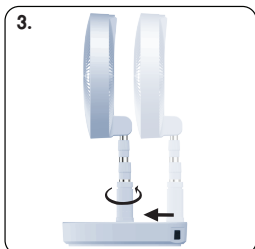

Shift the pole to the center of the base, turn the twist lock counter-clockwise to fix the pole in the position

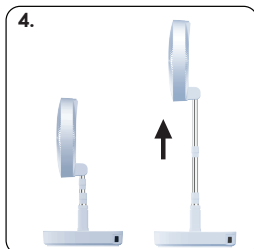

Maximum height of the fan can be stretched up to 92 cm. Pull the pole up or down gently

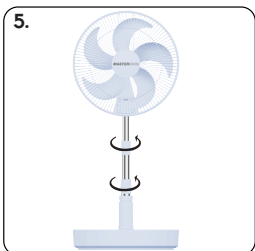

Turn the twist locks counter-clockwise to lock the height of the fan

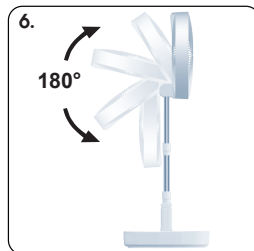

The fan can be flipped backwards according to arrow direction

## How to operate the fan

### 1. ON/OFF

Press ON/OFF button on the control panel or remote control to turn on/turn off the fan.

### 2. SPEED

Press SPEED button on the control panel or remote control to adjust the fan speed from level 1 (Lowest speed) to level 9 (Highest speed). Speed level indicates on the LED display.

### 3. SWING

Press SWING button on the control panel or remote control to activate swing mode. The fan will automatically oscillate 90° horizontal range. To stop swing mode, press SWING button again.

### 4. TIMER

Press TIMER button on the control panel or remote control to set the timer from 1-9 hours. Setting time indicates on the LED display. To exit timer mode, press TIMER button again.

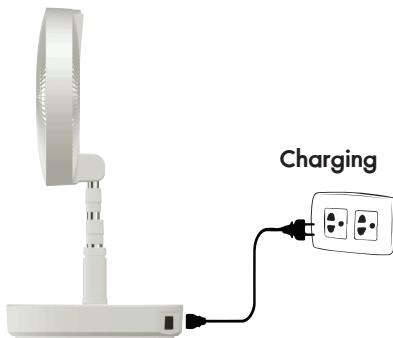

WIRE & REMOTE CONTROL STORAGE



DURING "SWING MODE", FAN BASE ROTATES LEFT AND RIGHT AUTOMATICALLY

## Product specification

**Product name:** iQ 1200

**Main material:** ABS plastic

**Fan size:** 12"

**Fan blade:** 5 blade

**Fan blade material:** Polypropylene

**Fan speed:** 9 speed

**Motor speed:** 1280 rpm

Air volume: 1985 m<sup>3</sup>/h

Wind speed: 8.2 m/s

Power: 25 W

Current: 0.145 A

Battery type: Lithium-ion (12000 mAh)

Continuous usage (fan only): 3-32 hours

Charging input: DC 27 V 0.5 A

Charging time: 2-2.5 hours

Maximum noise: 58 dB

Product size (Fold): 335x335x150 mm.

Product size (Unfold): 335x335x920 mm.

Net weight: 2.6 kg.

Gross weight: 3.1 kg.

Timer: 1-9 Hour

Oscillation: 90°

Remote control: √

## Safety caution

### . FOR HOUSEHOLD USE ONLY

- Do not place this product on high and uneven counter-tops or floors, avoid any falling damage
- Do not use the power supply beyond the product load which might cause the product heating and the circuit board burning out
- Do not disassemble or modify this product by yourself
- This product is prone to heat generation of electrical motor due to long time usage. It is recommended to use no more than 4 hours
- Do not hit or throw this product, it would be easily cause internal troubles
- Do not place the product in a cold humid place
- Do not throw the product into the fire, keep it away from the fire

## How to clean the fan

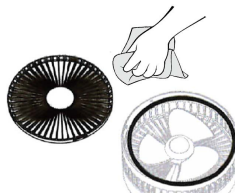
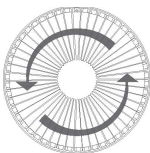

1) Open the front grille counter-clockwise

2) Use only a dry cloth to clean the front grille and fan guard.

## 1 Year Limited Warranty

This product is warranted for 1 year from the original date of purchase, against defects in materials and/or workmanship when utilized for normal household use. During this period if the unit is proved defective it will be repaired or replaced at the discretion of the service technician.

**The unit shall be returned, by original purchaser, freight prepaid with proof of original purchase date and \$29.99 return shipping/handling charges included. Redfern Enterprises does not accept C.O.D.'s and will not reimburse for any fees associated with the return or shipping of the item.**

This warranty does not apply to any defect arising from a buyers misuse, negligence, failure to follow instructions, use on current or voltage other than that stamped on the unit or repairs not authorized by a Redfern Ent. technician will null and void the warranty.

If you believe that your product is defective, contact Redfern Enterprises Customer Services Department:

CANADA  
101-127 Commercial Drive,  
Calgary, AB T3Z 2A7  
TF: 1-877-387-7770 (Toll Free)  
info@redferment.com www.redferment.com

UNITED STATES  
4168 N North Pecos Road, Ste 102  
Las Vegas, Nevada, 89115  
1-877-462-5757 ext. 1 (Toll Free)  
infous@redferment.com www.redfermentus.com

**Obtain a repair authorization number (RA Number) and bring in or send prepaid to the Service Center with proof of original purchase date, and prepaid return shipping of \$29.99. See contact info above for RA Number.**