

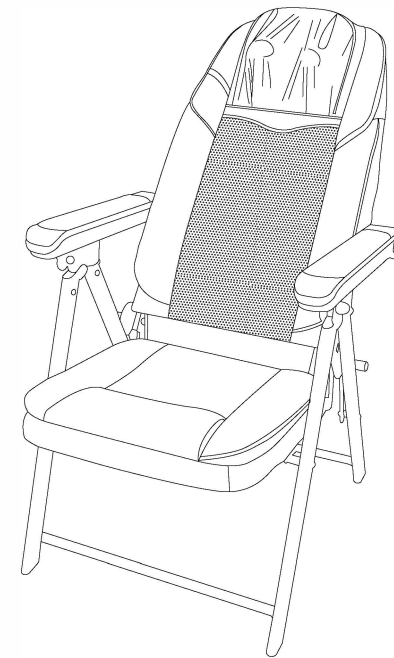

## SHIATSU FOLDABLE MASSAGE CHAIR



**User Guide**  
**BPM25**

## General Warnings

1. Keep cord away from heated surfaces.
2. Never block the air openings of the product or place it on a surface, such as a bed or couch, where the air openings may be blocked. Keep the air openings free of lint and hair.
3. Never use while sleeping.
4. Never drop or insert objects into any opening.
5. Do not operate where aerosol products are being used or administered.
6. Do not use on or near eyes or other highly sensitive areas.
7. Do not operate under a blanket or pillow. Excessive heating can occur and cause fire, electric shock, or injury.
8. Do not carry this product by its cord or power cord, or use the cord as a handle.
9. Do not use directly on one concentrated area of the body. It is meant to be used in a continuous motion, constantly changing the massage area.
10. To disconnect, turn all controls to the off position then remove the plug from the outlet.
11. Do not perform any servicing on the product.
12. Use this product only for its intended use as described in this manual. Do not use attachments not recommended by the manufacturer.

### To reduce the risk of burns, fire, electric shock, or injury:

1. Always unplug the product from the electrical outlet immediately after using and before cleaning.
2. Do not use while bathing or in a shower.
3. Do not place or store product where it can fall or be pulled into a tub, sink, or other body of water.
4. Do not place in or drop into water or other liquid.
5. Do not reach for an electrical appliance that has fallen into water. Unplug it immediately.

1

## In the Box

### Massage Chair

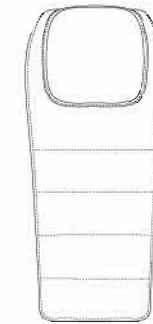
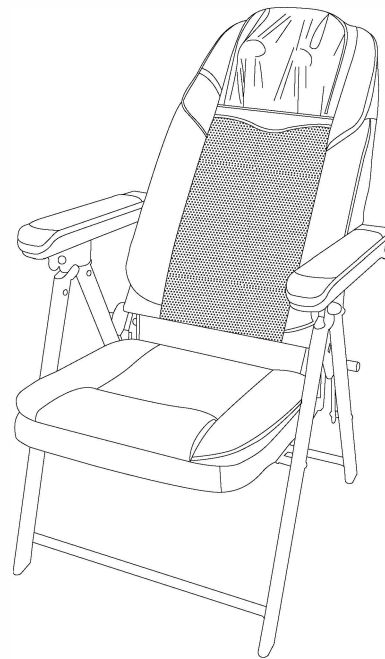

Chair Pad

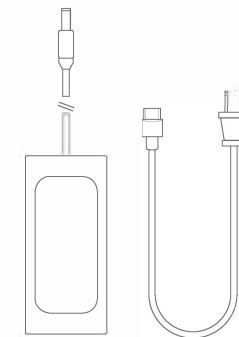

12V  5A Power Adapter and Cord

2

**Location of Controls (Massage Chair)**

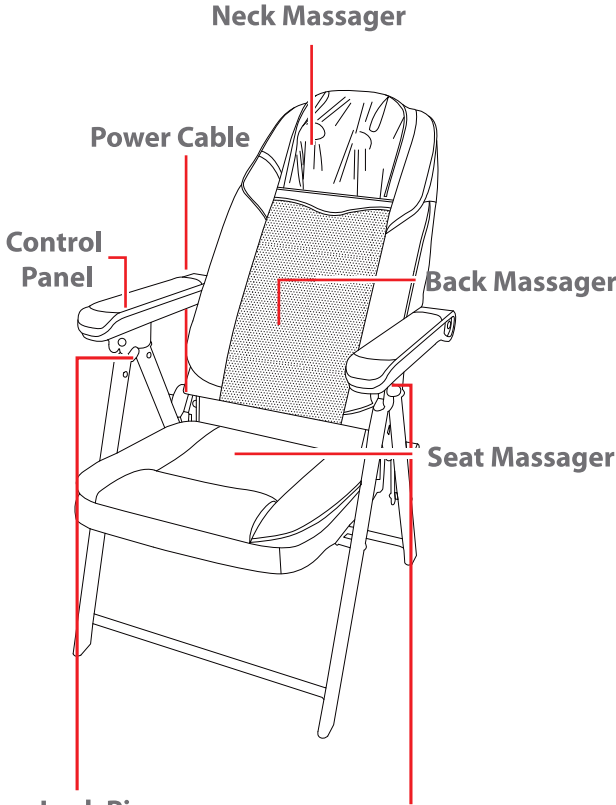

**Lock Pin**  
Adjust the back of the chair, turn the pin upward and lock into place.

**Location of Controls (Control Panel)**

1. **Neck Massage Adjustment**  
Adjust the height of neck massage nodes
2. **Neck Massage Mode**  
Switch between manual (*left button*) and automatic (*right button*) modes.
3. **Back Massage Mode**  
Cycle through *FULL*, *UPPER*, or *LOWER* back massage.
4. **Vibration**  
Cycle through 3 seat and massage intensities.
5. **Target**  
Massage specific target area.
6. **Target Adjustment**  
Adjust targeted massage area.
7. **Heat**  
Adjust heat level.
8. **Power**  
Power ON/OFF.

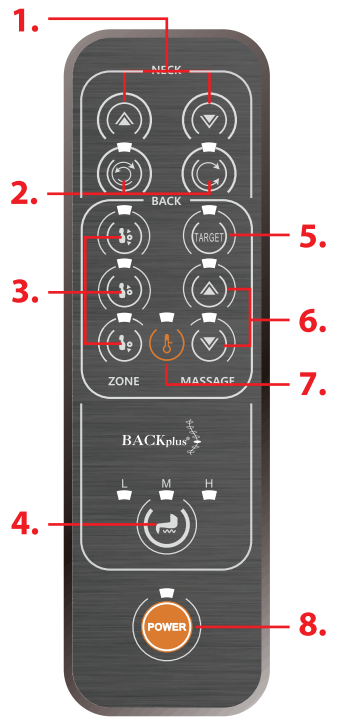

**Setting Up the Massage Chair**

**Setup**

Remove the massage chair from its packaging and fully unfold the chair, standing it upright. Make sure that you have room to unfold the chair and that it is located near a wall outlet.

Connect the pin of the **supplied 12V power adapter** into the **Power Cable** on the massager.

Plug the power cable into the power adapter and plug the other end into a wall outlet.

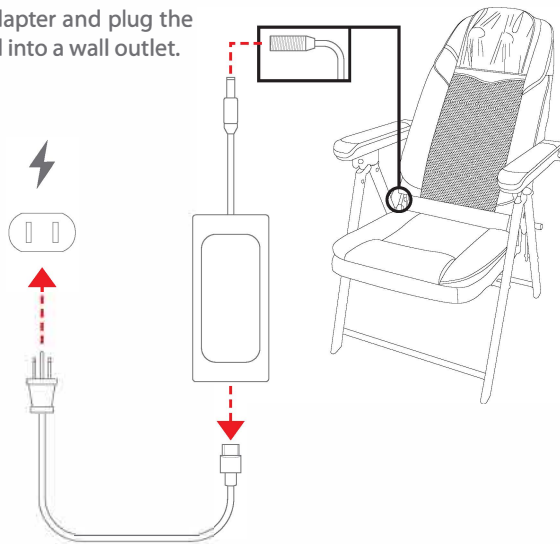

**Adjusting the Seat Back**

To adjust the chair, undo the lock pin, adjust the back of the seat to your liking, and return the lock pin to place.

**Using the Massage Chair**

**Using the Massage Chair**

**NOTE:** When using the massage chair, always sit fully upright in the chair. Do NOT slouch or slide forward, do NOT sit on the edge of the chair, and do NOT tip the chair forward or backward.

After setting the chair up, the control panel on the right arm will allow you to power the chair ON/OFF, set your massage modes and intensity, activate heat, etc.

**Powering ON/OFF**

- Press the **Power** button on the control panel to turn the massage chair ON/OFF.
- If not in use, the chair will **automatically power off** after **15 minutes**.

**Adjusting Heat**

- Press the **Heat** button to adjust the heat function.

**Adjusting Vibration**

- Press the **Vibration** button on the control panel to cycle through the 3 seat massage intensities.

**Neck Massage**

- Press the **Neck Massage Adjustment** and **Mode** buttons to adjust the intensity and area of the neck massager nodes and to switch between **manual** (left button, below) and **automatic** massage (right button, below).



**Back Massage**

- Press the **Back Massage** buttons to adjust the different areas of the back to be massaged.
- Press the **Target** button to massage a specific area on the back and use the arrow buttons to adjust the targeted massage area.

**Additional Safety Warnings**

**Storing the Massager**

The massager should be stored in a dry, cool location, away from sources of water or heat. It is best stored in a secure box or an airtight bag to keep it free of dust.

To fold the massager for storage:

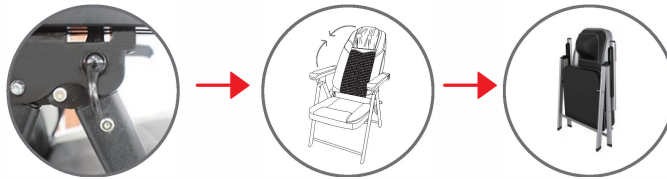

Lock the pin on both sides

Fold the back and arm rest inward

Folded for storage

**Cleaning the Massager**

To clean the massager, unplug the massager and let the pad cool down if the heating function was just used.

Wipe the pad down with a soft, slightly damp sponge. Avoid using concentrated soaps, such as dish soap, as it will be very difficult to clean from the pads once applied.

- Do NOT allow any liquid or cleaning solutions to come into direct contact with the massager.
- Do NOT immerse massager in water.
- Do NOT use any abrasive cleaners or chemicals on the pad.
- Do NOT attempt to repair any damage to the massager.

1. Consult your doctor before using this product.
2. Individuals with pacemakers should not use this item.
3. Never leave the product operating or unattended, especially if children are present.
4. Never use the product on open skin eruptions, swollen, or inflamed areas.
5. Do not operate after taking painkillers, sedatives, or alcohol. Consult your doctor if you are under these medications.
6. Do not continuously operate for 15 minutes or longer. It is recommended to turn the product off and allow it to rest (cool) for 30 minutes before re-using. This will prolong the life of the product.
7. The product is designed as a non-professional massager to soothe tired and aching muscles. It is not intended to be a substitute for medical attention. If your ailments and symptoms persist or worsen after use, contact your doctor immediately.

**WARNING:** Any individual who is pregnant, has a pacemaker, suffers from diabetes, phlebitis, and/or thrombosis, or is at an increased risk of developing blood clots due to recent surgery, should consult their physician before using a massaging device designed for home use.

**Limited Warranty**

**READ CAREFULLY AND KEEP THIS MANUAL**

**Caution:** Any changes or modifications not expressly approved could void the user's authority to operate the equipment.

**TO OBTAIN WARRANTY SERVICE:**

- 1 YEAR LIMITED WARRANTY
- This product to be free from defects in material and workmanship for a period of one (1) year from the date of original purchase, when utilized for normal household use, subject to the following conditions, exclusions and exceptions. Should any defect covered by the terms of the limited warranty be discovered within one (1) year, manufacturer will repair or replace any defective part provided the unit is returned by the original purchaser, Purchaser to package item safely and prepay shipping. A prepaid return shipping charge of \$49.99 must be included with the product if repair is needed.
- This warranty does not cover normal wear of parts and does not apply to any unit that has been tampered with or used for other than stated purposes. This warranty does not apply to any defect arising from misuse of the product, negligence, failure to follow manual, use on current or voltage other than that stamped on the product, alteration or repair not authorized by manufacturer, or damage due to faulty packaging or mishandling in transit (by a common carrier). Repair or disassembly by anyone other than a manufacturer authorized service center will void the warranty.
- This warranty is extended to the original purchaser of the unit and excludes all other legal and/or conventional warranties. The responsibility of manufacturer, if any, is limited to the specific obligations expressly assumed by it under the terms of the limited warranty. In no event is manufacturer liable for incidental or consequential damages of any nature whatsoever.
- For more information please contact Redfern Ent. at # 101-127 Commercial Drive, Calgary AB T3Z2A7
- Toll Free 1-877-387-7770 ext 222