

Discus Vine 3

Installation Guide

M . M

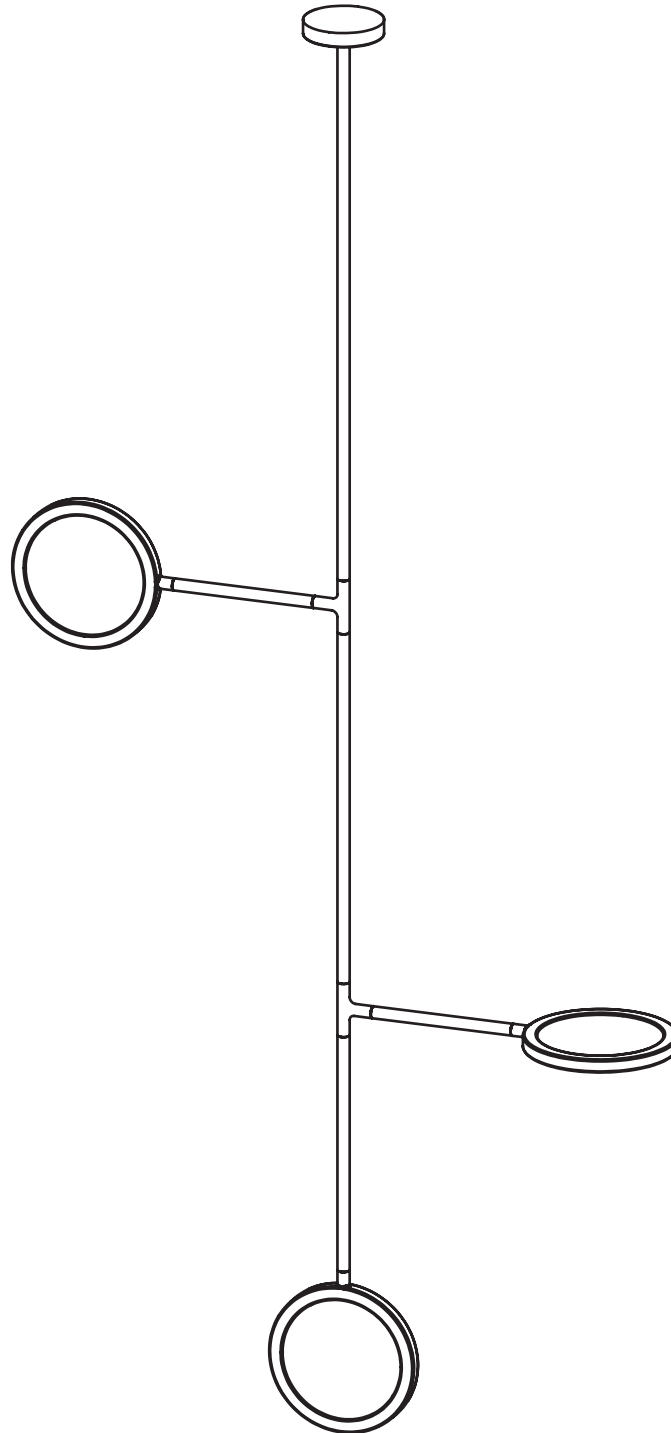

Discus Vine 3

Installation Guide

M . M

Included for installation:

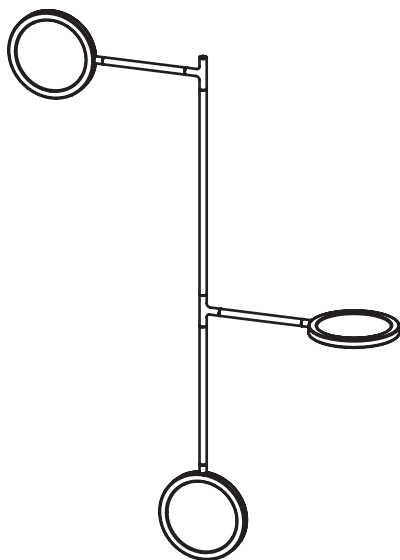

1 × Discus Vine 3

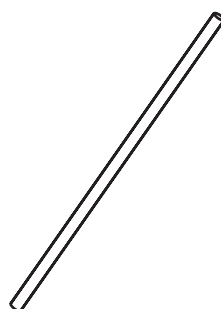

1 × Drop Stem

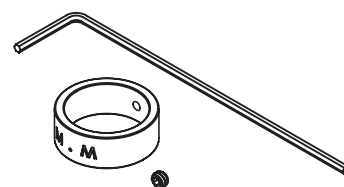

1 × Slip Ring, Hex Key, & Screw

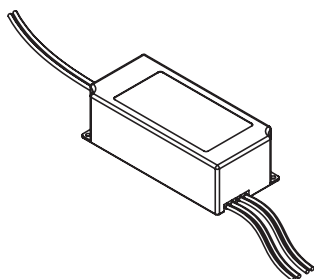

1 × LED driver



2 × Threaded Nipple

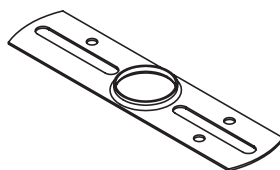

1 × Crossbar



1 × Ground Wire

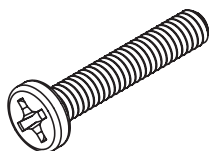

2 × 8-32 screws

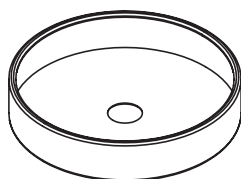

1 × Canopy



1 × Hex Nut



5 × Wire Nuts

Discus Vine 3

Installation Guide

M . M

Step 1 - 2

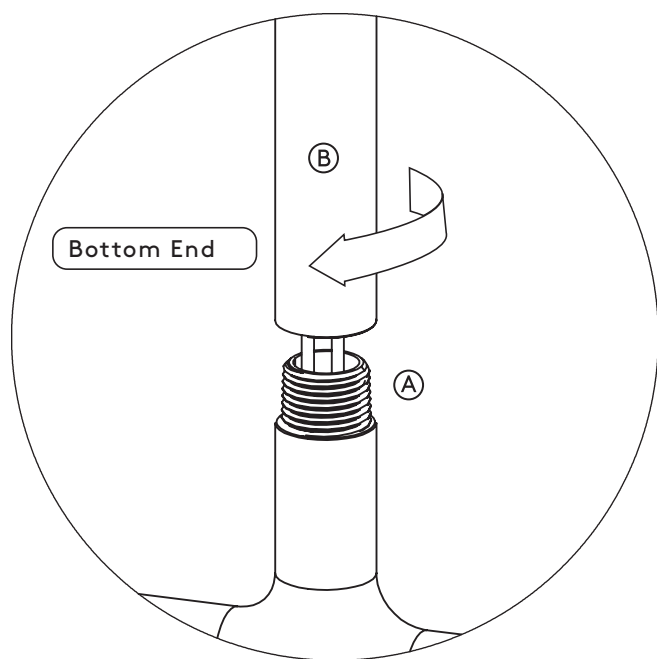

DANGER: ELECTRIC SHOCK RISK
Turn off power before installing.

Matter Made recommends the installation of this fixture to be completed by a licensed electrician.

1. Remove fixture from packaging and lay flat on a protected surface.
2. Feed the fixture wires through one of the included threaded nipples (A) and screw the nipple into the fixture. Feed the wires through the drop stem (B) and screw the drop stem onto the threaded nipple.

Step 3

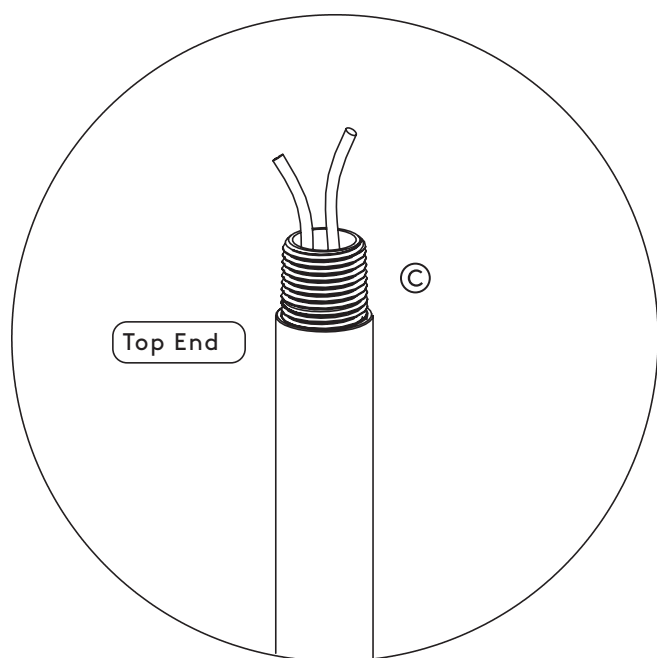

3. Feed fixture wires through the remaining threaded nipple (C) and screw the nipple into the top of the drop stem.

Discus Vine 3

Installation Guide

M . M

Step 4 - 5

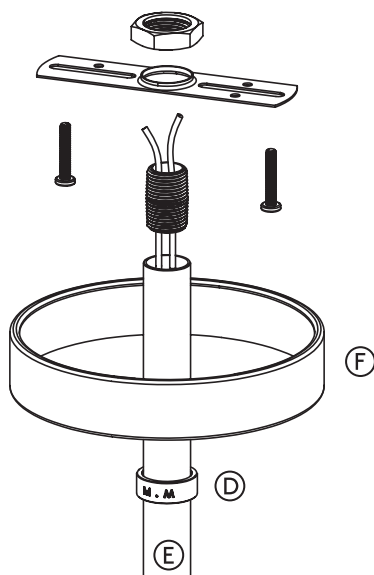

4. Loosen the set screw on the slip ring (D) and slide the slip ring down the drop stem (E) about 12 inches. Tighten the slip ring set screw.
5. Slide the canopy (F) down the drop stem and allow it to rest on the slip ring. Take care to avoid scratching the drop stem.

Step 6 - 7

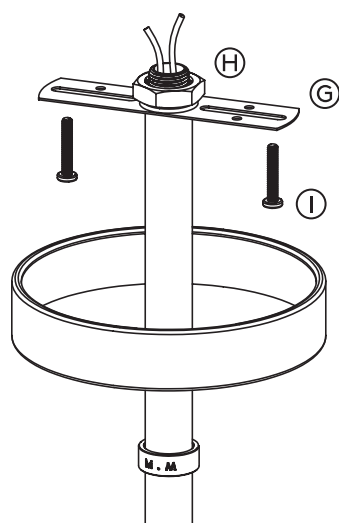

6. Attach the included cross bar (G) to the threaded nipple. Secure the crossbar in place using the included hex nut (H).
7. Attach the Discus to the junction box in the ceiling by passing the provided 8-32 screws (I) through the slots in the crossbar and into the threaded holes in the junction box.

Discus Vine 3

Installation Guide

M . M

Step 8 - 10

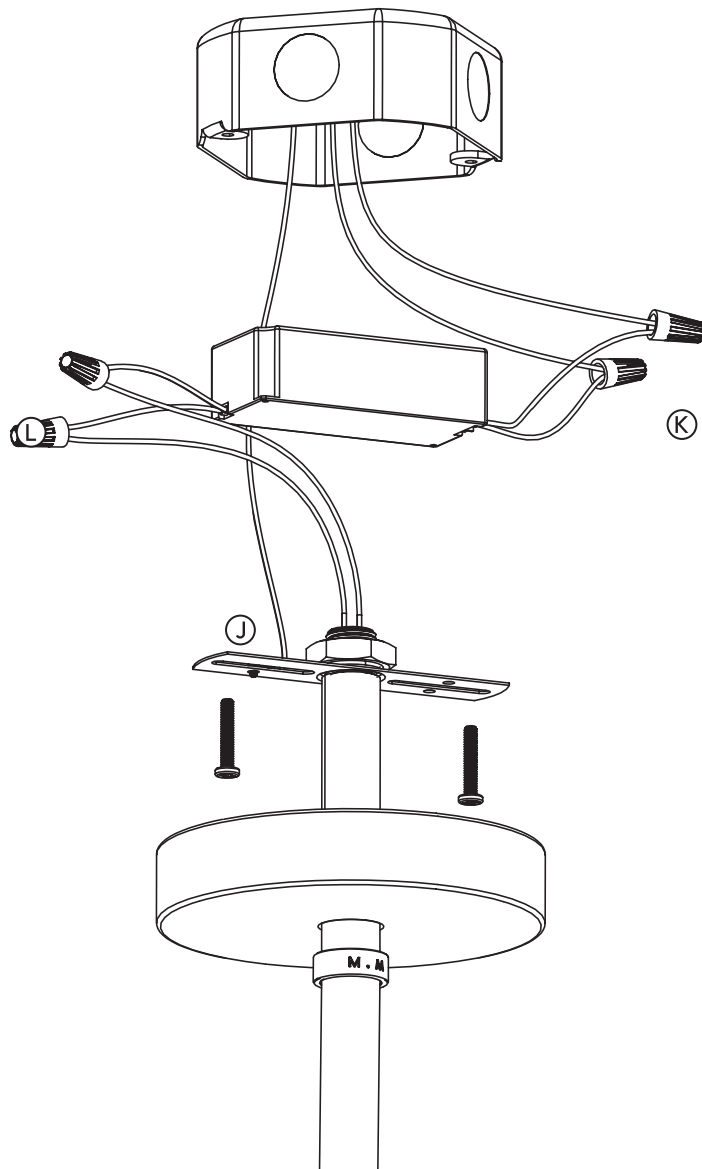

NOTE: The drawing is exploded for illustrating wiring and electrical connections. **The LED driver needs to be connected to the main power, allowing an adjusted current to power the LEDs. Never connect your fixture directly to power without a driver.**

8. Using the included wire nut, attach the ground wire from the junction box to the crossbar ground wire (J).
9. Using the included wire nuts, connect the live wire of the junction box (K) to the black wire of the LED driver. Connect the neutral wire from the junction box to the white wire of the LED driver.
10. Using the included wire nuts, connect the red wire (LED+) of the LED driver to the red wire (L) of the Discus fixture. Connect the black (LED-) wire of the LED driver to the black wire of the Discus fixture.

If you are using a 0-10v dimmer, connect the purple wire (DIM+) to the corresponding wire connected to your dimmer. Connect the pink wire (DIM-) to the corresponding wire connected to your dimmer.

If you are NOT using a 0-10v dimmer, cap the purple and pink wires separately with wire nuts or electrical tape.

Discus Vine 3

Installation Guide

M . M

Step 11

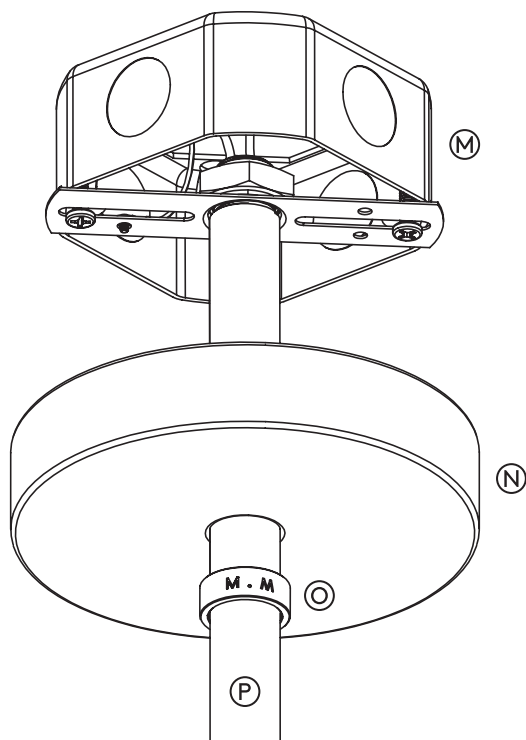

11. Tuck the connected wires into the junction box (M) and place the LED driver into the canopy (N). Using the provided hex wrench, loosen the slip ring set screw and slide the slip ring (O) and canopy up the drop stem (P). Make sure the canopy is flush to the ceiling and secure the canopy in place by tightening the slip ring set screw.

Step 12

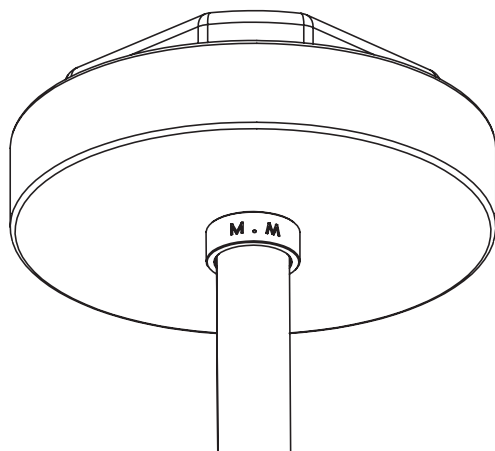

12. Turn on the power to the fixture and test switch and dimming function. Installation of the Discus is now complete.

Enjoy!