

RACKLESS

Awning Mount System

Important:

Installation should only be done by a qualified person and it is the responsibility of said person to ensure correct fitment.

Please read all procedures and precautions before installing and using the Rackless Awning Mount System. If you have any questions please contact us via email on the back of this installation manual.

Warning!

Please follow these steps when drilling the roof to avoid damage to the side curtain airbag mechanism. Failure to follow these steps will result in vehicle damage. It is recommended the vehicle roof head lining should be removed to ensure nothing is below the drilled position.

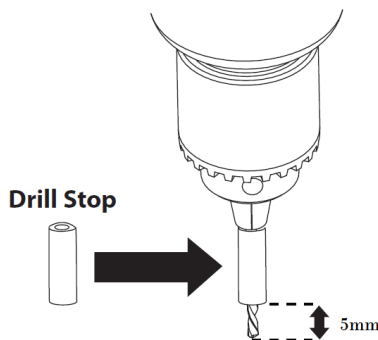

Warning!

Max Drill Depth is 5mm

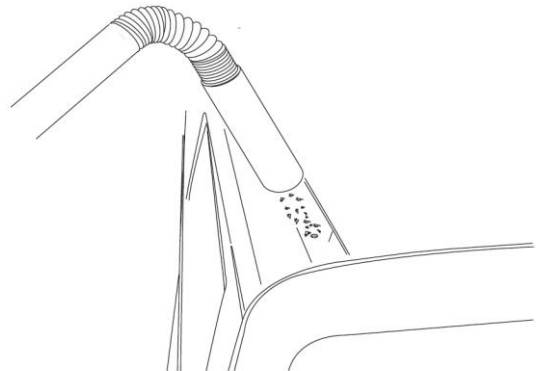

Drill approximately halfway and then use a vacuum to remove swarf from roof channel. Continue drilling the hole, repeat operation for remaining holes.

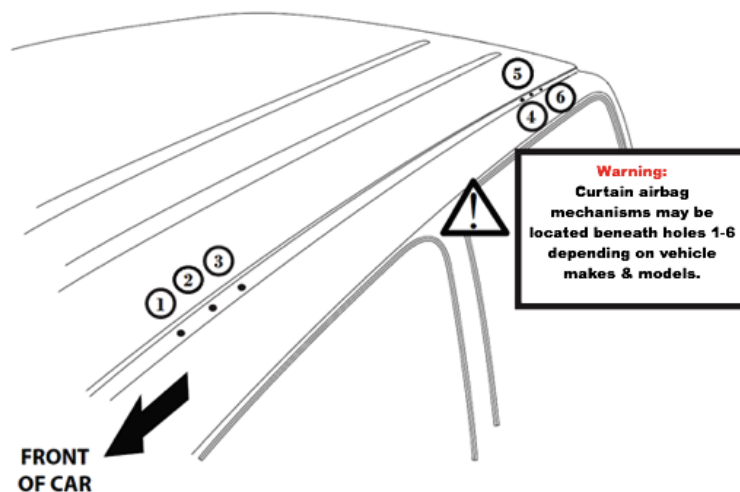

Care Instructions:

Clean vehicle roof before fitting Rackless roof mounts.

Tools Required:

- Vacuum cleaner
- 5mm drill bit with depth stop
- Marking pen
- Rivet gun with head to fit inside 12mm counter sunk hole
- Cordless or power drill
- Hammer and centre punch
- Rust stop paint and brush
- T30 torx security socket bit and torque driver
- Silicon and caulking gun
- Measuring tape

- Tin snips
- Tape
- Flat blade screwdriver
- Packing knife

Kit Contents:

- 2x Rackless bracket assemblies
- 4x T30 Stainless security bolts long
- 4x Stainless flat washers
- 4x Stainless spring washers
- 2x Paint protection strips
- 1x T30 torx bit
- 2x Stainless roof mounts
- 6x Stainless pop-rivets

Fitment Instructions:

1. Before installation check bracket and mount application is compatible with your vehicle.
2. Cover the working area with masking tape to prevent scratching the paint.
3. Place the front mount in the channel and measure from the edge of the windscreen rubber to the first rivet hole (Measurements found on table on back page). Mark the ends of the mounts with a felt pen this will be where to cut the adhesive.
Do the same for the rear mount. Then remove the mounts.
4. The roof channel is filled with rubber adhesive, this needs to be sliced with a knife along the edges and ends at the previously marked area's then levered out with a screwdriver.

Note: Purpose of extra holes on one roof mount is for fitment of optional LED light bar and should be placed facing the front of the vehicle.

5. The mounts can then be placed in the cut out sections and mark the holes for the rivets.

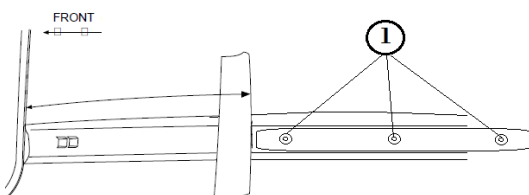

6. Accurately centre punch all holes before drilling.



7. Marked out holes can now be drilled using a 5mm drill bit with a drill stop. Set up the drill stop ensuring you don't drill through the roof lining.

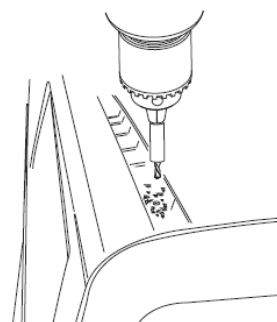

NOTE:
USE CARE WHEN BREAKING THROUGH. A DRILL STOP IS RECOMMENDED.

8. Use a vacuum to remove swarf from the roof channel.

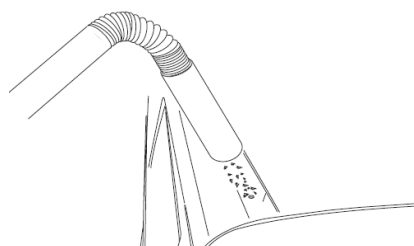

9. Apply anti rust paint to the inside and surrounds of all holes, allow for time to dry before applying silicon around each hole and along the mount length.

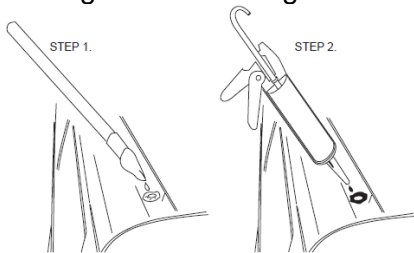

10. Accurately place the mount over the drilled holes in the roof channel using the rivets to position.

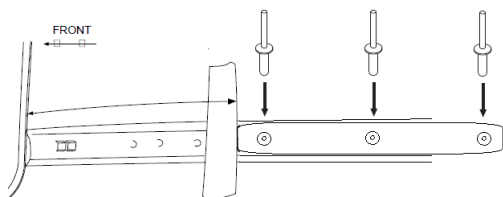

11. Using rivet gun, rivet the mount into place, make sure all rivets are seated firmly onto the base of the mount.

Note: Once pop rivets are fitted counter bore and around the mount can be filled with silicon to prevent from holding water.

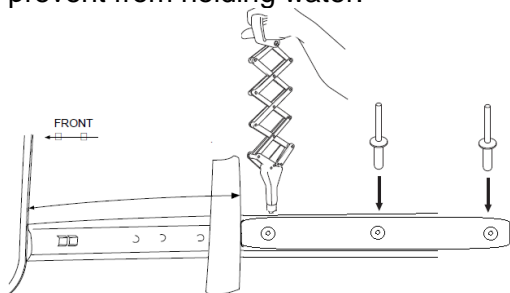

12. Apply paint protection strip to sit directly beneath both Rackless awning mounts.

13. Rackless awning bracket to be fitted to the roof gutter and mounts of the car with 4x M6 bolts and washers using an Anti-theft torx bit. Tighten bolts evenly to a torque of 6Nm.

Note: Some mounts have differing bolt lengths, ensure there is a significant amount of bolt through the mount.

Note: Ensure bracket is firmly pushed towards centre of vehicle. If not pushed inward, brackets may cause wear to door dust seals.

Note: This will be the same method if being fitted to roof tracks.

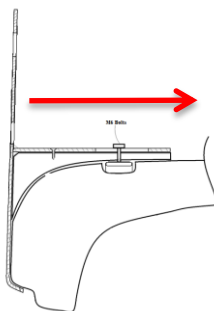

14. Fit awning to bracket using the bolts provided with awning and tighten to specs within awning instructions.

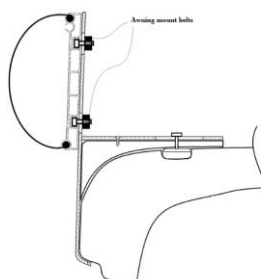

Maintenance Recommendations:

It is essential that all bolts and connections be checked after driving a short distance when you first install your awning mounts.

All bolt connections should be checked again at regular intervals (more often on rough road conditions). Ensure bolts are to specified torque as per above installation instructions.

The high density foam and paint protection strips should be inspected at regular intervals and replaced when required as these materials will not outlast the lifetime of the mounts. Please contact us if you require material replacements.

Sensitivity to cross winds and behaviour in curves:

The handling characteristics of the vehicle changes with the wind drag of an awning, for safety reasons we recommend you exercise extreme care when driving.

Please remove awning and brackets when putting vehicle through an automatic car wash.

When the awning is in use ensure the guy ropes are tied securely to pegs, especially in windy conditions, or as per awning manufacturer's setup instructions.

Do not let water sit on the awning. When the awning is out ensure there is enough fall to carry any rain off the side.

Note to Dealers and Fitters:

It is your responsibility to ensure instructions are given to the end user or client.

Additional Note:

No responsibility or liability will be held against supplier for incorrect fitment of product resulting in component or vehicular failure or damage. By purchasing this product you agree to all of these conditions.

Vehicle Make & Model	Front Mount 1 st hole from Windscreen	Rear Mount 1 st hole from Windscreen
Nissan NP300 Dual Cab	240mm	1140mm
Nissan NP300 King Cab	280mm	1200mm
Mercedes XClass Dual Cab	345mm	1055mm

Chalming Creations will warrant the original purchaser against manufacturing faults and defects in material for a period of 12 months from original purchase date.

- To obtain warranty, Chalming Creations must be provided with proof of purchase and photographic proof of fault. This warranty does not cover the removal or re-installation of the product.
- To obtain warranty, Chalming Creations must be provided with proof of fitment by a qualified person.
- Chalming Creations reserves the right, at its option, to repair, replace or refund the purchase price of a faulty or defective product or its components if returned to the place of purchase during the warranty period.
- When returning a product for warranty assessment it must be accompanied with the customer's name, address, contact phone number, a clear description of the fault and a copy of the original sales receipt detailing the date of purchase.
- For bent products being returned, they will be tested to hold 30kg each. If the desired weight is held they will not be classed as defective and classed as improper use or acts of nature. A typical awning weighs approximately 13kg and will not bend the product if set up and fitted correctly. Please ensure your awning is set up so it does not collect water and secured down with guy ropes as per manufacturers instructions.
- This warranty does not apply to damage due to accident, misuse, abuse, misapplication, collision, modification, improper installation or improper maintenance.

For change of mind purchases, the product must be returned in full within 30 days of the shipment date. A partial refund will be issued (minus any merchant, postage and packaging costs) with return postage being the purchasers responsibility.