

Max. operating height	1,547 mm (60.9")
Folded length	520 mm (20.5")
Camera platform diameter	48 mm (1.9")
Weight	535 g (1.2 lbs)

### Operating Instructions

Thank you very much for choosing SLIK PRO POD 382CFL. The SLIK Corporation has designed your monopod to be a sturdy, rugged, dependable product that will provide you with many years of satisfactory use.

Please take a few moments to read this operating instruction carefully before use so that you can take full advantage of your Monopod's many fine features. Retain this operating instruction in case you might want to refer back to it.

#### ⚠ Caution

This caution icon refers to information pertaining to important safety procedures in preventing injuries, or damages which may occur as a result of mishandling this product.

#### 🚫 Prohibition

This prohibited icon refers to information pertaining to prohibited contents. Please refer to instructions closely to avoid accidents.

Q918

### Components

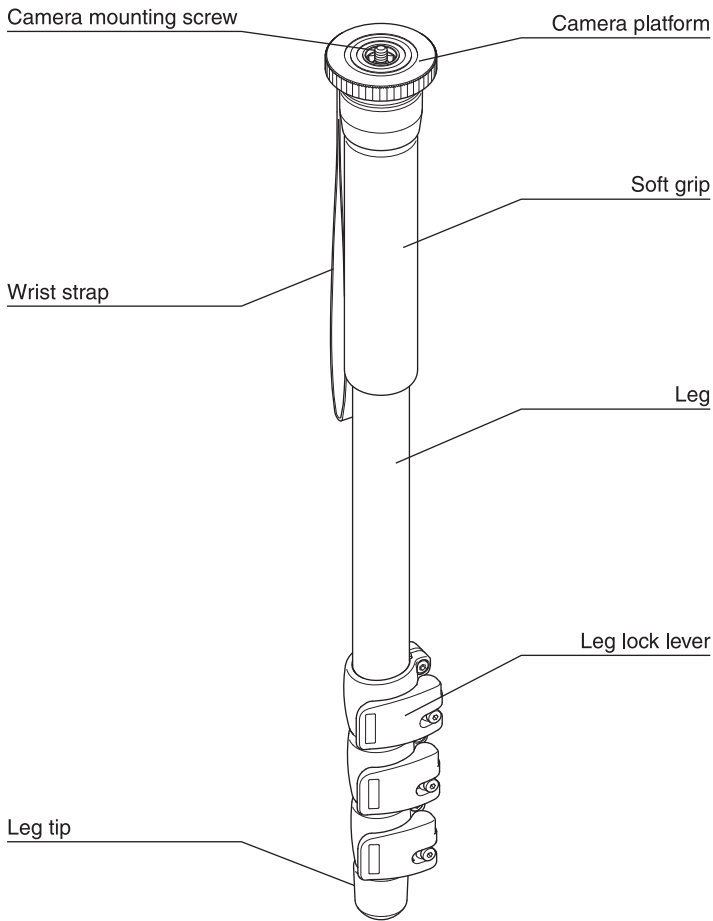

#### ⚠ Caution

- ※Soft grip is consumables. Replace when it is worn out.
- ※Color of the soft grip can be stained. Keep out from objects.

### Optional accessory



Carrying case for monopods.



### In case of the shock given to monopod by force.

#### ⚠ Caution

When the shock has been given to the monopod &/or leg such as falling down, check well whether there are cracks, flaws, etc. on the pipes or not. When you find some cracks, flaws, etc. on the pipes, stop to use it and ask to repair. It may be wounded when some of fibers came out from the pipes. In that case do not touch it.

### Carrying the monopod

#### 🚫 Prohibition



Carrying a monopod with a camera left on can result in unexpected accidents. We recommend you to remove your camera while carrying the monopod.

### Clamp head

#### 🚫 Prohibition

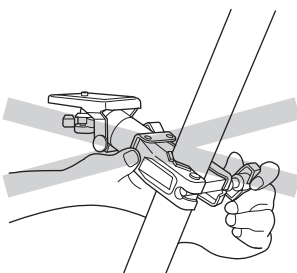

Do not use an optional clamp head for a carbon fiber monopod. The pipe may be damaged.

### Attaching a camera

#### ⚠ Caution

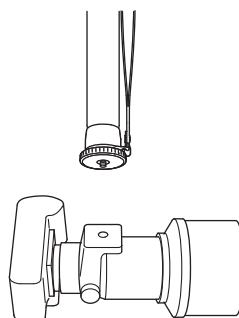

Hold the camera firmly, and screw the monopod into tripod socket. Always check the screw engagement, and rotate the monopod slowly and carefully in the beginning.

### Extending legs

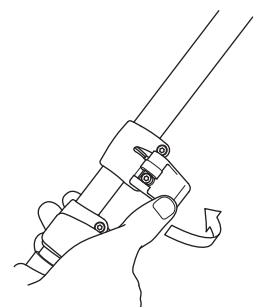

Flip up the leg lock lever to extend or shorten any of the individual leg sections to the desired length and close the leg lock lever.

## Extending legs (Continued)

### ⊘ Prohibition

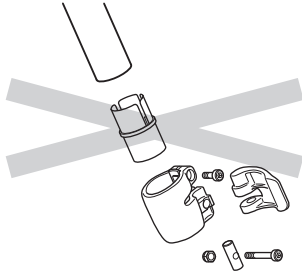

Do not disassemble.  
This may cause accidents.  
In case the section is disassembled, do not assemble by yourself.  
Consult your local dealer for assembling.

## Adjusting lever fixed power

### ⚠ Caution

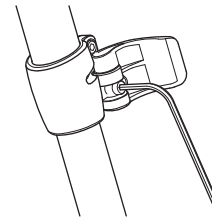

When the lever does not perform enough fixed power, adjust it with an attached Allen wrench.  
Do not over turn the screw. It may break the leg.

## How to change the camera mounting screw

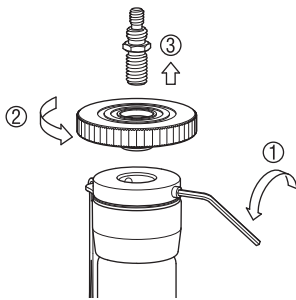

When the Camera mounting is converted to U3/8" screw, remove the fixing screw with an allen wrench.  
Then turn the Camera platform counter-clockwise until the Camera platform and the Camera mounting screw are apart from the body.

### ⚠ Caution

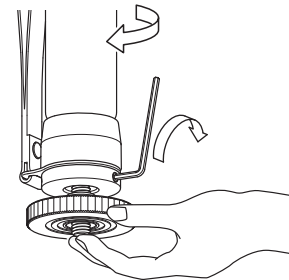

When the Camera platform is attached, make the monopod upside down and turn the monopod body clockwise while holding the Camera platform and the Camera mounting screw.  
The mounting is not done when a space exists between the Camera platform and the Camera mounting screw. Make sure to mount correctly and install the fixing screw with an allen wrench.

## Soft grip

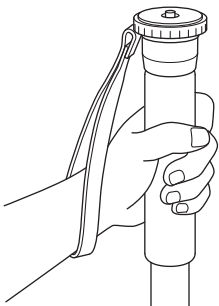

The large soft grip gives you a wide area to grasp and keeps your hands from slipping.  
It also stays warm and easy to work with even in the coldest weather.

## Wrist strap

### ⚠ Caution

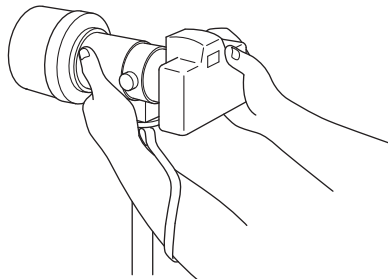

The Wrist strap rotates freely.  
As a safety measure it is advisable to hold the camera through the wrist strap.

## Optional accessory-Ball Head

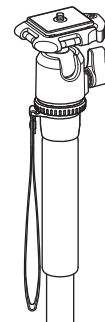

It is recommendable to use this monopod with ball heads (such as the variable ball head, small ball head, etc.) so that your action range of camera will be expanded. Please use it according to your cameras and lenses.

## Care of the Monopod

- DO NOT apply any grease or oil to this product.
- Clean with a mild detergent and a soft cloth only.
- DO NOT use close to flame. Avoid extreme heat.

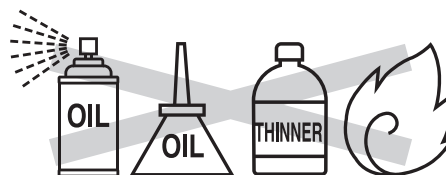

Slik Corporation reserves the right to make changes in design and/or improvements on the products without any obligation and advanced notice.

SLIK CORPORATION

853 Kayama, Hidaka City, Saitama 350-1231 Japan ©2014