

Operating Instructions

Thank you very much for choosing SLIK Carbon Series Tripod. The SLIK Corporation has designed your tripod to be a sturdy, rugged, dependable product that will provide you with many years of satisfactory use. Please take a few moments to read this operating instruction carefully before use so that you can take full advantage of your Tripod's many fine features. Retain this operating instruction in case you might want to refer back to it.

⚠ Caution

This caution icon refers to information pertaining to important safety procedures in preventing injuries, or damages which may occur as a result of mishandling this product.

🚫 Prohibition

This prohibited icon refers to information pertaining to prohibited contents. Please refer to instructions closely to avoid accidents.

Specification

PRO 823CFL
Max. operating height 1,640 mm (64.5in)
Max. center column ext. 320 mm (12.5in)
Folded length 620 mm (24.5in)
Weight 1.810 g (4lbs)

PRO 824CFL
Max. operating height 1,570 mm (61.8in)
Max. center column ext. 320mm (12.5in)
Folded length 505 mm (19.9in)
Weight 1.860 g (4.2lbs)

PRO 723CFL
Max. operating height 1,621 mm (63.8in)
Max. center column ext. 350mm (13.7in)
Folded length 590mm (23.3in)
WeightL 1.570 g (3.5lbs)

PRO 724CFL
Max. operating height 1,576 mm (62in)
Max. center column ext. 325mm (12.7in)
Folded length 496 mm (19.6in)
Weight 1.640 g (3.7lbs)

M852-1

Components

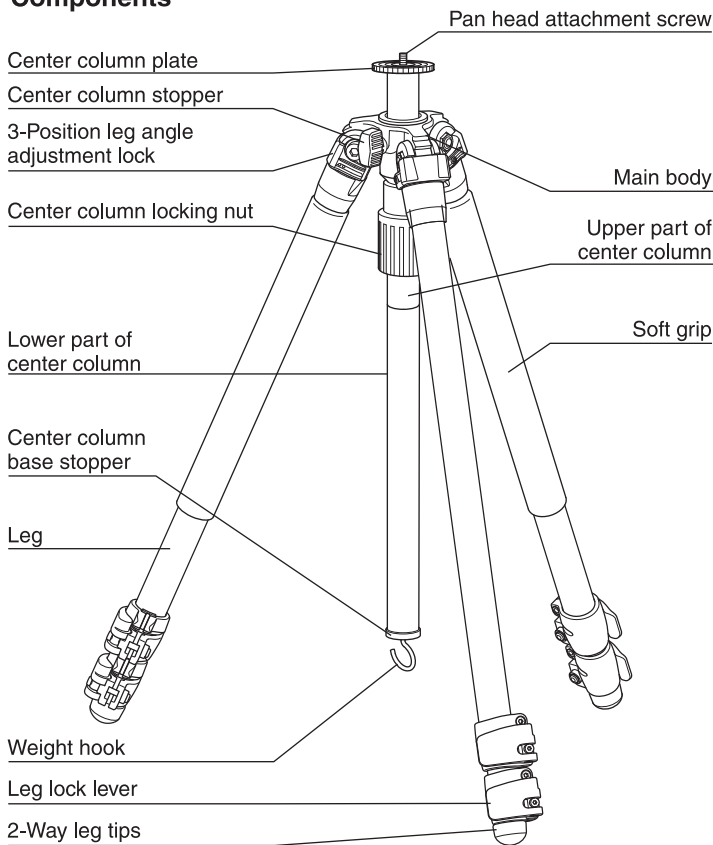

PRO 823CFL

⚠ Caution

- ※Soft grip is consumables. Replace when it is worn out.
- ※Color of the soft grip can be stained. Keep out from objects.

In case of the shock given to tripod by force

⚠ Caution

When the shock has been given to the tripods and legs such as falling down, please check well whether there are cracks, flaws, etc. on the pipes or not. When you find some cracks, flaws, etc. on the pipes, stop to use it and ask to repair. It may be wounded when some of fibers came out from the pipes. In that case do not touch it.

Carrying the tripod

🚫 Prohibition

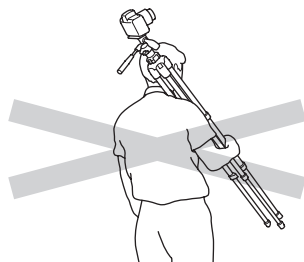

Carrying a tripod with a camera left on can result in unexpected accidents. We, therefore, recommend you to remove your camera while carrying the tripod.

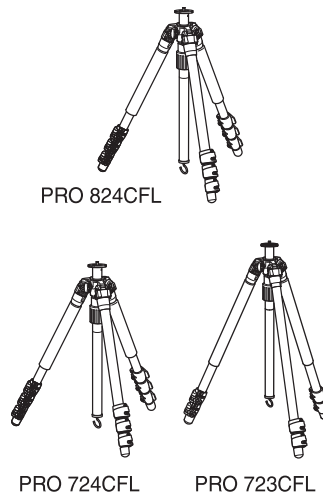

Optional Accessory

SPIKE SET
Cat. NO. 618-410

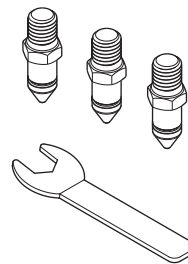

Equipment that can be loaded on this tripod

Maximum loading capacity:

PRO 823CFL : 7kg

PRO 824CFL : 7kg

PRO 723CFL : 5kg

PRO 724CFL : 5kg

Do not exceed the specified loading capacity.

Pan head mounting post

🚫 Prohibition

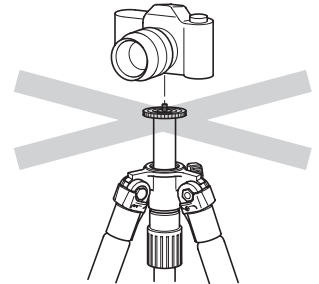

Do not attach a camera directly to the Pan head attachment screw. This may damage both your camera and tripod.

Clamp head

🚫 Prohibition

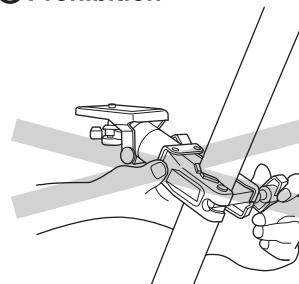

Do not use an optional clamp head for a carbon fiber tripod. The pipe may be damaged.

Setting up

⚠ Caution

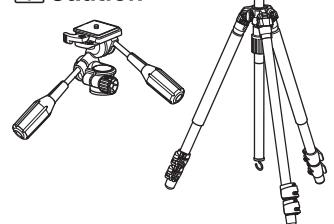

To prevent accidental equipment fall or tripod tipping over, making sure all levers, knobs and handles on the tripod are securely tightened. And all of the three legs are opened all the way.

Head setting

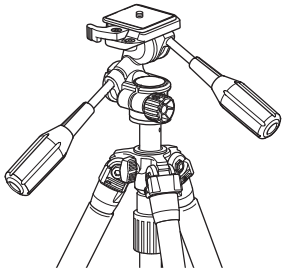

Set the new head or accessory on the pan head attachment screw. And turn the head clockwise until it comes to stop. Tighten the panning lock knob and turn clockwise slightly.

Extending the tripod legs

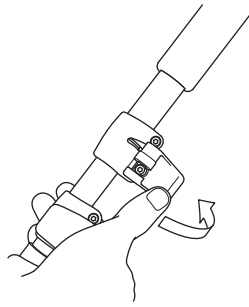

Flip up the leg lock lever to extend or shorten any of the individual leg sections to the desired length and close the leg lock lever.

Adjusting lever fixed power

⚠ Caution

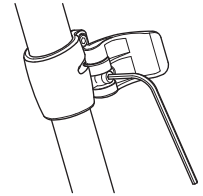

When the lever does not perform enough fixed power, adjust it with an attached Allen wrench. Do not over turn the screw. It may break the leg.

⊘ Prohibition

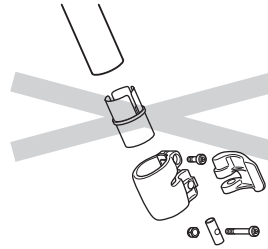

Do not disassemble. This may cause accidents. In case the section is disassembled, do not assemble by yourself. Consult your local dealer for assembling.

Three position adjustable legs

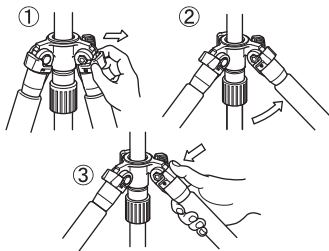

To change the angle of each leg, close the leg slightly, and then pull the leg angle adjustment lock out. There is a choice of two other angle positions. After choosing the desired leg angle, securely push in the adjustment lock.

Operating the center column

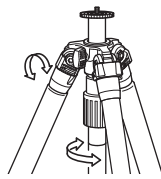

Center column stopper is used to lock or unlock center column. Center column locking nut is used to adjust a tension of the movement. Center column stopper and center column locking nut must be locked for fixing center column.

Inverting the center column

⚠ Caution

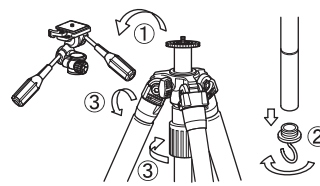

① Remove the pan head.
② Remove the center column base stopper turning to the direction of arrow.
③ Loosen the center column stopper and the center column locking nut, and then pull out the center column.

⚠ Caution

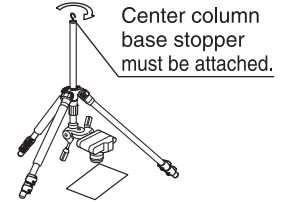

Center column base stopper must be attached. Insert the center column from the lower side of main body. Tighten the center column locking nut and the center column stopper. Make sure to re-attach the center column base stopper in order to prevent the center column from falling out accidentally.

⊘ Prohibition

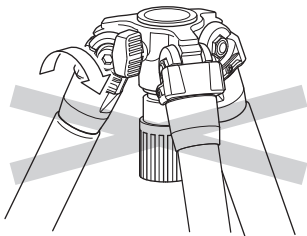

Do not turn the center column stopper while pulling out the center column. The internal parts may be damaged.

How to get low position shots

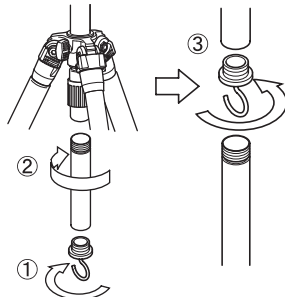

Remove the center column base stopper. Then remove the lower part of center column. Put the center column base stopper in to the upper part of center column.

How to change the leg tips

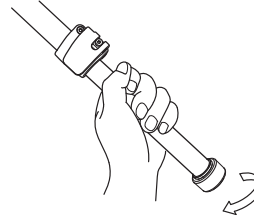

The leg tips can be converted to the spike leg tips. (sold separately) To remove the rubber leg tip, hold the leg pipe tightly and loosen the rubber leg tip.

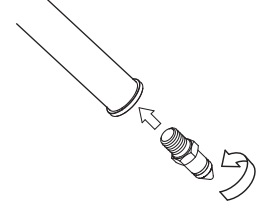

Screw the spike leg tip into the leg pipe by finger tips until it comes stop. Then the spike leg tip must be tightened up with the wrench (comes with SPIKE SET).

⊘ Prohibition

If you hold the leg pipe other than the lowest part, the leg pipe may be damaged. Always use the attached wrench for the conversion. The pipe may be damaged.

How to change the panhead attachment screw

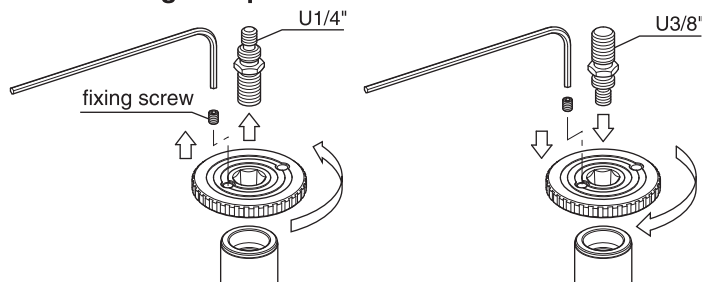

To change the U3/8" screw, loosen the fixing screw with an allen wrench (2.5mm width) and rotate the center column plate to remove from the center column. Then push out the panhead attachment screw from the bottom.

Flip the panhead attachment screw and put back to the center column plate. Screw in the center column plate and the panhead attachment screw. Tighten the fixing screw to avoid the rotating the center column plate while in use.

Care of the tripod

- DO NOT apply any grease or oil to this product.
- Clean with a mild detergent and a soft cloth only.
- DO NOT use close to flame. Avoid extreme heat.

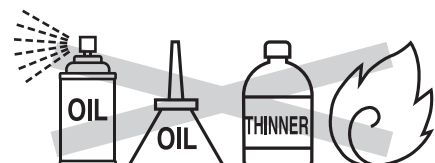

Slik Corporation reserves the right to make changes in design and/or improvements on the products without any obligation and advanced notice.

SLIK CORPORATION

853 Kayama, Hidaka City, Saitama 350-1231 Japan
Phone 81-42-989-2141, Fax. 81-42-985-0210 ©2015