

RAM® GLARE SHIELD & WINDOW CLAMP INSTRUCTIONS

PEEL PAPER FROM RUBBER PAD AND PRESS ONTO MOUNTING BRACKET AS SHOWN. THIS PROTECTS THE BRACKET FROM SCRATCHING OR DAMAGING MOUNTING SURFACE.

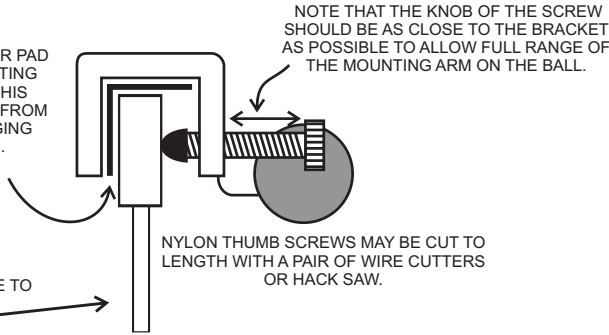

WINDSHIELD WITH FRAME TO ATTACH BRACKET ONTO

NOTE THAT THE KNOB OF THE SCREW SHOULD BE AS CLOSE TO THE BRACKET AS POSSIBLE TO ALLOW FULL RANGE OF THE MOUNTING ARM ON THE BALL.

NYLON THUMB SCREWS MAY BE CUT TO LENGTH WITH A PAIR OF WIRE CUTTERS OR HACK SAW.

IF YOUR WINDSHIELD FRAME LOOKS LIKE THIS YOU WILL NEED TO INSTALL THE SPECIAL RUBBER PAD SUPPLIED AS SHOWN.

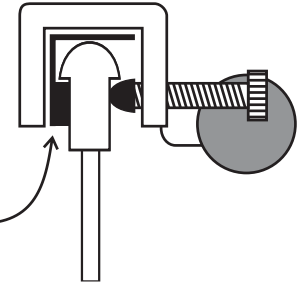

RAM Mounting Systems
8410 Dallas Ave S
Seattle, WA 98108
Phone: (206) 763-8361
Fax: (206) 763-9615
www.rammount.com
support@rammount.com

LIFETIME WARRANTY ON ALL MOUNTING COMPONENTS

The exclusive NPI Lifetime Warranty states that all RAM mounting components and parts are warranted against defect in materials and workmanship for the life of the product or part. NPI's Lifetime Warranty covers the mount or its components only. The mounted device is not covered under the Lifetime Warranty and will not be replaced if damaged as a result of mount failure. This warranty is expressly limited to the persons in the United States, and all foreign countries who purchase RAM for resale or use in the ordinary course of the buyer's business. This warranty does not cover any product or part that has been abused, worn out, heated, ground or otherwise altered, used for a purpose other than that for which it was intended, or used in a manner inconsistent with any instructions regarding its use.



RMR-INS-126

This document, including images, may not be reproduced partly or fully without the expressed written consent of National Products, Inc.

RAM® GLARE SHIELD & WINDOW CLAMP INSTRUCTIONS

PEEL PAPER FROM RUBBER PAD AND PRESS ONTO MOUNTING BRACKET AS SHOWN. THIS PROTECTS THE BRACKET FROM SCRATCHING OR DAMAGING MOUNTING SURFACE.

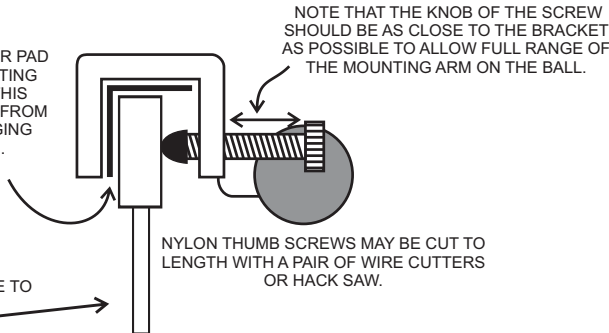

WINDSHIELD WITH FRAME TO ATTACH BRACKET ONTO

NOTE THAT THE KNOB OF THE SCREW SHOULD BE AS CLOSE TO THE BRACKET AS POSSIBLE TO ALLOW FULL RANGE OF THE MOUNTING ARM ON THE BALL.

NYLON THUMB SCREWS MAY BE CUT TO LENGTH WITH A PAIR OF WIRE CUTTERS OR HACK SAW.

IF YOUR WINDSHIELD FRAME LOOKS LIKE THIS YOU WILL NEED TO INSTALL THE SPECIAL RUBBER PAD SUPPLIED AS SHOWN.

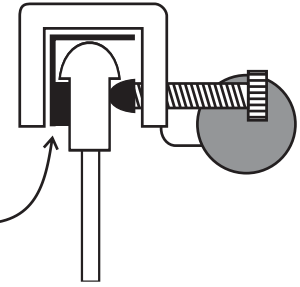

RAM Mounting Systems
8410 Dallas Ave S
Seattle, WA 98108
Phone: (206) 763-8361
Fax: (206) 763-9615
www.rammount.com
support@rammount.com

LIFETIME WARRANTY ON ALL MOUNTING COMPONENTS

The exclusive NPI Lifetime Warranty states that all RAM mounting components and parts are warranted against defect in materials and workmanship for the life of the product or part. NPI's Lifetime Warranty covers the mount or its components only. The mounted device is not covered under the Lifetime Warranty and will not be replaced if damaged as a result of mount failure. This warranty is expressly limited to the persons in the United States, and all foreign countries who purchase RAM for resale or use in the ordinary course of the buyer's business. This warranty does not cover any product or part that has been abused, worn out, heated, ground or otherwise altered, used for a purpose other than that for which it was intended, or used in a manner inconsistent with any instructions regarding its use.



RMR-INS-126

This document, including images, may not be reproduced partly or fully without the expressed written consent of National Products, Inc.

RAM® GLARE SHIELD & WINDOW CLAMP INSTRUCTIONS

PEEL PAPER FROM RUBBER PAD AND PRESS ONTO MOUNTING BRACKET AS SHOWN. THIS PROTECTS THE BRACKET FROM SCRATCHING OR DAMAGING MOUNTING SURFACE.

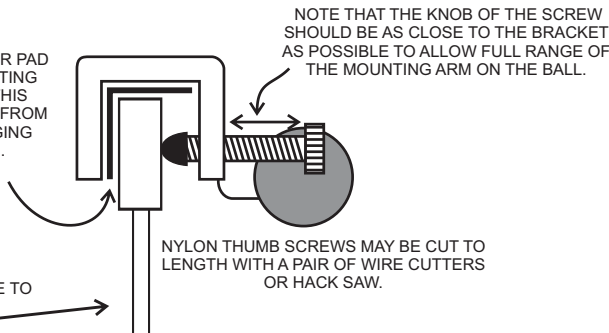

WINDSHIELD WITH FRAME TO ATTACH BRACKET ONTO

NOTE THAT THE KNOB OF THE SCREW SHOULD BE AS CLOSE TO THE BRACKET AS POSSIBLE TO ALLOW FULL RANGE OF THE MOUNTING ARM ON THE BALL.

NYLON THUMB SCREWS MAY BE CUT TO LENGTH WITH A PAIR OF WIRE CUTTERS OR HACK SAW.

IF YOUR WINDSHIELD FRAME LOOKS LIKE THIS YOU WILL NEED TO INSTALL THE SPECIAL RUBBER PAD SUPPLIED AS SHOWN.

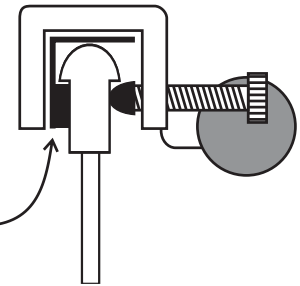

RAM Mounting Systems
8410 Dallas Ave S
Seattle, WA 98108
Phone: (206) 763-8361
Fax: (206) 763-9615
www.rammount.com
support@rammount.com

LIFETIME WARRANTY ON ALL MOUNTING COMPONENTS

The exclusive NPI Lifetime Warranty states that all RAM mounting components and parts are warranted against defect in materials and workmanship for the life of the product or part. NPI's Lifetime Warranty covers the mount or its components only. The mounted device is not covered under the Lifetime Warranty and will not be replaced if damaged as a result of mount failure. This warranty is expressly limited to the persons in the United States, and all foreign countries who purchase RAM for resale or use in the ordinary course of the buyer's business. This warranty does not cover any product or part that has been abused, worn out, heated, ground or otherwise altered, used for a purpose other than that for which it was intended, or used in a manner inconsistent with any instructions regarding its use.



RMR-INS-126

This document, including images, may not be reproduced partly or fully without the expressed written consent of National Products, Inc.