

RAM® BRAKE/CLUTCH RESERVOIR ASSEMBLY INSTRUCTIONS

PARTS INDEX:

- A. RAM® BRAKE/CLUTCH RESERVOIR BASE (QTY. 1)
- B. ½" THICK NYLON SPACER (QTY. 2)
- C. #1/4"-20 X 2" HEX DRIVE MACHINE SCREW (QTY. 2)
- D. 6MM X 55MM HEX DRIVE MACHINE SCREW (QTY. 2)
- E. LOCK WASHERS (QTY. 2)
- F. RAM® 1" BALL WITH #1/4"-20 THREADED HOLE (QTY. 1)
- G. #1/4"-20 X 5/8" FLAT HEAD SCREW (QTY. 1)
- H. EXTERNAL TOOTH LOCK WASHER (QTY. 1)

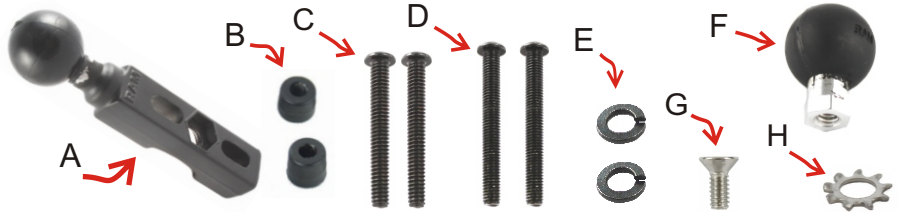

LOCATE THE BRAKE/CLUTCH RESERVOIR ASSEMBLY ON YOUR MOTORCYCLE HANDLEBAR. YOU WILL SEE TWO SCREWS (DEPENDING ON YOUR MOTORCYCLE, THESE SCREWS MAY BE LOCATED BEHIND A PLASTIC OR METAL TRIM. REMOVE THIS TRIM TO EXPOSE SCREW HEADS.) BEFORE REMOVING SCREWS, MARK THE LOCATION OF THIS ASSEMBLY ON THE HANDLEBAR IN CASE THERE IS A NEED TO REINSTALL IT FOR FUTURE USE.

TO INSTALL ADDITIONAL RAM BALL:

1. INSERT (G) SCREW THROUGH (H) TOOTH LOCK WASHER.
2. POSITION (F) RAM BALL INSIDE HEX HOLE OF (A) MOTORCYCLE BASE.
3. THREAD (G) SCREW THROUGH (F) RAM BALL THREADING. TIGHTEN WITH SCREWDRIVER UNTIL (H) TOOTH LOCK WASHER BENDS WITH COUNTERSUNK HOLE BEHIND (A) HANDLEBAR BASE.

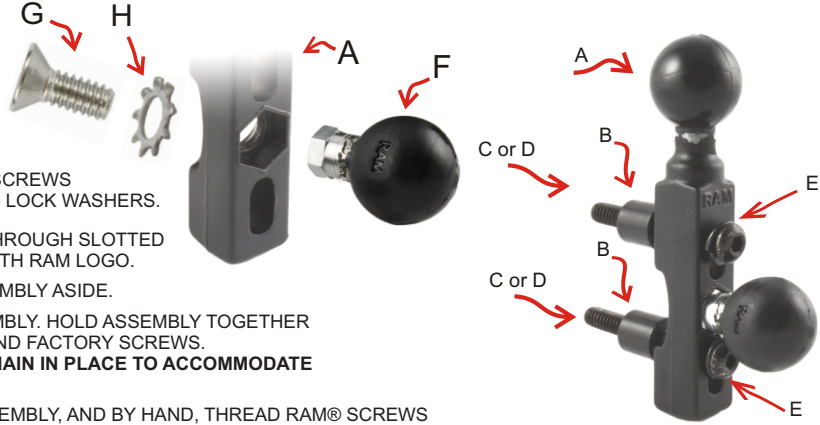

TO INSTALL ASSEMBLY TO MOTORCYCLE:

1. REMOVE ONE OF THE SCREWS AND COMPARE THE THREAD TO (C or D) SCREWS PROVIDED. GATHER THE 2 MATCHING SCREWS, 2 (B) SPACERS, AND 2 (E) LOCK WASHERS.
2. PASS EACH (C or D) SCREW THROUGH (E) LOCK WASHER, AND INSERT THROUGH SLOTTED HOLES OF (A) HANDLEBAR BASE. SCREW HEADS SHOULD BE VISIBLE WITH RAM LOGO.
3. POSITION (B) SPACERS OVER THREADS OF EACH SCREW, AND SET ASSEMBLY ASIDE.

4. REMOVE FINAL SCREW HOLDING YOUR ORIGINAL BRAKE/CLUTCH ASSEMBLY. HOLD ASSEMBLY TOGETHER WHILE REMOVING TO AVOID LOSING COMPONENTS. SET ASIDE CLAMP AND FACTORY SCREWS. **DEPENDING ON THE MOTORCYCLE, FACTORY CLAMP MAY NEED TO REMAIN IN PLACE TO ACCOMMODATE THE LENGTH OF SCREWS IN YOUR RAM MOUNT KIT.**

5. CAREFULLY PICK UP YOUR RAM MOUNT ASSEMBLY, AND BY HAND, THREAD RAM® SCREWS INTO THREADED HOLES OF YOUR BRAKE/CLUTCH RESERVOIR ASSEMBLY.
6. TIGHTEN SCREWS USING ALLEN WRENCH UNTIL RAM MOUNT IS SECURE.
7. STORE ANY UNUSED COMPONENTS OR HARDWARE FOR POSSIBLE FUTURE USE.

RAM Mounting Systems

8410 Dallas Ave S
Seattle, WA 98108
Phone: (206) 763-8361
Fax: (206) 763-9615
www.rammount.com
support@rammount.com



RMR-INS-B-309-2

This document, including images, may not be reproduced partly or fully without the expressed written consent of National Products, Inc.

RAM® BRAKE/CLUTCH RESERVOIR ASSEMBLY INSTRUCTIONS

PARTS INDEX:

- A. RAM® BRAKE/CLUTCH RESERVOIR BASE (QTY. 1)
- B. ½" THICK NYLON SPACER (QTY. 2)
- C. #1/4"-20 X 2" HEX DRIVE MACHINE SCREW (QTY. 2)
- D. 6MM X 55MM HEX DRIVE MACHINE SCREW (QTY. 2)
- E. LOCK WASHERS (QTY. 2)
- F. RAM® 1" BALL WITH #1/4"-20 THREADED HOLE (QTY. 1)
- G. #1/4"-20 X 5/8" FLAT HEAD SCREW (QTY. 1)
- H. EXTERNAL TOOTH LOCK WASHER (QTY. 1)

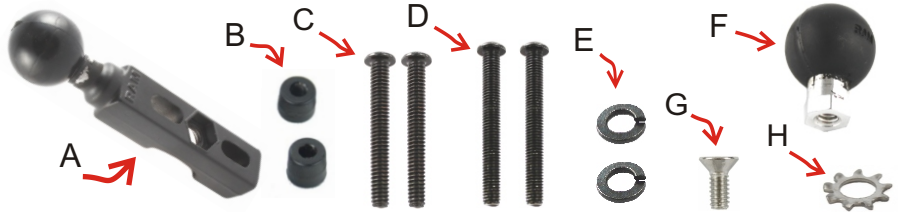

LOCATE THE BRAKE/CLUTCH RESERVOIR ASSEMBLY ON YOUR MOTORCYCLE HANDLEBAR. YOU WILL SEE TWO SCREWS (DEPENDING ON YOUR MOTORCYCLE, THESE SCREWS MAY BE LOCATED BEHIND A PLASTIC OR METAL TRIM. REMOVE THIS TRIM TO EXPOSE SCREW HEADS.) BEFORE REMOVING SCREWS, MARK THE LOCATION OF THIS ASSEMBLY ON THE HANDLEBAR IN CASE THERE IS A NEED TO REINSTALL IT FOR FUTURE USE.

TO INSTALL ADDITIONAL RAM BALL:

1. INSERT (G) SCREW THROUGH (H) TOOTH LOCK WASHER.
2. POSITION (F) RAM BALL INSIDE HEX HOLE OF (A) MOTORCYCLE BASE.
3. THREAD (G) SCREW THROUGH (F) RAM BALL THREADING. TIGHTEN WITH SCREWDRIVER UNTIL (H) TOOTH LOCK WASHER BENDS WITH COUNTERSUNK HOLE BEHIND (A) HANDLEBAR BASE.

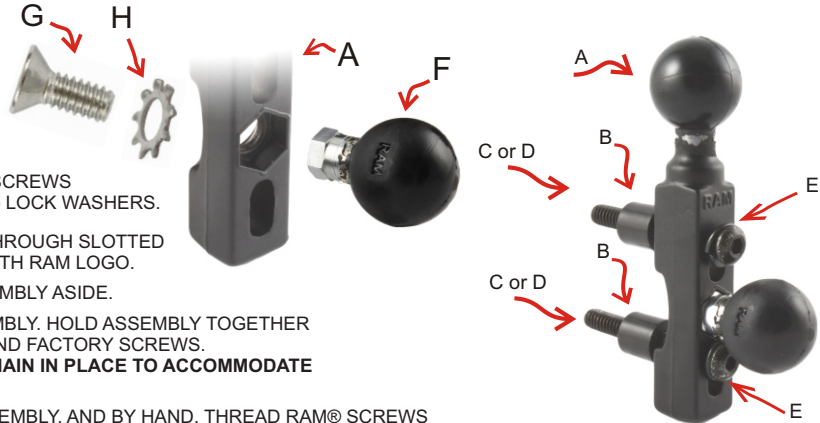

TO INSTALL ASSEMBLY TO MOTORCYCLE:

1. REMOVE ONE OF THE SCREWS AND COMPARE THE THREAD TO (C or D) SCREWS PROVIDED. GATHER THE 2 MATCHING SCREWS, 2 (B) SPACERS, AND 2 (E) LOCK WASHERS.
2. PASS EACH (C or D) SCREW THROUGH (E) LOCK WASHER, AND INSERT THROUGH SLOTTED HOLES OF (A) HANDLEBAR BASE. SCREW HEADS SHOULD BE VISIBLE WITH RAM LOGO.
3. POSITION (B) SPACERS OVER THREADS OF EACH SCREW, AND SET ASSEMBLY ASIDE.

4. REMOVE FINAL SCREW HOLDING YOUR ORIGINAL BRAKE/CLUTCH ASSEMBLY. HOLD ASSEMBLY TOGETHER WHILE REMOVING TO AVOID LOSING COMPONENTS. SET ASIDE CLAMP AND FACTORY SCREWS. **DEPENDING ON THE MOTORCYCLE, FACTORY CLAMP MAY NEED TO REMAIN IN PLACE TO ACCOMMODATE THE LENGTH OF SCREWS IN YOUR RAM MOUNT KIT.**

5. CAREFULLY PICK UP YOUR RAM MOUNT ASSEMBLY, AND BY HAND, THREAD RAM® SCREWS INTO THREADED HOLES OF YOUR BRAKE/CLUTCH RESERVOIR ASSEMBLY.
6. TIGHTEN SCREWS USING ALLEN WRENCH UNTIL RAM MOUNT IS SECURE.
7. STORE ANY UNUSED COMPONENTS OR HARDWARE FOR POSSIBLE FUTURE USE.

RAM Mounting Systems

8410 Dallas Ave S
Seattle, WA 98108
Phone: (206) 763-8361
Fax: (206) 763-9615
www.rammount.com
support@rammount.com



RMR-INS-B-309-2

This document, including images, may not be reproduced partly or fully without the expressed written consent of National Products, Inc.

CONNECT ANY DEVICE TO YOUR MOTORCYCLE!



P/N: **RAM-B-132BU**
RAM® SELF-LEVELING
DRINK CUP HOLDER



P/N: **RAM-HOL-UN7BU**
RAM® X-Grip® UNIVERSAL
PHONE HOLDER



P/N: **RAP-B-202U-GOP1**
RAM® BALL ADAPTER FOR
GOPRO® HERO SERIES



MODEL SPECIFIC GPS
CRADLES
(PART NUMBERS VARY)



P/N: **RAM-HOL-AQ7-2COU**
RAM AQUA BOX® PRO 20
WEATHERPROOF PHONE CASE



P/N: **RAM-B-201U**
STANDARD DOUBLE SOCKET ARM
OVERALL LENGTH 3 11/16"



P/N: **RAM-B-201U-A**
SHORT DOUBLE SOCKET ARM
OVERALL LENGTH 2 7/16"



P/N: **RAM-B-201U-C**
LONG DOUBLE SOCKET ARM
OVERALL LENGTH 6"



P/N: **RAP-B-200-12U**
DOUBLE SOCKET SWIVEL ARM
OVERALL LENGTH 4 1/4"



P/N: **RAM-B-230U**
1" DOUBLE BALL ADAPTER
CONNECTS ANY TWO
DOUBLE SOCKET ARMS

HUNDREDS OF OTHER COMPONENTS FOR YOUR MOTORCYCLE CAN BE FOUND AT WWW.RAMMOUNT.COM
SUGGESTED SEARCH TERM: "B Components"

RAM Mounting Systems
8410 Dallas Ave S
Seattle, WA 98108
Phone: (206) 763-8361
Fax: (206) 763-9615
www.rammount.com
support@rammount.com

Your RAM® motorcycle ball base can be configured and customized with any other RAM® Mount components. By selecting any B-size double socket arm and any device holder, you can get the best motorcycle experience with the ability to mount virtually anything anywhere! All RAM Mount components are made in the USA and backed with a Lifetime Warranty.



This document, including images, may not be reproduced partly or fully without the expressed written consent of National Products, Inc.

CONNECT ANY DEVICE TO YOUR MOTORCYCLE!



P/N: **RAM-B-132BU**
RAM® SELF-LEVELING
DRINK CUP HOLDER



P/N: **RAM-HOL-UN7BU**
RAM® X-Grip® UNIVERSAL
PHONE HOLDER



P/N: **RAP-B-202U-GOP1**
RAM® BALL ADAPTER FOR
GOPRO® HERO SERIES



MODEL SPECIFIC GPS
CRADLES
(PART NUMBERS VARY)



P/N: **RAM-HOL-AQ7-2COU**
RAM AQUA BOX® PRO 20
WEATHERPROOF PHONE CASE



P/N: **RAM-B-201U**
STANDARD DOUBLE SOCKET ARM
OVERALL LENGTH 3 11/16"



P/N: **RAM-B-201U-A**
SHORT DOUBLE SOCKET ARM
OVERALL LENGTH 2 7/16"



P/N: **RAM-B-201U-C**
LONG DOUBLE SOCKET ARM
OVERALL LENGTH 6"



P/N: **RAP-B-200-12U**
DOUBLE SOCKET SWIVEL ARM
OVERALL LENGTH 4 1/4"

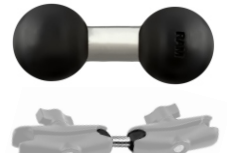

P/N: **RAM-B-230U**
1" DOUBLE BALL ADAPTER
CONNECTS ANY TWO
DOUBLE SOCKET ARMS

HUNDREDS OF OTHER COMPONENTS FOR YOUR MOTORCYCLE CAN BE FOUND AT WWW.RAMMOUNT.COM
SUGGESTED SEARCH TERM: "B Components"

RAM Mounting Systems
8410 Dallas Ave S
Seattle, WA 98108
Phone: (206) 763-8361
Fax: (206) 763-9615
www.rammount.com
support@rammount.com

Your RAM® motorcycle ball base can be configured and customized with any other RAM® Mount components. By selecting any B-size double socket arm and any device holder, you can get the best motorcycle experience with the ability to mount virtually anything anywhere! All RAM Mount components are made in the USA and backed with a Lifetime Warranty.



This document, including images, may not be reproduced partly or fully without the expressed written consent of National Products, Inc.