

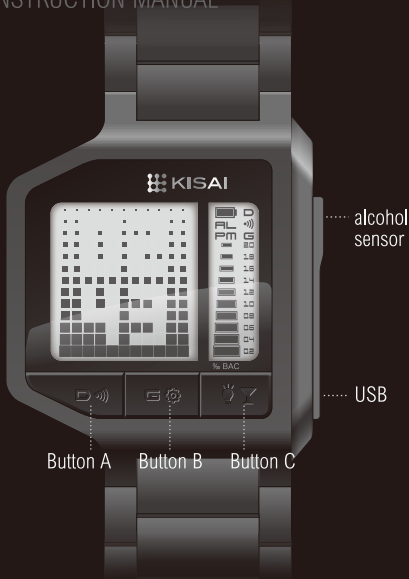

Change the way you think about time

INTOXIQA3

INSTRUCTION MANUAL



1. How to read the time

- This watch uses an LCD “always on” display to show the time.
- You can illuminate the display for a short time with the LED backlight by pressing button C.
- The time in hours and minutes is displayed digitally on the screen.

Example

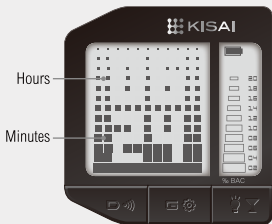
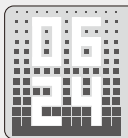

06:24

2. How to read the date

- Press button A to display the date.
- The date icon  indicates that you are in date mode.
- You can illuminate the display for a short time with the LED backlight by pressing button C.
- The date is displayed digitally with the month in the upper half of the screen and date in the lower half of the screen.
- The display will change back to time mode after a short time.

Example

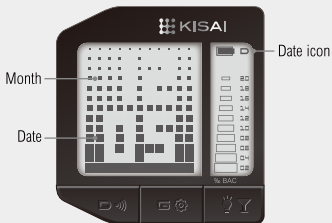

December 5th

3. How to check the alarm time

- Press button A twice to display the alarm time.
(see example below)
- The alarm mode icon **AL** indicates that you are in alarm mode. The alarm on icon **🔊** indicates that the alarm is on.
- When the alarm sounds, you can turn it off by touching any button.

Example



07:30 alarm on

4. How to set the date and time

- Press and hold button B for 3 seconds to enter setting mode.
*Note after 10 seconds of inactivity setting mode will deactivate

I. Setting the year

- The year digits will flash when you are in year setting mode.
- The date icon indicates that you are in date setting mode.
- Press button A to increase the year as required.
- Press button B to confirm and move to the month.

II. Setting the month

- The month digits will flash when you are in month setting mode.
- The date icon indicates that you are in date setting mode.
- Press button A to increase the month as required.
- Press button B to confirm and move to the date.

III. Setting the date

- The date digits will flash when you are in date setting mode.
- The date icon indicates that you are in date setting mode.
- Press button A to increase the date as required.
- Press button B to confirm and move to the hour.

IV. Setting the hour

- The hour digits will flash when you are in hour setting mode.
- The PM icon **PM** in setting mode indicates that you are setting the time in PM.
- Press button A to increase the hour as required.
- Press button B to confirm and move to the minutes.

V. Setting the minutes

- The minute digits will flash when you are in minute setting mode.
- Press button A to increase the minutes as required.
- Press button B to confirm and exit setting mode.

Example



09:48 PM

5. How to set the alarm

- Press button A twice to display the alarm time and then hold button B for 3 seconds to enter alarm setting mode.
*Note after 10 seconds of inactivity setting mode will deactivate
- The alarm mode icon will be displayed.
- Press button A to turn the alarm on or off. The alarm on icon indicates that the alarm is on.
- Press button B to confirm and move to the hours.
- Press button A to increase the hour as required.
- Press button B to confirm and move to the minutes.
- Press button A to increase the minutes as required.
- Press button B to confirm and exit alarm setting mode.

Example

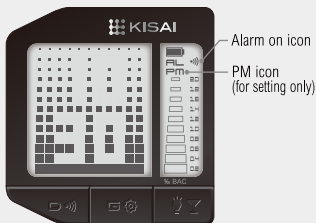

10:30 PM alarm on

6. How to recharge the battery

- This watch uses a PL352323 USB rechargeable battery.
- If the Battery Indicator Icon  starts blinking, please recharge the battery.
- To recharge the battery, gently open the lower side of the sensor cap and first connect the USB charging cable to the USB charging jack on the watch.
- Connect the charging cable to a power source, e.g. your computer.
- When charging, the Battery Indicator will blink.
- When the Battery Indicator stops blinking, the battery is 90% charged.

*It is advised that you continue to charge the battery for a full 4 hours to ensure the battery is 100% charged.

*The alcohol test needs more power than the normal watch functions. So if the power is low when starting a test, the Battery Indicator may blink to show there is not enough power to complete the test.



7. How to check alcohol level

The watch can estimate your Blood Alcohol level from a breath sample. (Breathalyser) To perform the test:

- Gently open the upper side of the sensor cap. Please take care not to remove the whole cap.
- Press and hold button C for 3 seconds to start the alcohol test mode.

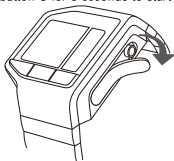

- The alcohol sensor will warm up ready for the test and the display will show a shutter animation.
- After warming up is finished, the display will show a count down to begin blowing.
- The display will then show arrows to indicate you need to blow in the sensor now.

*sensor-to-mouth distance : 20mm (take care not to spit in the sensor)



Arrows indicate "Blow now"

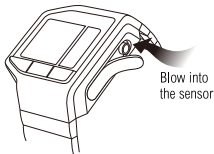

- Continue blowing until the arrows stop animating (about 5 seconds)
- For best results, take a break from drinking alcohol before taking the test. Alcohol in your mouth will give a false score.
- Test results are shown in the right side window on the watch display.

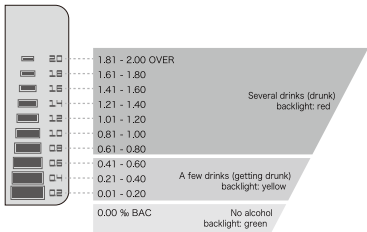

Example



0.00 % BAC
No alcohol
Backlight: Green



0.41-0.60 % BAC
Getting drunk
Backlight: Yellow



1.21-1.40 % BAC
Drunk
Backlight: Red

8. How to play the game

The watch includes a sobriety game to test your reaction time. A vertical bar will move left & right on the display, the aim is to stop the bar when it is in the centre position.

- Press button B to start the game.
- The bar will start moving left & right.
- Press button B again to stop the bar.
- You need to stop the bar at center position.

*Note: after finishing the game the watch will return to time mode.

Example



Game indicator

Perfect! Not drunk.
Backlight: Green



Moving bar

Center point

Almost
Getting drunk
Backlight: Yellow



Oops! Drunk
Backlight: Red

9. User information

I. Battery

- This watch use a PL352323 USB rechargeable battery only.
- Battery lifetime will vary depending on use, but is estimated at approximately 300 charges.
- To maximise battery charge, you should limit the use of the LED backlight and alcohol test.
- The plug standard input voltage for the PL352323 USB battery is DC3.7V. You should use only the cable provided with the watch when recharging.

II. Warranty

- This watch is covered by a 1 year warranty. This warranty does not cover water damage, accidental damage, neglect or unauthorized repair.

III. Caution

- This watch has limited resistance to water. Please do not use the watch in the shower, for swimming or for other water related activities.
- Items included in the box:
 - Watch
 - USB cable
 - Instruction Manual

SPECIFICATIONS

| | |
|------------------------|-------------------------------|
| Case Materials | ABS |
| Strap Materials | Silicone |
| Case Dimensions | 42 x 58 x 16 mm |
| Finish | Matte |
| Maximum Fit Wrist Size | 220mm (approx.) |
| Weight | 65g |
| Display | LCD with LED backlight |
| Battery | PL352323 rechargeable battery |

“This watch is designed for entertainment only. The retailer does not warrant that the results obtained from this breathalyzer will be completely accurate or reliable and accepts no liability for consequences arising from its use. Please remember do not drink and drive under any circumstance.”

