

15 Amp Portable EV Charger

USER MANUAL



Contents

| | |
|-----------------------------|---|
| Safety Precautions | 2 |
| What's Included | 3 |
| How to Install | 4 |
| LED Indicators | 4 |
| LED Status | 5 |
| Charging Your Vehicle | 5 |
| Troubleshooting | 7 |
| Specifications | 8 |
| Get More Support | 9 |

Safety Precautions

- It is recommended that electrical outlets for your charger should be installed by a licensed and qualified electrician. To avoid serious injury or death, installation must comply with the provisions of the National Electric Code (NEC) and all local codes. If there are conflicts between local codes and the NEC, local codes shall take precedence.
- This product must be grounded. In case of a malfunction or breakdown, grounding can help reduce the risk of electric shock. This product includes a cord that is equipped with a grounding conductor and a grounding plug. The plug must be inserted into an appropriate outlet that is properly installed and grounded in accordance with all local codes and ordinances.
- **SHOCK HAZARD** - Make sure the plug is fully inserted into the wall outlet to avoid any exposed metal surfaces.
- Do not leave children unattended or unsupervised around chargers or other power outlets or devices.
- **DO NOT DROP THE CHARGER OR HANDLE.**
- If the output plug is separated from the charger module or the charging handle, **DO NOT ATTEMPT TO REPAIR THE CABLE YOURSELF.** For assistance, contact Customer Service at: contact@ev-lectron.com
- When using your charger, basic precautions should always be followed, including:
 - Read warnings on the charger-cord label before operating the charger for the first time.
 - Read all instructions in this guide before using the charger.
 - Never use the charger with non-approved power adapters or other power components.

What's Included

15 Amp portable EV charger



LED status light

Cable (16 ft)

- POWER
- CONNECT
- CHARGING
- ERROR

Charging handle (J1772)

Release button

| Compatibility | |
|---|---|
|  |  |
| NEMA 5-15 (120 V) | J1772 Plug |

How to Install

- 1. Insert the screw into the wall then hang up the device.

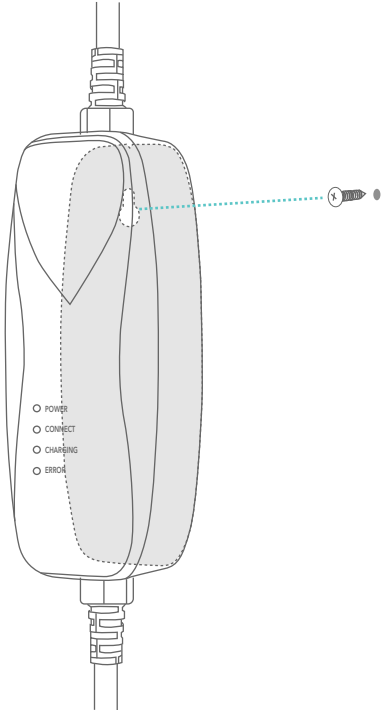

LED Indicators

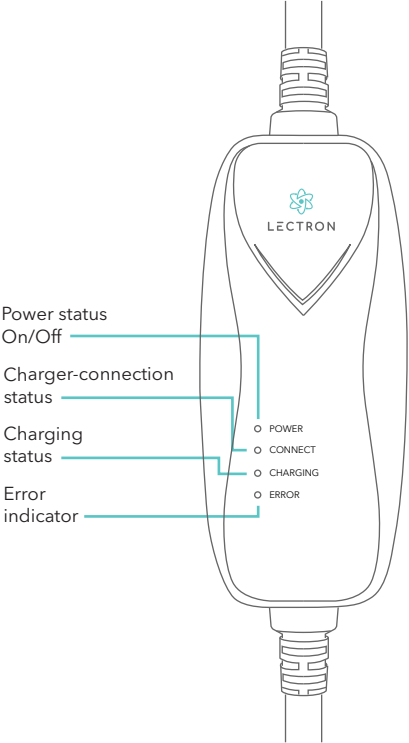

LED Status

| Function Status | LED Status | | | |
|-------------------------------|-----------------------------|----------------|------------------|----------------|
| | Power (red) | Connect (blue) | Charging (green) | Error (yellow) |
| LED displays | On - ● Flashing - ● Off - ○ | | | |
| Normal status light | ● | ● | ● | ● |
| Has power, not connected | ● | ○ | ○ | ○ |
| Connected, not charging | ● | ● | ○ | ○ |
| Charging | ● | ● | ● | ○ |
| Charging complete | ● | ● | ● | ○ |
| Communication error | ● | ● | ○ | ● |
| Surge-voltage protection | ● | ○ | ○ | ● |
| Low-voltage protection | ● | ○ | ○ | ● |
| Surge-current protection | ● | ● | ● | ○ |
| Leakage protection | ● | ● | ● | ● |
| High-temperature protection | ● | ● | ● | ● |
| Current fault / short circuit | ● | ● | ● | ● |
| Ground fault | ● | ○ | ● | ● |

Charging Your Vehicle

NOTE: Ensure your car is parked and the engine is turned **OFF**.

1. Insert the charger into an appropriate wall outlet.

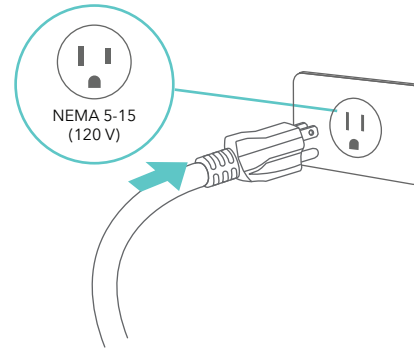

2. The Power and Connected lights will light up and stay solid, which means the charger is receiving AC power and is ready for use.

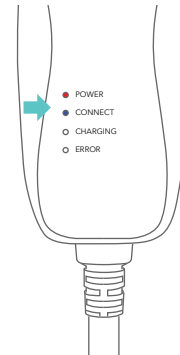

3. Plug the charging handle into your vehicle's charging outlet until it clicks. Once latched, the charging handle will not disengage until you press the release button.

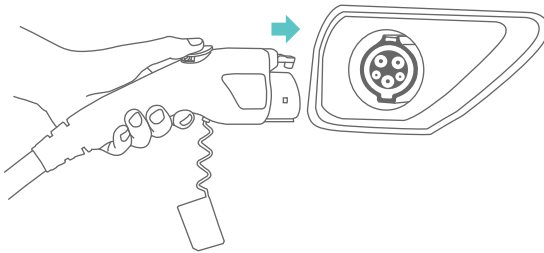

4. Charging begins automatically. Power will be delivered in accordance to the demand of your vehicle. While charging, the Charging Indicator will continuously blink. Always verify your vehicle-charging status by checking the vehicle panel.

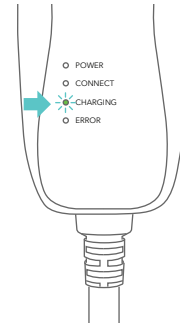

5. When your vehicle is fully charged, the Charging Indicator light will stay solid. Your vehicle has a "dashboard gauge", which also shows if your vehicle is fully charged. Refer to your vehicle user manual to find the location of the gauge on the dashboard.

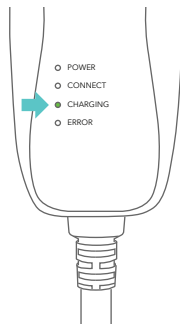

6. Disconnect the charger when the charge is completed by pressing the release button on the charging handle and separating it from your vehicle.

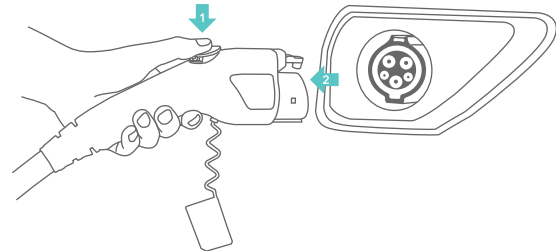

NOTE: The charger requires a 120 V AC split phase. It draws a maximum of 15 Amps of continuous current.

Troubleshooting

Please refer to this troubleshooting guide to fix common charging errors or while using the portable charger.

| Problem | Possible Cause | Solution |
|--|---|---|
| Charging Indicator does not illuminate | No power to the charger. | <ol style="list-style-type: none"> 1. Check the circuit breaker and other circuit loads. 2. Try another wall outlet. 3. Ensure that the charger module (and adapter if operating in 120 V AC mode) is fully inserted into the wall outlet. |
| | | Contact Lectron Customer Support at contact@ev-lectron.com for assistance. |
| Vehicle will not charge | Charging handle is not properly inserted into the vehicle. | <ol style="list-style-type: none"> 1. Inspect the charging handle. 2. Remove the charging handle from the vehicle, then reinsert it into the vehicle outlet until it clicks. |
| | Vehicle cannot accept any charge. | Verify that the vehicle charge timer is set to permit charging. Refer to the vehicle user manual for charge timer instructions. |
| | Communication error between the charger and vehicle. | Contact Lectron Customer Support at contact@ev-lectron.com for assistance. |
| | Above the temperature limit. Cases: <ol style="list-style-type: none"> 1. Temperature is too high. The charger will restart charging when it cools down. 2. House/socket wiring may be faulty. | <ol style="list-style-type: none"> 1. Inspect the charger module for overheating: <ol style="list-style-type: none"> a. Carefully unplug the charger module from the wall outlet and allow it to cool. b. If the problem continues, contact Lectron Customer Support at contact@ev-lectron.com for assistance. 2. Disconnect the charger from the wall outlet. 3. Have a qualified electrician inspect the wall outlet and adapter. |
| Error Indicator is blinking rapidly | Utility fault. | <ol style="list-style-type: none"> 1. Disconnect the charger module from the wall outlet and reconnect it. 2. If the problem continues, have a qualified electrician inspect the ground circuit of the wall outlet. |

Specifications

| | |
|-----------------------------------|---|
| Rated current: | 15 Amp |
| Input/output: | 120 V AC |
| Frequency: | 50/60 Hz |
| Cable length: | 16 ft (5 m) |
| Plug: | NEMA 5-15 |
| EV charging handle: | SAE J1772 |
| Dimensions: | 8.1 x 3.2 x 1.6 in (208 x 82 x 42.3 mm) |
| Weight: | 5.3 lbs (2.4 kg) |
| Operating temperature: | -22 °F to +122 °F (-30 °C to +50 °C) |
| Material: | PC |
| Control-box water resistance: | IP65 |
| Charging handle water resistance: | Type 3R |
| Reference standard: | UL2594, UL2251, SAE J1772, UL2231 |



Get More Support

Scan the QR code below or email us at contact@ev-lectron.com

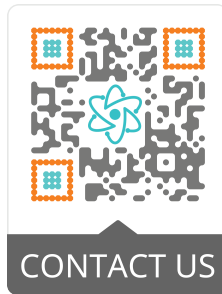

LĒCTRON

www.ev-lectron.com

Made in China