



CHRIS KING

PRECISION COMPONENTS

Bottom Bracket Fit Kits

Congratulations! Since 1976, Chris King has been supplying cyclists with the best made, most reliable components in the market. With proper installation and maintenance, you will enjoy many years of exceptional performance from the legendary quality built into each one of our components.

Our bottom bracket spindle sleeves ensure that our precise, made-in-house bearings mate perfectly with your chosen crank's spindle and reduce the chance of unwanted noise and premature wear.

Fit Kit Installation

1. Apply a thin layer of grease to the spindle sleeves.
2. Press the spindle sleeves into the bearings. The spindle sleeves are designed to have a snug fit and will hand-press into the bottom bracket bearings.
3. Refer to the chart on the following pages that corresponds to your Chris King Fit Kit and install the 1.0mm and 0.5mm spindle spacers onto the crank spindle as needed to achieve the spacing listed.

Crank Installation

1. Clean crank spindle and apply a thin layer of grease to spindle surface. We recommend Chris King Blue Grease.
2. Insert spindle into the bottom bracket using only hand pressure. Use of excessive force may cause bearing to separate.
3. Be sure spindle is properly aligned with bottom bracket bearing spindle sleeve. Follow crank arm manufacturer's installation instructions to properly install crank assembly and achieve optimal BB bearing preload.
4. Check for bearing play (i.e. proper bearing preload) by pushing/pulling the crank arm toward/away from the frame. **If you have issues achieving proper bearing adjustment please contact Chris King customer service at 800.523.6008 or info@chrisking.com.**
5. Periodically check bearing adjustment during the initial break in period, the first 100 hours of use. Keeping optimal preload on bottom bracket bearings will maximize their longevity. **DO NOT RIDE WITH LOOSE BEARING ADJUSTMENT.**

Questions?

E-mail us at info@chrisking.com or call 800-523-6008.

Replacement parts available through any authorized Chris King dealer, or at www.chrisking.com.

Fit Kit - General Parts Identification

Spindle Spacer
WHITE
Plastic
0.33mm

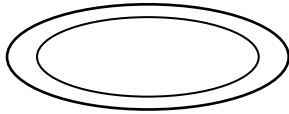

Spindle Spacer
BLACK
Plastic
0.5mm and 1mm

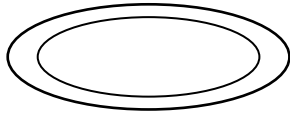

Cup Spacer
BLACK
Metal

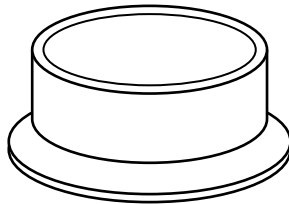
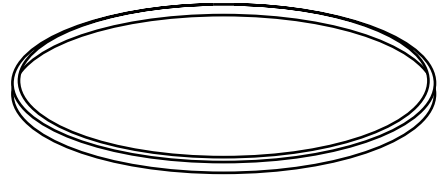

Spindle Sleeve
BLACK
Plastic

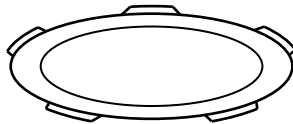

Disc Spring
GRAY
Metal

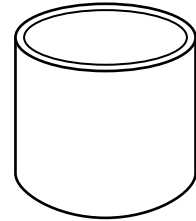

GXP Adapter Sleeve
SILVER
Metal

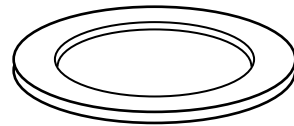

Stepped Washer
SILVER
Metal

Fit Kit 1

Bottom Bracket Type - ThreadFit™ 30, T47 30i, T47 30x

Crank Type - DUB 28.99mm spindle

Road	Frame Shell Width (mm)	Non-Drive Side Spindle Spacers (mm)	Left BB Cup Spacers (mm)	Right BB Cup Spacers (mm)	Drive Side Spindle Spacers (mm)
ThreadFit™ T47 30x	68	-	-	-	3
ThreadFit™ T47 30i	85.5 (Trek)	1	-	-	4.5
	86.5	0.5	-	-	4

Mountain	Frame Shell Width (mm)	Non-Drive Side Spindle Spacers (mm)	Left BB Cup Spacers (mm)	Right BB Cup Spacers (mm)	Drive Side Spindle Spacers (mm)
ThreadFit™ 30	68	-	2.5 (see footnote)	2.5 (see footnote)	4.5
	73	-	-	-	4.5
	73 SB+	4.5	-	-	9 (see footnote)
ThreadFit™ T47 30x	68	-	2.5 (see footnote)	2.5 (see footnote)	4.5
	73	-	-	-	4.5
	73 SB+	4.5	-	-	9 (see footnote)
ThreadFit™ T47 30i	92	1.5	-	-	4
	92 SB+	6	-	-	8.5 (see footnote)

* Additional Cup Spacers for Threadfit30 (Part Code: PBB008B) and for T47 (PBB078B).

And 86.5/92mm T47 30i Center Sleeves (PBB092), and additional Spindle Spacers (PBB081) required.

Fit Kit 2

Bottom Bracket Type - ThreadFit™ 30

Crank Type - DUB 28.99mm spindle

Road	Frame Shell Width (mm)	Non-Drive Side Spindle Spacers (mm)	Left BB Cup Spacers (mm)	Right BB Cup Spacers (mm)	Drive Side Spindle Spacers (mm)
ThreadFit™ 30	68	-	-	-	3

Fit Kit 3

Bottom Bracket Type - ThreadFit™ 30

Crank Type - 30mm spindle

Note: 30mm crankset spindles come in a variety of lengths depending on the crankset manufacturer and model. The simplest way to find your fitment is to measure the bottom bracket you are replacing, while it is mounted on the frame. If the bottom bracket you are replacing had dust covers, measure the bottom bracket with them installed. Compare that measurement to the following sizes to determine your fitment; Road Narrow: 88.4mm, Road Wide: 91.0mm, Mountain Narrow: 95.9mm, Mountain Wide: 98.5mm

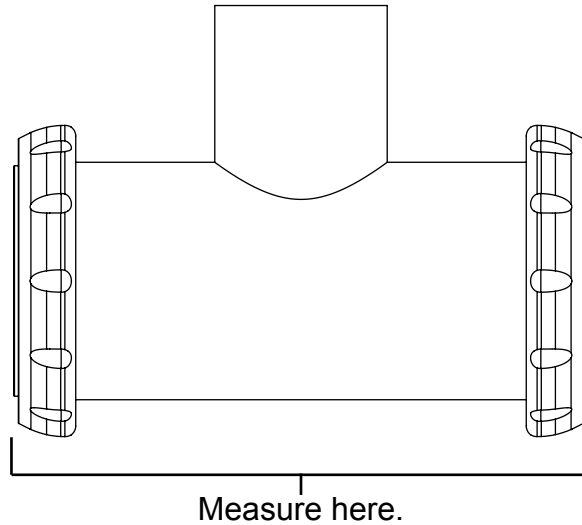

Road	Frame Shell Width (mm)	Non-Drive Side Spindle Spacers (mm)	Left BB Cup Spacers (mm)	Right BB Cup Spacers (mm)	Drive Side Spindle Spacers (mm)
ThreadFit™ 30 Narrow	68	-	-	-	-
ThreadFit™ 30 Wide	68	1	-	-	1

Mountain	Frame Shell Width (mm)	Non-Drive Side Spindle Spacers (mm)	Left BB Cup Spacers (mm)	Right BB Cup Spacers (mm)	Drive Side Spindle Spacers (mm)
ThreadFit™ 30 Narrow	68	-	2.5	5	-
	73	-	-	2.5	-
ThreadFit™ 30 Wide	68	1	2.5	5	1
	73	1	-	2.5	1

Fit Kit 4

Bottom Bracket Type - ThreadFit™ 24, T47 24x, T47 24i

Crank Type - 24mm spindle

Note: 85.5mm and 86.5mm bottom bracket shell widths are compatible with BB86 type cranksets. 92mm bottom bracket shell widths are compatible with BB92 type cranksets.

Road	Frame Shell Width (mm)	Non-Drive Side Spindle Spacers (mm)	Left BB Cup Spacers (mm)	Right BB Cup Spacers (mm)	Drive Side Spindle Spacers (mm)
ThreadFit™ 24	68	1	-	-	1
ThreadFit™ T47 24x	68	1	-	-	1
ThreadFit™ T47 24i	85.5 (Trek)	0.5	-	-	0.5
	86.5	-	-	-	-

Mountain	Frame Shell Width (mm)	Non-Drive Side Spindle Spacers (mm)	Left BB Cup Spacers (mm)	Right BB Cup Spacers (mm)	Drive Side Spindle Spacers (mm)
ThreadFit™ 24	68	2.5	-	-	5 (see footnote)
	73	-	-	-	2.5
ThreadFit™ T47 24x	68	2.5	-	-	5 (see footnote)
	73	-	-	-	2.5
	100	-	-	-	-
ThreadFit™ T47 24i	92	-	-	-	-

* Due to the longer length of spindle in this application, additional spacers need to be purchased part number PBB015

Fit Kit 5

Bottom Bracket Type - ThreadFit™ T47 30x, T47 30i

Crank Type - 30mm spindle

Note: 30mm crankset spindles come in a variety of lengths depending on the crankset manufacturer and model. The simplest way to find your fitment is to measure the bottom bracket you are replacing, while it is mounted on the frame. If the bottom bracket you are replacing had dust covers, measure the bottom bracket with them installed. Compare that measurement to the following sizes to determine your fitment; Road Narrow: 88.4mm, Road Wide: 91.0mm, Mountain Narrow: 95.9mm, Mountain Wide: 98.5mm

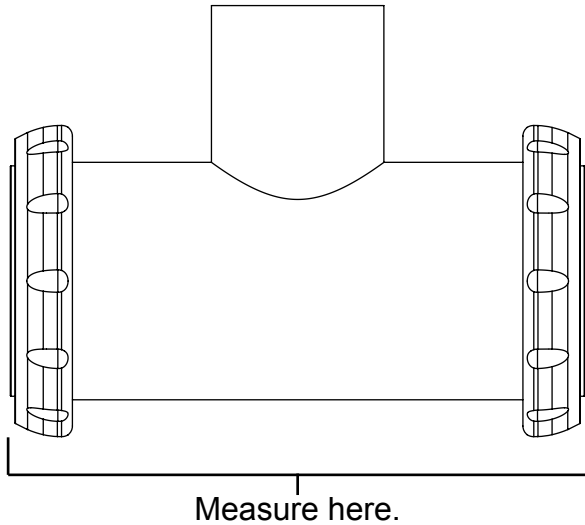

ThreadFit™ T47 30i: Installed on a 68mm bottom bracket shell the ThreadFit™ T47 30i is compatible with road BB30 type cranksets. Installed on a 73mm bottom bracket shell it is compatible with mountain BB30 type cranksets. When installed on an 85.5mm or 86.5mm bottom bracket shell is compatible with BB386 type cranksets.

Road	Frame Shell Width (mm)	Non-Drive Side Spindle Spacers (mm)	Left BB Cup Spacers (mm)	Right BB Cup Spacers (mm)	Drive Side Spindle Spacers (mm)
ThreadFit™ T47 30x Narrow	68	-	-	-	-
ThreadFit™ T47 30x Wide	68	1	-	-	1
ThreadFit™ T47 30i	68	-	-	-	-
	85.5 (Trek)	0.5	-	-	0.5
	86.5	-	-	-	-

Mountain	Frame Shell Width (mm)	Non-Drive Side Spindle Spacers (mm)	Left BB Cup Spacers (mm)	Right BB Cup Spacers (mm)	Drive Side Spindle Spacers (mm)
ThreadFit™ T47 30x Narrow	68	-	2.5	5	-
	73	-	-	2.5	-
ThreadFit™ T47 30x Wide	68	1	2.5	5	1
	73	1	-	2.5	1
ThreadFit™ T47 30i	73	-	-	-	-

Fit Kit 6

Bottom Bracket Type - ThreadFit™ 24, T47 24x, T47 24i

Crank Type - GXP spindle

NOTE: Slide the GXP Adapter Sleeve onto the 22mm stepped portion of the spindle before installing the Stepped Washer.

Road	Frame Shell Width (mm)	Non-Drive Side Spindle Spacers (mm)	Left BB Cup Spacers (mm)	Right BB Cup Spacers (mm)	Drive Side Spindle Spacers (mm)
ThreadFit™ 24	68	Stepped Washer	-	-	Disc Spring and 1.85
ThreadFit™ T47 24x	68	Stepped Washer	-	-	Disc Spring and 1.85
ThreadFit™ T47 24i	85.5 (Trek)	Stepped Washer and 0.5	-	-	Disc Spring and 2.35
	86.5	Stepped Washer	-	-	Disc Spring and 1.85

Mountain	Frame Shell Width (mm)	Non-Drive Side Spindle Spacers (mm)	Left BB Cup Spacers (mm)	Right BB Cup Spacers (mm)	Drive Side Spindle Spacers (mm)
ThreadFit™ 24	73	Stepped Washer	-	-	Disc Spring and 3.85
ThreadFit™ T47 24x	73	Stepped Washer	-	-	Disc Spring and 3.85
ThreadFit™ T47 24i	85.5 (Trek)	Stepped Washer and 0.5	-	-	Disc Spring and 4.35
	86.5	Stepped Washer	-	-	Disc Spring and 3.85

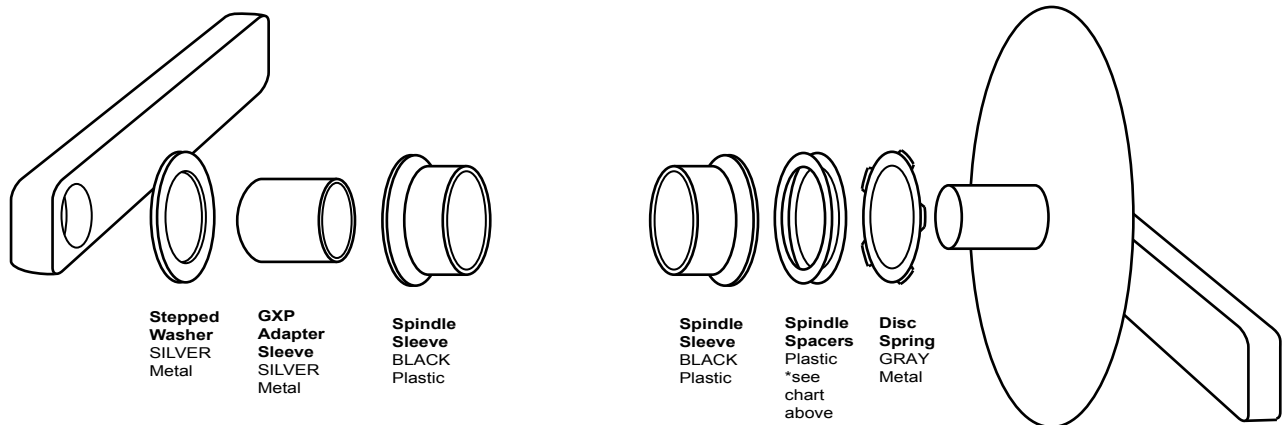

KING LIMITED WARRANTY

EFFECTIVE FOR PRODUCTS SOLD FROM AND AFTER JANUARY 1, 2019

King Cycle Group, Inc. ("King Cycle") warrants its products (the "Product") to the original purchaser to be free from defects in materials and workmanship, and defects that hinder the functioning of the Product, that occur under normal use for the applicable following periods from the original date of purchase (these warranties are collectively referred to as our "Limited Warranty"):

Hubs, Headsets, and Bottom Brackets, including the bearings, are warranted for the lifetime of the original purchaser. All other products are warranted for the following periods: Cielo Frames and Stems (5 years), Accessories (1 year), Soft Goods (90 days), Wheels (The hubs only are warranted for the life of the original purchaser. All other wheel components that are not manufactured by King Cycle such as, but without limitation, rims, spokes, and nipples, are not warranted by King Cycle.).

This Limited Warranty does not cover damage or failure resulting from misuse, abuse, alteration, neglect, crash or impact, accidents, failure to perform routine maintenance, improper installation, use other than that for which the Product was intended, and normal wear and tear. This Limited Warranty does not cover any Product where the serial number has been altered or removed.

WARRANTY CLAIMS: In order to make a warranty claim, the Product alone (i.e., not including any other equipment such as cassettes, skewers, steering tubes, etc.) or built into a wheel including rim, spokes, nipples, rim strip and tubeless valve, together with a Return Authorization number provided by King Cycle, must be returned to and received by King Cycle at the address set forth below, postage prepaid, within the applicable Limited Warranty period.

EXCLUSIVE REMEDY: If a defect arises and you return your Product during the applicable Limited Warranty period described above, King Cycle will, in its sole discretion and to the extent permitted by law, either repair the Product using new or refurbished parts, replace your Product with a new or refurbished product functionally at least equivalent to yours, or accept the return of the Product in exchange for a refund of the purchase price you paid for the Product. If King Cycle repairs or replaces the Product, the repaired or replaced product will continue to be warranted for the remaining time of the original warranty period. All returned parts for which you have received a replacement will become the property of King Cycle. Nothing in this Limited Warranty will reduce or otherwise affect your statutory rights in relation to the Product.

THE LIMITED WARRANTY WRITTEN ABOVE IS THE ONLY EXPRESS WARRANTY KING CYCLE PROVIDES FOR THE PRODUCT, AND THE ABOVE REMEDY IS YOUR SOLE REMEDY. TO THE MAXIMUM EXTENT PERMITTED BY APPLICABLE LAW, KING CYCLE EXPRESSLY DISCLAIMS ALL OTHER WARRANTIES AND CONDITIONS OF ANY KIND, WHETHER STATUTORY OR IMPLIED, ARISING FROM COURSE OF CONDUCT OR OTHERWISE, REGARDING THE PRODUCT, EXCEPT THAT ANY IMPLIED WARRANTIES OF MERCHANTABILITY, FITNESS FOR A PARTICULAR PURPOSE, NON-INFRINGEMENT, AND OTHERWISE ARE LIMITED IN DURATION TO THE APPLICABLE PERIOD OF THE EXPRESS WARRANTY ABOVE (DEPENDING ON THE TYPE OF PRODUCT).

LIMITATION OF LIABILITY: YOU EXPRESSLY UNDERSTAND AND AGREE THAT, TO THE MAXIMUM EXTENT PERMITTED BY APPLICABLE LAW, KING CYCLE AND ITS SUBSIDIARIES AND AFFILIATES (COLLECTIVELY, "KING PARTIES") SHALL NOT BE LIABLE TO YOU UNDER ANY THEORY OF LIABILITY (WHETHER CONTRACT, TORT (INCLUDING NEGLIGENCE), BREACH OR FAILURE OF ANY WARRANTY OR OTHERWISE) FOR ANY INDIRECT, INCIDENTAL, SPECIAL, CONSEQUENTIAL, PUNITIVE, OR EXEMPLARY DAMAGES THAT MAY BE INCURRED BY YOU IN CONNECTION WITH THE PRODUCT OR THESE TERMS, WHETHER OR NOT A KING PARTY OR ITS REPRESENTATIVES HAVE BEEN ADVISED OF OR SHOULD HAVE BEEN AWARE OF THE POSSIBILITY OF ANY SUCH LOSSES ARISING. YOU EXPRESSLY UNDERSTAND AND AGREE THAT, TO THE MAXIMUM EXTENT PERMITTED BY APPLICABLE LAW, THE KING PARTIES' TOTAL LIABILITY IN CONNECTION WITH THE PRODUCT OR THIS LIMITED WARRANTY WILL NOT EXCEED THE AMOUNT YOU ACTUALLY PAID FOR THE PRODUCT.

Some states do not allow limitations on how long an implied warranty lasts, so the above limitation may not apply to you. Some states do not allow the exclusion or limitation of incidental or consequential damages, so the above limitation or exclusion may not apply to you. This warranty gives you specific legal rights, and you may also have other rights which vary from state to state.

GENERAL: This Limited Warranty is to the original purchaser of the Product only and is not assignable or otherwise transferable. No employee or representative of King Cycle or its affiliates or any third party is authorized to make any modification, extension or addition to this Limited Warranty. If any term of this Limited Warranty is held to be illegal or unenforceable, the remaining terms hereof will remain in full force and effect.

This Limited Warranty is given by King Cycle Group, Inc., an Oregon corporation, whose principal place of business is at 2801 NW Nela