

Service Schematic

NOTICE - PROPRIETARY INFORMATION: THIS SERVICE SCHEMATIC AND ITS CONTENTS ARE WHOLLY OWNED BY HYDRO-GEAR OF SULLIVAN, IL, AND MAY NOT BE USED, DISCLOSED, PUBLISHED OR REPRODUCED WITHOUT THE WRITTEN CONSENT OF HYDRO-GEAR.

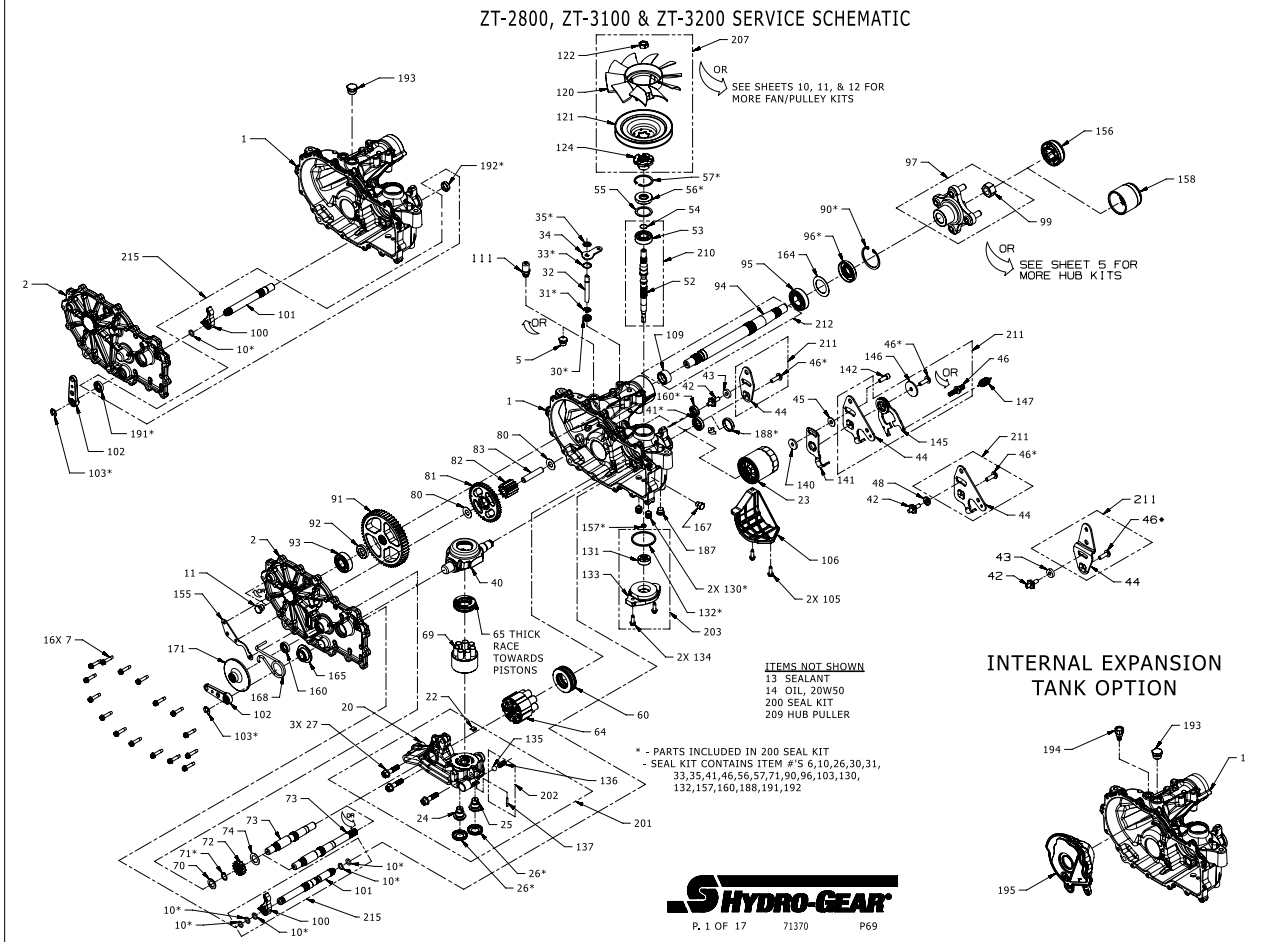

Service Schematic

#	PART #	DESCRIPTION	QTY	Note
1	71425	KIT, MAIN HOUSING, LH, CNTL	1	
2	71574	KIT, COVER, SIDE, LH	1	
7	53246	SCREW 1/4-20 X 1.125 HEX WASHER	16	
10	51804	O-RING -111 .103 X .424	5	
11	54730	PLUG, EXTERNAL, HEX	1	
13	50928	SEALANT TUBE	1	
14		OIL, 20W50	70.3 oz	
22	51448	PLATE, BYPASS	1	
23	52114	FILTER, OIL	1	
26	52162	SEAL 1.375 X .250 PLUG	2	
27	52137	SCREW 3/8-16 X 1.50 HFH	3	
30	55232	SEAL, LIP .375 X .75 X .25	1	
31	51628	RING RET 37 EXT KLIPRING	1	
32	52136	ROD BYPASS	1	
33	51627	RING RET 75 INT	1	
34	52370	ARM, BYPASS	1	
35	51630	RING RET 37 EXT PUSH	1	
40	51048	TRUNNION, SWASHPLATE	1	
41	51140	SEAL 18 X 32 X 7 LIP	1	
45	44130	WASHER .34 X .88 X .06	1	
46	51812	SCREW 5/16-24 X 1.00 TWHCS PATCH	1	
55	50951	WASHER 1.23 X 1.57 X .04	1	
56	55486	SEAL, LIP 17 X 40 X 7 HNBR	1	
57	50329	RING RET 156 INT	1	
60	51462	BEARING 35X62X16 BALL THRUST	1	
64	72882	ASS'Y, CYLINDER BLOCK, 16cc	1	
65	50551	BEARING 30X52X13 BALL THRUST	1	
69	70723	ASSY, BLOCK 7 PISTON	1	
70	44371	WASHER .63 X 1.0 X .05 FLAT	1	
71	44145	RETAINING RING, MOTOR SHAFT	1	
72	52149	GEAR, 16T	1	
73	52150	SHAFT MOTOR	1	
74	51069	WASHER .71 X 1.16 X .04 FLAT	1	
80	50132	WASHER .51 X 1.10 X .03 FLAT	2	
81	52148	GEAR, 43T	1	
82	52583	GEAR, 11T	1	
83	51083	JACK SHAFT (PIN)	1	
90	50859	RING, RETAINING 206 INTERNAL	1	
91	52108	GEAR, 54T	1	
92	53336	SPACER, .75 X 1.32 X .257	1	
93	72749	KIT, BEARING	1	
95	53656	BEARING 25.4X52X15 BALL 6205R-1	1	
96	53699	SEAL 1.0 X 2.06 X .38 LIP TC4	1	
97	71446	KIT, HUB 4 BOLT	1	
99	53768	NUT 3/4-16 HEX LOCK	1	
100	52766	PAWL, BRAKE	1	

Service Schematic

#	PART #	DESCRIPTION	QTY	Note
101	52651	SHAFT INBOARD BRAKE	1	
102	53973	HANDLE, ACTUATING	1	
103	53019	RING RET 43 EXT KLIPRING	1	
105	50752	SCREW 1/4-20 X .75 HF	2	
106	71854	KIT, FILTER GUARD	1	
111	71393	KIT 1/2 BEADED 9/16 SAE FITTING	1	
140	54315	SPACER 0.320 ID X 1.005 OD X 0.1495 THK	1	
141	51946	ARM, NEUTRAL LEFT	1	
142	51616	SHCS 5/16-24 X .875	1	
147	52401	SPRING EXT .63 X 2.05	1	
158	53501	CAP,AXLE	1	
164	53514	SPACER 1.719 X 2.039 X.021	1	
186	53496	TUBE AXLE 2.03	1	
200	73107	KIT, SEAL	1	
201	71568	KIT, CENTER SECTION LH	1	
209	72320	KIT HUB PULLER	1	
210	73040	KIT, SERVICE, INPUT SHAFT	1	
211	71592	KIT, RTN, BIDIRECTIONAL	1	
212	71570	KIT, SHAFT, AXLE	1	
215	72755	KIT, INBOARD RH ROT "A"/ LH ROT "B"	1	