

Service Schematic

NOTICE - PROPRIETARY INFORMATION: THIS SERVICE SCHEMATIC AND ITS CONTENTS ARE WHOLLY OWNED BY HYDRO-GEAR OF SULLIVAN, IL, AND MAY NOT BE USED, DISCLOSED, PUBLISHED OR REPRODUCED WITHOUT THE WRITTEN CONSENT OF HYDRO-GEAR.

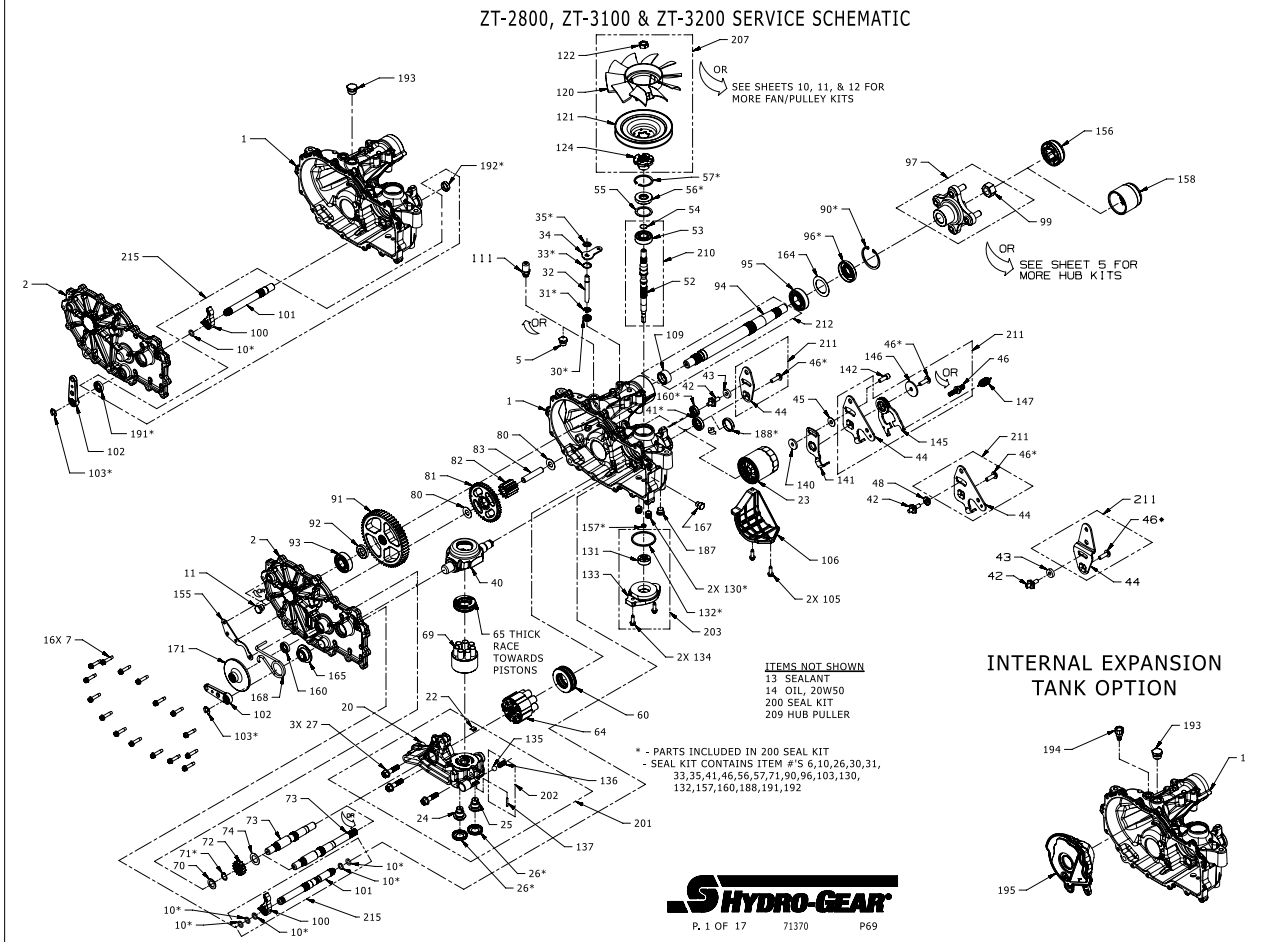

Service Schematic

| # | PART # | DESCRIPTION | QTY | Note |
|----|--------|------------------------------------|---------|------|
| 1 | 71419 | KIT, HOUSING, MAIN RH, CHRNG, CNTL | 1 | |
| 2 | 71576 | KIT, COVER, SIDE, RH | 1 | |
| 5 | 54730 | PLUG, EXTERNAL, HEX | 3 | |
| 7 | 53246 | SCREW 1/4-20 X 1.125 HEX WASHER | 16 | |
| 10 | 51804 | O-RING -111 .103 X .424 | 5 | |
| 11 | 54730 | PLUG, EXTERNAL, HEX | 1 | |
| 13 | 50928 | SEALANT TUBE | 1 | |
| 14 | | OIL, 20W50 | 70.3 oz | |
| 22 | 51448 | PLATE, BYPASS | 1 | |
| 23 | 52114 | FILTER, OIL | 1 | |
| 26 | 52162 | SEAL 1.375 X .250 PLUG | 2 | |
| 27 | 52137 | SCREW 3/8-16 X 1.50 HFH | 3 | |
| 30 | 55232 | SEAL, LIP .375 X .75 X .25 | 1 | |
| 31 | 51628 | RING RET 37 EXT KLIPRING | 1 | |
| 32 | 52136 | ROD BYPASS | 1 | |
| 33 | 51627 | RING RET 75 INT | 1 | |
| 34 | 51629 | ARM, BYPASS | 1 | |
| 35 | 51630 | RING RET 37 EXT PUSH | 1 | |
| 40 | 51048 | TRUNNION, SWASHPLATE | 1 | |
| 41 | 51140 | SEAL 18 X 32 X 7 LIP | 1 | |
| 45 | 44130 | WASHER .34 X .88 X .06 | 1 | |
| 46 | 51812 | SCREW 5/16-24 X 1.00 TWHCS PATCH | 1 | |
| 55 | 50951 | WASHER 1.23 X 1.57 X .04 | 1 | |
| 56 | 55486 | SEAL, LIP 17 X 40 X 7 HNBR | 1 | |
| 57 | 50329 | RING RET 156 INT | 1 | |
| 60 | 51462 | BEARING 35X62X16 BALL THRUST | 1 | |
| 64 | 72882 | ASSY, CYLINDER BLOCK, 16cc | 1 | |
| 65 | 50551 | BEARING 30X52X13 BALL THRUST | 1 | |
| 69 | 70723 | ASSY, BLOCK 7 PISTON | 1 | |
| 70 | 44371 | WASHER .63 X 1.0 X .05 FLAT | 1 | |
| 71 | 44145 | RETAINING RING, MOTOR SHAFT | 1 | |
| 72 | 52149 | GEAR, 16T | 1 | |
| 73 | 52150 | SHAFT MOTOR | 1 | |
| 74 | 51069 | WASHER .71 X 1.16 X .04 FLAT | 1 | |
| 80 | 50132 | WASHER .51 X 1.10 X .03 FLAT | 2 | |
| 81 | 52148 | GEAR, 43T | 1 | |
| 82 | 52583 | GEAR, 11T | 1 | |
| 83 | 51083 | JACK SHAFT (PIN) | 1 | |
| 90 | 50859 | RING, RETAINING 206 INTERNAL | 1 | |
| 91 | 52108 | GEAR, 54T | 1 | |
| 92 | 53336 | SPACER, .75 X 1.32 X .257 | 1 | |
| 93 | 72749 | KIT, BEARING | 1 | |
| 95 | 53656 | BEARING 25.4X52X15 BALL 6205R-1 | 1 | |
| 96 | 53699 | SEAL 1.0 X 2.06 X .38 LIP TC4 | 1 | |
| 97 | 71405 | KIT, HUB, 4 BOLT | 1 | |
| 99 | 53768 | NUT 3/4-16 HEX LOCK | 1 | |

Service Schematic

| # | PART # | DESCRIPTION | QTY | Note |
|-----|--------------|---|-----|------|
| 100 | 52766 | PAWL, BRAKE | 1 | |
| 101 | 52651 | SHAFT INBOARD BRAKE | 1 | |
| 102 | 53973 | HANDLE, ACTUATING | 1 | |
| 103 | 53019 | RING RET 43 EXT KLIPRING | 1 | |
| 105 | 50752 | SCREW 1/4-20 X .75 HF | 2 | |
| 106 | 73041 | GUARD, FILTER, RH | 1 | |
| 130 | 54501 | TUBE CHARGE TRIPLE O-RING | 2 | |
| 131 | 50273 | GEROTOR TANGX1.15X.39 (1.9CC) | 1 | |
| 132 | 55204 | O-RING -137, 2.05 X .099 SQUARE | 1 | |
| 133 | 53738 | HOUSING CHARGE PUMP | 1 | |
| 134 | 50752 | SCREW 1/4-20 X .75 HF | 2 | |
| 140 | 54315 | SPACER 0.320 ID X 1.005 OD X 0.1495 THK | 1 | |
| 141 | 51945 | ARM, NEUTRAL RIGHT | 1 | |
| 142 | 51616 | SHCS 5/16-24 X .875 | 1 | |
| 147 | 52401 | SPRING EXT .63 X 2.05 | 1 | |
| 156 | 53088 | CAP, AXLE | 1 | |
| 157 | 72291 | KIT GEROTOR SEAL | 1 | |
| 164 | 53514 | SPACER 1.719 X 2.039 X.021 | 1 | |
| 167 | 55153 | PLUG, 7/16-20 HEX | 1 | |
| 187 | 9005110-5600 | PLUG 9/16-18 METAL | 1 | |
| 200 | 73107 | KIT, SEAL | 1 | |
| 201 | 72839 | KIT, CENTER SECTION, RH, CHRG | 1 | |
| 202 | 71436 | KIT, CHARGE RELIEF | 1 | [1] |
| 203 | 72274 | KIT CHARGE | 1 | [2] |
| 209 | 72320 | KIT HUB PULLER | 1 | |
| 210 | 73047 | KIT, INPUT SHAFT | 1 | [3] |
| 211 | 71588 | KIT, RTN, BIDIRECTIONAL | 1 | |
| 212 | 71569 | KIT, SHAFT, AXLE | 1 | |
| 215 | 72755 | KIT, INBOARD RH ROT "A"/ LH ROT "B" | 1 | |

PART NOTES:

- [1] - contains items 135,136,137
- [2] - contains items 131, 132, 133, 134
- [3] - contains items 52, 53, 54, 124