

Service Schematic

NOTICE - PROPRIETARY INFORMATION: THIS SERVICE SCHEMATIC AND ITS CONTENTS ARE WHOLLY OWNED BY HYDRO-GEAR OF SULLIVAN, IL, AND MAY NOT BE USED, DISCLOSED, PUBLISHED OR REPRODUCED WITHOUT THE WRITTEN CONSENT OF HYDRO-GEAR.

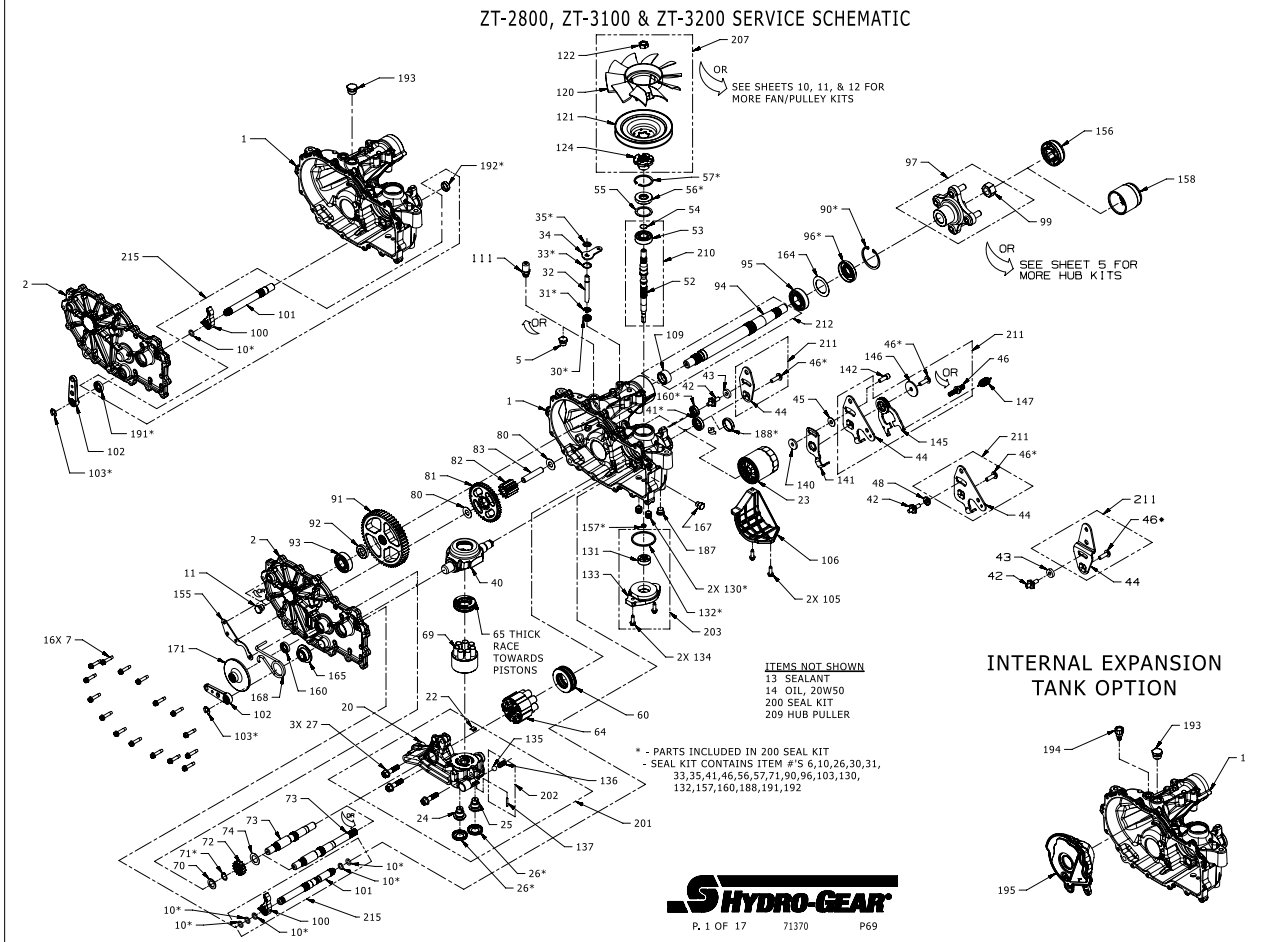

Service Schematic

#	PART #	DESCRIPTION	QTY	Note
1	73069	KIT, HOUSING, MAIN, RH, CHRGR, CNTL	1	
2	73095	KIT, SIDE COVER, RH	1	
7	53246	SCREW 1/4-20 X 1.125 HEX WASHER	16	
10	51804	O-RING -111 .103 X .424	1	
11	54730	PLUG, EXTERNAL, HEX	1	
13	50928	SEALANT TUBE	1	
14		OIL, 20W50	63.4 oz	
22	51448	PLATE, BYPASS	1	
23	52114	FILTER, OIL	1	
26	52162	SEAL 1.375 X .250 PLUG	2	
27	52137	SCREW 3/8-16 X 1.50 HFH	3	
30	55232	SEAL, LIP .375 X .75 X .25	1	
31	51628	RING RET 37 EXT KLIPRING	1	
32	52136	ROD BYPASS	1	
33	51627	RING RET 75 INT	1	
34	52370	ARM, BYPASS	1	
35	51630	RING RET 37 EXT PUSH	1	
40	51048	TRUNNION, SWASHPLATE	1	
41	51140	SEAL 18 X 32 X 7 LIP	1	
45	44130	WASHER .34 X .88 X .06	1	
46	51812	SCREW 5/16-24 X 1.00 TWHCS PATCH	1	
55	50951	WASHER 1.23 X 1.57 X .04	1	
56	55486	SEAL, LIP 17 X 40 X 7 HNBR	1	
57	50329	RING RET 156 INT	1	
60	51462	BEARING 35X62X16 BALL THRUST	1	
64	72882	ASS'Y, CYLINDER BLOCK, 16cc	1	
65	50551	BEARING 30X52X13 BALL THRUST	1	
69	70723	ASSY, BLOCK 7 PISTON	1	
70	44371	WASHER .63 X 1.0 X .05 FLAT	1	
71	44145	RETAINING RING, MOTOR SHAFT	1	
72	52149	GEAR, 16T	1	
73	52150	SHAFT MOTOR	1	
74	51069	WASHER .71 X 1.16 X .04 FLAT	1	
80	50132	WASHER .51 X 1.10 X .03 FLAT	2	
81	52148	GEAR, 43T	1	
82	52583	GEAR, 11T	1	
83	51083	JACK SHAFT (PIN)	1	
90	50859	RING, RETAINING 206 INTERNAL	1	
91	52108	GEAR, 54T	1	
92	53336	SPACER, .75 X 1.32 X .257	1	
93	72749	KIT, BEARING	1	
95	53656	BEARING 25.4X52X15 BALL 6205R-1	1	
96	53699	SEAL 1.0 X 2.06 X .38 LIP TC4	1	
97	71404	KIT, HUB, 4 BOLT	1	
99	53768	NUT 3/4-16 HEX LOCK	1	
100	52766	PAWL, BRAKE	1	

Service Schematic

#	PART #	DESCRIPTION	QTY	Note
101	55479	SHAFT, BRAKE, OUTBOARD	1	
102	53973	HANDLE, ACTUATING	1	
103	53019	RING RET 43 EXT KLIPRING	1	
105	50752	SCREW 1/4-20 X .75 HF	2	
106	73041	GUARD, FILTER, RH	1	
130	54501	TUBE CHARGE TRIPLE O-RING	2	
131	50273	GEROTOR TANGX1.15X.39 (1.9CC)	1	
132	55204	O-RING -137, 2.05 X .099 SQUARE	1	
133	53738	HOUSING CHARGE PUMP	1	
134	50752	SCREW 1/4-20 X .75 HF	2	
140	54315	SPACER 0.320 ID X 1.005 OD X 0.1495 THK	1	
141	51945	ARM, NEUTRAL RIGHT	1	
142	51616	SHCS 5/16-24 X .875	1	
147	52401	SPRING EXT .63 X 2.05	1	
156	53088	CAP, AXLE	1	
157	72291	KIT GEROTOR SEAL	1	
159	53429	SPRING TORSION 1.01 X 1.17	1	
164	53514	SPACER 1.719 X 2.039 X.021	1	
191	53138	SEAL .625 X .875 X .250 LIP	1	
192	55177	SEAL, PLUG .875 X .250	1	
193	54974	PLUG, 3/4 - 16	1	
194	55789	ASSEMBLY, FITTING 9/16-18 BREATHER	1	
195	55071	ASSEMBLY, TANK, EXPANSION, INTERNAL, RH	1	
200	73107	KIT, SEAL	1	
201	71638	KIT, CENTER SECTION, RH, CHRG	1	
202	71436	KIT, CHARGE RELIEF	1	
203	72274	KIT CHARGE	1	
209	72320	KIT HUB PULLER	1	
210	73047	KIT, INPUT SHAFT	1	
211	71590	KIT, RTN CW	1	
212	71569	KIT, SHAFT, AXLE	1	
215	73118	KIT, OUTBOARD RH ROT "A" / LH ROT "B"	1	