

Service Schematic

NOTICE - PROPRIETARY INFORMATION. THIS SERVICE SCHEMATIC AND ITS CONTENTS ARE WHOLLY OWNED BY HYDRO-GEAR OF SULLIVAN, IL, AND MAY NOT BE USED, DISCLOSED, PUBLISHED OR REPRODUCED WITHOUT THE WRITTEN CONSENT OF HYDRO-GEAR.

NOTES:

1. LH SIDE SHOWN,
RH SIDE MIRROR IMAGE

ZT-2100 SERVICE SCHEMATIC

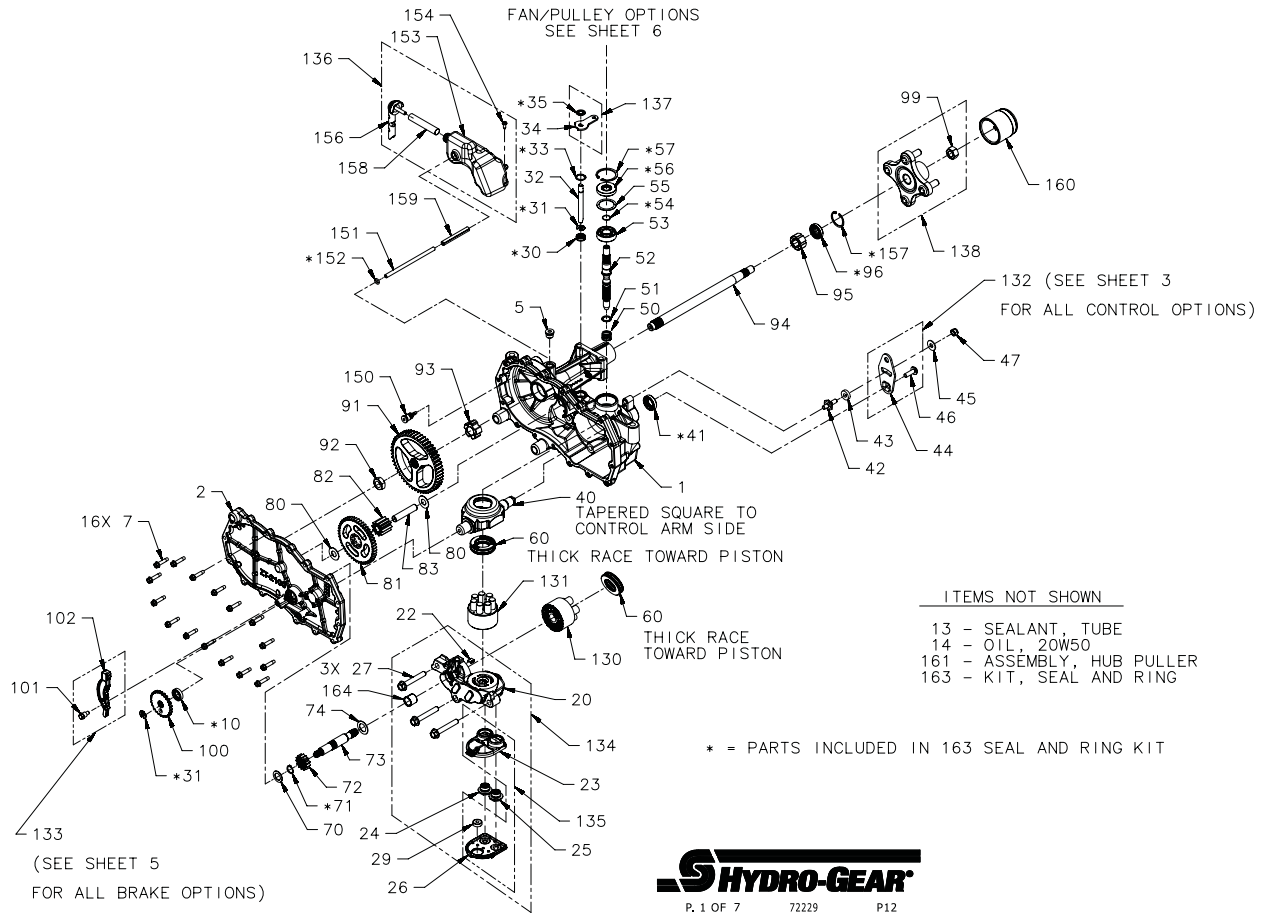

Service Schematic

#	PART #	DESCRIPTION	QTY	Note
1	72203	KIT, HOUSING, MAIN, RH	1	
2	72205	KIT, HOUSING, SIDE, RH	1	
5	9005110-5600	PLUG 9/16-18 METAL	1	
7	53246	SCREW 1/4-20 X 1.125 HEX WASHER	16	
13	50928	SEALANT TUBE	1	
14		OIL, 20W50		
32	51625	ROD BYPASS	1	
40	51048	TRUNNION, SWASHPLATE	1	
42	50426	STUD 5/16-24X1.5 SHORT	1	
43	52298	WASHER .31 X .80 X.21 PLASTIC	1	[1]
45	44130	WASHER .34 X .88 X .06	1	
47	50317	NUT HEX 5/16-24 UNF NYLON INSERT	1	
50	2003014	SPRING, BLOCK	1	
51	2003017	WASHER .59 X .79 X .04 FLAT	1	
52	51062	SHAFT INPUT	1	
53	50315	BEARING 17X40X12 BALL OPEN 6203	1	
55	50951	WASHER 1.23 X 1.57 X .04	1	
60	50551	BEARING 30X52X13 BALL THRUST	2	
70	44371	WASHER .63 X 1.0 X .05 FLAT	1	
72	51130	GEAR, 13T PINNION	1	
73	51632	SHAFT MOTOR	1	
74	51069	WASHER .71 X 1.16 X .04 FLAT	1	
80	50132	WASHER .51 X 1.10 X .03 FLAT	2	
81	51129	GEAR, 10T/48T	1	
82	51043	GEAR, 10T JACKSHAFT	1	
83	51083	JACK SHAFT (PIN)	1	
91	53615	GEAR, BULL 52T	1	
92	50791	NUT HEX 5/8-18 PATCH	1	
93	52280	BUSHING, AXLE INBOARD	1	
94	53833	SHAFT 11.72 X 3.6 DEG AXLE TAPER SPLINE	1	
95	53599	BUSHING, AXLE OUTBOARD	1	
130	70331	KIT, BLOCK, 10CC CYLINDER	1	
131	70723	ASSY, BLOCK 7 PISTON	1	
132	71633	KIT, CONTROL ARM	1	[1]
133	70865	KIT, BRAKE ARM	1	
110	51628	RING RET 37 EXT KLIPRING	1	
100	51635	DISC, COG BRAKE	1	
(102)		ARM, BRAKE	1	
(101)		BOLT, SHOULDER 1/4-20 X 1 W/PATCH	1	
134	71530	KIT, CENTER SECTION W/ FILTER - RH	1	
(20)		CENTER SECTION, LH, 7P	1	
(22)		PLATE, BYPASS	1	
(27)		BOLT, HEX FLANGE 3/8-24 X 2.5	3	
(26)		ASSEMBLY, COVER	1	
(23)		FILTER, BASE	1	
(29)		MAGNET	1	

Service Schematic

#	PART #	DESCRIPTION	QTY	Note
(24)		CHECK PLUG ASSEMBLY, .027, WASHER	1	
(25)		CHECK PLUG ASSEMBLY, .027, WASHER	1	
(164)		BUSHING .711 X .778 LG	1	
135	71497	KIT, FILTER	1	
(26)		ASSEMBLY, COVER	1	
(23)		FILTER, BASE	1	
(29)		MAGNET	1	
136	72243	KIT, EXPANSION TANK, RH	1	
(153)		TANK, EXPANSION, RH	1	
(154)		BOLT, SELF- TAPPING #10-32 X 1/2	1	
162	72245	KIT, BREATHER ASSEMBLY	1	
137	71357	KIT, BYPASS ARM	1	
138	72231	KIT, HUB, 4 BOLT	1	
150	51143	FITTING 5/16 SAE, 5/32 TUBE	1	
151	52474	TUBE .16 X .28 X 5.5	1	
154	52810	SCREW 10-32 X .50 SELF T	1	
159	53896	CASE, TUBE	1	
160	53962	CAP, AXLE	1	
161	72320	KIT HUB PULLER	1	
163	72201	KIT, SEALS AND RETAINING RINGS	1	
		ITEM #163 SEAL KIT, P/N 72201		
10		SEAL, LIP .625 X 1.0 X .25	1	
30		SEAL, LIP .375 X .75 X .25	1	
31		RING, RETAINING .375 EXT.	2	
33		RING, RETAINING .750 INT.	1	
35		RING, RETAINING .375 EXT. IPUSHNUTI	1	
41		SEAL, LIP 18 X 32 X 7	1	
54		RING, RETAINING EXT. WIRE .591 ID	1	
56		SEAL, LIP 17 X 40 X 7	1	
57		RING, RETAINING 1.562 INTERNAL	1	
71		RING, RETAINING	1	
96		SEAL, LIP .75 X 1.25 X .313	1	
152		O-RING .103 X .299 ID	1	
157		RING, RETAINING	1	

PART NOTES:

[1] - Includes items 42, 45, 47