

Parts Breakdown

718-0254
313-0500

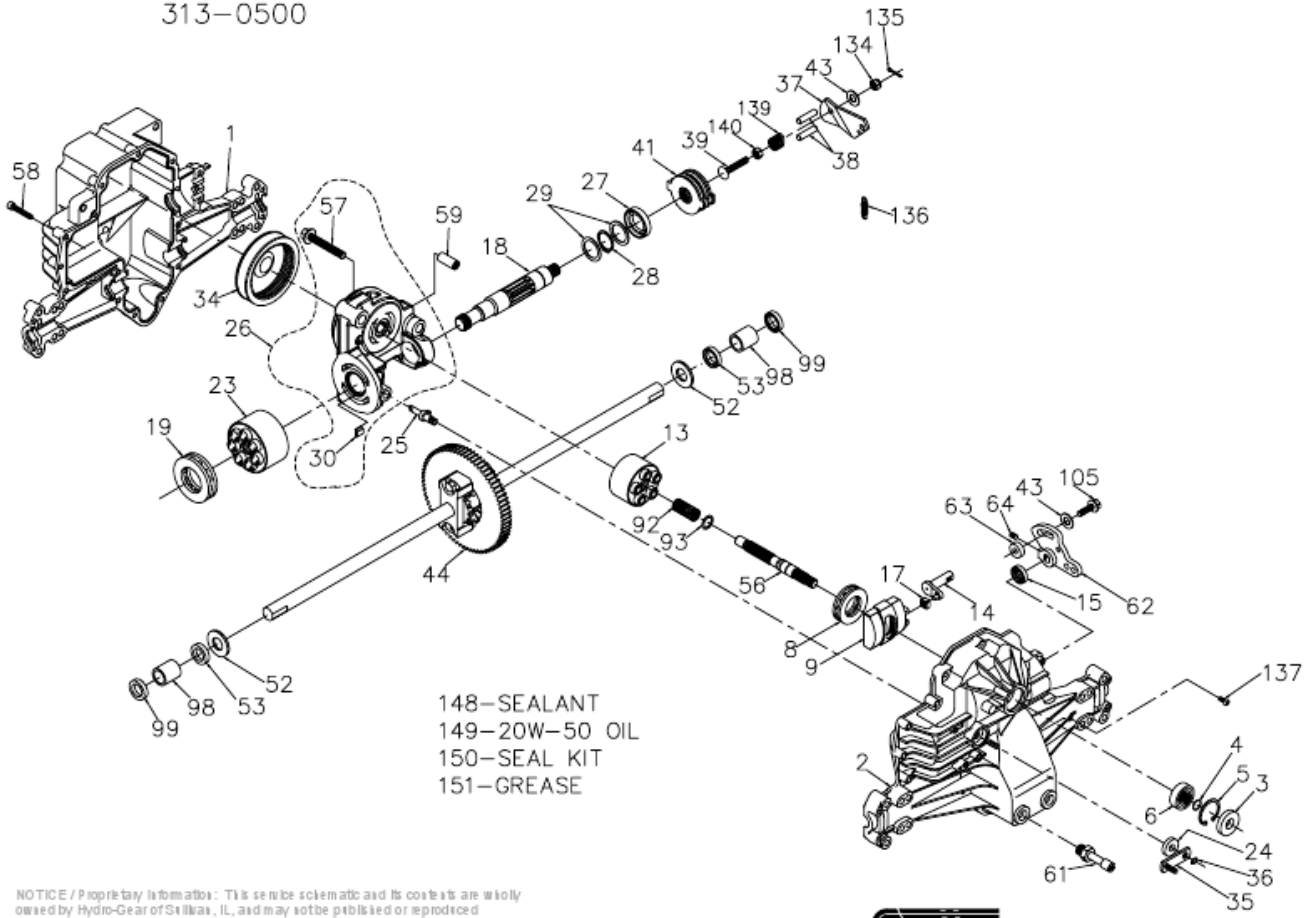

NOTICE / Proprietary Information: This service schematic and its contents are wholly owned by Hydro-Gear of Stillman, IL, and may not be published or reproduced without the written consent of Hydro-Gear.



Parts Breakdown

| # | PART # | DESCRIPTION | QTY | Note |
|----|--------------|---------------------------------|-----|------|
| 1 | 44863RM | HOUSING, 0500 LOWER (RAW MATL) | 1 | |
| 2 | 70254 | KIT, HOUSING, UPPER | 1 | |
| | | UPPER HOUSING | 1 | |
| | | TRUNNION JOURNAL BEARING | 1 | |
| 3 | 9008000-0128 | SEAL 15 X 35 X 7 LIP PTC | 1 | |
| 4 | 2003016 | RING RET 59 EXT WIRE | 1 | |
| 5 | 2003052 | RING RET 137 INT | 1 | |
| 6 | 2003043 | BEARING 15X35X11 BALL OPEN 6202 | 1 | |
| 8 | 50551 | BEARING 30X52X13 BALL THRUST | 1 | |
| 9 | 2003087 | SWASHPLATE 10CC | 1 | |
| 13 | 70331 | KIT, BLOCK, 10CC CYLINDER | 1 | |
| | | BLOCK-CYLINDER | 1 | |
| | | PISTON | 5 | |
| | | PISTON SPRING | 5 | |
| | | PISTON SPRING WASHER | 5 | |
| 14 | 2003005 | ARM, TRUNNION, DOUBLE D | 1 | |
| 15 | 9008000-0126 | SEAL 12 X 25 X 7 LIP TC | 1 | |
| 17 | 2000015 | SLOT GUIDE | 1 | |
| 18 | 50449 | SHAFT, MOTOR 10 T PINI | 1 | |
| 19 | 50552 | BEARING 42X68X16 BALL THRUST | 1 | |
| 23 | 70082 | KIT, MOTOR BLOCK | 1 | |
| | | BLOCK-CYLINDER | 1 | |
| | | PISTON | 7 | |
| | | PISTON SPRING | 7 | |
| | | PISTON SPRING WASHER | 7 | |
| 24 | 45074 | SEAL 10 X 25 X 7 LIP | 1 | |
| 25 | 2003555 | ACTUATOR BYPASS | 1 | |
| 26 | 70250 | KIT, CENTER SECTION | 1 | |
| | | PLATE, BYPASS | 1 | |
| | | CHECK PLUG ASSEMBLY | 2 | |
| | | CENTER SECTION | 1 | |
| | | DU BEARING | 1 | |
| | | BOLT, 3/8-24 X 2.5 | 3 | |
| | | BUSHING, 1.02 X 1.1 X .67 | 1 | |
| 27 | 45075 | SEAL 26 X 42 X 8 LIP | 1 | |
| 28 | 50007 | RING RET 102 EXT | 1 | |
| 29 | 44872 | WASHER 1.04 X 1.37 X .04 FLAT | 2 | |
| 30 | 70680 | KIT, BYPASS PLATE | 1 | |
| 34 | 50990 | FILTER | 1 | |
| 35 | 50126 | ARM, BYPASS | 1 | |
| 36 | 44870 | RING RET 31 EXT | 1 | |
| 37 | 44094 | ARM, BRAKE | 1 | |
| 38 | 44891 | PIN .3 X 1.25 ACTUATING | 2 | |
| 39 | 50316 | SCREW 5/16-24 X 2 BRAKE | 1 | |
| 41 | 70135 | KIT, BRAKE ROTOR | 1 | |
| | | BRAKE STATOR | 4 | |

Parts Breakdown

| # | PART # | DESCRIPTION | QTY | Note |
|-----|---------|-------------------------------|------|------|
| | | BRAKE ROTOR | 2 | |
| 43 | 44130 | WASHER .34 X .88 X .06 | 2 | |
| 44 | 70128 | KIT, SERVICE DIFF | 1 | |
| | | AXLE SHAFT | 2 | |
| | | 72T DIFFERENTIAL GEAR | 1 | |
| | | DIFFERENTIAL HOUSING | 2 | |
| | | 14T BEVEL GEAR | 2 | |
| | | 10T PLANET GEAR | 2 | |
| | | RETAINING RING | 2 | |
| | | DIFFERENTIAL LOCKING BOLT | 2 | |
| | | DIFFERENTIAL SPACER | 1 | |
| 52 | 44875 | WASHER .77 X 1.5 X .10 FLAT | 2 | |
| 53 | 45076 | SEAL- .75 X 1.25 X .250 | 2 | |
| 56 | 50005 | SHAFT INPUT | 1 | |
| 57 | 50016 | SCREW 3/8-24 X 2.5 HF W/PATCH | 1 | |
| 58 | 44876 | SCREW 1/4-20 X 1.37 THC | 20 | |
| 59 | 50002 | PIN .39 X .50 X 1.12 HOLLOW | 2 | |
| 61 | 50042 | ASSY, BREATHER 9/16-18 | 1 | |
| 62 | 45007 | ARM, CNTRL PM | 1 | |
| 63 | 50034 | SPACER .32X.81X.28 | 1 | |
| 64 | 50018 | SCREW 5/16-24 x .50 SET | 1 | |
| 92 | 2003014 | SPRING, BLOCK | 1 | |
| 93 | 2003017 | WASHER .59 X .79 X .04 FLAT | 1 | |
| 98 | 50137 | BUSHING .75X1.0X1.1 STEPPED | 2 | |
| 99 | 50941 | SEAL .75 X 1 X .15 LIP | 2 | |
| 105 | 50282 | FLANGE HEX SCREW, 5/16-24 X 1 | 1 | |
| 134 | 44142 | CASTLE NUT, 5/16-24 | 1 | |
| 135 | 44101 | PIN 3/32 X 3/4 COTTER | 1 | |
| 136 | 50384 | SPRING EXT .33 X 1.33 | 1 | |
| 137 | 50653 | BOLT 10-32 X 1/2 SELF TAPPING | 1 | |
| 139 | 50431 | SPRING COMP .69 X .75 | 1 | |
| 140 | 50269 | NUT HEX 5/16-24 | 1 | |
| 148 | 50928 | SEALANT TUBE | 1 | |
| 149 | | 20W-50 OIL | 77oz | |
| 150 | 70312 | KIT, SEAL | 1 | |
| 151 | 50416 | GREASE TUBE CHEMPLUS 1-LP | 1 | |