

# Parts Breakdown

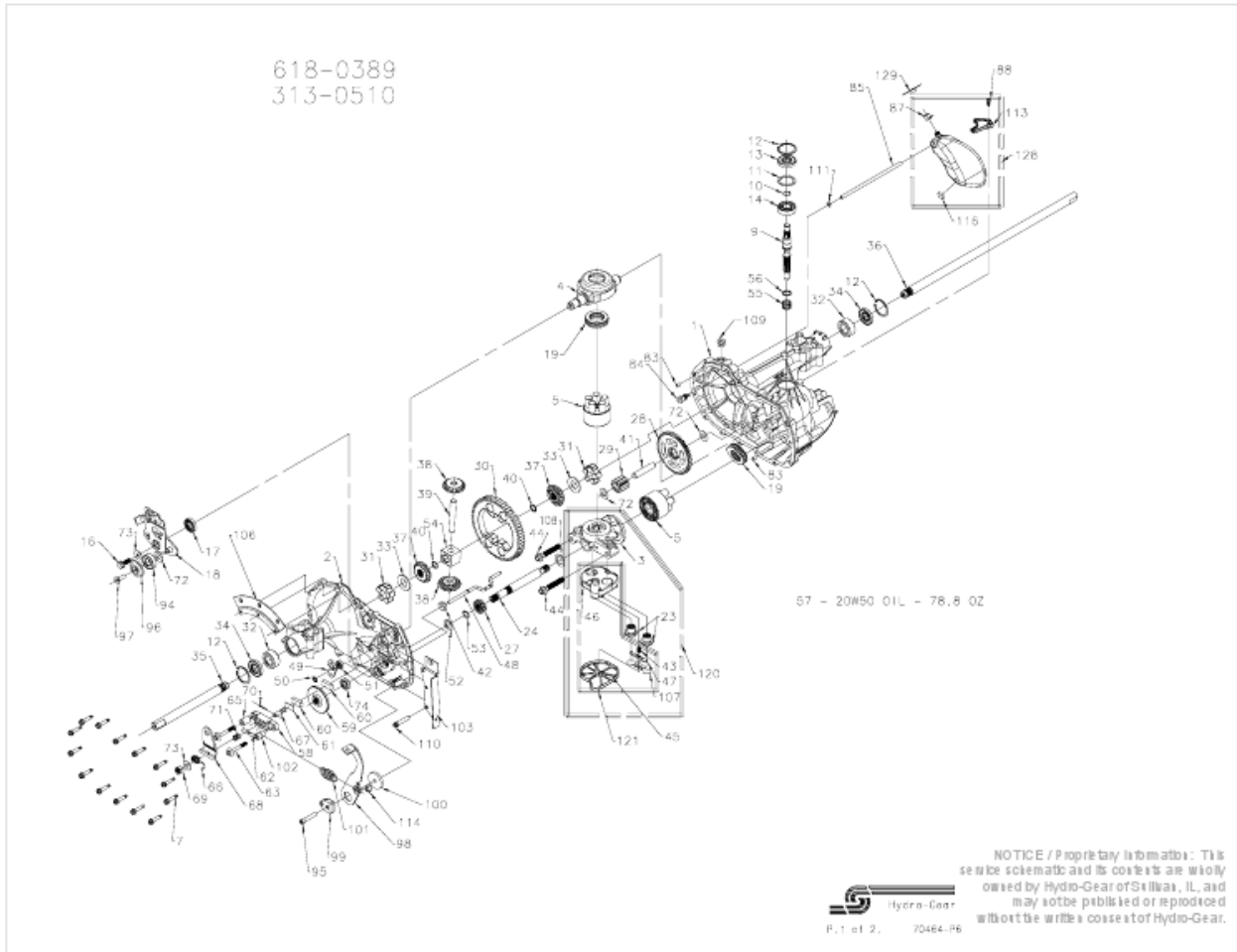

## Parts Breakdown

#	PART #	DESCRIPTION	QTY	Note
1	70467	KIT, HOUSING, MAIN	1	
		MAIN HOUSING, MACHINED	1	
		BUSHING, 0.865 X 0.985 X 0.790	1	
2	70468	KIT, HOUSING, SIDE	1	
		SIDE HOUSING, MACHINED	1	
		BUSHING, 0.865 X 0.985 X 0.790	1	
		BUSHING, 0.624 X 0.719 X 0.562	1	
3	70477	KIT, CENTER SECTION	1	
		CENTER SECTION, MACHINED	1	
		BUSHING, 0.707 X 0.788 X 0.591	1	
4	51048	TRUNNION, SWASHPLATE	1	
5	70331	KIT, BLOCK, 10CC CYLINDER	2	
		BLOCK - CYLINDER	1	
		PISTON	5	
		SPRING, COMPRESSION	5	
		WASHER, THRUST	5	
6	50928	SEALANT TUBE	10.5 oz	
7	51190	SCREW, HEX FLANGE 1/4-20 X 1.25	14	
9	51062	SHAFT INPUT	1	
10	2000022	RING RET 67 EXT WIRE	1	
11	50951	WASHER 1.23 X 1.57 X .04	1	
12	50329	RING RET 156 INT	3	
13	51161	SEAL 17 X 40 X 7 LIP	1	
14	50315	BEARING 17X40X12 BALL OPEN 6203	1	
16	51064	BOLT 5/16-24 X .94 HF (PATCH)	1	
17	51140	SEAL 18 X 32 X 7 LIP	1	
18	51119	ARM, CONTROL	1	
19	50551	BEARING 30X52X13 BALL THRUST	2	
23	51207	ASSY, CHK PLUG W/WASHER	2	
24	50966	SHAFT MOTOR	1	
27	51130	GEAR, 13T PINNION	1	
28	51129	GEAR, 10T/48T	1	
29	51043	GEAR, 10T JACKSHAFT	1	
30	51044	GEAR, 60T BULL	1	
31	51088	BUSHING, SLEEVE (INBOARD)	2	
32	51089	BUSHING, SLEEVE .752 X 1.571 X .625	2	
33	44875	WASHER .77 X 1.5 X .10 FLAT	2	
34	51066	SEAL .750 X 1.577 X .250 LIP	2	
35	51106	SHAFT, AXLE 0.75 X 9.12 (DO, RH)	1	
36	51105	SHAFT .75 X 21.76 DD (LH) AXLE	1	
37	44096	MITER GEAR (SPLINED)	2	
38	44097	MITER GEAR 15T (0.5 ID)	2	
39	50146	SHAFT DIFF	1	
40	44871	RING RET 62 EXT SPIRAL	2	
41	51083	JACK SHAFT (PIN)	1	
42	51100	MAGNET, RING	1	

# Parts Breakdown

#	PART #	DESCRIPTION	QTY	Note
43	51136	SPRING COMP .30 X .50	1	
44	50016	SCREW 3/8-24 X 2.5 HF W/PATCH	2	
45	51581	BOTTOM FILTER	1	
46	51580	BASE FILTER W/ POPPET	1	
47	51091	ACTUATOR, BYPASS ZINC	1	
48	51098	ROD ACTUATOR BYPASS	1	
49	51135	ARM, BYPASS	1	
50	51116	RING RET 25 EXT PUSH	1	
51	51081	SEAL .25 X .75 X .25 LIP TC	1	
52	44371	WASHER .63 X 1.0 X .05 FLAT	1	
53	44145	RETAINING RING, MOTOR SHAFT	1	
54	51071	BUSHING, CENTER BLOCK	1	
55	2003014	SPRING, BLOCK	1	
56	2003017	WASHER .59 X .79 X .04 FLAT	1	
57		OIL, 20W50	76.3 OZ.	
58	44092	BRAKE YOKE	1	
59	51072	ROTOR, BRAKE	1	
60	44132	PUCK, BRAKE	2	
61	44134	PLATE, PUCK	1	
62	44127	PIN BRAKE ACTUATING	2	
63	51146	SCREW .250-20 X 2.0 HFS PATCH	2	
65	23711	SPACER .26X.57X.87	1	
66	50884	SPRING, BRAKE ARM BIAS	1	
67	44138	BOLT 5/16-24 SH RIBBED	1	
68	51142	ARM, BRAKE	1	
69	44142	CASTLE NUT, 5/16-24	1	
70	44101	PIN 3/32 X 3/4 COTTER	1	
71	50919	SPRING COMPRESSION BRAKE ANTI-DRAG	1	
72	50132	WASHER .51 X 1.10 X .03 FLAT	3	
73	44130	WASHER .34 X .88 X .06	2	
74	44761	SEAL, OIL .625 X 1.0 X .25	1	
83	9004800-2506	PIN .250 X .375	2	
84	51143	FITTING 5/16 SAE, 5/32 TUBE	1	
85	51147	HOSE EXPANSION TANK 7.56 IN	1	
87	51251	CAP EXPANSION	1	
88	50653	BOLT 10-32 X 1/2 SELF TAPPING	1	
94	44147	BEARING .62X1.38X.44 BALL	1	
95	50837	SCREW 5/16-24 X 1.5 SHC	1	
96	51200	SPACER, LOCATING	1	
97	50870	SCREW 5/16-18 X 1 SHC W/PATCH	1	
98	51120	ARM, RETURN	1	
99	51097	PUCK, ADJUSTING	1	
100	51122	WASHER, .32 ID X 1.60 OD X .24	1	
101	51131	SPRING EXT .82 X 1.96	1	
102	51123	SPACER .560 OD X .260 ID X .870	1	
103	51137	BRACKET, 5.5" TORQUE	1	

---

Parts Breakdown

# Parts Breakdown

#	PART #	DESCRIPTION	QTY	Note
106	51138	BRACKET, AXLE SUPPORT	1	
107	51134	DEFLECTOR	1	
108	51069	WASHER .71 X 1.16 X .04 FLAT	1	
109	9005110-5600	PLUG 9/16-18 METAL	1	
110	50868	SCREW 5/16-18 X 1.5 TH	1	
111	51144	O-RING -109 .103 X .299	1	
113	51179	BRACKET EXPANSION TANK SUPPORT	1	
114	51184	SPRING GUIDE	1	
116	51196	SPONGE, SILICONE 1/2X1/2	1	
120	70757	KIT, CENTER SECTION, FILTER-BYPASS	1	
		CENTER SECTION MACHINING	1	
		BASE, FILTER W/POPPET	1	
		CHECK, PLUG ASSEMBLY	2	
		SPRING, BYPASS	1	
		ACTUATOR, BYPASS	1	
		DEFLECTOR	1	
		BOTTOM, FILTER	1	
		BUSHING, .707 X .788 X .591	1	
121	70756	ASSY, FILTER	1	
		BOTTOM, FILTER	1	
		BASE, FILTER W/POPPET	1	
		SPRING, BYPASS	1	
		ACTUATOR, BYPASS	1	
		DEFLECTOR	1	
122	70463	KIT, O-RING & SEAL	1	
		SEAL, LIP .67 X 1.58 X .276	1	
		SEAL, LIP 18 X 32 X 7	1	
		SEAL, LIP .706 X 1.584 X .25	2	
		SEAL, LIP .741 X .250 X .250 TC	1	
		OIL, SEAL .625 X 1.0 X .25	2	
		O-RING .07 X .301 ID	1	
128	70503	KIT, EXPANSION TANK	1	
		TANK, EXPANSION	1	
		CAP, VENT	1	
		BOLT, SELF TAPPING 10 - 32 X 1/2	1	
		BRACKET, SUPPORT EXPANSION TANK	1	
		SILICON SPONGE 1/2 X 1/2 X 3/16	1	
129	51252	CAP EXPANSION TANK SHIPPING	1	