

Parts Breakdown

NOTICE - PROPRIETARY INFORMATION: THIS SERVICE SCHEMATIC AND ITS CONTENTS ARE WHOLLY OWNED BY HYDRO-GEAR OF SULLIVAN, IL, AND MAY NOT BE USED, DISCLOSED, PUBLISHED OR REPRODUCED WITHOUT THE WRITTEN CONSENT OF HYDRO-GEAR.

ZT-5400 SERVICE SCHEMATIC

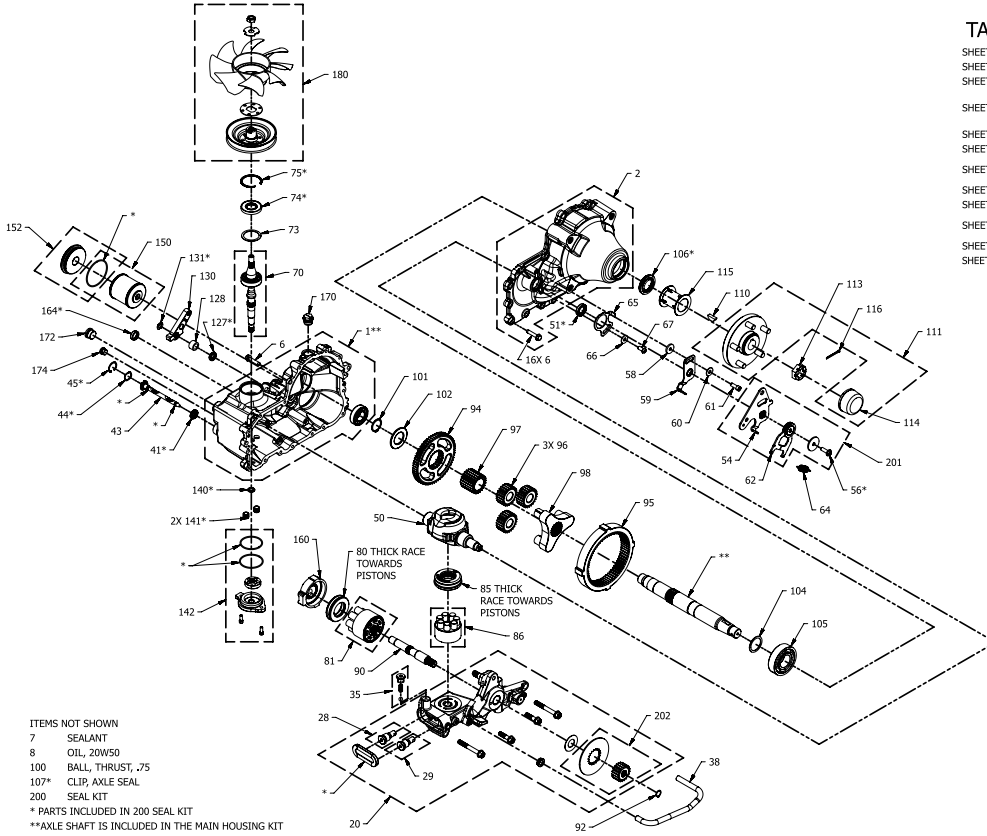

TABLE OF CONTENTS

| | |
|--------------|----------------------------------|
| SHEET 2 | COMMON ITEMS |
| SHEET 3 | MAIN HOUSING OPTIONS |
| SHEET 4 | SIDE HOUSING OPTIONS |
| SHEET 4 | CENTER SECTION OPTIONS |
| SHEET 5 | SHOCK VALVE ROTATION A OPTIONS |
| SHEET 5 | SHOCK VALVE ROTATION B OPTIONS |
| SHEET 6 | GEAR REDUCTION OPTIONS |
| SHEET 7 | AXLE END OPTIONS |
| SHEET 8 | CONTROL ARM OPTIONS |
| SHEET 8 | RTN SPRING OPTIONS |
| SHEET 9 | CONTROL ARM TYPE OPTIONS |
| SHEET 10 | MOTOR RANGE OPTIONS |
| SHEET 11 | FAN/PULLEY OPTIONS |
| SHEET 12 | EXTERNAL COOLING OPTIONS |
| SHEET 12 | BARBED EXPANSION FITTING OPTIONS |
| SHEETS 13-14 | SERVICE CONFIGURATION GUIDE |

- ITEMS NOT SHOWN
- 7 SEALANT
 - 8 OIL, 20W50
 - 100 BALL, THRUST, .75
 - 107* CLIP, AXLE SEAL
 - 200 SEAL KIT
 - * PARTS INCLUDED IN 200 SEAL KIT
 - **AXLE SHAFT IS INCLUDED IN THE MAIN HOUSING KIT



Parts Breakdown

| # | PART # | DESCRIPTION | QTY | Note |
|-----|--------|---|---------|------|
| 1 | 72688 | KIT, HOUSING, MAIN, RH | 1 | |
| 2 | 71949 | KIT, HOUSING, SIDE, RH | 1 | |
| 6 | 53987 | SCREW 5/16-18 X 1.5 HEX WASHER | 17 | |
| 7 | 50928 | SEALANT TUBE | 1 | |
| 8 | | OIL, 20W50 | 1.2 gal | |
| 20 | 71996 | KIT, CENTER SECTION | 1 | |
| 28 | 71952 | KIT, SHOCK VALVE | 1 | |
| 29 | 71952 | KIT, SHOCK VALVE | 1 | |
| 35 | 71999 | KIT, CHARGE RELIEF | 1 | |
| 38 | 52983 | TUBE, FILTER RH | 1 | |
| 41 | 55522 | SEAL, LIP 12 X 24 X 5, HNBR | 1 | |
| 43 | 54335 | ASSEMBLY ACTUATOR BYPASS | 1 | |
| 44 | 53321 | SPRING WAVE | 1 | |
| 45 | 53322 | RING RET 102 INT | 1 | |
| 50 | 52972 | SWASHPLATE 16CC MACHINED | 1 | |
| 51 | 55526 | SEAL, LIP 22 X 32 X 7 TC, HNBR | 1 | |
| 54 | 53221 | ARM, CONTROL, RH | 1 | |
| 56 | 51812 | SCREW 5/16-24 X 1.00 TWHCS PATCH | 1 | [1] |
| 58 | 54315 | SPACER 0.320 ID X 1.005 OD X 0.1495 THK | 1 | |
| 59 | 51945 | ARM, NEUTRAL RIGHT | 1 | |
| 60 | 44130 | WASHER .34 X .88 X .06 | 1 | |
| 61 | 51616 | SHCS 5/16-24 X .875 | 1 | [1] |
| 62 | 52432 | ASSEMBLY, RTN BI-DIRECTIONAL | 1 | |
| 64 | 51605 | SPRING, EXTENSION | 1 | |
| 65 | 53189 | PLATE, STOP, RH | 1 | |
| 66 | 44130 | WASHER .34 X .88 X .06 | 1 | |
| 67 | 53519 | SCREW 5/16-18 X .75 HBHCS | 1 | |
| 70 | 71941 | KIT, INPUT SHAFT | 1 | |
| 73 | 51279 | WASHER 1.559 X 1.944 X .040 | 1 | |
| 74 | 51280 | LIP SEAL 25 X 52 X 7 PTC | 1 | |
| 75 | 52650 | RING RET 206 INT | 1 | |
| 80 | 53341 | BEARING (21) 42X68X16 PLASTIC THRUST | 1 | |
| 81 | 72159 | KIT, BLOCK 21CC CYLINDER, PW SERIES | 1 | [2] |
| 85 | 52991 | BEARING 35X70X21.6 THRUST | 1 | |
| 86 | 72897 | KIT,BLOCK 16cc CYLINDER | 1 | [3] |
| 90 | 52992 | SHAFT MOTOR | 1 | |
| 92 | 44145 | RETAINING RING, MOTOR SHAFT | 1 | |
| 94 | 52996 | GEAR, 65T/22T | 1 | |
| 95 | 53988 | GEAR, RING, 68T | 1 | |
| 96 | 54483 | GEAR, PLANET, 23T | 3 | |
| 97 | 53000 | GEAR, 22T | 1 | |
| 98 | 53001 | CARRIER | 1 | |
| 100 | 53002 | BALL .75 | 1 | |
| 101 | 53003 | RING RET 125 EXT | 1 | |
| 102 | 53004 | SPACER, THRUST, AXLE, 1.31 X 2.50 X .13 | 1 | |
| 104 | 53006 | WASHER 1.40 X 1.75 X .05 | 1 | |

Parts Breakdown

| # | PART # | DESCRIPTION | QTY | Note |
|-----|--------------|-------------------------------------|-----|------|
| 105 | 53007 | BEARING 35X80X21 BALL 6307 | 1 | [4] |
| 106 | 53008 | SEAL 1.375 X 2.062 X .25 LIP | 1 | |
| 110 | 51796 | KEY 5/16 X 1 WOODRUFF | 1 | |
| 111 | 72038 | KIT, HUB 4 BOLT | 1 | |
| 113 | 51821 | NUT 1-20 HEX SLOTTED | 1 | |
| 114 | 53724 | CAP AXLE | 1 | |
| 115 | 53367 | TUBE 1.40 X 2.22 AXLE | 1 | |
| 116 | 51822 | PIN 9/64 X 2 COTTER EXTENDED PRONG | 1 | |
| 127 | 55523 | SEAL, LIP .562 X .875 X .187, HNBR | 1 | |
| 128 | 53356 | SPACER .57 X .86 X .53 | 1 | |
| 130 | 53018 | HANDLE, ACTUATING | 1 | |
| 131 | 53019 | RING RET 43 EXT KLIPRING | 1 | |
| 140 | 53020 | SEAL .500 X .688 X .094 LIP | 1 | |
| 141 | 54501 | TUBE CHARGE TRIPLE O-RING | 2 | |
| 142 | 71942 | KIT, CHARGE COVER | 1 | |
| 150 | 71943 | KIT, FILTER | 1 | |
| 152 | 71944 | KIT, FILTER PLUG | 1 | |
| 160 | 53026 | SWASHPLATE MOTOR | 1 | |
| 164 | 55524 | SEAL, PLUG .945 X .250, HNBR | 1 | |
| 170 | 53037 | FITTING 5/8 BEADED 7/8 SAE STRAIGHT | 1 | |
| 172 | 9005110-8700 | PLUG 7/8-14 STR THREAD SOCKET HEAD | 1 | |
| 174 | 9005110-5600 | PLUG 9/16-18 METAL | 1 | |
| 180 | 71905 | KIT, FAN/PULLEY | 1 | |
| 200 | 73190 | KIT, SEAL | 1 | |
| 201 | 71951 | KIT RTN BIDIRECTIONAL | 1 | |
| 202 | 72748 | KIT, BRAKE ROTOR, GEAR | 1 | |

PART NOTES:

- [1] - PATCH
- [2] - 21cc
- [3] - 16cc
- [4] - 6307