

Parts Breakdown

NOTICE - PROPRIETARY INFORMATION: THIS SERVICE SCHEMATIC AND ITS CONTENTS ARE WHOLLY OWNED BY HYDRO-GEAR OF SULLIVAN, IL, AND MAY NOT BE USED, DISCLOSED, PUBLISHED OR REPRODUCED WITHOUT THE WRITTEN CONSENT OF HYDRO-GEAR.

ZT-5400 SERVICE SCHEMATIC

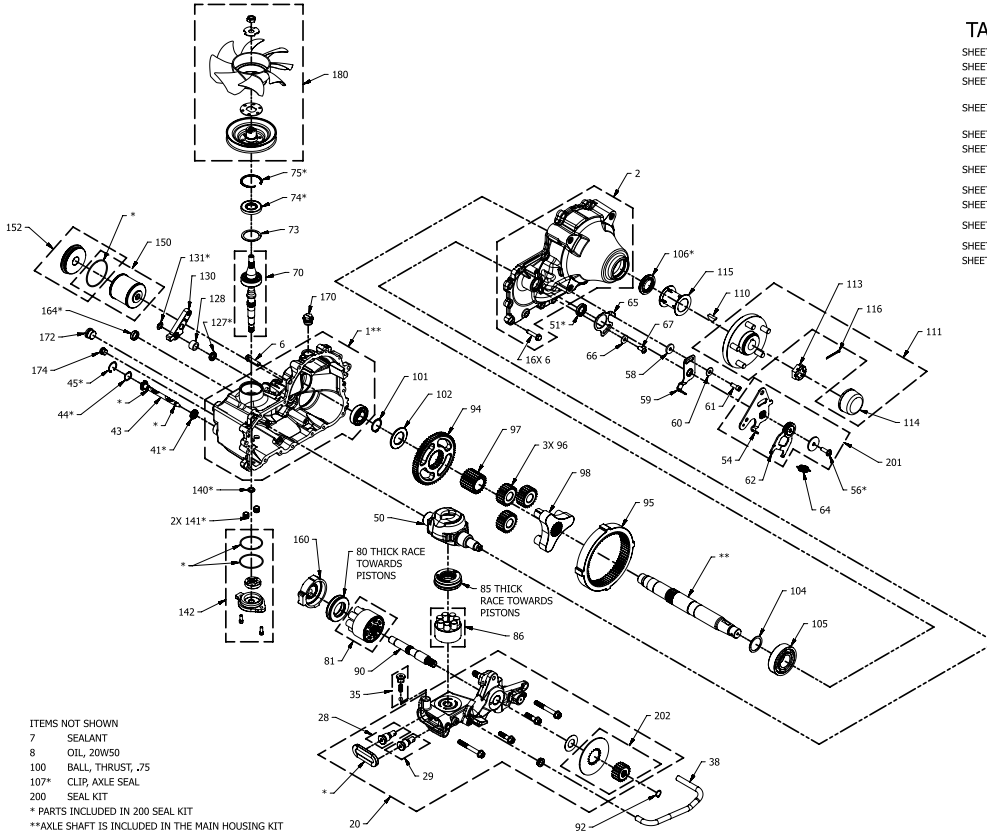

- ITEMS NOT SHOWN
- 7 SEALANT
 - 8 OIL, 20W50
 - 100 BALL, THRUST, .75
 - 107* CLIP, AXLE SEAL
 - 200 SEAL KIT
 - * PARTS INCLUDED IN 200 SEAL KIT
 - **AXLE SHAFT IS INCLUDED IN THE MAIN HOUSING KIT

TABLE OF CONTENTS

SHEET 2	COMMON ITEMS
SHEET 3	MAIN HOUSING OPTIONS
SHEET 4	SIDE HOUSING OPTIONS
SHEET 4	CENTER SECTION OPTIONS
SHEET 5	SHOCK VALVE ROTATION A OPTIONS
SHEET 5	SHOCK VALVE ROTATION B OPTIONS
SHEET 6	GEAR REDUCTION OPTIONS
SHEET 7	AXLE END OPTIONS
SHEET 8	CONTROL ARM OPTIONS
SHEET 8	RTN SPRING OPTIONS
SHEET 9	CONTROL ARM TYPE OPTIONS
SHEET 10	MOTOR RANGE OPTIONS
SHEET 11	FAN/PULLEY OPTIONS
SHEET 12	EXTERNAL COOLING OPTIONS
SHEET 12	BARBED EXPANSION FITTING OPTIONS
SHEETS 13-14	SERVICE CONFIGURATION GUIDE



Parts Breakdown

#	PART #	DESCRIPTION	QTY	Note
1	72689	KIT, HOUSING, MAIN, LH	1	
2	71948	KIT, HOUSING, SIDE, LH	1	
6	53987	SCREW 5/16-18 X 1.5 HEX WASHER	17	
7	50928	SEALANT TUBE	1	
8		OIL, 20W50	1.2 gal	
20	71995	KIT, CENTER SECTION	1	
28	71952	KIT, SHOCK VALVE	1	
29	71952	KIT, SHOCK VALVE	1	
35	71999	KIT, CHARGE RELIEF	1	
38	52984	TUBE, FILTER LH	1	
41	55522	SEAL, LIP 12 X 24 X 5, HNBR	1	
43	54335	ASSEMBLY ACTUATOR BYPASS	1	
44	53321	SPRING WAVE	1	
45	53322	RING RET 102 INT	1	
50	52972	SWASHPLATE 16CC MACHINED	1	
51	55526	SEAL, LIP 22 X 32 X 7 TC, HNBR	1	
54	53222	ARM, CONTROL, LH	1	
56	51812	SCREW 5/16-24 X 1.00 TWHCS PATCH	1	[1]
58	54315	SPACER 0.320 ID X 1.005 OD X 0.1495 THK	1	
59	51946	ARM, NEUTRAL LEFT	1	
60	44130	WASHER .34 X .88 X .06	1	
61	51616	SHCS 5/16-24 X .875	1	[1]
62	52433	ASSEMBLY, RTN UNI-DIRECTIONAL (CCW)	1	[2]
64	51833	SPRING EXT .56 X 2.05	1	
65	53190	PLATE, STOP, LH	1	
66	44130	WASHER .34 X .88 X .06	1	
67	53519	SCREW 5/16-18 X .75 HBHCS	1	
70	71941	KIT, INPUT SHAFT	1	
73	51279	WASHER 1.559 X 1.944 X .040	1	
74	51280	LIP SEAL 25 X 52 X 7 PTC	1	
75	52650	RING RET 206 INT	1	
80	53341	BEARING (21) 42X68X16 PLASTIC THRUST	1	
81	72159	KIT, BLOCK 21CC CYLINDER, PW SERIES	1	[3]
85	52991	BEARING 35X70X21.6 THRUST	1	
86	72897	KIT,BLOCK 16cc CYLINDER	1	[4]
90	52992	SHAFT MOTOR	1	
92	44145	RETAINING RING, MOTOR SHAFT	1	
94	52996	GEAR, 65T/22T	1	
95	53988	GEAR, RING, 68T	1	
96	54483	GEAR, PLANET, 23T	3	
97	53000	GEAR, 22T	1	
98	53001	CARRIER	1	
100	53002	BALL .75	1	
101	53003	RING RET 125 EXT	1	
102	53004	SPACER, THRUST, AXLE, 1.31 X 2.50 X .13	1	
104	53006	WASHER 1.40 X 1.75 X .05	1	

Parts Breakdown

#	PART #	DESCRIPTION	QTY	Note
105	53007	BEARING 35X80X21 BALL 6307	1	[5]
106	53008	SEAL 1.375 X 2.062 X .25 LIP	1	
107	50859	RING, RETAINING 206 INTERNAL	1	
110	51796	KEY 5/16 X 1 WOODRUFF	1	
111	72101	KIT, HUB 4 BOLT	1	
113	51821	NUT 1-20 HEX SLOTTED	1	
114	53724	CAP AXLE	1	
115	53367	TUBE 1.40 X 2.22 AXLE	1	
116	51822	PIN 9/64 X 2 COTTER EXTENDED PRONG	1	
127	55523	SEAL, LIP .562 X .875 X .187, HNBR	1	
128	53356	SPACER .57 X .86 X .53	1	
130	53018	HANDLE, ACTUATING	1	
131	53019	RING RET 43 EXT KLIPRING	1	
140	53020	SEAL .500 X .688 X .094 LIP	1	
141	54501	TUBE CHARGE TRIPLE O-RING	2	
142	71942	KIT, CHARGE COVER	1	
150	71943	KIT, FILTER	1	
152	71944	KIT, FILTER PLUG	1	
160	53026	SWASHPLATE MOTOR	1	
164	55524	SEAL, PLUG .945 X .250, HNBR	1	
170	9005200-8700	PLUG, SHIPPING 7/8-14	1	
172	9005110-8700	PLUG 7/8-14 STR THREAD SOCKET HEAD	1	
174	9005110-5600	PLUG 9/16-18 METAL	1	
180	71906	KIT, FAN/PULLEY	1	
200	73190	KIT, SEAL	1	
201	72002	KIT RTN LH UNI-DIRECTIONAL	1	
202	72748	KIT, BRAKE ROTOR, GEAR	1	

PART NOTES:

- [1] - PATCH
- [2] - CCW
- [3] - 21cc
- [4] - 16cc
- [5] - 6307