

# Parts Breakdown

NOTICE - PROPRIETARY INFORMATION: THIS SERVICE SCHEMATIC AND ITS CONTENTS ARE WHOLLY OWNED BY HYDRO-GEAR OF SULLIVAN, IL, AND MAY NOT BE USED, DISCLOSED, PUBLISHED OR REPRODUCED WITHOUT THE WRITTEN CONSENT OF HYDRO-GEAR.

## ZT-5400 SERVICE SCHEMATIC

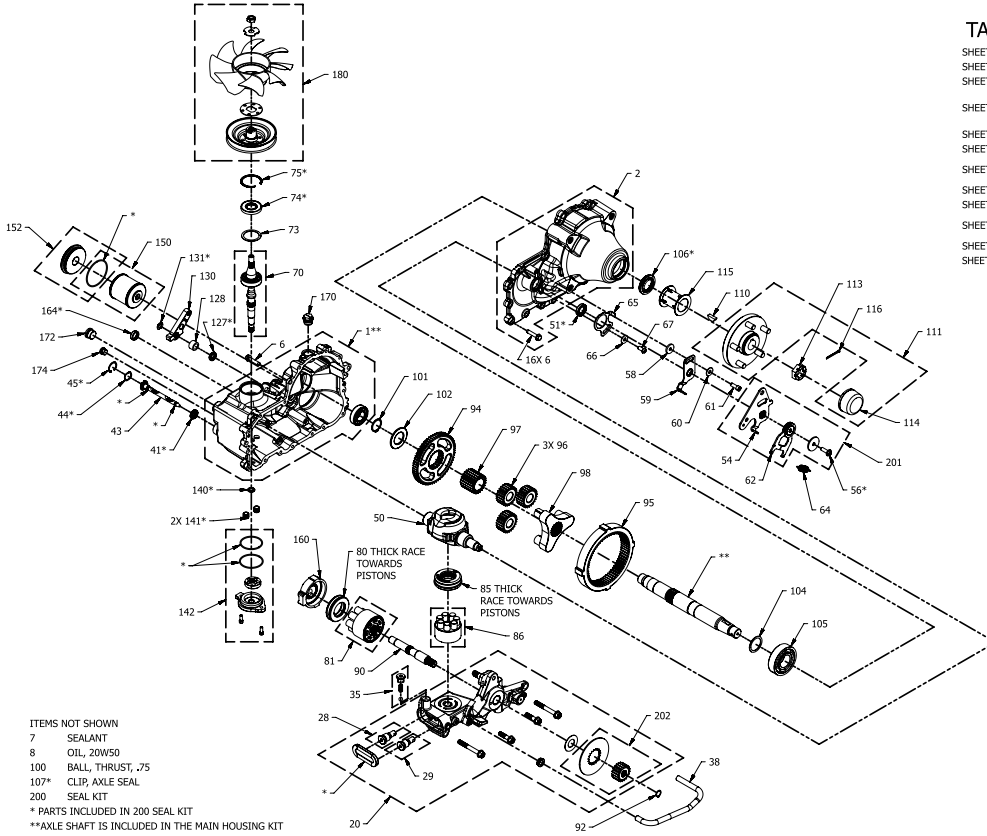

### TABLE OF CONTENTS

|              |                                  |
|--------------|----------------------------------|
| SHEET 2      | COMMON ITEMS                     |
| SHEET 3      | MAIN HOUSING OPTIONS             |
| SHEET 4      | SIDE HOUSING OPTIONS             |
|              | CENTER SECTION OPTIONS           |
| SHEET 5      | SHOCK VALVE ROTATION A OPTIONS   |
|              | SHOCK VALVE ROTATION B OPTIONS   |
| SHEET 6      | GEAR REDUCTION OPTIONS           |
| SHEET 7      | AXLE END OPTIONS                 |
| SHEET 8      | CONTROL ARM OPTIONS              |
|              | RTN SPRING OPTIONS               |
| SHEET 9      | CONTROL ARM TYPE OPTIONS         |
| SHEET 10     | MOTOR RANGE OPTIONS              |
| SHEET 11     | FAN/PULLEY OPTIONS               |
| SHEET 12     | EXTERNAL COOLING OPTIONS         |
|              | BARBED EXPANSION FITTING OPTIONS |
| SHEETS 13-14 | SERVICE CONFIGURATION GUIDE      |

- ITEMS NOT SHOWN
- 7 SEALANT
  - 8 OIL, 20W50
  - 100 BALL, THRUST, .75
  - 107\* CLIP, AXLE SEAL
  - 200 SEAL KIT
  - \* PARTS INCLUDED IN 200 SEAL KIT
  - \*\*AXLE SHAFT IS INCLUDED IN THE MAIN HOUSING KIT



## Parts Breakdown

| #   | PART # | DESCRIPTION                             | QTY     | Note |
|-----|--------|---|---------|------|
| 1   | 72688  | KIT, HOUSING, MAIN, RH                  | 1       |      |
| 2   | 71949  | KIT, HOUSING, SIDE, RH                  | 1       |      |
| 6   | 53987  | SCREW 5/16-18 X 1.5 HEX WASHER          | 17      |      |
| 7   | 50928  | SEALANT TUBE                            | 1       |      |
| 8   |        | OIL, 20W50                              | 1.2 gal |      |
| 20  | 71996  | KIT, CENTER SECTION                     | 1       |      |
| 28  | 71952  | KIT, SHOCK VALVE                        | 1       |      |
| 29  | 71952  | KIT, SHOCK VALVE                        | 1       |      |
| 35  | 71999  | KIT, CHARGE RELIEF                      | 1       |      |
| 38  | 52983  | TUBE, FILTER RH                         | 1       |      |
| 41  | 55522  | SEAL, LIP 12 X 24 X 5, HNBR             | 1       |      |
| 43  | 54335  | ASSEMBLY ACTUATOR BYPASS                | 1       |      |
| 44  | 53321  | SPRING WAVE                             | 1       |      |
| 45  | 53322  | RING RET 102 INT                        | 1       |      |
| 50  | 52972  | SWASHPLATE 16CC MACHINED                | 1       |      |
| 51  | 55526  | SEAL, LIP 22 X 32 X 7 TC, HNBR          | 1       |      |
| 54  | 53221  | ARM, CONTROL, RH                        | 1       |      |
| 56  | 51812  | SCREW 5/16-24 X 1.00 TWHCS PATCH        | 1       | [1]  |
| 58  | 54315  | SPACER 0.320 ID X 1.005 OD X 0.1495 THK | 1       |      |
| 59  | 51945  | ARM, NEUTRAL RIGHT                      | 1       |      |
| 60  | 44130  | WASHER .34 X .88 X .06                  | 1       |      |
| 61  | 51616  | SHCS 5/16-24 X .875                     | 1       | [1]  |
| 62  | 52432  | ASSEMBLY, RTN BI-DIRECTIONAL            | 1       |      |
| 64  | 52401  | SPRING EXT .63 X 2.05                   | 1       |      |
| 65  | 53189  | PLATE, STOP, RH                         | 1       |      |
| 66  | 44130  | WASHER .34 X .88 X .06                  | 1       |      |
| 67  | 53519  | SCREW 5/16-18 X .75 HBHCS               | 1       |      |
| 70  | 71941  | KIT, INPUT SHAFT                        | 1       |      |
| 73  | 51279  | WASHER 1.559 X 1.944 X .040             | 1       |      |
| 74  | 51280  | LIP SEAL 25 X 52 X 7 PTC                | 1       |      |
| 75  | 52650  | RING RET 206 INT                        | 1       |      |
| 80  | 53341  | BEARING (21) 42X68X16 PLASTIC THRUST    | 1       |      |
| 81  | 72159  | KIT, BLOCK 21CC CYLINDER, PW SERIES     | 1       | [2]  |
| 85  | 52991  | BEARING 35X70X21.6 THRUST               | 1       |      |
| 86  | 72897  | KIT,BLOCK 16cc CYLINDER                 | 1       | [3]  |
| 90  | 52992  | SHAFT MOTOR                             | 1       |      |
| 92  | 44145  | RETAINING RING, MOTOR SHAFT             | 1       |      |
| 94  | 52996  | GEAR, 65T/22T                           | 1       |      |
| 95  | 53988  | GEAR, RING, 68T                         | 1       |      |
| 96  | 54483  | GEAR, PLANET, 23T                       | 3       |      |
| 97  | 53000  | GEAR, 22T                               | 1       |      |
| 98  | 53001  | CARRIER                                 | 1       |      |
| 100 | 53002  | BALL .75                                | 1       |      |
| 101 | 53003  | RING RET 125 EXT                        | 1       |      |
| 102 | 53004  | SPACER, THRUST, AXLE, 1.31 X 2.50 X .13 | 1       |      |
| 104 | 53006  | WASHER 1.40 X 1.75 X .05                | 1       |      |

## Parts Breakdown

| #   | PART #       | DESCRIPTION                        | QTY | Note |
|-----|--------------|------------------------------------|-----|------|
| 105 | 53007        | BEARING 35X80X21 BALL 6307         | 1   | [4]  |
| 106 | 53008        | SEAL 1.375 X 2.062 X .25 LIP       | 1   |      |
| 107 | 50859        | RING, RETAINING 206 INTERNAL       | 1   |      |
| 110 | 51796        | KEY 5/16 X 1 WOODRUFF              | 1   |      |
| 111 | 72039        | KIT, HUB 5 BOLT                    | 1   |      |
| 113 | 51821        | NUT 1-20 HEX SLOTTED               | 1   |      |
| 114 | 53724        | CAP AXLE                           | 1   |      |
| 116 | 51822        | PIN 9/64 X 2 COTTER EXTENDED PRONG | 1   |      |
| 127 | 55523        | SEAL, LIP .562 X .875 X .187, HNBR | 1   |      |
| 128 | 53356        | SPACER .57 X .86 X .53             | 1   |      |
| 130 | 53018        | HANDLE, ACTUATING                  | 1   |      |
| 131 | 53019        | RING RET 43 EXT KLIPRING           | 1   |      |
| 140 | 53020        | SEAL .500 X .688 X .094 LIP        | 1   |      |
| 141 | 54501        | TUBE CHARGE TRIPLE O-RING          | 2   |      |
| 142 | 71942        | KIT, CHARGE COVER                  | 1   |      |
| 150 | 71943        | KIT, FILTER                        | 1   |      |
| 152 | 71944        | KIT, FILTER PLUG                   | 1   |      |
| 160 | 53026        | SWASHPLATE MOTOR                   | 1   |      |
| 164 | 55524        | SEAL, PLUG .945 X .250, HNBR       | 1   |      |
| 170 | 9005200-8700 | PLUG, SHIPPING 7/8-14              | 1   |      |
| 172 | 9005110-8700 | PLUG 7/8-14 STR THREAD SOCKET HEAD | 1   |      |
| 174 | 9005110-5600 | PLUG 9/16-18 METAL                 | 1   |      |
| 180 | 71905        | KIT, FAN/PULLEY                    | 1   |      |
| 200 | 73190        | KIT, SEAL                          | 1   |      |
| 201 | 71951        | KIT RTN BIDIRECTIONAL              | 1   |      |
| 202 | 72748        | KIT, BRAKE ROTOR, GEAR             | 1   |      |

**PART NOTES:**

- [1] - PATCH
- [2] - 21cc
- [3] - 16cc
- [4] - 6307