

# OHELLA

## Portable Water Flosser



(OH-OI03WH)

- Please read the user manual and use the product correctly.
- Please read the safety precautions and use the product correctly.
- This user manual includes warranty.

# Part names

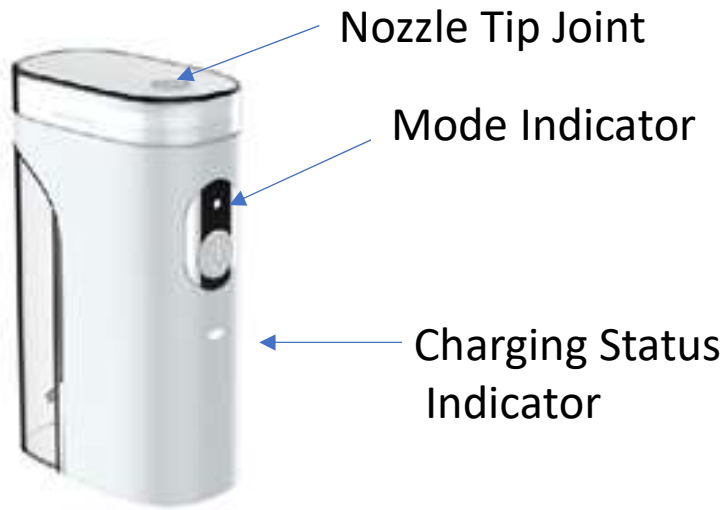

Back

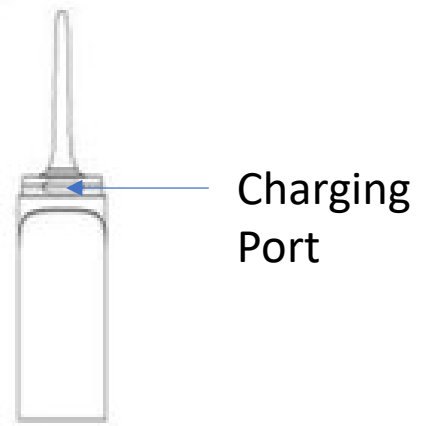

Lower

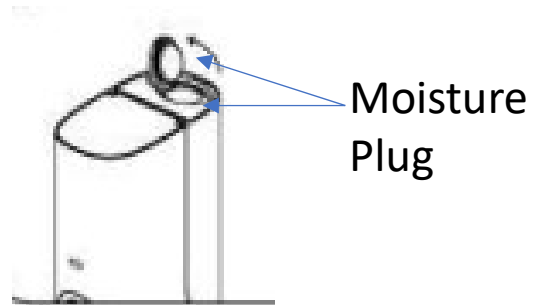

# Dimensions

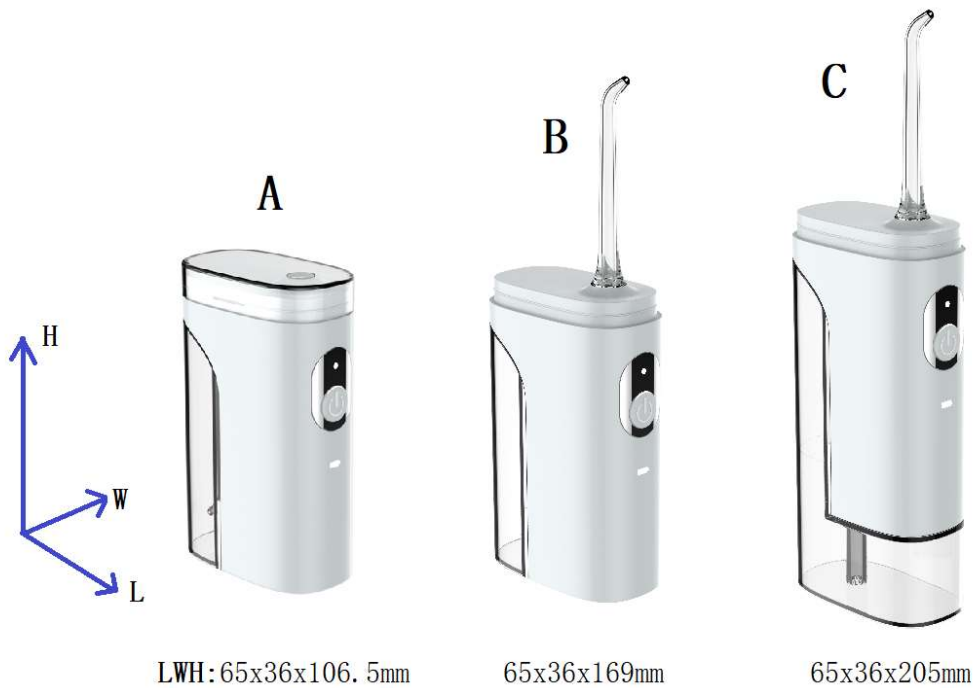

# Components



Main Body

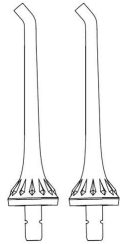

Nozzle Tip\*2ea



Large Capacity Water Bottle (100ml)



Small Water Bottle (50ml)



Cover



Charging Port Cover

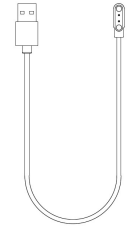

Charging Cable



Manual

# Product Specifications

Name	Portable Mouthwash
Model	OH-OI03WH
Rated Voltage	5 Vdc, 1 A
Battery	Li-ion, 3.7 Vdc, 1000 mAh
Waterproof	IPX7
Water Pressure	40~90 PSI
Operating Time	1 minute usage Use up to 30 minutes
Charging Time	~4 Hours
Capacity	100 mL/50ml
Dimensions	Body (50ml With 50ml Bottle)- 65x36x106.5mm Body (50ml With Nozzle)- 65x36x169mm Body (100ml With Nozzle)- 65x36x205mm

# Safety Precautions

- This is to protect user safety and prevent property damage.
- Please read the information below carefully and use the product correctly.

## Warning

---

- This product is not intended for use by persons (including children) who lacks physical, sensory, mental abilities or who lacks experience and knowledge to safely use the product without supervision or direction.
- **Keep away from children.**
- Children under the age of 6 to be use under parental supervision.
- Keep the nozzle tip out of reach from children.
- **If you are experiencing tooth or gum pain, keep away from the product, consult your dentist first.**
- **Keep water temperature below 40 degrees.**

## Precautions

---

- People who are intoxicated, infants and those who require surgery to stay away from the product.
- **Keep out of reach from children.**
- **Do not disassemble, modify, or repair arbitrarily.**
- **Remove outlet if product gets submerged in water.**
- **Do not use while bathing.**
- **Do not immerse in water for a long time to avoid loss of function.**
- Do not charge in a humid place or when the product is wet.
- **Do not use without nozzle.**
- **Do not use iodine, brine, or water-insoluble concentrated oils while using the product.**
- Keep away from liquids and heat, use in dry environment.

# Medical Warnings

---

- Consult your dentist before usage if you had oral or periodontal surgery in the past 12 months.
- When starting a new oral hygiene, gums may bleed slightly. If excessive bleeding occurs after 2 weeks of use, consult your dentist.
- Do not use mouthwash or rinses that contain iodine, bleach or tea tree oil.
- Do not use if you have open wounds on tongue or mouth.
- If advised to take antibiotics prior to dental procedure, consult dentist before using the product.
- Make sure that the nozzle tip touches teeth, gums or tongue. Contact with other areas may lead to damage.
- Use only for oral hygiene cleaning. Do not use for other purposes.
- With any new oral hygiene program, individuals with heart disease should consult a physician prior to using the product.

## Charging Method

---

Note: Charging voltage of this device is 5V DC. Before charging, make sure the output of the voltage matches the voltage (5V DC) indicated on the nameplate. High voltage will damage the device.

1. If the charging light starts flashing during or after use, the battery is low and requires charge.
2. Using the USB charging cable provided, connect to a computer USB port or smartphone charger to charge the device. (Voltage is 5V DC)

As shown below, open the USB sealing plug on the right side of the top cover, insert the USB cable to charge.

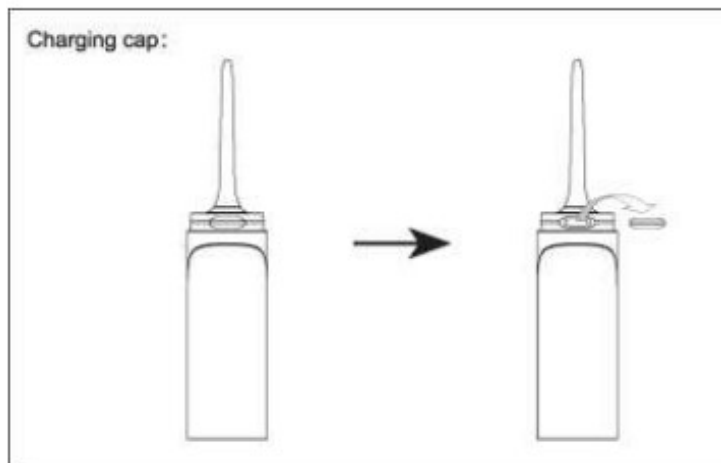

4. When charging, the light on the front handle will flash.
5. When device is fully charged, the light will stay on.
6. Takes about 4 hours for the device to charge fully. (vary as it depends on environment)

# How to Install

---

## <How to install nozzle tip>

Step1. Adjust nozzle tip pointing to the right, align the buckle on the tip with the slot on the handle, then push the tip downwards until it is secured and attached to the handle.



Step2. Rotate 90 degrees to the left until it points forward facing you.

Step3. After use, turn off the product and rotate the nozzle 90 degrees to the right, pull the nozzle to detach.

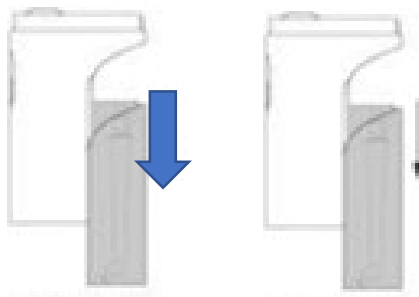

Step4. When replacing the water tank, pull downwards to separate the water tank from body, replace the water tank afterwards.

Tip> If you push upwards, you will hear a 'click' sound and the water tank combines with the body.

Step5. After combining, open the rubber cover at the bottom of the water tank and fill it with water before use.

Note: Some mouthwash products may damage the device. Do not add mouthwash to the device.

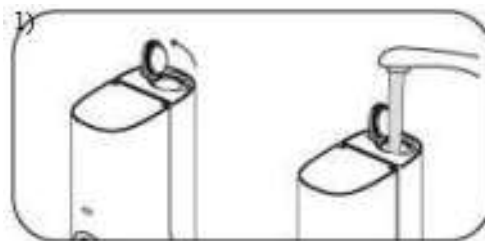

# Instructions for use

---

When using the mouthwash for the first time, you may experience itch or bleed on your gums. This is natural and the bleeding usually disappears in a week or two.

1. Before using, lean slightly over the sink and insert the nozzle tip to your mouth and orient your teeth or gums.

- Adjust the direction so that the water stream is perpendicular to the cleaning area.

2. Press the power button to turn on. White LED indicator lights up and enters normal mode. Press the button again after 2 seconds to switch modes. (Soft Mode) Press once again to turn device off, press power button after 2 seconds to turn off the device. Functional mode resumes after exit.

\* The white LED indicator is brighter in normal mode and darker in soft.

\* Product Mode

[Normal] : Suitable for normal cleaning of teeth.

[Soft] : Suitable for users with sensitive teeth. Can be washed gently without irritation.

TIPS :

For a comfortable experience, when using the product for the first time, we recommend using the soft mode for a week then switching to normal mode until you get used to it.

- If you need to continue using, refill the water before usage.

3. Start from the molar area and use in the direction of the front teeth.

- Move vertically along the gum line and between your teeth.

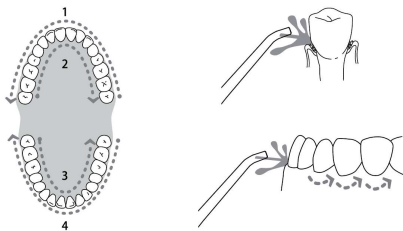

4. After usage, remove water tank and discard remaining water. Set up the nozzle tip to face the sink and operate the flosser till the water stops flowing.

- Mouthwash products have a 1-minute timer.
- When water no longer spouts, turn off the flosser.

# Cleaning & Maintenance

## How to clean the body

1. Be sure to wash the product with clean water or neutral detergent, avoid corrosive or abrasive detergents.
2. Do not wash the appliance with hot water above 50 degrees.
  - This may result in malfunction or damage to the product.
3. Do not soak the product in water for a long time and, if necessary, wipe the surface with a soft cloth or cleaner.

## How to clean the water tank

1. Rinse the insides of the water tank with clean water at room temperature and do not use any detergent. .

## How to wash the sediment

1. Depending on the mineral contents of the water, accumulation of water deposits may occur in the unit.
2. After using clean and warm water, remove the water container, immerse the hose at the bottom of the main body.
  - When use repeatedly every 1-3 months, the product is durable.

## How to store

1. After washing the device, dry it.
2. Store in packaged state.
3. If not used for long periods, clean and store it. Charge once every 6 months to protect the battery.
4. Avoid violent vibrations, bumps, bangs or drops.
5. Do not store in direct sunlight and in damp places.

## Checklist before reporting a breakdown

Issue	Resolution
Power does not turn on.	Charge the battery fully.
Weak water pressure.	Charge battery fully. Check if there is any foreign matter in nozzle tip.
No water coming out.	Charge battery fully. Make sure water tank is filled with water.