

OHELLA

Ohella Mouthwash Cordless Water Flosser



(OH-0102WPWH / OH-0102WPNY)

- Be sure to read the user manual and use correctly.
- Be sure to read the safety precautions and use product correctly.
- This user manual includes product warranty, so keep it close.

Safety Precautions

This is to protect user's safety and prevent property damage.
Please read the information below carefully.

Warning

- This product is not intended for use by persons (including children) who lacks physical, sensory or mental abilities, or lacks the experience and knowledge to use the product safely.
- Keep away from children.
- Children under age of 6 must use with parental supervision.
- Keep the nozzle out of reach from children.
- The nozzle tip is small and can get caught in the throat if swallowed.
- Those with periodontal disease or had oral surgery within last 2 months should consult a doctor before using.
- If experiencing tooth or gum pains, be sure to consult your dentist before using the product.
- Do not use hot water above 40 degrees to avoid burns.

Caution

- People who are intoxicated, infants or requires surgery to keep prohibited from using.
- Keep out of reach from children.
- Do not disassemble, modify, or repair arbitrarily.
- Do not store the product in a location with narrow spaces.
- If gets wet or submerged in water, remove the outlet first.
- Do not use when bathing.
- Do not immerse in water for long periods of time to avoid loss of function.
- Do not charge in a humid place or when product is wet.
- Do not use the product without a nozzle.
- Do not press too hard on the spray tip to avoid injuring your gums or teeth.
- Do not use iodine juice, brine, or concentrated oils.
- Do not put pure mouthwash liquid into the product. If necessary, add mouthwash after diluting in proportion.
- Keep away from liquids and heat, use in dry environment.
- Disconnect the adapter after fully charging.
- Do not use anything other than the supplied nozzle.
- Use the mouthwash according to the instructions.
- Recommended charging at 5V, 1A or higher. *Does not support fast charging
- Do not charge with more than 9V.

Specifications

Product Name	Mouthwash
Model Name	OH-OI02WPWH / OH-OI02WPNY
Power	5 Vdc, 1 A
Battery	Li-ion, 3.7 Vdc, 800 mAh
Waterproof	IPX7
Pressure	60 psi
Operating Time	2 minutes operation / use up to 30 minutes
Charging Time	2.5 Hours
Volume	100 mL
Noise	73 dB
Weight	200 g
Dimensions	52 x 52 x 190 mm

Name of parts

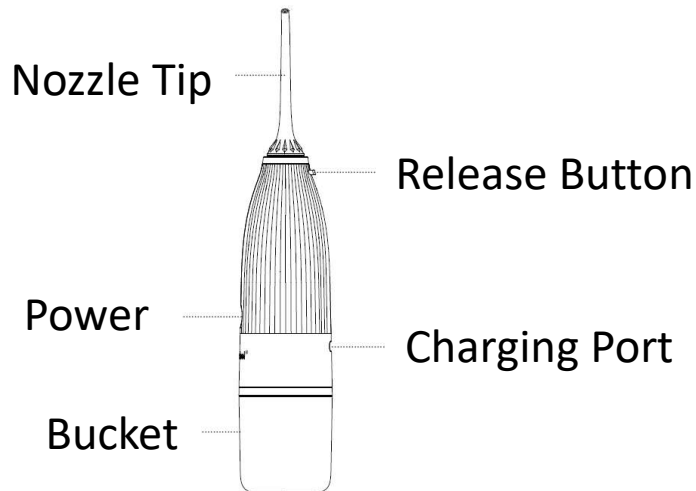

Components



Main Body

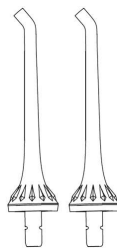

Nozzle Tip

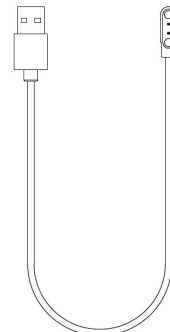

USB Cable

Instructions

✘ Be sure to connect the charging cable and fully charge the device before usage the first time.

✘ The product cannot be used while charging.

1. Turn the water tank to the left and pull down to separate the water tank.

- Pour water in line with the top of the transparent section of the tank

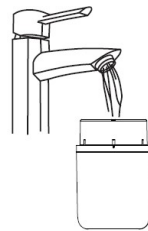

2. After adding water, insert the water tank into the body and turn to the right to fixate it.

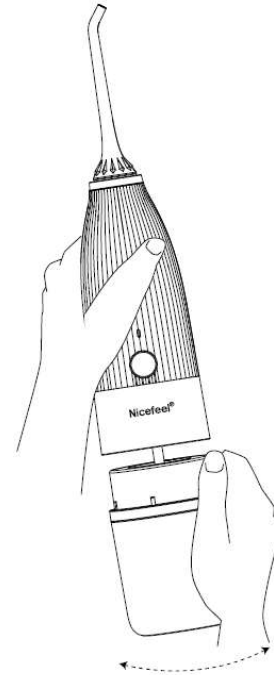

3. Insert nozzle tip to be used until it is secured.

- When inserted fully, a 'click' sound can be heard.

4. To remove the nozzle tip after use, lift the nozzle tip upwards while pressing the tip release button.

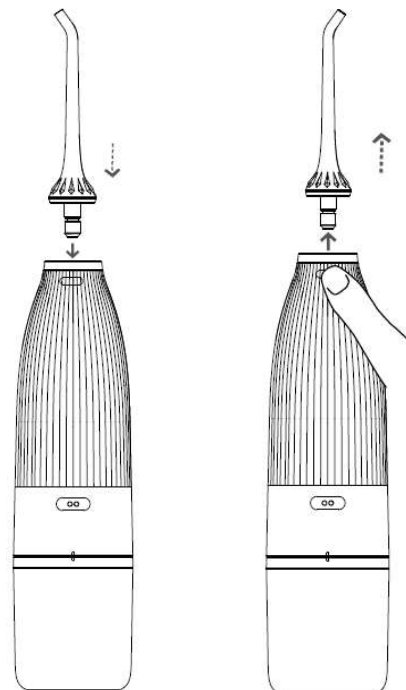

✂ If using the mouthwash for the first time, you may experience itching or some bleeding from your gums. This is natural and the bleeding usually disappears after a week or two.

5. Before usage, lean slightly over the sink and insert the nozzle tip into your mouth to orient your teeth or gums.
 - Adjust the direction so that the water stream is perpendicular to the cleaning area.
6. Press and hold the power button for 2 seconds to turn on the power and spray. To pause while in use, press and hold the power button for 2 seconds.
 - When the power is on, it automatically shuts down after 2 minutes.
 - To continue using, use after refilling water.
7. Start from the molar area and work your way to the front teeth.
 - Move vertically along the gums and between your teeth.

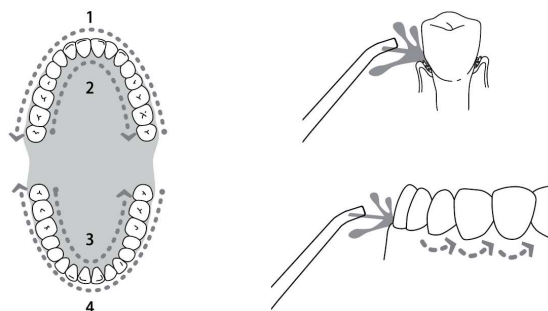

8. After use, remove the water tank and discard the remaining water. Set the nozzle tip to face the sink and operate until water stops flowing.
 - When the water no longer spouts, turn it off.

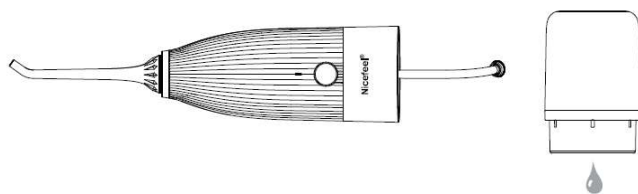

9. When using, the LED indicator flashes white, when low battery the indicator flashes 5 times and shuts off.
 - When the power is on without battery, the LED blinks 3 times and will shut off afterwards.
 - When charging, the LED blinks to indicate charging status.
 - When product is fully charged, the LED indicator will be always on.

Cleaning & Maintenance

How to clean the body

1. Be sure to wash the product with clean water or neutral detergent, avoid using corrosive or abrasive detergents.
2. Do not wash the appliance with hot water above 50 degrees.
 - May cause malfunction or damage to the product.
3. Do not soak the product in water for a long time and, if necessary, wipe the surface with a soft cloth and cleaner.

How to clean the water tank

1. Rinse the insides of the water tank with clean water at room temperature and do not use any detergent..
 - May cause bodily injury.

How to wash sediment

1. Depending on the mineral content of the water, hard water deposits may accumulate in the unit.
2. After cleaning with warm water, remove the tank, immerse the hose at the bottom of the main body and operate the machine until the water runs out.
 - When used repeatedly every 1 to 3 months, the product has a longer shelf life.

How to store

1. After washing the device with a towel, keep it dry.
2. Store product in its packaged state.
3. If it is not used for a long period of time, clean and store it. Charge once every 6 months to protect the battery.
4. Avoid violent vibrations, bumps, bangs or drops.
5. Do not store in direct sunlight and humid places.

Things to check before reporting a breakdown

Issue	Resolution
Power does not on.	Charge fully the battery.
Weak water pressure.	Charge fully the battery. Check if there are any foreign objects stuck in the nozzle tip.
No water coming out.	Charge fully the battery. Check if water is in the water tank.