



## RAMP CONTROL CARTRIDGE INSTALLATION

### TOOLS NEEDED:

- 24mm socket and wrench
- 11mm socket
- Cassette lock-ring tool (Park Tool FR-5 or equivalent)
- Small amount of slick honey or equivalent lubrication

## ATTENTION:

If air pressure is not released from fork before upgrade cartridge installation, injury or damage to fork may occur!

1) Release all air pressure from air spring by depressing the Schrader valve core on the air leg of the fork. To ensure all air is release from both chambers cycle the fork 2-3 times and depress the valve core again.

2) After air pressure is released, use 24mm socket to remove existing air spring top cap.

3) Remove the dust cap from the upgrade cartridge to access the lock nut.

4) Use the 11mm socket to remove the lock nut and allow for removal of the ramp knob and access to the cassette tool interface.

5) Lightly grease O-ring on upgrade cartridge top cap taking care to keep grease off of threads.

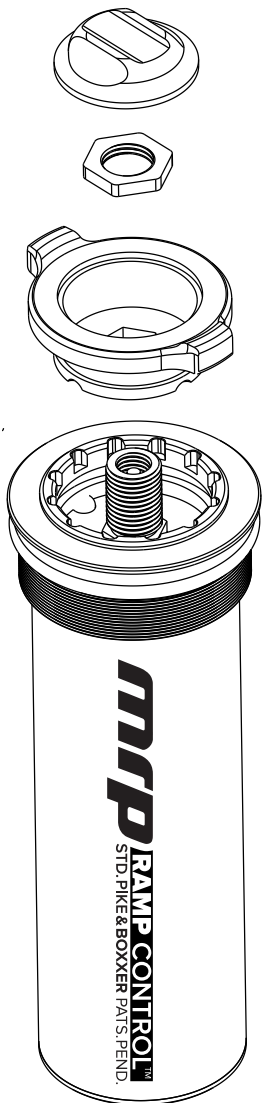

6) Insert upgrade cartridge into air leg and tighten using cassette tool. Tighten top cap to 28 Nm (250 in-lb) for Pike, Lyrik, Yari, or to 7.3 Nm (65 in-lb) for Boxxer.

7) Insert ramp knob into top cap ensuring that the hex is fully seated in the cap.

8) Tighten lock nut **by hand**, while holding Ramp Control knob, using an 11mm socket. **IMPORTANT: FAILURE TO HOLD RAMP CONTROL KNOB WHILE TIGHTENING HEX AND SURPASSING 2 Nm OF TORQUE WILL RESULT IN DAMAGE.**

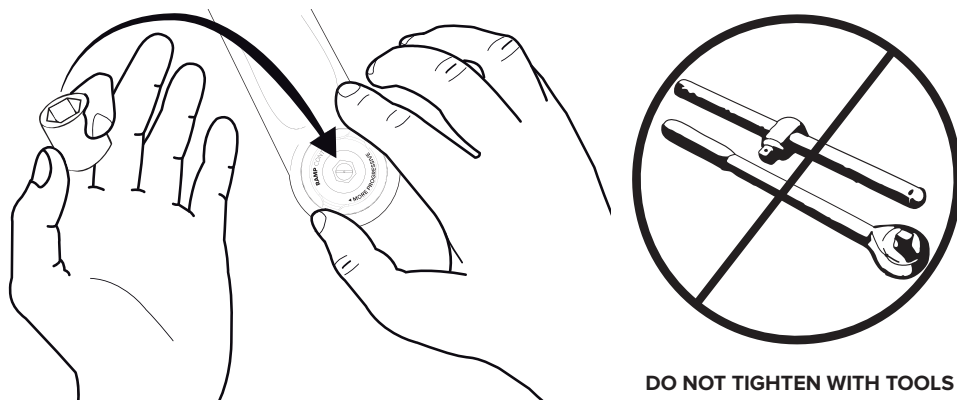

9) Re-inflate fork and install dust cap.

## ATTENTION:

For any service activities that entail removal of lowers or ramp control cartridge, you must turn the ramp control adjustment to the full open position to relieve all air pressure from the spring.

### IMPORTANT CONSUMER SAFETY INFORMATION

*WARNING: RIDING A BIKE IS DANGEROUS. NOT PROPERLY MAINTAINING OR INSPECTING YOUR BIKE AND ITS COMPONENTS IS EVEN MORE DANGEROUS. IT IS ALSO DANGEROUS TO NOT READ AND FOLLOW THESE INSTRUCTIONS.*

1. DO NOT PERFORM ANY MODIFICATIONS OR ADJUSTMENTS THAT ARE NOT OUTLINED IN THIS MANUAL.
2. MRP RECOMMENDS THAT YOU WEAR PROPER SAFETY EQUIPMENT EVERY TIME YOU RIDE, INCLUDING AN APPROVED BICYCLE HELMET. NEVER RIDE AT NIGHT WITHOUT LIGHTS.
3. ALWAYS USE GENUINE MRP PARTS. USE OF AFTERMARKET REPLACEMENT PARTS AND UPGRADES VOIDS ANY WARRANTY AND COULD CAUSE STRUCTURAL FAILURE.

**MRP HIGHLY RECOMMENDS THAT YOU HAVE YOUR RAMP CONTROL CARTRIDGE INSTALLED BY A PROFESSIONAL MECHANIC AT YOUR FAVORITE LOCAL BIKE SHOP. IF YOU HAVE ANY DOUBTS ABOUT HOW TO INSTALL THIS UPGRADE, TAKE IT TO A BIKE SHOP. YOU'LL BE GLAD YOU DID.**