

i.life 160cm x 70cm Rectangular Idealform Bath

ILLUSTRATED

T4771	i.life 160cm x 70cm rectangular idealform bath with no taphole
T4828	i.life Fixation Set
BD264	Ceraplan dual control bath filler
E3183	Unilux 160cm front panel
E3169	Unilux 70cm end panel
S8970	Trap 1½" plastic P with 75mm seal, multi-purpose outlet suitable for plastic and BS copper pipe
E1486	Luxury bath pop-up waste and overflow
A5901	TMV thermostatic mixing valve, 22mm

ILLUSTRATED PRODUCT DETAILS







Weights

T4771	18.70 KG
BD264	2.39 KG
E3183	3.60 KG
E3169	2.58 KG
S8970	1.00 KG
A5901	0.60 KG

Materials

T4771	Acrylic
T4828	Acrylic
BD264	Chrome Plated Brass
E3183	Acrylic
E3169	Acrylic
S8970	Plastic
E1486	Mixed Material
A5901	Chrome Plated Metal

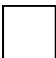
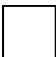
Finishes

T4771		White (01)
T4828		White (01)
BD264		Chrome (AA)
E3183		White (01)
E3169		White (01)
S8970		Neutral / No Finish (67)
E1486		Chrome (AA)
A5901		Chrome (AA)

Capacity

T4771	162.0 litres (to overflow)
--------------	----------------------------

Designer

Palomba Serafini Associati

Standards

EN 198:2008. EN 14516

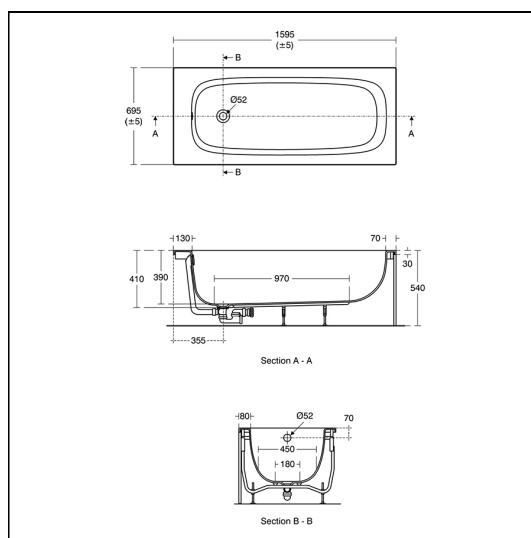

FEATURES

