

# i.life A 104cm Vanity Washbasin

## ILLUSTRATED

- T4621** i.life A 104cm vanity washbasin, 1 taphole
- E0157** Wall fixing set
- BD275** Ceraplan single lever basin mixer with ifix+ and pop up waste
- E0079** Trap 1¼" Contemporary metal bottle, 75mm seal

## OPTIONS

- EE230339** Space saving trap and waste pipe assembly for use with furniture basin units

## ILLUSTRATED PRODUCT DETAILS

### Sizes

**T4621** w:1040 x d:460



### Weights

- T4621** 28.40 KG
- E0157** 0.16 KG
- BD275** 1.47 KG
- E0079** 1.45 KG

### Materials

- T4621** Fine Fireclay
- E0157** Metal
- BD275** Chrome Plated Brass
- E0079** Chrome Plated Metal

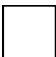
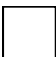
### Finishes

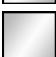
- T4621**  White (01)
- E0157**  Neutral / No Finish (67)
- BD275**  Chrome (AA)
- E0079**  Chrome (AA)

### Capacity

**T4621** 9.1 litres

### Flow rates

**BD275** 5 Litres per minute @ 3 bar pressure

### Designer

Palomba Serafini Associati

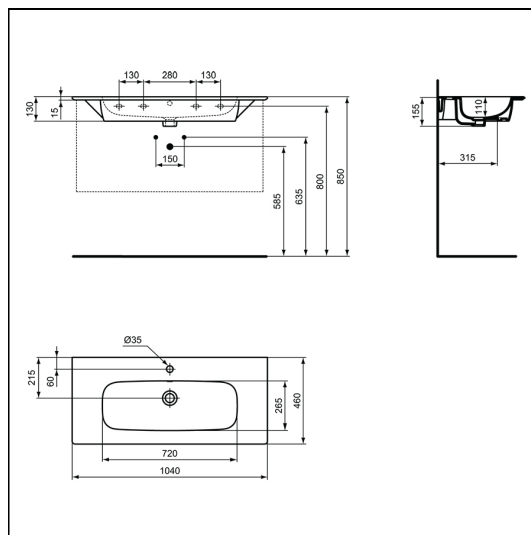

### Standards

Washbasin to BS EN 14688 and BS EN 31

### Special Notes

Washbasin wall mounted using E0157 wall fixing set or supplied on dedicated furniture units. When fitted to furniture washbasin must be secured with the E0157 fixing set.