

34 725 000 GROHTHERM SPECIAL THERMOSTATIC SHOWER MIXER 1/2"

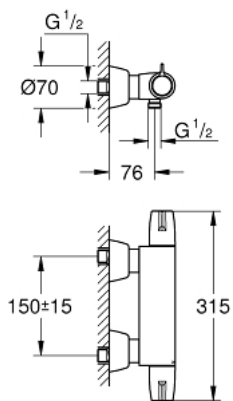

PRODUCT DESCRIPTION

- wall mounted
- ergonomic metal wing handles
- ceramic headparts 1/2", 90°
- **GROHE TurboStat** compact cartridge with wax thermoelement
- temperature scale handle with pre-adjustable safety stop between 35°C and 41°C (calibration required)
- **Thermostatic cartridge max.temperature 41°C (calibration required)**
- integrated mixed water shut off
- shower bottom outlet 1/2" with integrated non return-valve
- metal temperature safety stop
- dirt strainers
- with S-unions, chrome nuts and covers
- GROHE Quickfix for fast exchange of non return valves in connections
- **GROHE CoolTouch** safety housing
- **GROHE StarLight** chrome finish
- **GROHE SafetyPlus** fixed temperature stop
- **TMV3 approved product**

34 725 000 GROHTHERM SPECIAL THERMOSTATIC SHOWER MIXER 1/2"

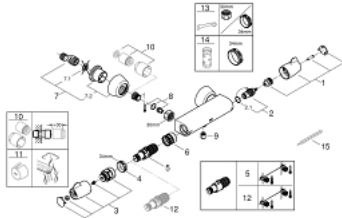

SPARE PARTS

- 1: Shut-off handle (Order-nr. 49006000)
 - 2: Ceramic headpart, 1/2" (Order-nr. 45882000)
 - 2.1: O-Ring Ø18,2 x Ø1,7 (Order-nr. 0392400M)
 - 3: Temperature control handle (Order-nr. 49005000)
 - 4: retaining ring (Order-nr. 47743000)
 - 5: Thermostatic compact cartridge 1/2" (Order-nr. 49071000)
 - 6: Race (Order-nr. 47975000)
 - 7: S-union (Order-nr. 12058000)
 - 7.1: Sealing washer (Order-nr. 0138600M)
 - 7.2: Covering escutcheon (Order-nr. 45545000)
 - 8: Non-return valves (Order-nr. 47979000)
 - 8.1: Non-return valve (Order-nr. 0654400M)
 - 8.2: Fixing set (Order-nr. 48003000)
 - 9: Non-return valve (Order-nr. 08565000)
 - 10: Extension 30 (Order-nr. 46238000)*
 - 11: Temperature unlocking handle (Order-nr. 47994000)*
 - 12: GROHE TurboStat cartridge 1/2" (Order-nr. 47175000)*
 - 13: Special Spanner (Order-nr. 19377000)*
 - 14: Socket Spanner (Order-nr. 19332000)*
 - 15: Adjusting Thermometer (°C) (Order-nr. 19001000)*
- * Optional accessories