

34 361 000 THERMOSTAT MIXER 1/2"

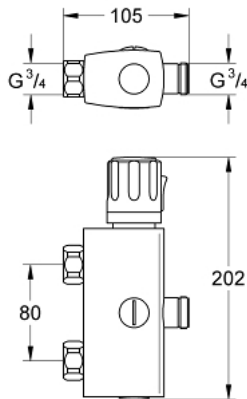

PRODUCT DESCRIPTION

- wall mounted
- wax thermoelement
- outlet 3/4"
- threaded connector 3/4"
- temperature scale handle with
GROHE SafeStop safety stop at 38°C
(**calibration required**)
- built-in non return valves
- dirt strainers
- without connection unions for wall mounting
- without elbow union
- **GROHE StarLight** chrome finish

34 361 000 THERMOSTAT MIXER 1/2"

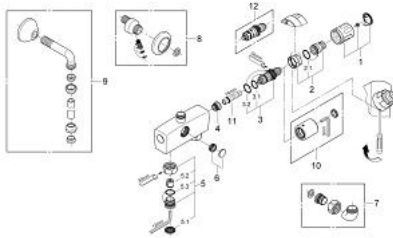

SPARE PARTS

- 1: Scale handle, basic (Order-nr. 47255000)
- 2: Stop ring and regulating nut (Order-nr. 47167000)
- 2.1: O-Ring Ø24 x Ø2 (Order-nr. 0119600M)
- 3: Thermo-element (Order-nr. 47450000)
- 3.1: O-Ring Ø21 x Ø2 (Order-nr. 0599900M)
- 3.2: O-Ring Ø24 x Ø2 (Order-nr. 0119600M)
- 4: Thermostat seat (Order-nr. 01460000)
- 5: Non-return valve (Order-nr. 47189000)
- 5.1: Filter (Order-nr. 0726400M)
- 5.2: Non-return valve (Order-nr. 08565000)
- 5.3: O-Ring Ø17 x Ø2 (Order-nr. 0305500M)
- 6: Nipple (Order-nr. 47195000)
- 7: Elbow union (Order-nr. 12419000)*
- 8: S-union (Order-nr. 12400000)*
- 9: Wall union, male 1/2" (Order-nr. 12407000)*
- 10: Loose key and shield (Order-nr. 47350000)*
- 11: Socket Spanner (Order-nr. 19070000)*
- 12: Thermo-element 1/2" for reverse waterways (Order-nr. 47282000)*

* Optional accessories