

matki | SHOWERING

BOUTIQUE WALK-IN WITH TRAY AND HINGE PANEL

INSTALLATION

PARTS LIST

MODELS INCLUDING BLADE MIXER ASSEMBLY:

NWSC/TBH, NWSR/TBH, NWCC/TBH, NWST/TBH

MODELS WITH TRAY ONLY:

NWSC/TH, NWSR/TH, NWCC/TH, NWST/TH

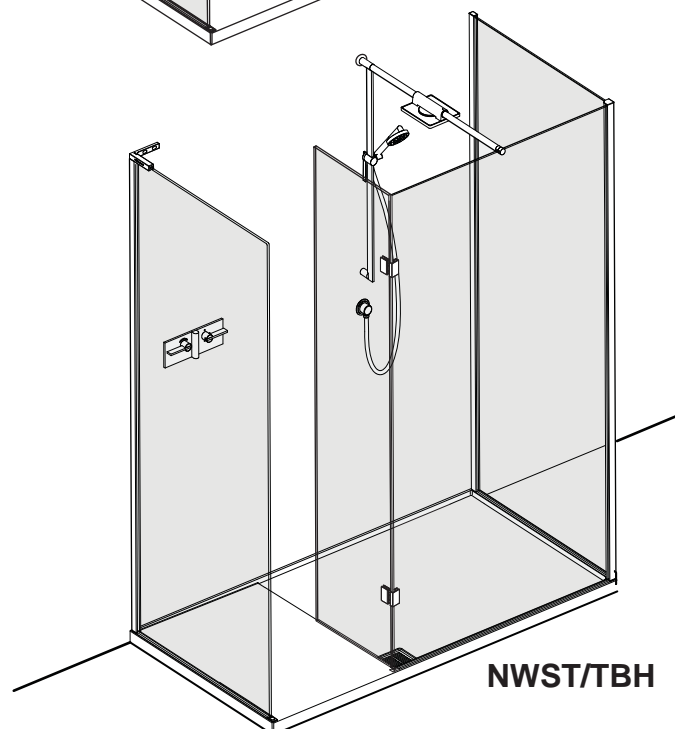
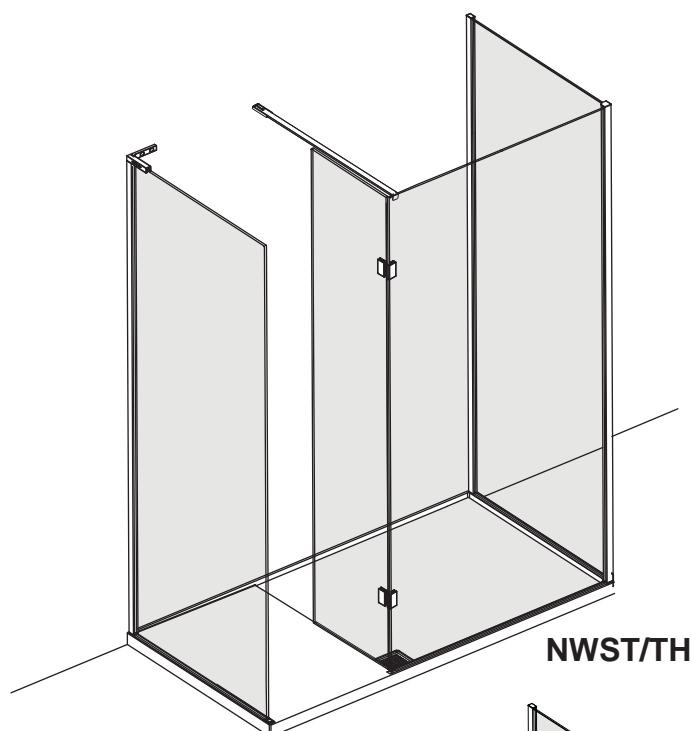

MATKI PLC, CHURCHWARD ROAD, YATE, BRISTOL BS37 5PL
TELEPHONE:01454 322 888 FAX:01454 315 284 EMAIL:techsupport@matki.co.uk

IMPORTANT

TOOLS REQUIRED

Masonry Drill bit 6mm, Tape Measure, Screw Drivers, Safety Glasses, Electric Drill, Level, Pencil, Adjustable Spanners, Non Slip Gloves

Before disposing of carton and/or commencing assembly, please check all the parts to ascertain that none are missing and they are all undamaged. No claim for missing/damaged parts will be accepted once the packing carton has been disposed of and/or assembly has commenced. In case of query contact your Stockist with details of model number and details of serial number.

PREPARATION IMPORTANT

1. Please read complete installation instructions before fitting the enclosure and tray (if fitting).
2. We recommend that two people are available for fitting of the glass panels.
The **Boutique Walk-in** range is **8 and 10mm Glass** construction. Large glass panels are very heavy. We recommend the use of safety glasses and non slip gloves when handling the glass panels.
3. Ensure that the product can be **fixed to a solid masonry wall** or suitable **timber stud work grade C16/C24** in the area behind the wall frames and panel fixing brackets.
4. Shower trays or tiled floors **must be absolutely level** where enclosures are fitted.
5. If fitting a tray we recommend a **drainage test** is carried out before the tray is tiled in position.
6. The assembly should be installed onto a waterproof wall covering and installed after the tray and wall coverings are in place. Trays with tiling lips should be let into the wall with the tiling lip flush with the wall to allow the tiling to overlap the tiling lip.
7. Seal between tray and tiles. Remove any excess sealant from the area/joint between the tray and the tiles where the wall mount is to be fitted. This will ensure the wall mount fits correctly to the wall and tray/or tiled floor.

CAUTION: TEMPERED GLASS CANNOT BE CUT, POLISHED METAL AND CHROME CAN BE SCRATCHED. CAREFULLY REMOVE ASSEMBLY FROM CARTON, DO NOT PLACE GLASS ON HARD FLOOR OR EXPOSE EDGES TO IMPACT.

DIMENSIONS

Dimensions are approximate
Model shown NWST/TBH 1790LH

	A	B	C	D	E
MODEL 1290	1200mm	900mm	320mm	530mm	440mm
MODEL 1590	1500mm	900mm	470mm	530mm	490mm
MODEL 1780	1700mm	800mm	545mm	580mm	490mm
MODEL 1790	1700mm	900mm	545mm	580mm	540mm

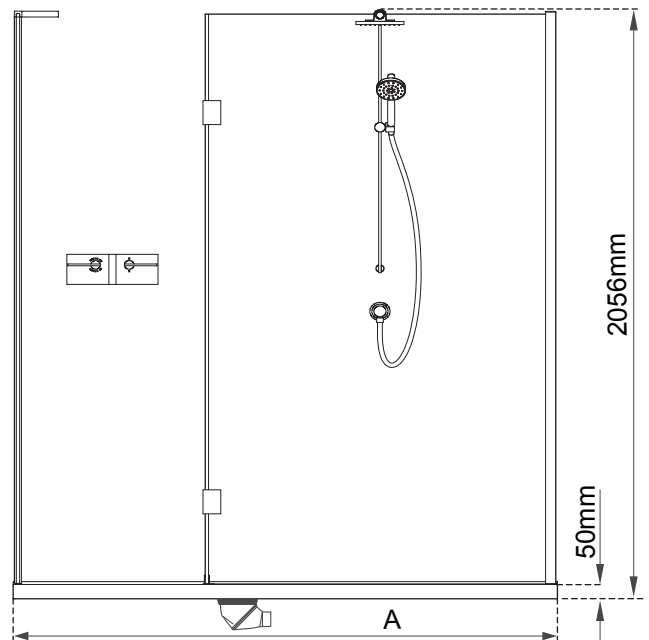
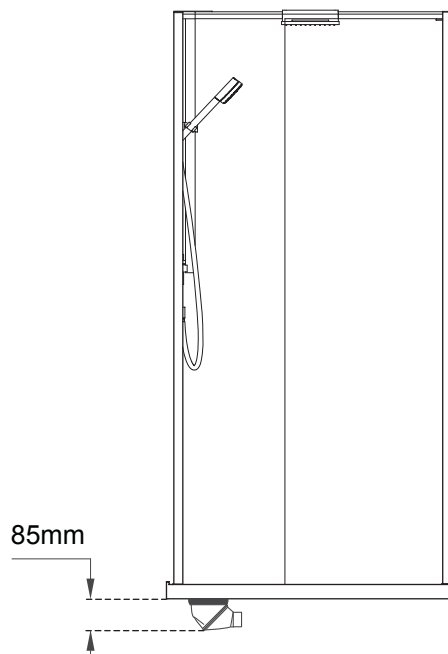
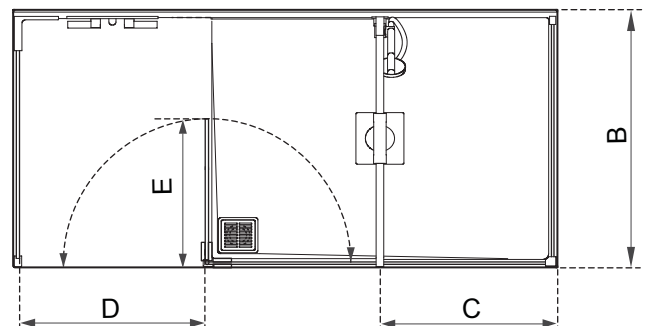

READ ONLY IF INSTALLING WITH BLADE MIXER ASSEMBLY AND OVERHEAD DELUGE

DIMENSIONS FOR TRAY AND PLUMBING FOR OVERHEAD DELUGE

ILLUSTRATION SHOWS LH MODEL

TRAY MUST BE LEVEL
IN ALL PLANES

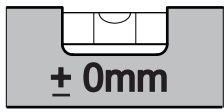

DO NOT PLUMB PIPE WORK TO OVERHEAD
MANIFOLD IN THE AREA OF RISER RAIL
LOWER WALL FIXING.

WALL MANIFOLD FOR OVERHEAD

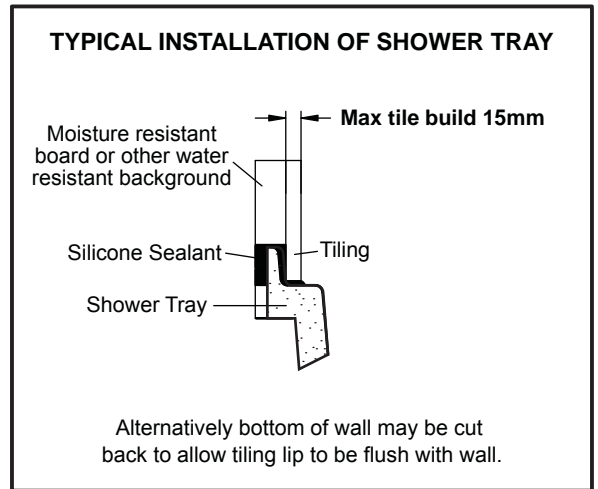

	A	B	C	D	E
MODEL 1290	870mm	652mm	1200mm	285mm	900mm
MODEL 1590	1020mm	652mm	1500mm	285mm	900mm
MODEL 1780	1145mm	702mm	1700mm	310mm	800mm
MODEL 1790	1145mm	702mm	1700mm	310mm	900mm

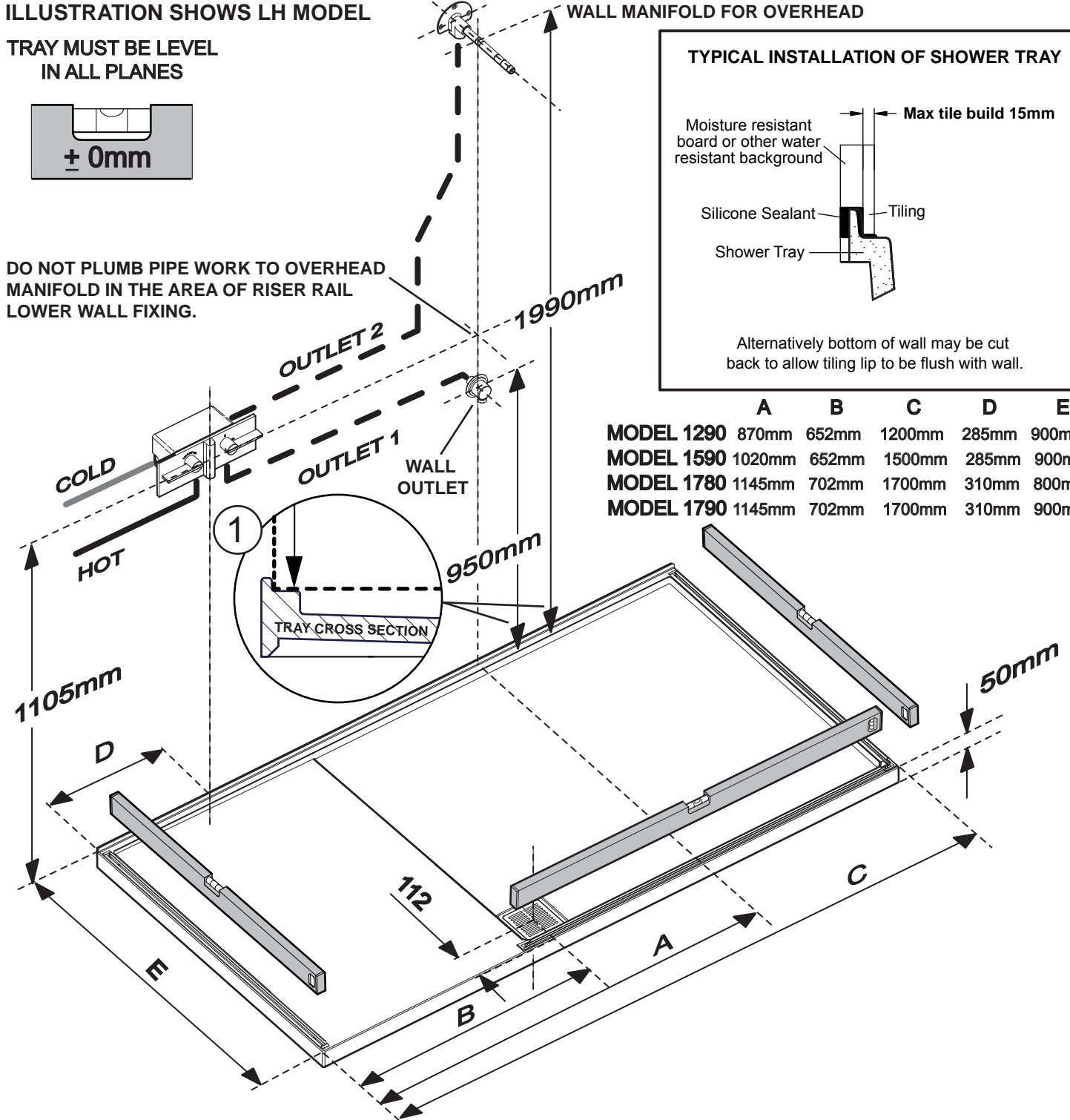

See separate installation instructions for fitting the EX20 Elixir Mixer.
 For the plumbing configuration shown above when the flow control lever on the mixer is rotated upwards mixed water will be diverted to the handset and when rotated downwards the Overhead Deluge. Alternatively Outlet 2 can be plumbed to the wall outlet and Outlet 1 to the overhead manifold. When rotated upwards the flow control will then divert water to the overhead and when rotated downwards to the handset.

The dimensions indicate the recommended position for the wall outlet and mixer from the **shower tray as shown (1)**. Dimension height 1105mm is centred to the mixer controls. This will align the controls to the cylindrical lower wall fitting of the handset riser rail /overhead deluge. Dimension A is to the centre of the showering area for the relevant model. The wall outlet is shown positioned directly below the riser rail. Do not plumb the Outlet to the overhead deluge manifold in the area of the lower riser rail fixing.

For tiling builds greater than 15mm in front of the tiling upstand, position the tray to accommodate the thicker build by fitting down to the tiling upstand. For fitting the shower waste see the RAISED TRAY STAGE.

READ ONLY IF INSTALLING WITH BLADE MIXER ASSEMBLY AND OVERHEAD DELUGE

PLUMBING FOR OVERHEAD DELUGE

MANIFOLD SIDE VIEW - MIN/MAX MOUNTING DEPTHS

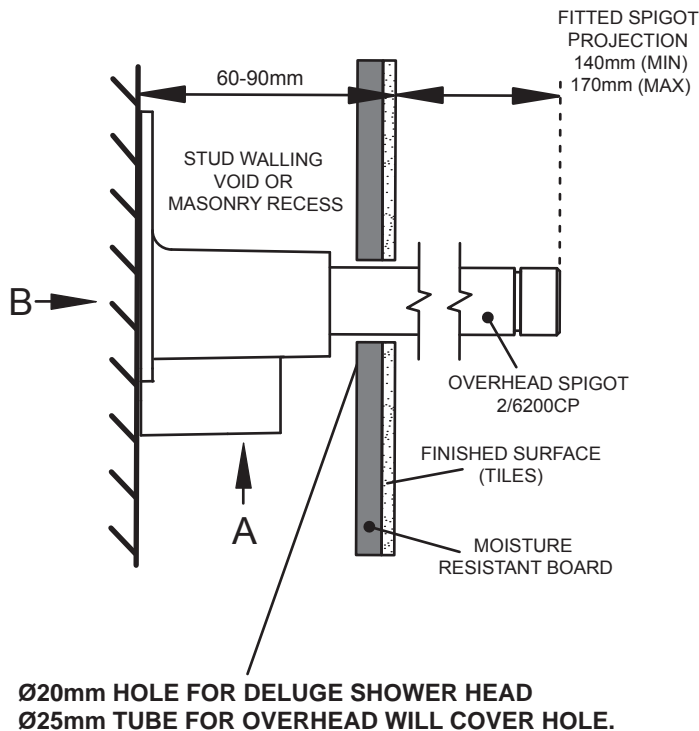

MIXED WATER INLET. SEE SEPERATE ELIXIR MIXER FITTING INSTRUCTIONS.

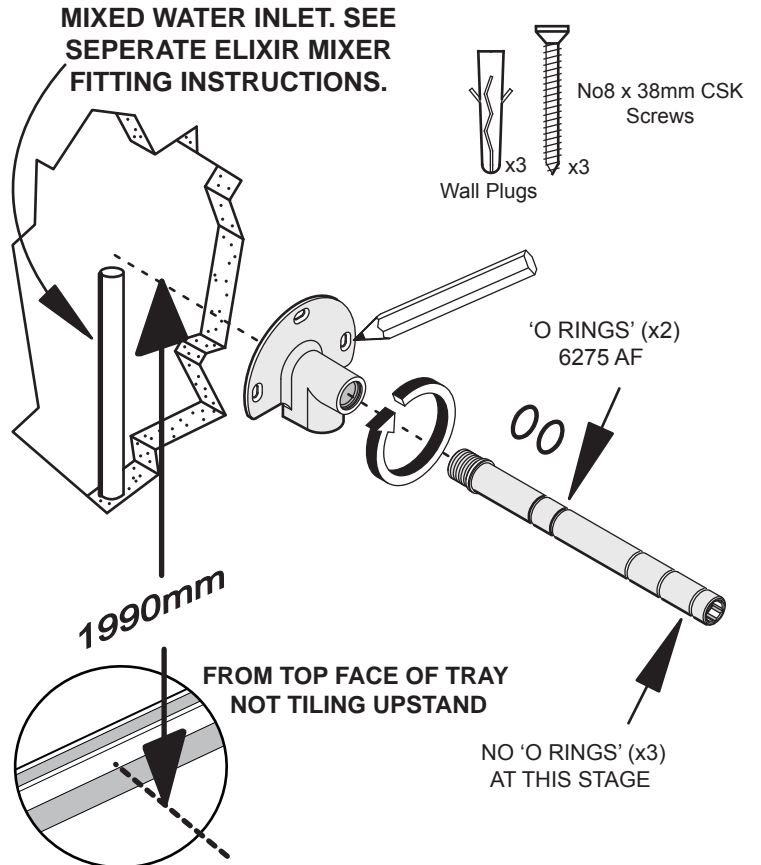

INLET BLANKING PLUG (6251 AF). USED TO SEAL REDUNDANT PLUMBING OPTION.

1/2" BSP FEMALE FITTING (PARALLEL) OPTIONS;
A (FROM BELOW)
B (FROM BEHIND)
 ALTERNATIVELY THE MANIFOLD CAN BE ROTATED 360° FOR PLUMBING FROM LEFT, RIGHT AND FROM ABOVE.

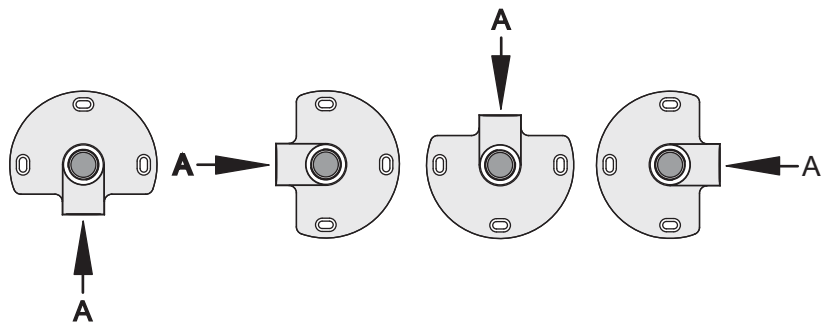
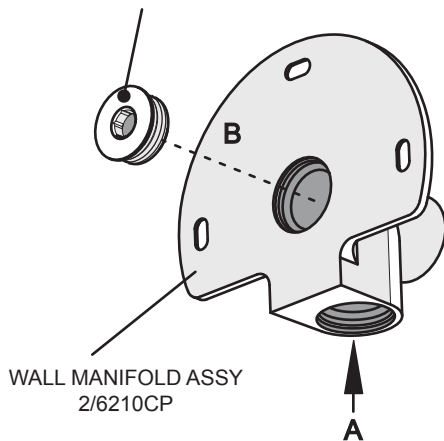

This stage describes fixing of the Wall Manifold & Overhead Spigot

- The wall manifold mounting height is **1990mm** (from top face of tray to **centre** of overhead spigot 2/6200CP) for the deluge shower head and rail that connects to the front glass panel.
- Make sure the wall manifold 2/6210CP is mounted on a structurally solid, leveled surface - check with a spirit level once overhead spigot 2/6200CP has been fully screwed in, this will ensure the deluge Shower head will be level once assembled.
- Overhead spigot 2/6200CP should project from the final finished surface between 140mm-170mm depending on the depth wall manifold 2/6210CP has been mounted.
- Wall manifold assy 2/tht210CP can be plumbed to from underneath (**A**) or behind (**B**) using a standard 1/ BSP male connector. Manifold may also be rotated 360° if required. Always use PTFE tape on threaded connectors. **NEVER** use taper threaded connectors.
- The Inlet blanking plug (6251 AF) seals the redundant plumbing option.
- Wall manifold assy 2/6210CP can be mounted in the same depth of recess as the Elixir Mixer - from 60mm to 90mm (see separate Elixir Mixer fitting instructions).

READ ONLY IF INSTALLING WITH ELIXIR MIXER AND RISER RAIL (WITHOUT OVERHEAD DELUGE)

DIMENSIONS FOR TRAY AND PLUMBING FOR 'WITHOUT OVERHEAD DELUGE'

ILLUSTRATION SHOWS LH MODEL

**TRAY MUST BE LEVEL
IN ALL PLANES**

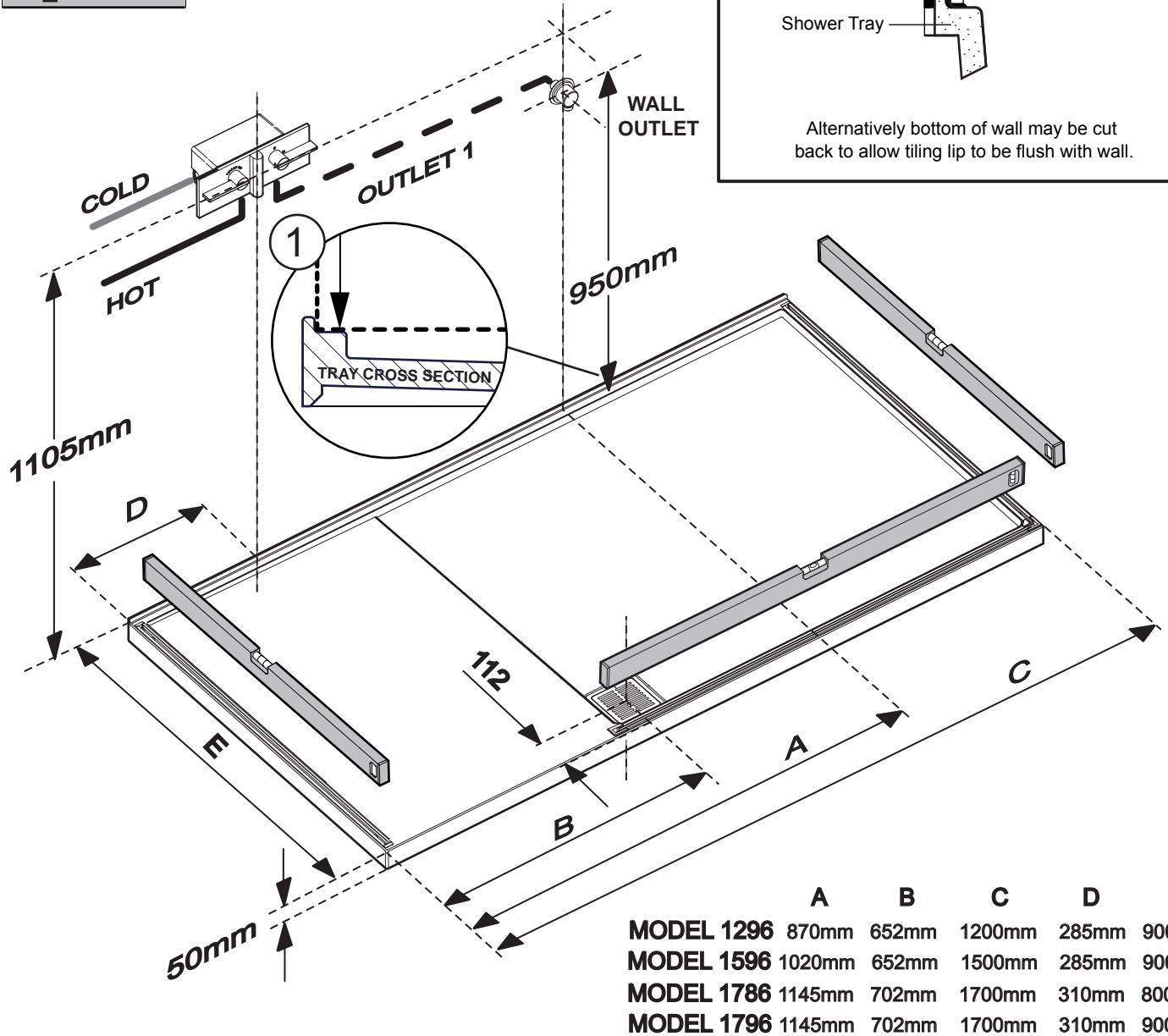
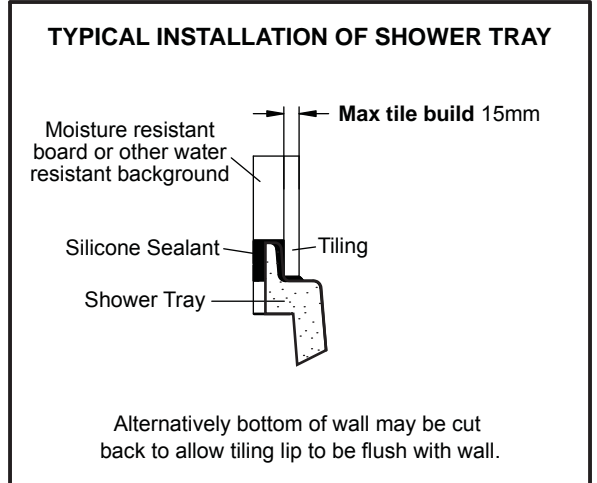
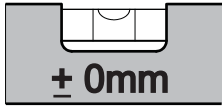

See separate installation instructions for fitting the EX20 Elixir Mixer and Riser Rail.

For the plumbing configuration shown above when the flow control lever on the mixer is rotated upwards mixed water will supply the handset. If preferred the flow control can operate by rotating downwards by plumbing the wall outlet to Outlet 2 on the shower mixer.

The dimensions indicate the recommended position for the wall outlet and mixer from the **shower tray as shown (1)**. Dimension height 1105mm is centred to the mixer controls. This will align the controls to the cylindrical lower wall fitting of the handset riser rail /overhead deluge. Dimension A is to the centre of the showering area for the relevant model. The wall outlet is shown positioned directly below the riser rail.

For tiling builds greater than 15mm in front of the tiling upstand position the tray to accommodate the thicker build by fitting down to the tiling upstand. For fitting the shower waste see the RAISED TRAY STAGE.

READ FOR ALL MODELS

RAISED TRAY VERSIONS AND FITTING WASTE

TRAY MUST BE LEVEL
IN ALL PLANES

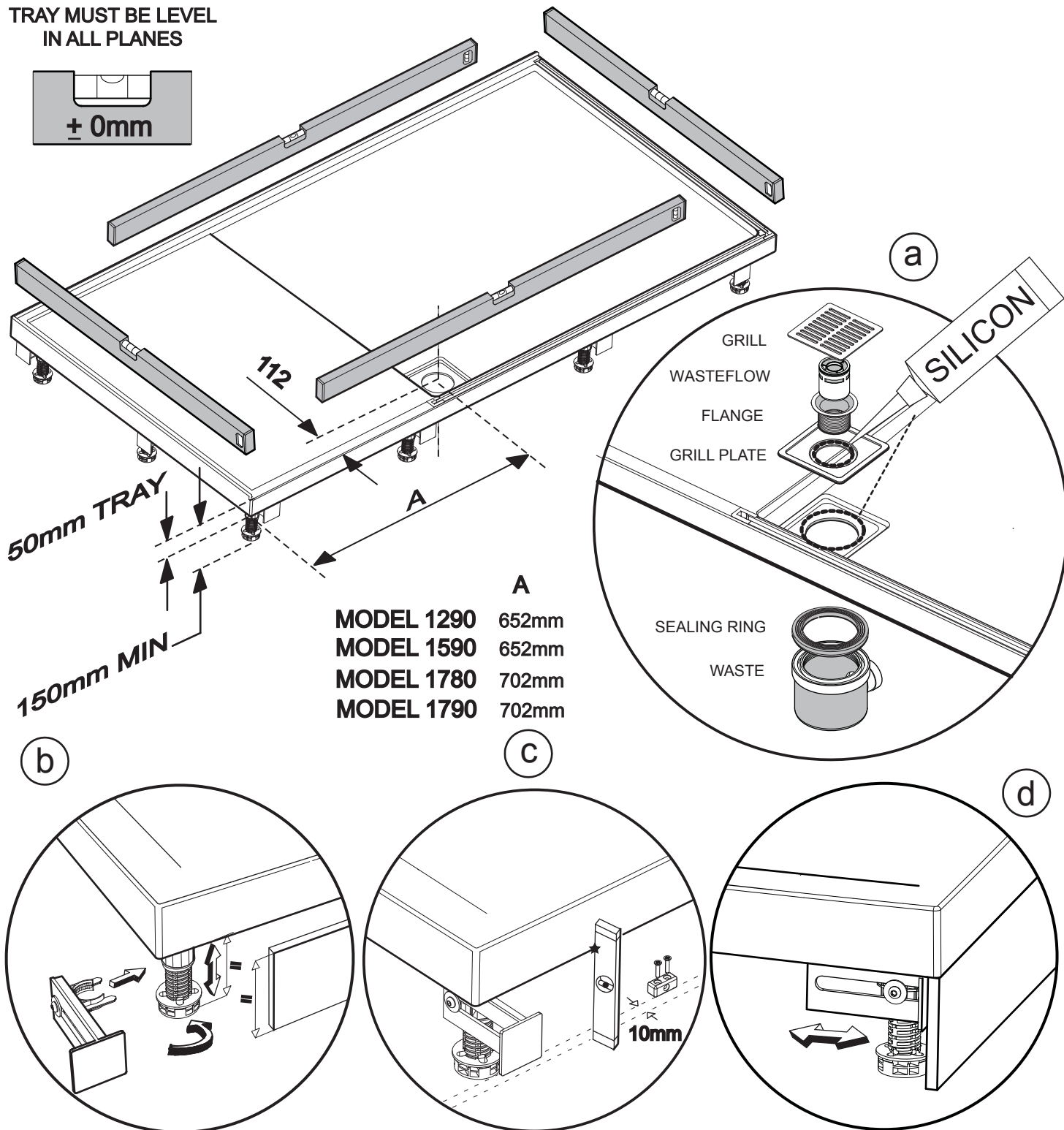
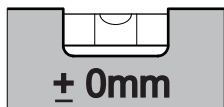

a. When fitting the shower waste apply a small continuous bead of silicon to the tray waste recess before fitting the square grill plate. Also apply a small continuous bead of silicon sealant in the circular recess of the square grill plate before fitting the shower waste and flange together. See installation instructions with shower waste.

Push fit the adjustable legs into cups on underside of the tray.

b. Adjust the height of the tray by winding the lower part of the leg to match the height of the front panel. Clip the panel brackets provided on to the legs that will be supporting the panel.

c. If required fit the support blocks supplied between legs.

d. Adjust the panel brackets so that the panel is flush with the front face of the tray.

The Matki panels are supplied extra long and these can be trimmed to size if needed using a fine toothed hacksaw.

Align the velcro pads supplied with the panel brackets and fit the panel.

READ FOR ALL MODELS

PANEL FITTING INDEX

ILLUSTRATIONS SHOW LH MODELS

See relevant panel fitting instructions for the model.

NWSC

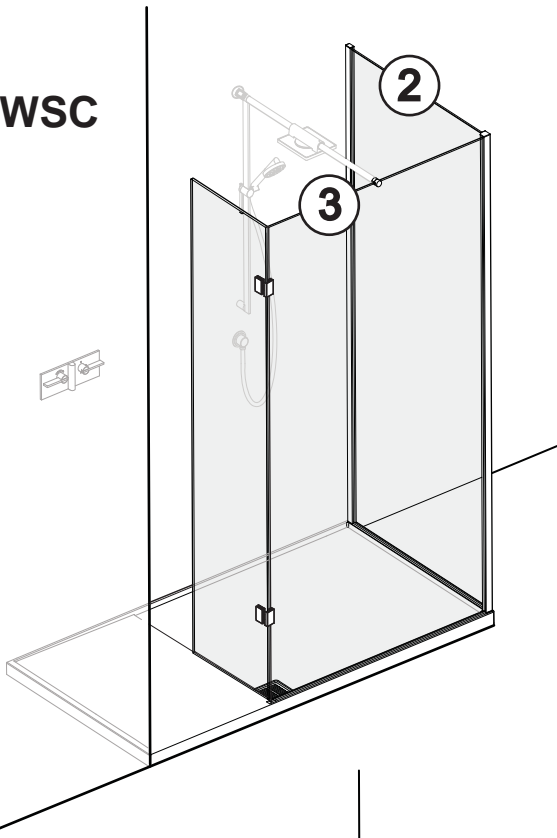

NWSR

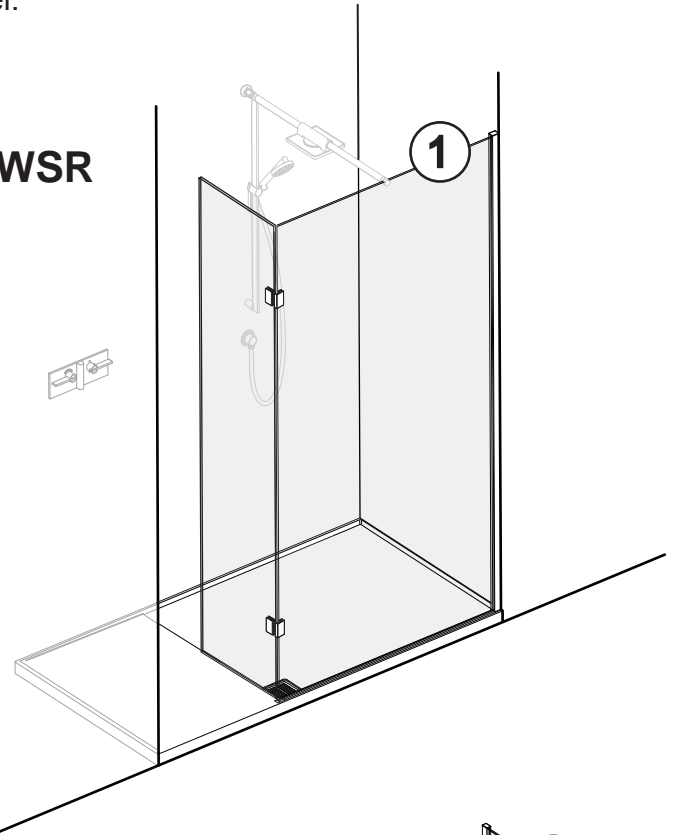

NWCC

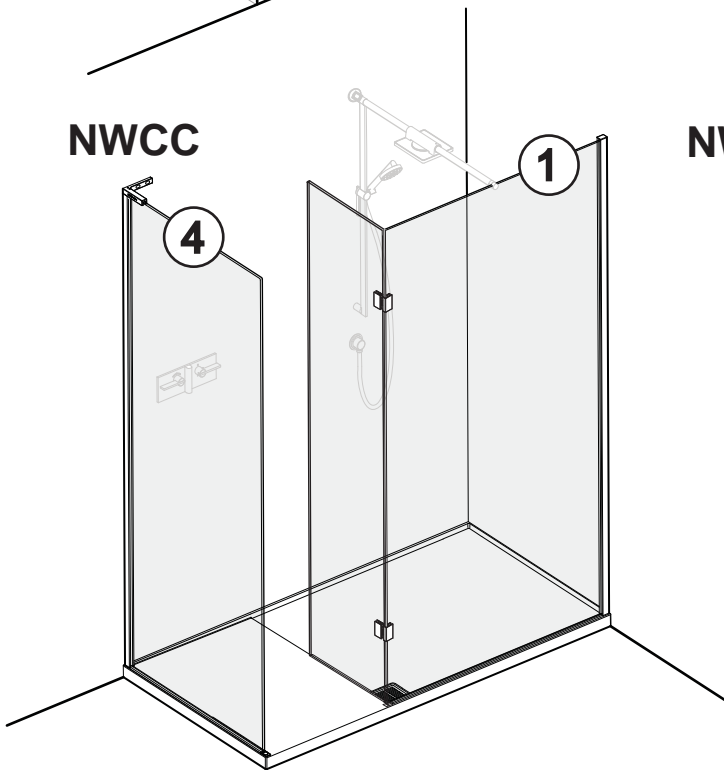

NWST

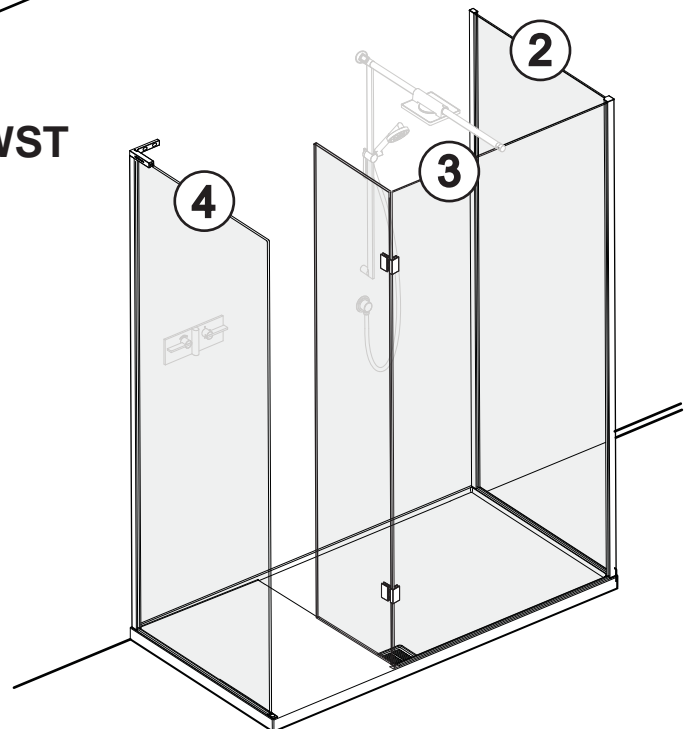

PANEL 1

READ ONLY WHEN INSTALLING MODELS NWCC OR NWSR

FRONT PANEL

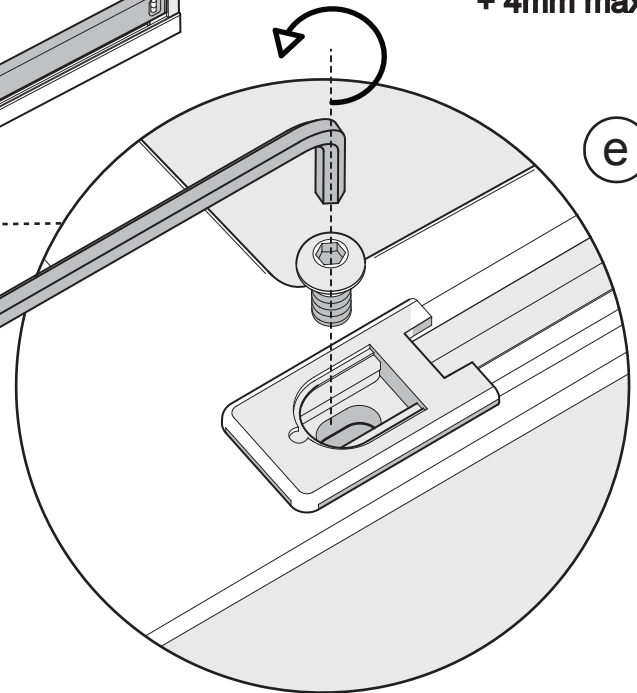
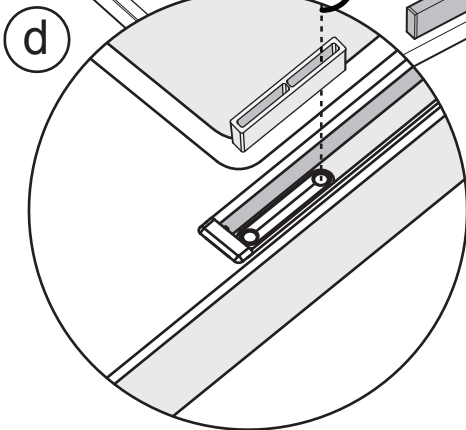
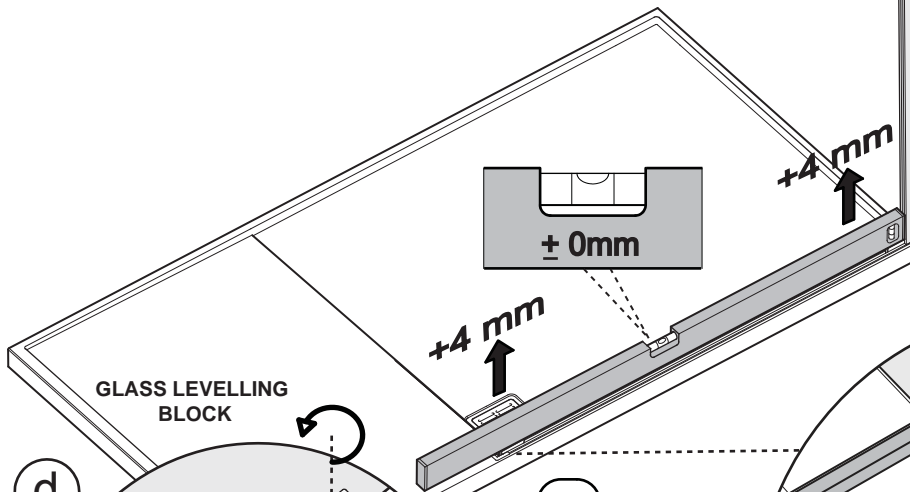
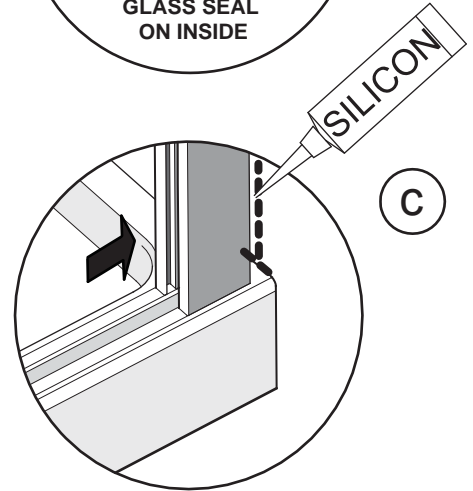
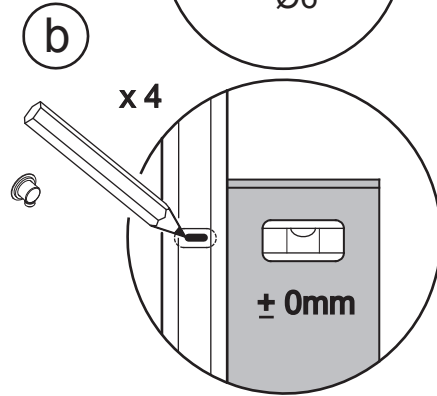
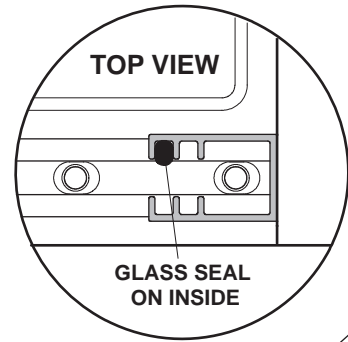
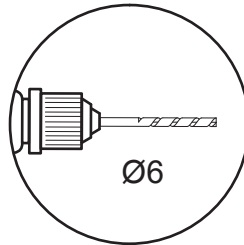
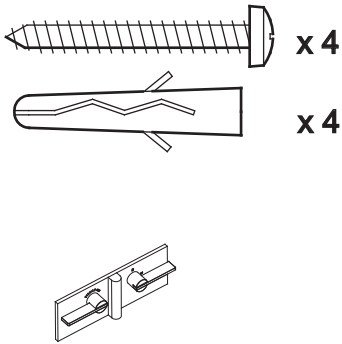

SMALL FLAT BLADE SCREW DRIVER 4mm

IMPORTANT: Remove the tray gasket end panel cap before fitting the front panel.

This stage is describing the fitting of the Front panel wall mount.

- Place the wall mount onto the top of the tray gasket with the wall mount glass seal on the inside. Align the opening in the wall mount with the opening in the tray glass gasket.
- Plumb the wall mount for upright and mark the fixing holes in the centre of the slots.
- Drill 4 x fixing holes in the wall and insert the wall plugs. Clean area and apply silicon sealant to the area behind the wall mount between the tray and tiles and 100mm up the wall, central to the width of the wall mount. Secure the wall mount using the No.8 x 32mm pan head screws, plumb the wall mount for upright do not overtighten the screws to allow for adjustment.
- The tray is fitted with adjustment screws in the base of the tray glass gaskets. Minor adjustments can be made to the level of the glass panel using these screws if the tray is not completely level before the glass panel is fitted. Place the clear glass levelling blocks into the tray gasket on top of the levelling adjustment screws, place a level between the blocks and check for level. Adjust the screws out in pairs at the required end of the level. Maximum upward adjustment of screws is 4mm. Maximum adjustment at one end will correct the glass for vertical by 8mm at the top. **DO NOT USE IF THE TRAY IS LEVEL.**
- Remove the tray gasket end panel cap before fitting the front panel.



READ ONLY WHEN INSTALLING MODELS NWCC OR NWSR
IMPORTANT: Panel is very heavy.
Two people required.

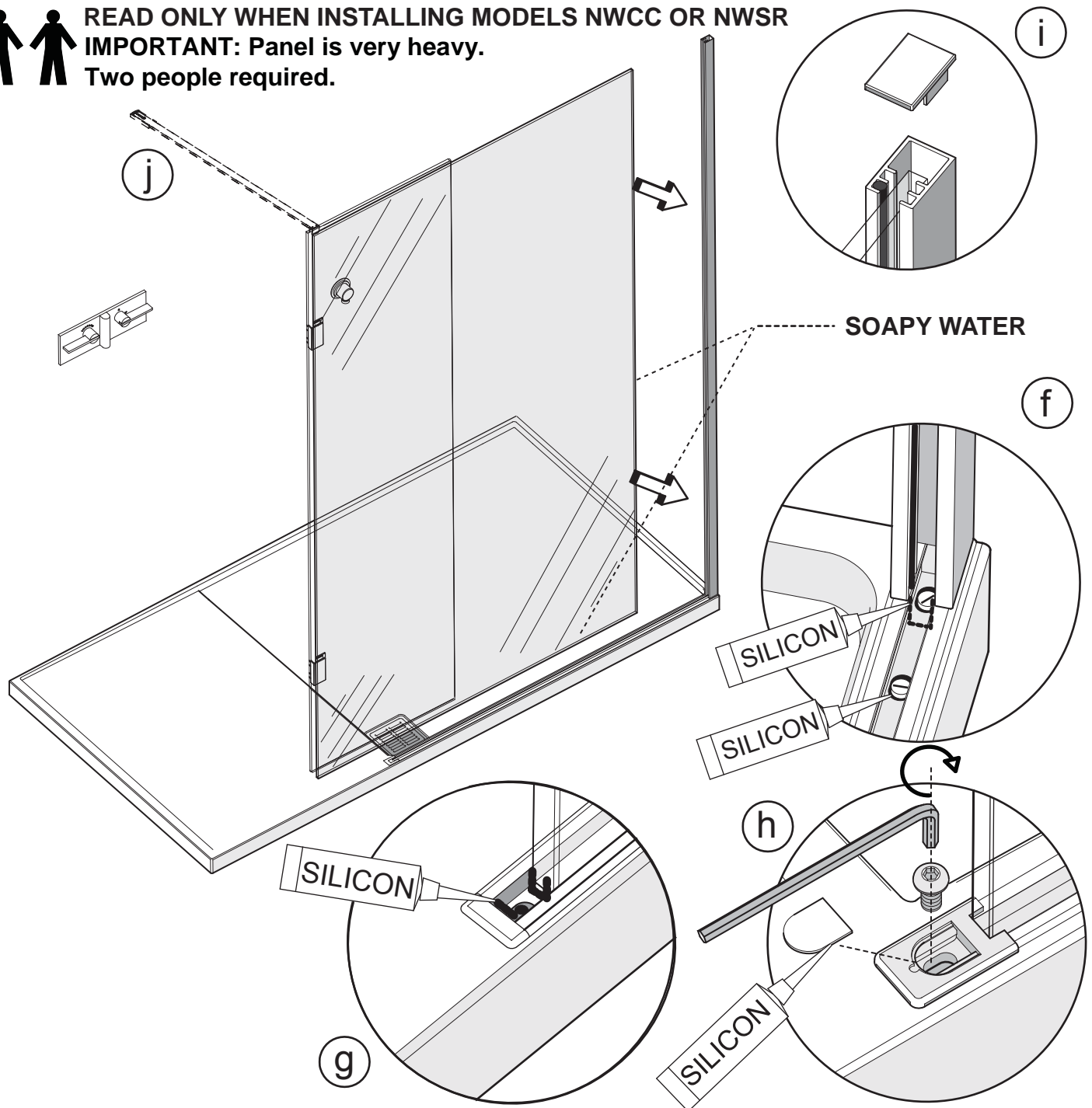

This stage is describing the fitting of the Front panel glass.

We recommend two people are available for this stage.

f. Before fitting the glass panel apply a small bead of silicon sealant around the tray gasket adjustment screws. Apply a small 'U' shaped bead of silicon in the base and sides of the tray gasket at the opening of the wall mount.

Important: The hinge front panel is very heavy, two people required. Lightly wet the vertical and bottom horizontal edge of the glass panel with soapy water and carefully lower the panel into the wall mount tray gasket. Push the top of the glass panel into the wall mount first followed by the bottom.

g. Apply a 'u' shaped bead of silicon sealant in the base and sides of the tray gasket at the end of the glass panel and end of the tray gasket.

h. Fit the panel end cap into the tray gasket and secure with the M6 button head screw, place a small spot of silicon sealant under the screw cover and fit.

i. Fit the wall mount top cap.

j. Fit panel brace bar included in deluge kit. (See separate instructions) Model: 1290, 1586, 1596, 1786, 1796.

Apply final silicon sealant to the wall mount when all stages of the installation are complete.
(See Silicon Sealant Stage)

PANEL 2

READ ONLY WHEN INSTALLING MODELS NWSC OR NWST

CORNER PANEL

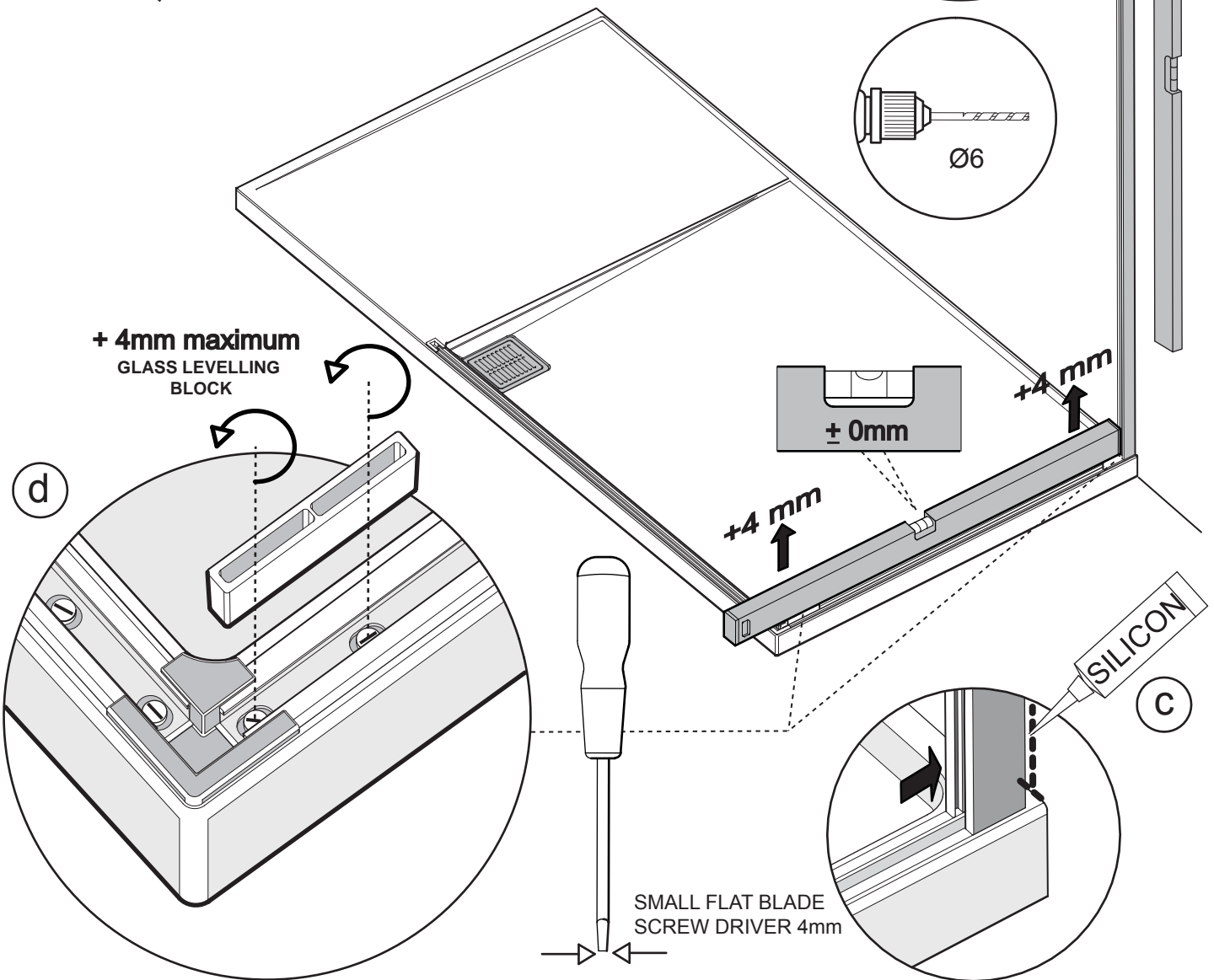
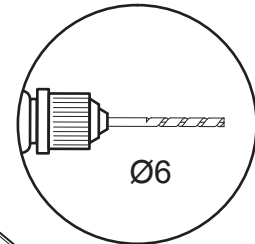
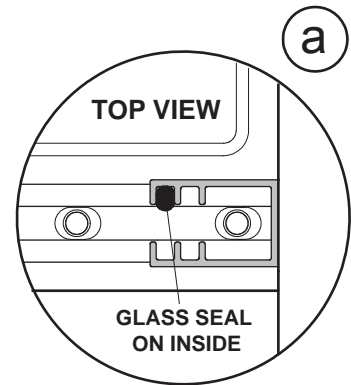
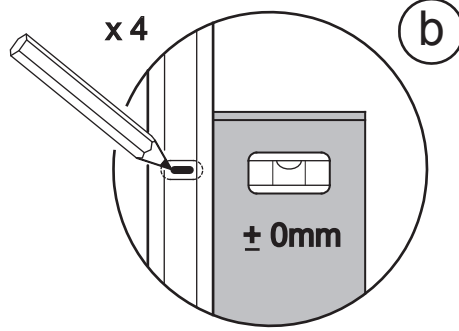
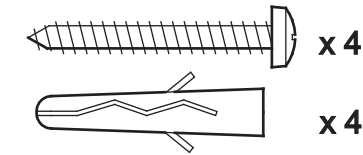

This stage is describing the fitting of the Corner panel wall mount.

- Place the wall mount onto the top of the tray gasket with the wall mount glass seal on the inside. Align the opening in the wall mount with the opening in the tray glass gasket.
- Plumb the wall mount for upright and mark the fixing holes in the centre of the slots.
- Drill 4 x fixing holes in the wall and insert the wall plugs. Clean area and apply silicon sealant to the area behind the wall mount between the tray and tiles and 100mm up the wall, central to the width of the wall mount. Secure the wall mount using the No.8 x 32mm pan head screws, plumb the wall mount for upright do not overtighten the screws to allow for adjustment.
- The tray is fitted with adjustment screws in the base of the tray glass gaskets. Minor adjustments can be made to the level of the glass panel using these screws if the tray is not completely level before the glass panel is fitted. Place the clear glass levelling blocks into the tray gasket on top of the levelling adjustment screws, place a level between the blocks and check for level. Adjust the screws out in pairs at the required end of the level. Maximum upward adjustment of screws is 4mm. Maximum adjustment at one end will correct the glass for vertical by 8mm at the top. **DO NOT USE IF THE TRAY IS LEVEL.**

READ ONLY WHEN INSTALLING MODELS NWSC OR NWST

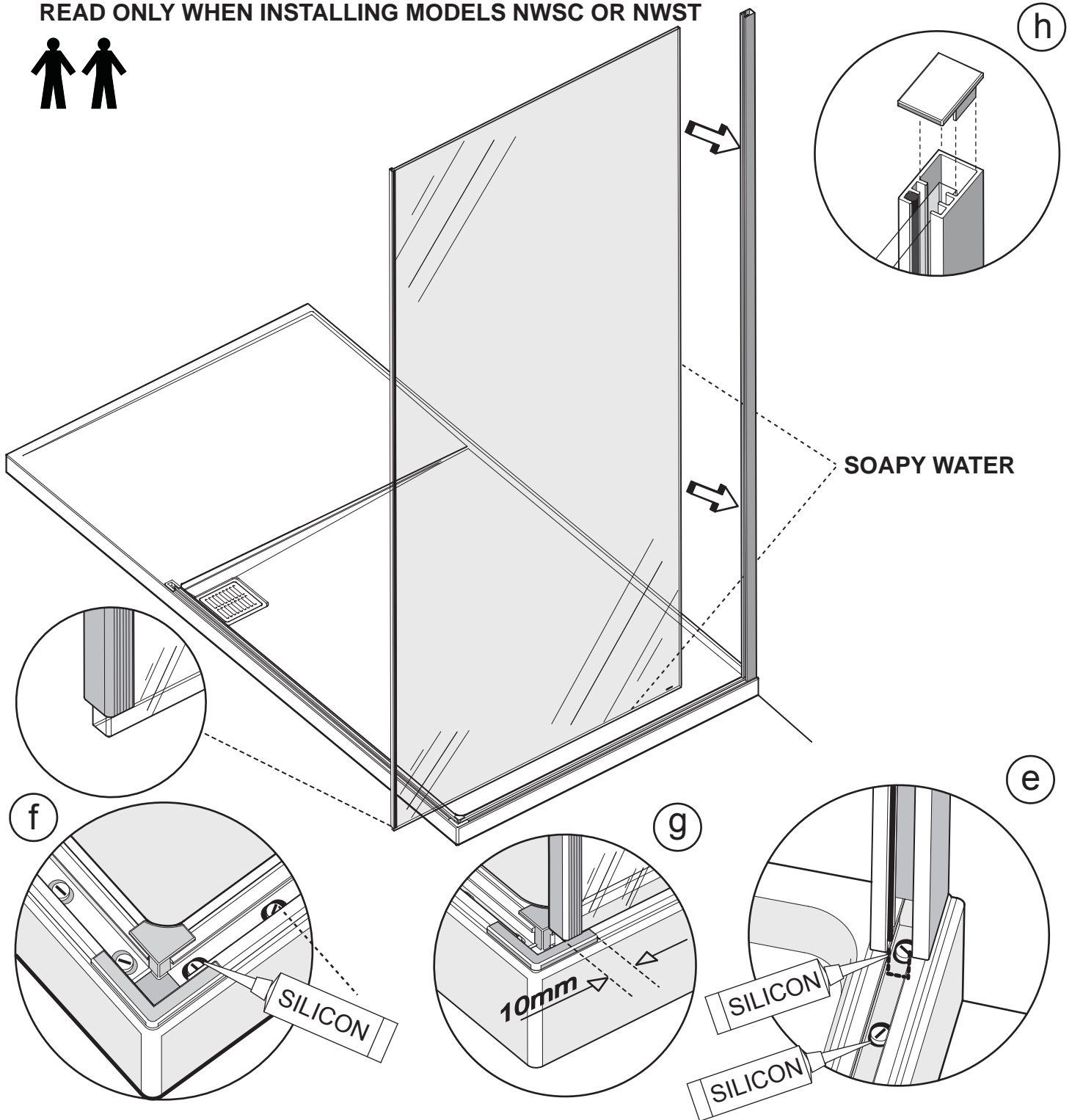

**This stage is describing the fitting of the Corner panel glass.
We recommend two people are available for this stage.**

e. Before fitting the glass panel apply a small bead of silicon sealant around the tray gasket adjustment screws.

Apply a small 'U' shaped bead of silicon in the base and sides of the tray gasket at the opening of the wall mount.

f. Apply a small bead of silicon sealant around the tray gasket adjustment screws at the chrome corner cap.

IMPORTANT: Fit the Corner panel with the vertical extrusion frame away from the wall. The bottom of the vertical frame stops short on the glass panel. Lightly wet the vertical and bottom horizontal edge of the glass panel with soapy water and gently lower the panel into the wall mount and tray gasket. Push the top of the panel into the wall mount first, followed by the bottom.

g. Adjust the glass panel so that the outside vertical edge is 10mm in from the outside edge of the chrome corner cap.

h. Fit the wall mount top cap.

**Apply final silicon sealant to the wall mount when all stages of the installation are complete.
(See Silicon Sealant Stage)**

PANEL 3

READ ONLY WHEN INSTALLING MODELS NWSC OR NWST
CORNER FRONT PANEL

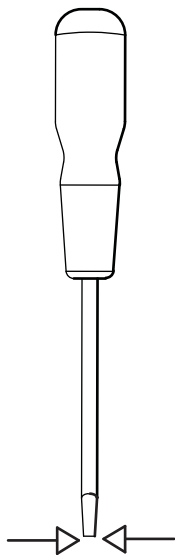
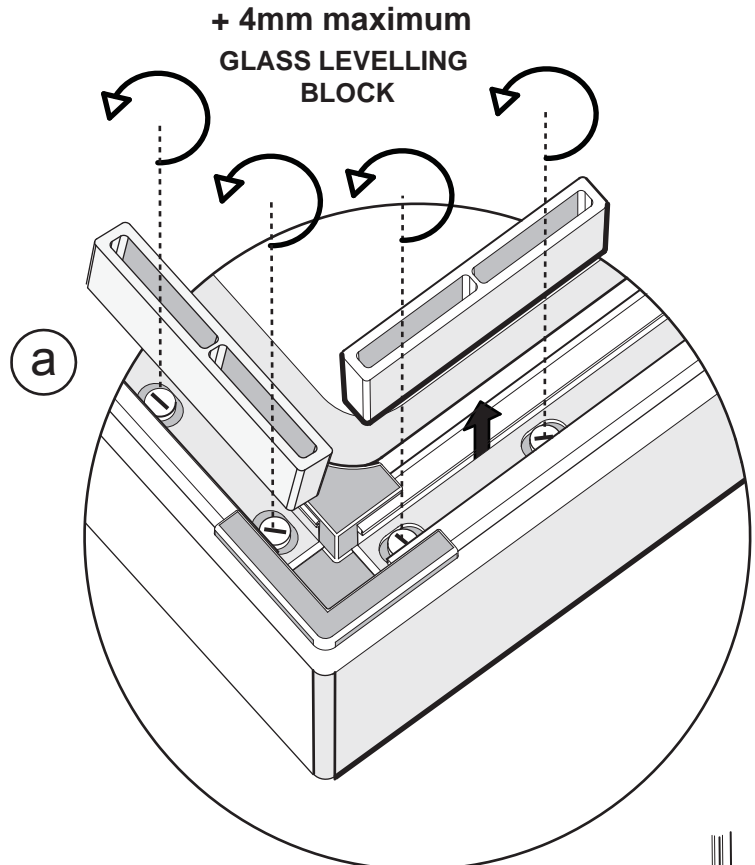
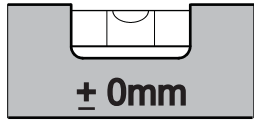

SMALL FLAT BLADE
SCREW DRIVER 4mm

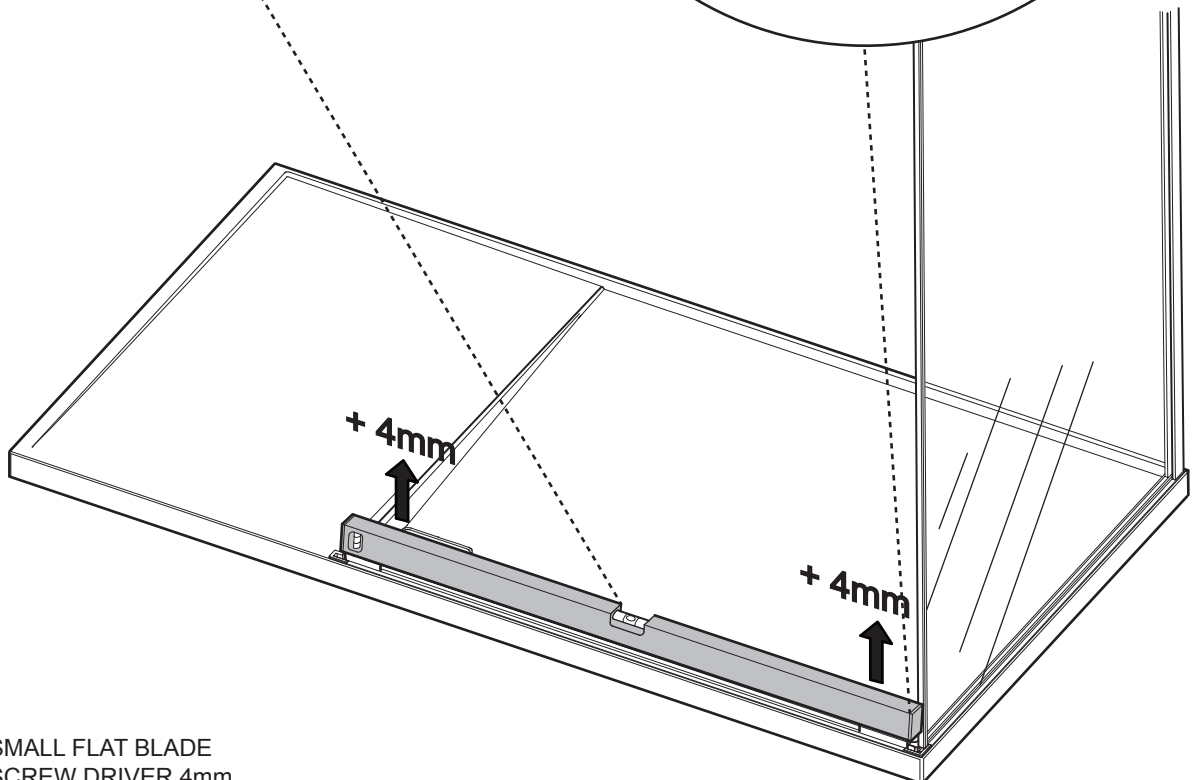

This stage is describing the fitting of the Corner Front panel.

a. The tray is fitted with adjustment screws in the base of the tray glass gaskets. Minor adjustments can be made to the level of the glass panel using these screws if the tray is not completely level before the glass panel is fitted. Place the clear glass levelling blocks into the tray gasket on top of the levelling adjustment screws, place a level between the blocks and check for level. Adjust the screws out in pairs at the require end of level. Maximum upward adjustment of screws 4mm. Maximum adjustment at one end will correct the glass for vertical by 8mm at the top. **DO NOT USE IF TRAY IS LEVEL**

**READ ONLY WHEN
INSTALLING MODELS
NWSC OR NWST
IMPORTANT: Panel
is very heavy. Two
people required.**



SOAPY WATER

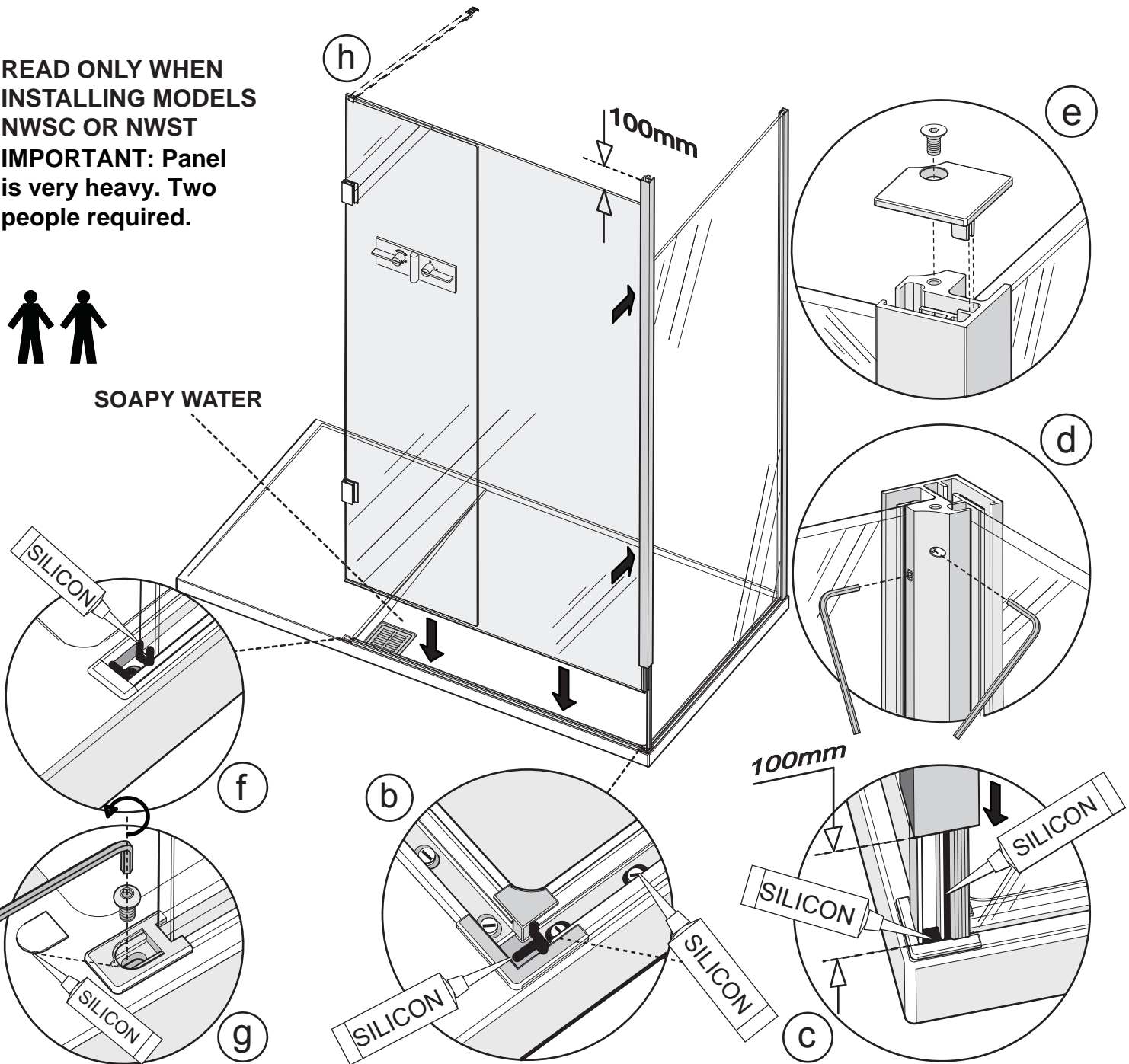

**This stage is describing the fitting of the Corner Front panel glass.
We recommend two people are available for this stage.**

IMPORTANT: Fit the corner front panel. Lightly wet the bottom horizontal edge of the glass panel with soapy water and gently lower the panel into tray gasket and onto the end of the corner panel. Ensure that the corner vertical frame is lifted 100mm above the top edge of the glass for applying silicon sealant under the corner frame. Adjust the glass panel so that the outside vertical edge is in the corner of the chrome corner cap.

b. Before fitting the glass panel apply a small bead of silicon sealant around the tray gasket adjustment screws. Apply a small 'U' shaped bead of silicon in the base and sides of the tray gasket at the joint between the tray gasket and chrome corner cap and a bead in the base of the corner cap.

c. Apply silicon sealant onto the ends of the glass panels in the corner cap and apply a vertical bead up 100mm between the end frames of the corner front panel and corner panel. Push the Corner frame down to the corner cap, allow any excess sealant on the joint between the corner cap and corner frame to cure before removal.

d. Adjust the corner frame for upright and lock into position with the locking screws on the inside top and bottom corner of the vertical frame.

e. Fit the corner vertical frame top cap and secure with the M4 x 8 csk screw.

f. Apply a 'u' shaped bead of silicon sealant in the base and sides of the tray gasket at the end of the glass panel and end of the tray gasket.

g. Fit the panel end cap into the tray gasket and secure with the M6 button head screw, place a small spot of silicon sealant under the screw cover and fit.

h. Fit panel brace bar included in deluge kit. (See separate instructions) Model: 1290, 1586, 1596, 1786, 1796.

HINGE PANEL

READ FOR ALL MODELS
HINGE PANEL HORIZONTAL SEAL

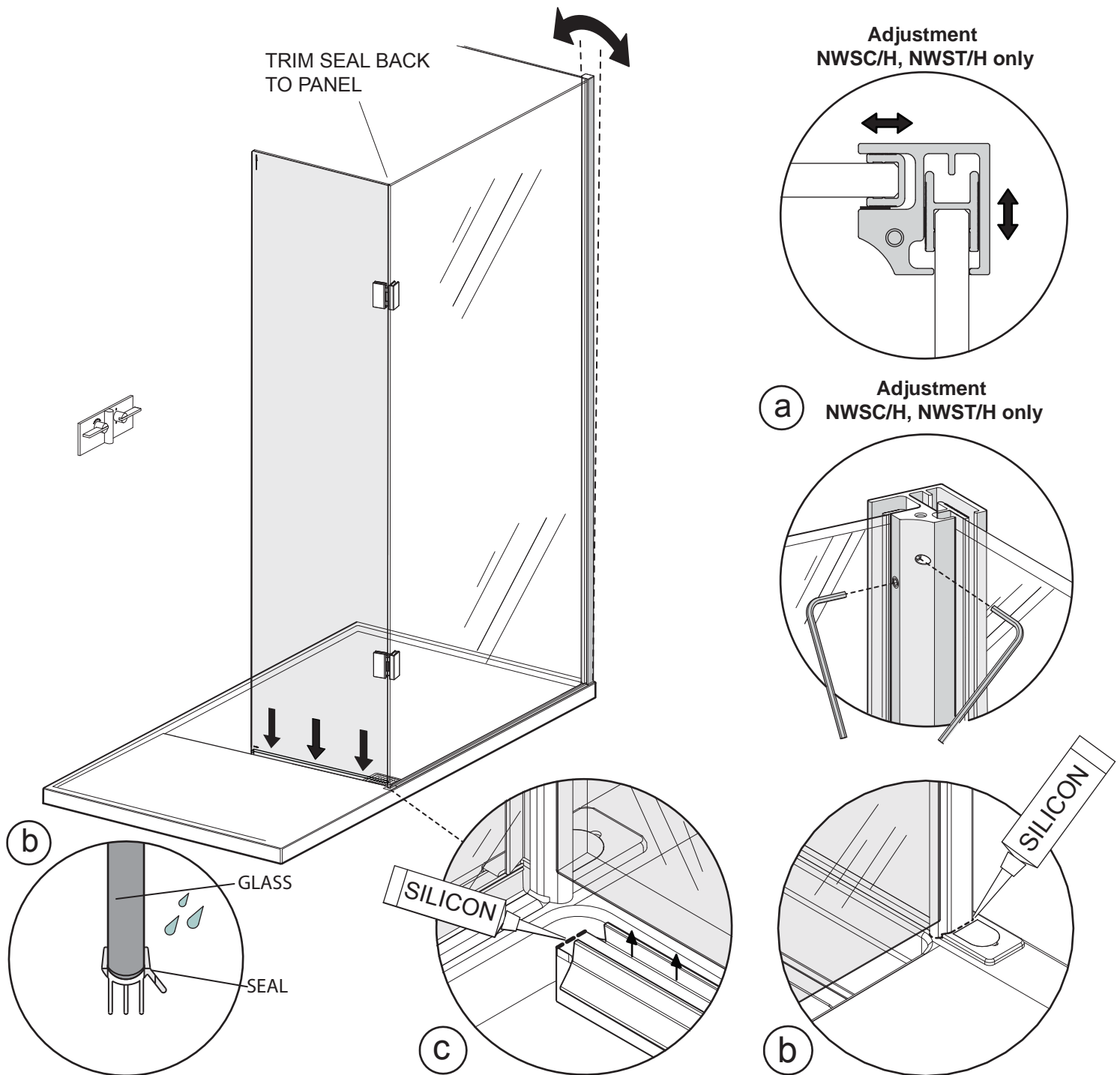

This stage is describing the adjustment of the Entrance panel before final fitting.

a. For the NWSC/TBH and NWST/TBH models there is adjustment in the corner vertical frame which can be used to adjust the vertical line of the front panel. We recommend that any adjustment should be made once the overhead deluge and riser rail is fitted.

b. Fit the Hinge panel horizontal seal to the bottom edge of the panel with the deflector edge on the inside of the hinge glass panel. Before fitting the seal place a small spot of silicon sealant at the hinge end of the seal between the bottom edge of the glass panel and seal. Push fit the seal onto the glass so that the end of the seal is flush with the end of the hinge panel glass where it meets the vertical hinge seal.

c. Apply silicon sealant where the hinge vertical seal meets the panel end cap and shower tray.

PANEL 4

READ ONLY WHEN INSTALLING MODELS NWCC OR NWST ENTRANCE SIDE PANEL

TOP THREADS IN SCREW PORTS

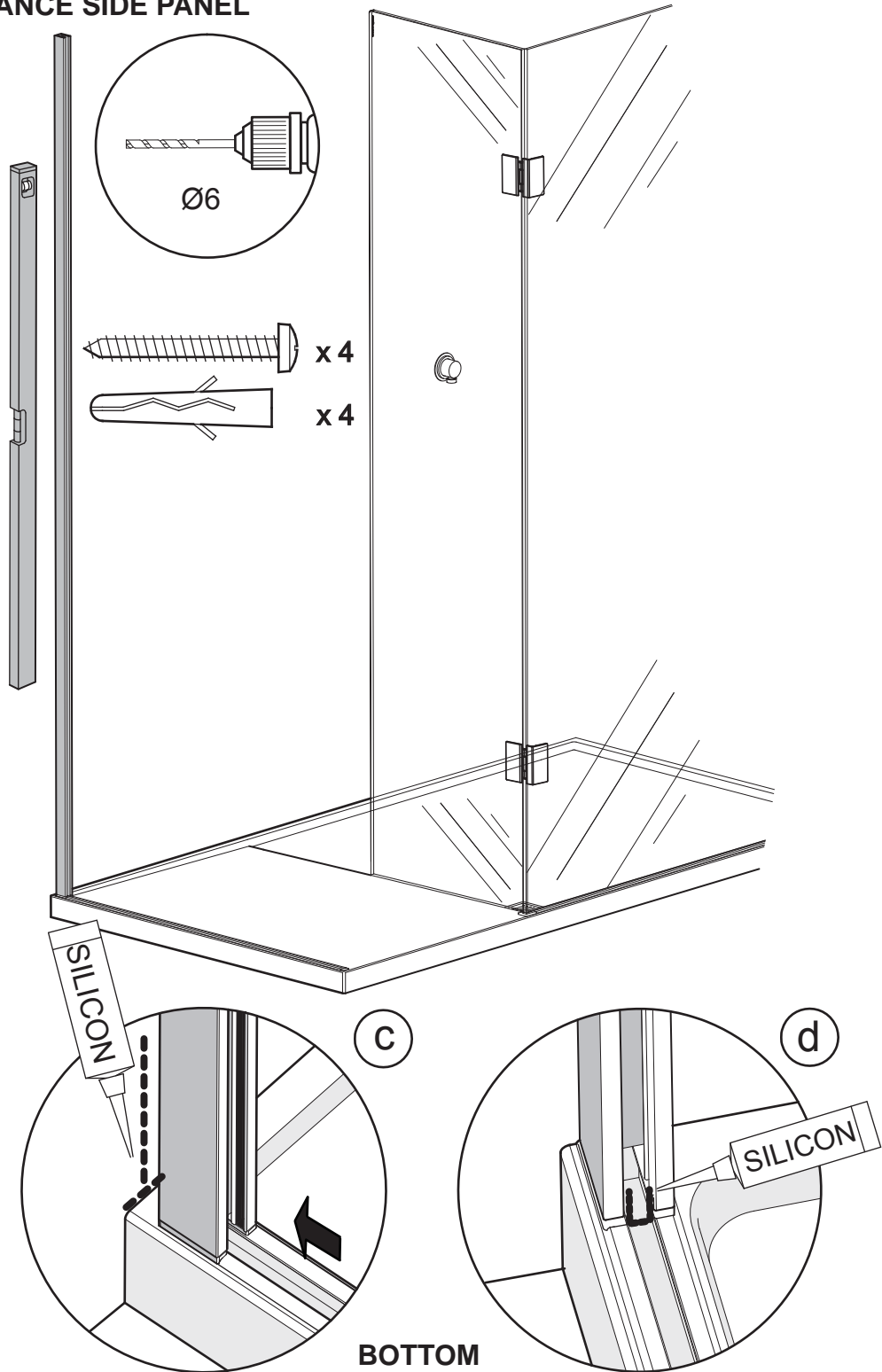
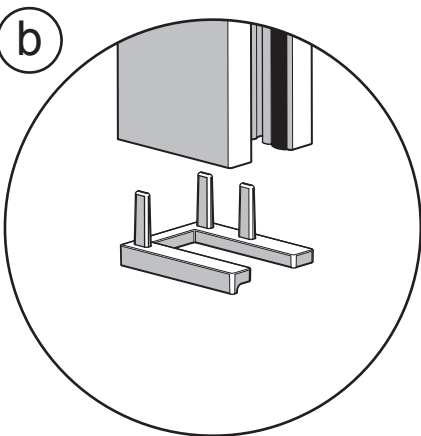
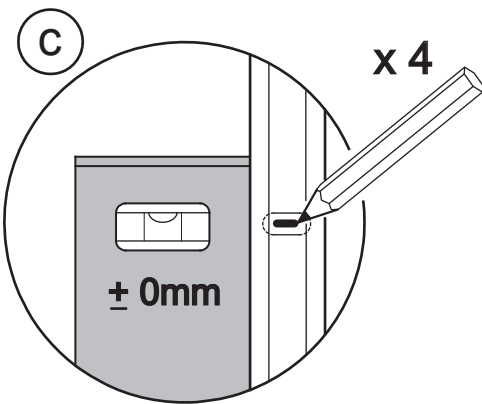
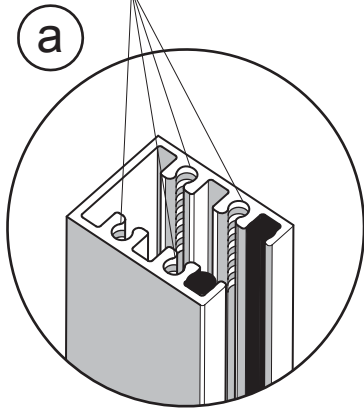

This stage is describing the fitting of the Entrance Side panel wall mount.

- The Wall mount has a top and bottom, the top has the threaded holes for the fitting of the top wall bracket.
- Before placing the wall mount fit the bottom cap with the thicker edge on the outside. Place the wall mount onto the top of the tray glass gasket. Align the opening in the wall mount with the opening in the tray glass gasket.
- Plumb the wall mount for upright and mark the fixing holes in the centre of the slots. Drill 4 x fixing holes in the wall and insert the wall plugs. Clean area and apply silicon sealant to the area behind the wall mount between the tray and tiles and 100mm up the wall, central to the width of the wall mount. Secure the wall mount using the No.8 x 32mm pan head screws, plumb the wall mount for upright do not overtighten the screws to allow for adjustment.
- Before fitting the Entrance Side panel glass apply a small 'U' shaped bead of silicon in the base and sides of the tray gasket at the opening of the wall mount.

READ ONLY WHEN INSTALLING MODELS NWCC OR NWST

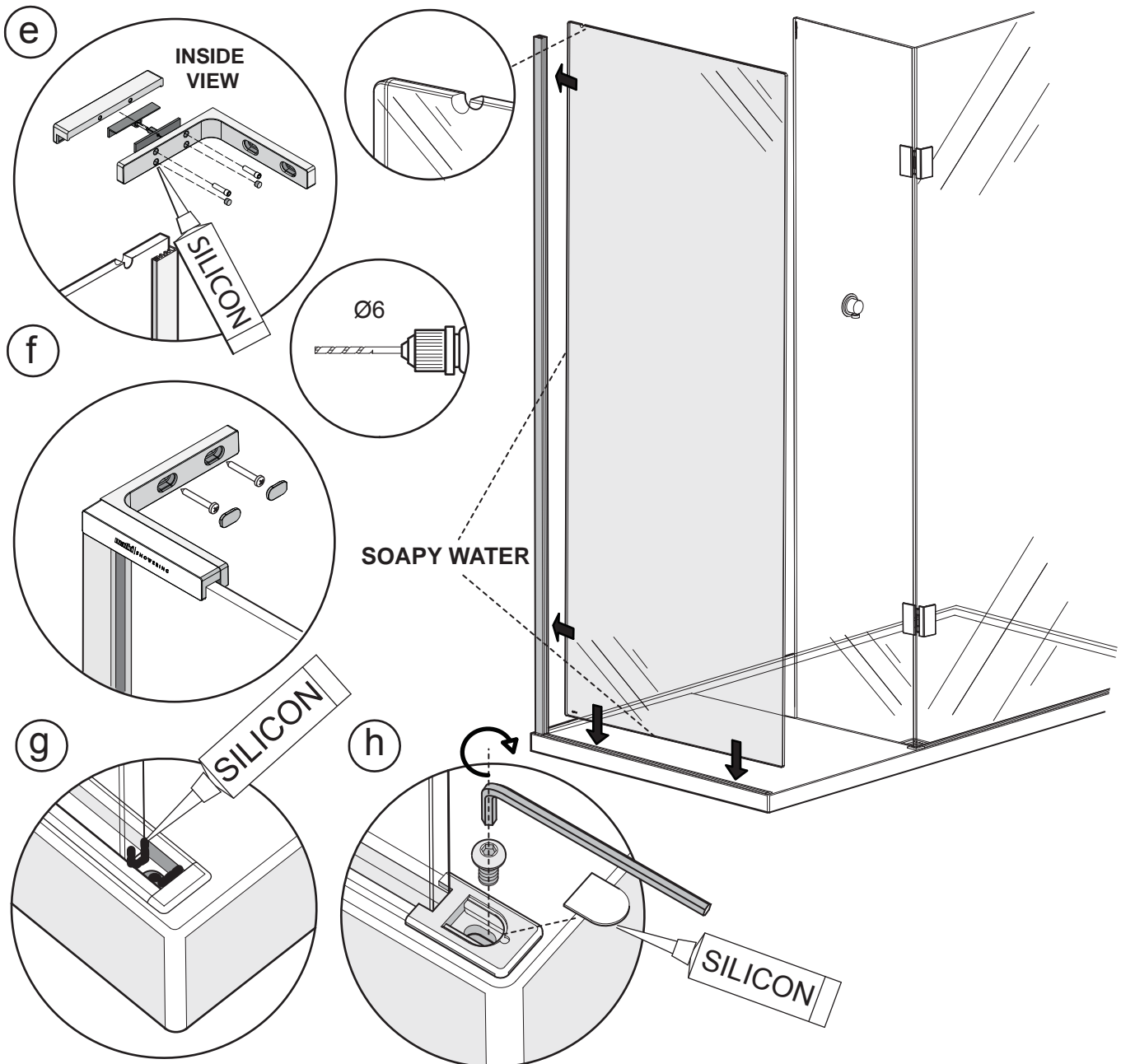

This stage is describing the fitting of the Entrance Side Panel.

IMPORTANT - Before fitting the entrance side panel, lightly wet the vertical and horizontal edges of the glass panel with soapy water and gently lower the panel into the wall mount and tray gasket. Push the top of the panel into the wall mount first, followed by the bottom.

e. Fit the two piece hard plastic 'u' shaped gasket into the cut out in the top edge of the glass with the grooved face of the gasket facing outwards. Fit the wall bracket over the glass and onto the top of the wall mount. d. Mark the centre of the slotted holes in the wall bracket onto the wall, remove the wall bracket and drill and fix the wall plugs. Refit the wall bracket. Clamp the bracket to the glass by tightening the clamping screws on the inside of the bracket. Fit the clamping screw cover caps into the two unused holes on the inside of the wall bracket. Apply a small spot of silicon in the holes before fitting the caps.

f. Fix the bracket to the wall using the No.8 x 50 pan head screws and fit the bracket screw cover caps.

g. Apply a 'U' shaped bead of silicon sealant in the base and sides of the tray gasket at the end of the glass panel and end of the gasket.

h. Fit the Entrance side panel cap into the tray gasket and secure with the M6 button head screw, place a small spot of silicon sealant under the screw cover and fit.

**Apply final silicon sealant to the wall mount when all stages of the installation are complete.
(See Silicon Sealant Stage)**

FITTING THE OVERHEAD DELUGE AND RISER RAIL

READ ONLY IF INSTALLING A BLADE MIXER ASSEMBLY

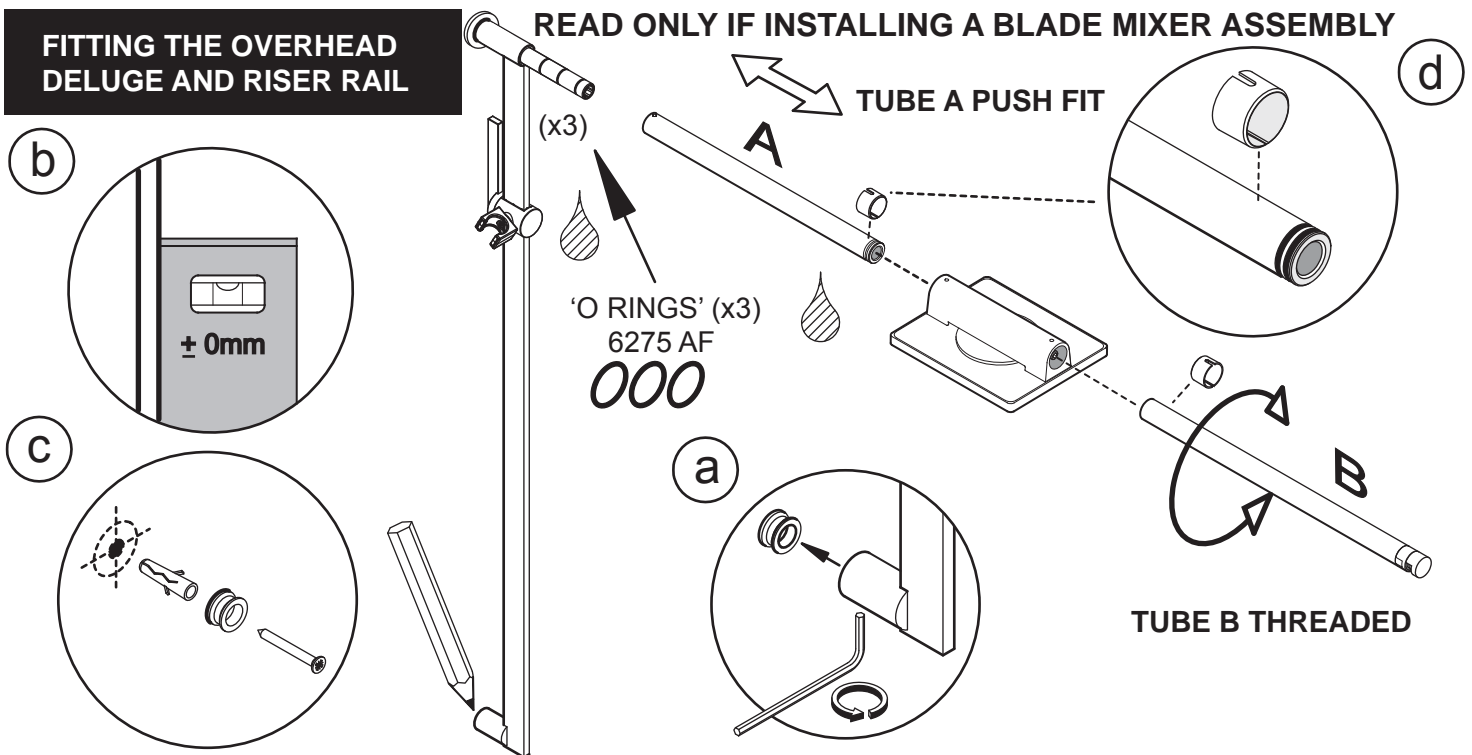

Depending on customer preference, the Hand Shower can be mounted either side of the riser rail, to do this;

- Remove the Bottom Riser Rail Bracket, slide off the Riser Mechanism and rotate about 180°.
 - Slide the Riser Mechanism back onto the Riser Rail (making sure the handle remains at the back of the Riser Rail)
- Replace the Bottom Riser Rail Bracket, twist the Hand Shower Holder around, ready to accept the Hand Shower.

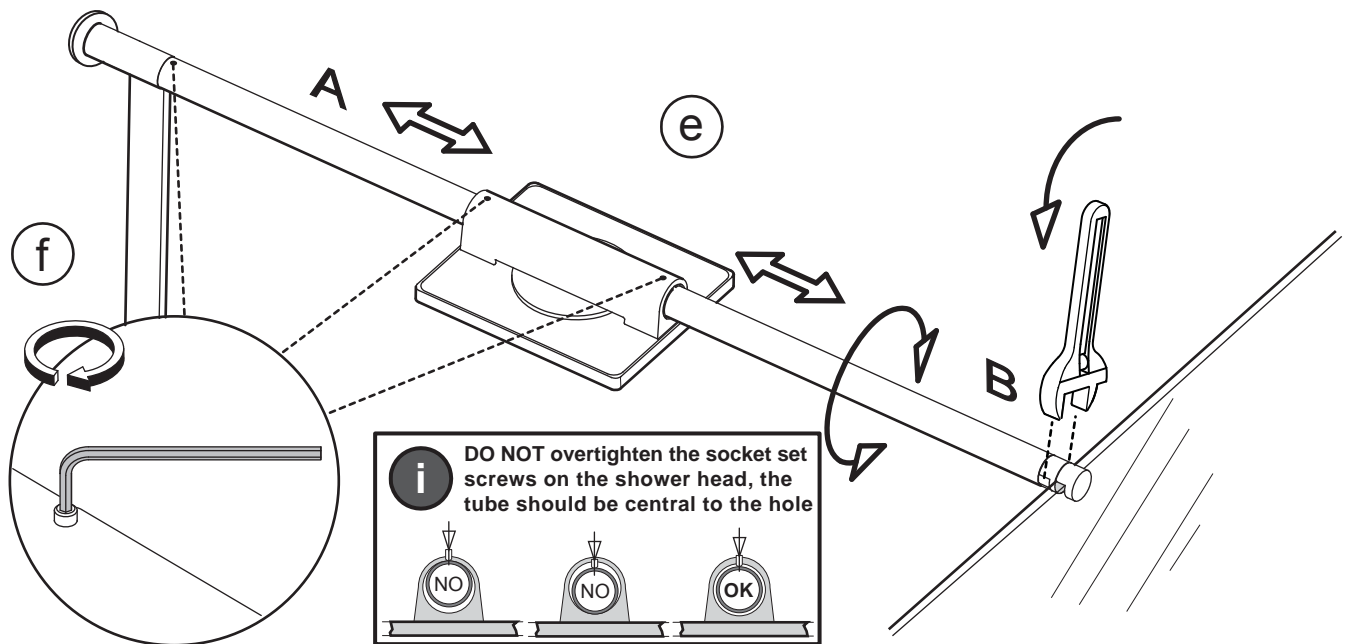

This stage describes the fitting of the Riser Rail & Overhead Deluge.

- Remove the wall plate.
- Moisten with water the 2x 'O rings' located at the back of the overhead spigot to aid assembly. Push the riser rail over the overhead spigot onto the 'O rings' and back to the wall, then level Riser Rail.
- Mark around the bottom riser rail bracket and remove the riser rail and carefully put to one side. Centre the wall plate on the mark and make a second, central mark through the wall plate. Drill and fix the wall plate with the wall plug and screw supplied. Re-fit the riser rail. Push the bottom riser rail bracket onto wall plate and fasten from underneath. (a) Then fit the 3x remaining 'O Rings' (6275 AF from the Kit of Parts) to the overhead spigot, and moisten before fitting the overhead deluge assembly. Assemble the tubes to the Deluge head. Fit tube **A** into the open inlet of the shower head ensuring that the white bearing sleeve (d) is fitted behind the o-rings on the end of the tube. Fit tube **B** into the blanked threaded outlet of the shower head ensuring that the white bearing sleeve is fitted to the tube. Push the bearing sleeves into the openings in the shower head before adjusting the tubes in or out. Adjust the tubes inwards for fitting to the glass and overhead spigot.
- Fit tube A onto the overhead spigot, adjust and centralise the shower head to the showering area. Tighten the glass clamp to the top edge of the front glass panel.
- Tighten the socket set screws on the top of the shower head and on tube A at the joint with the overhead spigot and test.

SILICON SEALANT

READ FOR ALL MODELS
ILLUSTRATIONS SHOW LH MODELS

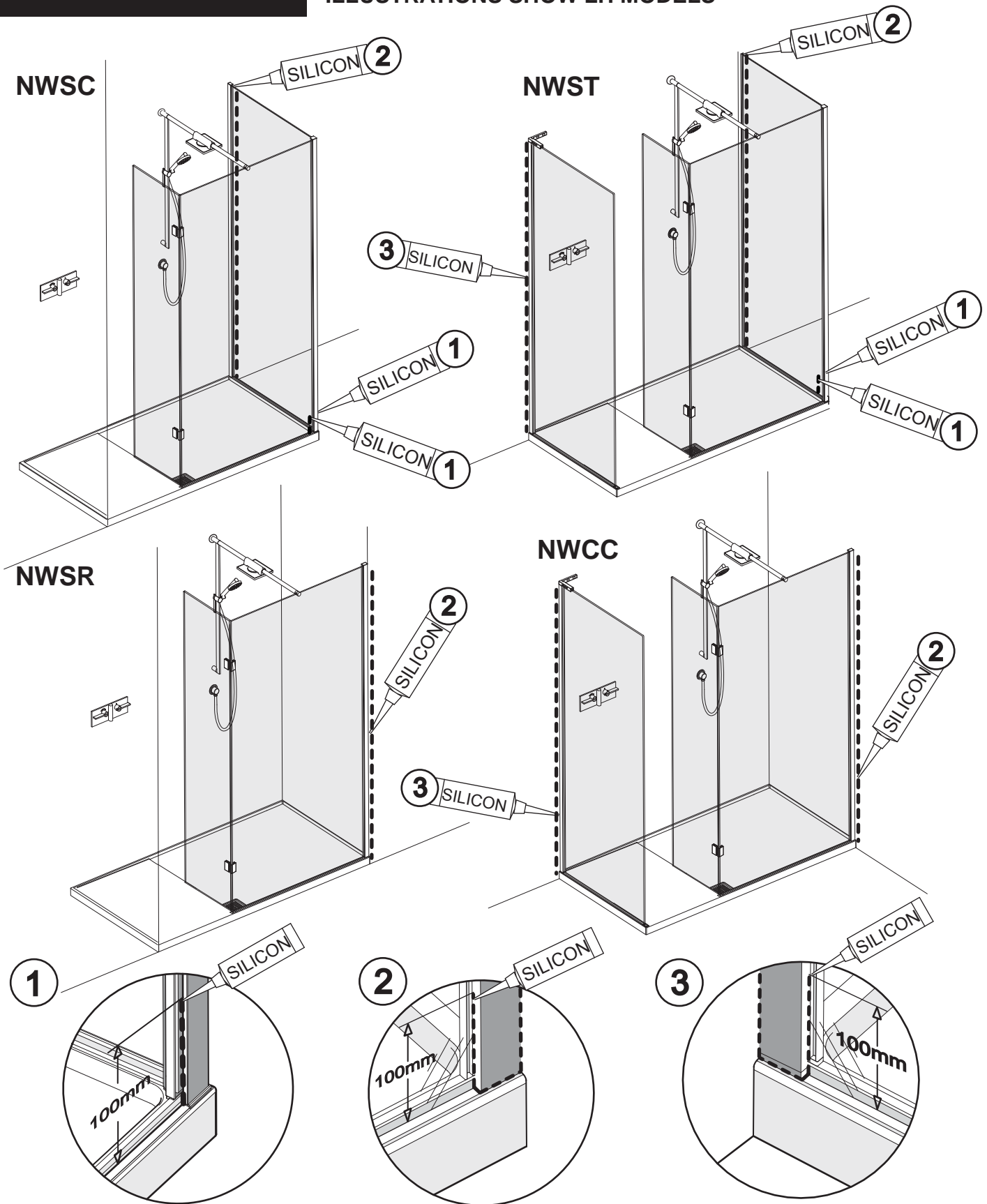

1.NWSC and NWST.

Apply a thin bead of silicon at the bottom of the corner extrusion 100mm up the joint between the front and corner glass panels and the corner extrusion.

2&3.NWCC, NWSR, NWST.

Apply a thin bead of silicon along the bottom edge of both the wall mounts where they meet the tray and 100mm up the joint between the glass panel and wall mount. Apply silicon all the way up the outside of the wall mount extrusion between the wall mount and the tiles. Masking tape can be used to achieve a tidy edge to the sealant. Remove the masking tape immediately and allow the silicon to cure for 24 - 48 hours before using the shower.

NWST/TBH NWST/TH PARTS LIST

ILLUSTRATION SHOWS LH MODEL

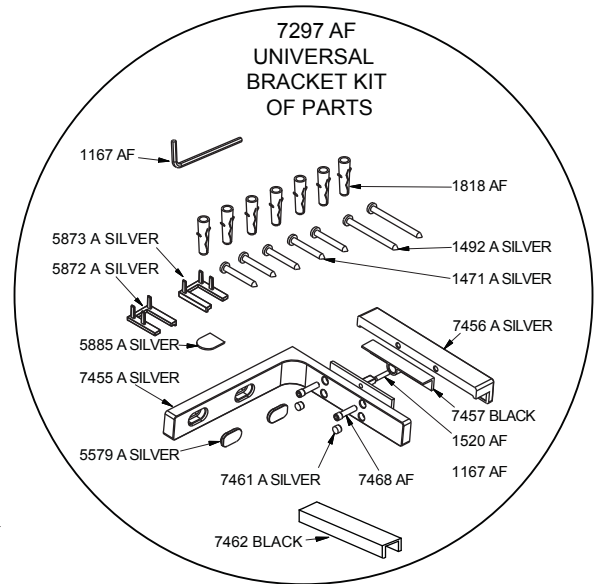
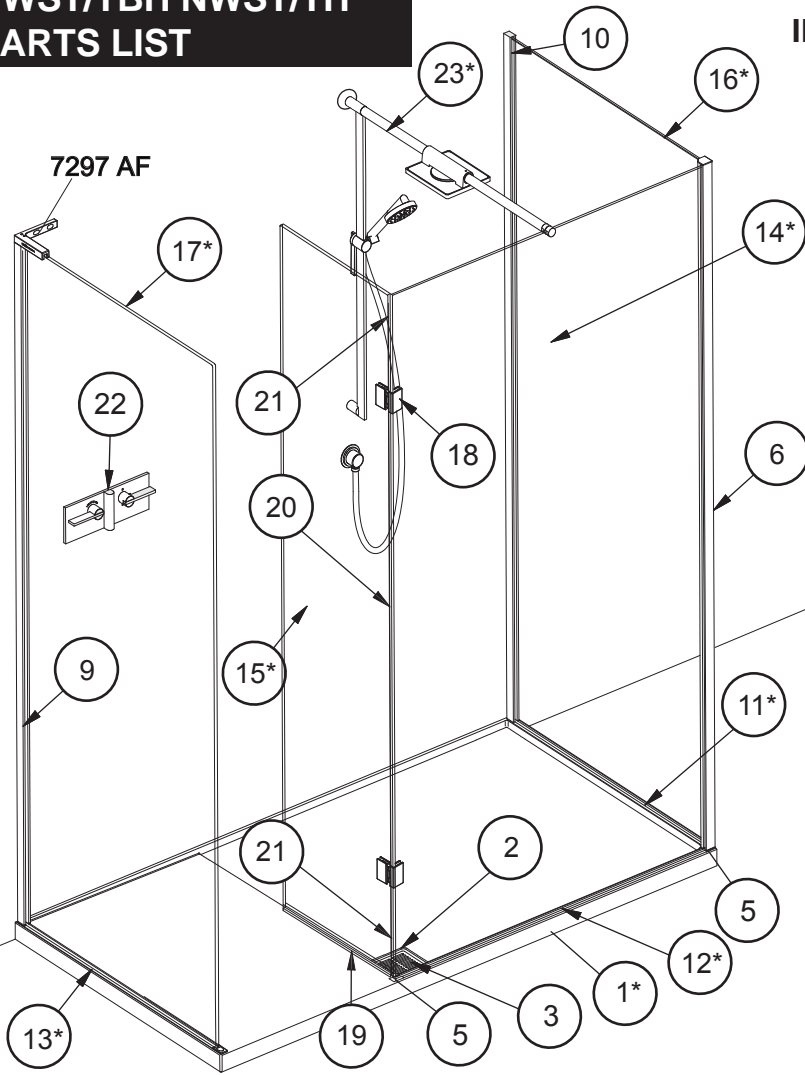

BOUTIQUE NW-H PARTS KIT 7296 AF.

PARTS LIST				
ITEM	DESCRIPTION	PART NUMBER	QTY	LENGTH
* 1	NWST/H 1700 X 900 LH / RH		1	
	NWST/H 1700 X 800 LH / RH		1	
	NWST/H 1500 X 900 LH / RH		1	
	NWST/H 1200 X 900 LH / RH		1	
2	SQUARE WASTE FLANGE	5861 A SILVER	1	
3	SQUARE TRAY GRILL	7491 A SILVER	1	
4	FAST FLOW WASTE WITH 70mm FLANGE	RR0000402	1	
5	CORNER TRAY CAP	5882 A SILVER	2	
6	CORNER EXTRUSION	5790 A SILVER	1	1997mm
7	M4 X 8 SOCKET SET SCREW	1380 A SILVER	2	
8	M4 X 14 SOCKET SET SCREW	1279 A SILVER	2	
9	END PANEL MOUNT	5794 A SILVER	1	1979mm
10	WALL MOUNT	5792 A SILVER	1	1997mm
* 11	CORNER PANEL TRAY GASKET			
	MODEL 800	2329 WHITE	1	751mm
	MODEL 900	2330 WHITE	1	851mm
* 12	FRONT PANEL TRAY GASKET			
	MODEL 1500	2367 WHITE	1	931mm
	MODEL 1700	2368 WHITE	1	1082mm
* 13	ENTRANCE SIDE PANEL TRAY GASKET			
	MODEL 800	2325 WHITE	1	759mm
	MODEL 900	2326 WHITE	1	859mm
* 14	CORNER FRONT PANEL GLASS			
	MODEL 1200	8191 M CLEAR/PLAIN	1	608mm
	MODEL 1500	8184 M CLEAR/PLAIN	1	908mm
	MODEL 1700	8185 M CLEAR/PLAIN	1	1058mm
* 15	HINGE PANEL GLASS			
	MODEL 1200	7678 M CLEAR/PLAIN	1	400mm
	MODEL 1500	8187 M CLEAR/PLAIN	1	450mm
	MODEL 1700	8188 M CLEAR/PLAIN	1	500mm
* 16	CORNER PANEL GLASS			
	MODEL 800	7973 M CLEAR/PLAIN	1	2000 x 747mm
	MODEL 900	7972 M CLEAR/PLAIN	1	2000 x 847mm
* 17	ENTRANCE SIDE PANEL GLASS			
	MODEL 800	7979 M CLEAR/PLAIN	1	2000 x 740mm
	MODEL 900	7978 M CLEAR/PLAIN	1	2000 x 840mm
18	NWH OPENING HINGE	7295 AF	2	
* 19	NWH HORIZONTAL SEAL 1500	2372 CLEAR	1	445mm
	NWH HORIZONTAL SEAL 1700	2373 CLEAR	1	495mm
20	BOUTIQUE CENTRE VERTICAL SEAL	2382 CLEAR	1	1193mm
21	BOUTIQUE VERTICAL SEAL	2383 CLEAR	2	376mm
22	EX20 ELIXIR MIXER	SW- EX20	1	
* 23	RISER, HANDSET, WALL OUTLET	NW 8696 KIT	1	
	OVERHEAD DELUGE, RISER, HANDSET	NW 80 KIT	1	
	OVERHEAD DELUGE, RISER, HANDSET	NW 90 KIT	1	

ITEM	DESCRIPTION	PART No.	QTY
1	WALL MOUNT TOP CAP	5869 A SILVER	1
2	CORNER EXTRUSION TOP CAP LH	5870 A SILVER	1
3	TRAY CLAMP COVER CAP	5885 A SILVER	1
4	CORNER EXTRUSION TOP CAP RH	5868 A SILVER	1
5	GLASS LEVELING BLOCK	5887 CLEAR	3
6	M4 x 8 CSK SOCKET HEAD SCREW	1499 A SILVER	1
7	WALL PLUG	1818 AF	5
8	No.8 x 32 PAN HEAD SELF TAPPING SCREW	1471 A SILVER	5
9	4mm ALLEN KEY	1166 AF	1
10	3mm ALLEN KEY	1167 AF	1
11	2.5mm ALLEN KEY	1168 AF	1
12	2mm ALLEN KEY	1286 AF	1
13	SILICON SEALANT 78g WITH LOGO	1967 AF	1
14	INSTALLATION INSTRUCTIONS	0964 AF	1
15	GUARANTEE BOOKLET	1061 AF	1

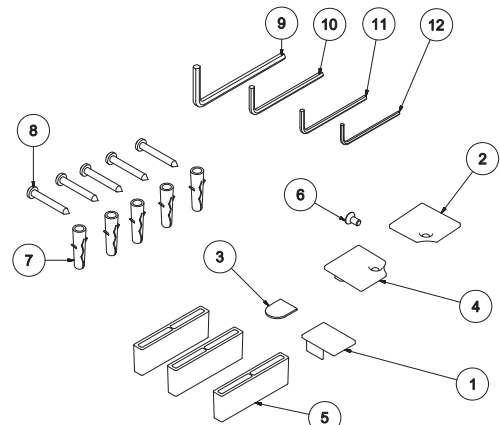

* ITEM VARIES DEPENDING ON MODEL

NWSC/TBH NWSC/TH PARTS LIST

ILLUSTRATION SHOWS LH MODEL

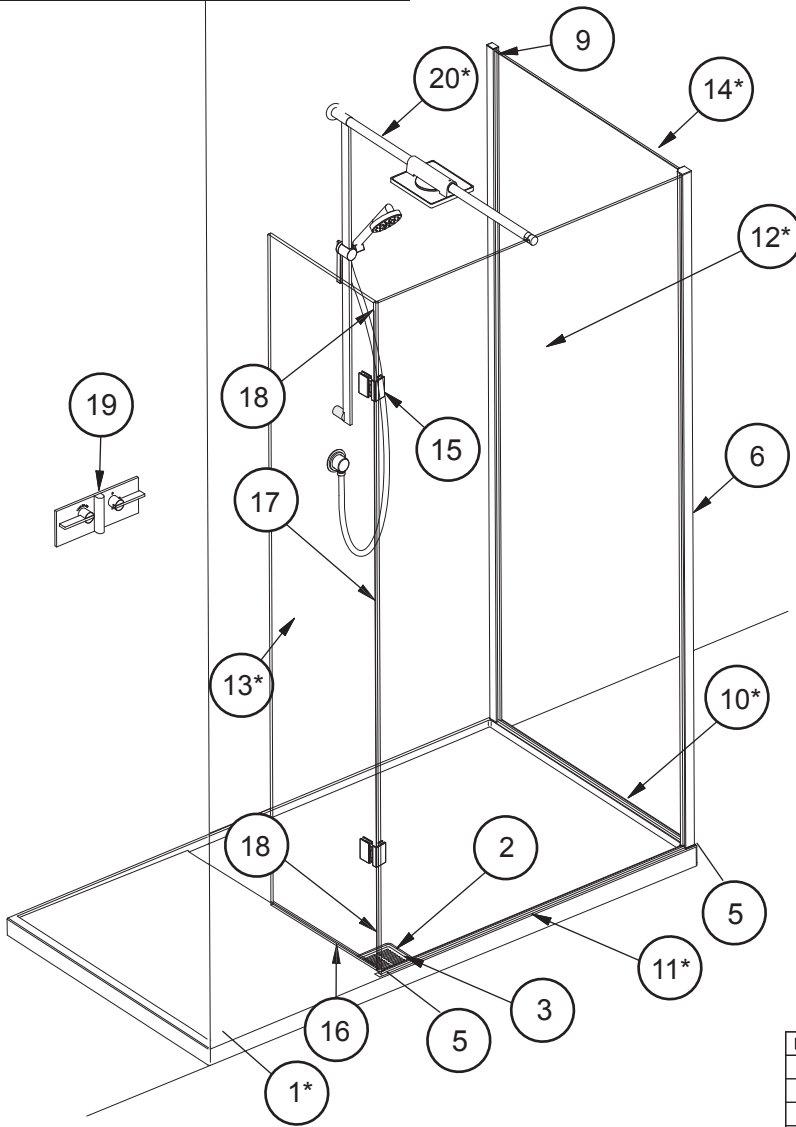

BOUTIQUE NW-H PARTS KIT 7296 AF.

ITEM	DESCRIPTION	PART No.	QTY
1	WALL MOUNT TOP CAP	5869 A SILVER	1
2	CORNER EXTRUSION TOP CAP LH	5870 A SILVER	1
3	TRAY CLAMP COVER CAP	5885 A SILVER	1
4	CORNER EXTRUSION TOP CAP RH	5868 A SILVER	1
5	GLASS LEVELING BLOCK	5887 CLEAR	3
6	M4 x 8 CSK SOCKET HEAD SCREW	1499 A SILVER	1
7	WALL PLUG	1818 AF	5
8	No.8 x 32 PAN HEAD SELF TAPPING SCREW	1471 A SILVER	5
9	4mm ALLEN KEY	1166 AF	1
10	3mm ALLEN KEY	1167 AF	1
11	2.5mm ALLEN KEY	1168 AF	1
12	2mm ALLEN KEY	1286 AF	1
13	SILICON SEALANT 78g WITH LOGO	1967 AF	1
14	INSTALLATION INSTRUCTIONS	0964 AF	1
15	GUARANTEE BOOKLET	1061 AF	1

PARTS LIST				
ITEM	DESCRIPTION	PART NUMBER	QTY	LENGTH
* 1	NWSC/H 1700 X 900 LH / RH		1	
	NWSC/H 1700 X 800 LH / RH		1	
	NWSC/H 1500 X 900 LH / RH		1	
	NWSC/H 1200 X 900 LH / RH		1	
			1	
2	SQUARE WASTE FLANGE	5861 A SILVER	1	
3	SQUARE TRAY GRILL	7491 A SILVER	1	
4	FAST FLOW WASTE WITH 70mm FLANGE	RR0000402	1	
5	CORNER TRAY CAP	5882 A SILVER	2	
6	CORNER EXTRUSION	5790 A SILVER	1	1997mm
7	M4 X 8 SOCKET SET SCREW	1360 A SILVER	2	
8	M4 X 14 SOCKET SET SCREW	1279 A SILVER	2	
9	WALL MOUNT	5792 A SILVER	1	1997mm
* 10	CORNER PANEL TRAY GASKET			
	MODEL 800	2329 WHITE	1	751mm
	MODEL 900	2330 WHITE	1	851mm
* 11	FRONT PANEL TRAY GASKET			
	MODEL 1500	2367 WHITE	1	931mm
	MODEL 1700	2368 WHITE	1	1082mm
* 12	CORNER FRONT PANEL GLASS			
	MODEL 1200	8191 M CLEAR/PLAIN		608mm
	MODEL 1500	8184 M CLEAR/PLAIN		908mm
	MODEL 1700	8185 M CLEAR/PLAIN	1	1058mm
* 13	HINGE PANEL GLASS			
	MODEL 1200	7878 M CLEAR/PLAIN	1	400mm
	MODEL 1500	8187 M CLEAR/PLAIN	1	450mm
	MODEL 1700	8188 M CLEAR/PLAIN	1	500mm
* 14	CORNER PANEL GLASS			
	MODEL 800	7973 M CLEAR/PLAIN	1	2000 x 747mm
	MODEL 900	7972 M CLEAR/PLAIN	1	2000 x 847mm
* 15	NWH OPENING HINGE	7295 AF	2	
* 16	NWH HORIZONTAL SEAL 1500	2372 CLEAR	1	445mm
	NWH HORIZONTAL SEAL 1700	2373 CLEAR	1	495mm
	BOUTIQUE CENTRE VERTICAL SEAL	2382 CLEAR	1	1196mm
	BOUTIQUE VERTICAL SEAL	2383 CLEAR	2	378mm
* 19	EX20 ELIXIR MIXER	SW- EX20	1	
* 20	RISER, HANDSET, WALL OUTLET	NW 8696 KIT	1	
	OVERHEAD DELUGE, RISER, HANDSET	NW 80 KIT	1	
	OVERHEAD DELUGE, RISER, HANDSET	NW 90 KIT	1	

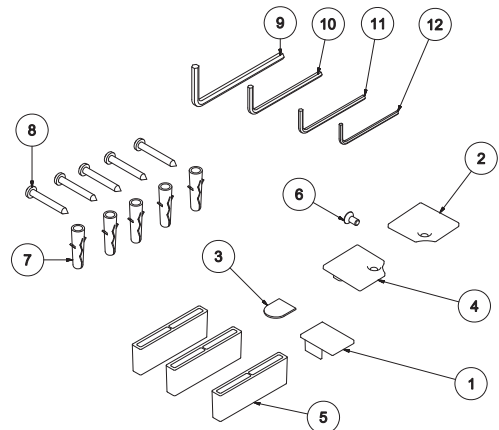

* ITEM VARIES DEPENDING ON MODEL

NWSR/TBH NWSR/TH PARTS LIST

ILLUSTRATION SHOWS LH MODEL

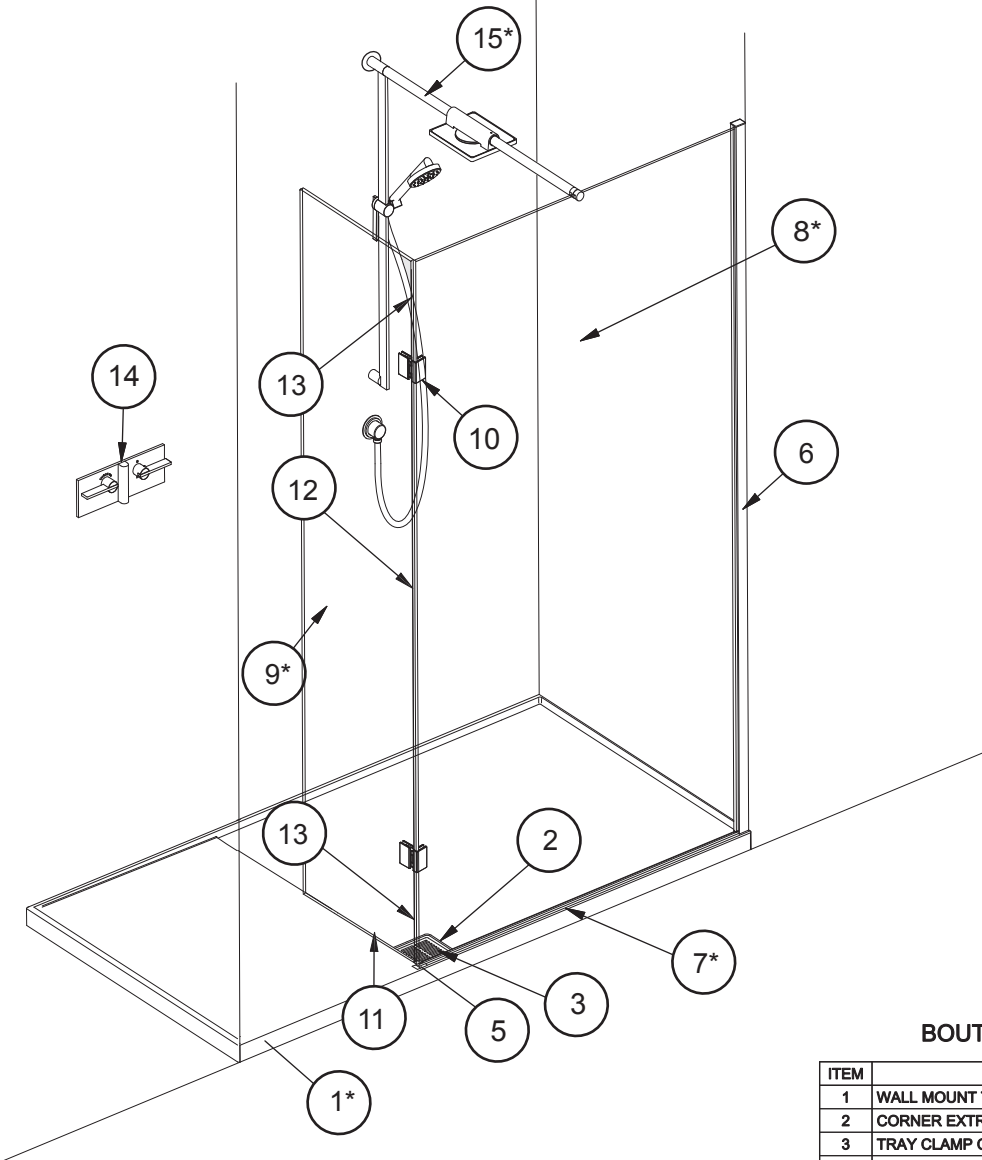

BOUTIQUE NW-H PARTS KIT 7296 AF.

ITEM	DESCRIPTION	PART No.	QTY
1	WALL MOUNT TOP CAP	5869 A SILVER	1
2	CORNER EXTRUSION TOP CAP LH	5870 A SILVER	1
3	TRAY CLAMP COVER CAP	5885 A SILVER	1
4	CORNER EXTRUSION TOP CAP RH	5868 A SILVER	1
5	GLASS LEVELING BLOCK	5887 CLEAR	3
6	M4 x 8 CSK SOCKET HEAD SCREW	1499 A SILVER	1
7	WALL PLUG	1818 AF	5
8	No.8 x 32 PAN HEAD SELF TAPPING SCREW	1471 A SILVER	5
9	4mm ALLEN KEY	1166 AF	1
10	3mm ALLEN KEY	1167 AF	1
11	2.5mm ALLEN KEY	1168 AF	1
12	2mm ALLEN KEY	1286 AF	1
13	SILICON SEALANT 78g WITH LOGO	1967 AF	1
14	INSTALLATION INSTRUCTIONS	0964 AF	1
15	GUARANTEE BOOKLET	1061 AF	1

PARTS LIST				
ITEM	DESCRIPTION	PART NUMBER	QTY	LENGTH
* 1	NWSR/H 1700 X 900 LH / RH		1	
	NWSR/H 1700 X 800 LH / RH		1	
	NWSR/H 1500 X 900 LH / RH		1	
	NWSR/H 1200 X 900 LH / RH		1	
			1	
			1	
2	SQUARE WASTE FLANGE	5861 A SILVER	1	
3	SQUARE TRAY GRILL	7491 A SILVER	1	
4	FAST FLOW WASTE WITH 70mm FLANGE	RR0000402	1	
5	CORNER TRAY CAP	5882 A SILVER	1	
6	WALL MOUNT	5792 A SILVER	1	1997mm
* 7	FRONT PANEL TRAY GASKET			
	MODEL 1500	2369 WHITE	1	935mm
	MODEL 1700	2370 WHITE	1	1085mm
* 8	FRONT PANEL GLASS			
	MODEL 1200	8191 M CLEAR/PLAIN	1	608mm
	MODEL 1500	8184 M CLEAR/PLAIN	1	908mm
	MODEL 1700	8185 M CLEAR/PLAIN	1	1058mm
* 9	HINGE PANEL GLASS			
	MODEL 1200	7678 M CLEAR/PLAIN	1	400mm
	MODEL 1500	8187 M CLEAR/PLAIN	1	450mm
	MODEL 1700	8188 M CLEAR/PLAIN	1	500mm
10	NWH OPENING HINGE	7295 AF	2	
* 11	NWH HORIZONTAL SEAL 1500	2372 CLEAR	1	445mm
	NWH HORIZONTAL SEAL 1700	2373 CLEAR	1	495mm
12	BOUTIQUE CENTRE VERTICAL SEAL	2382 CLEAR	1	1196mm
13	BOUTIQUE VERTICAL SEAL	2383 CLEAR	2	376mm
14	EX20 ELIXIR MIXER	SW- EX20	1	
* 15	RISER, HANDSET, WALL OUTLET	NW 8696 KIT	1	
	OVERHEAD DELUGE, RISER, HANDSET	NW 80 KIT	1	
	OVERHEAD DELUGE, RISER, HANDSET	NW 90 KIT	1	

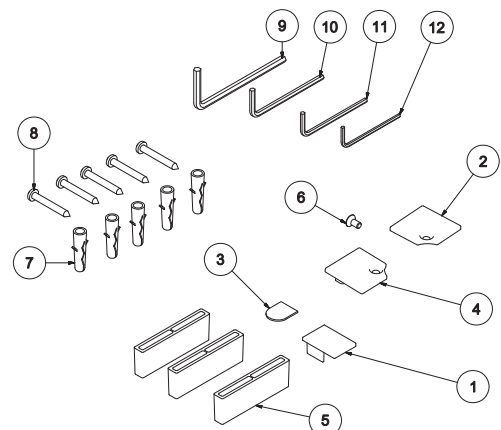

* ITEM VARIES DEPENDING ON MODEL

NWCC/TBH NWCC/TH PARTS LIST

ILLUSTRATION SHOWS LH MODEL

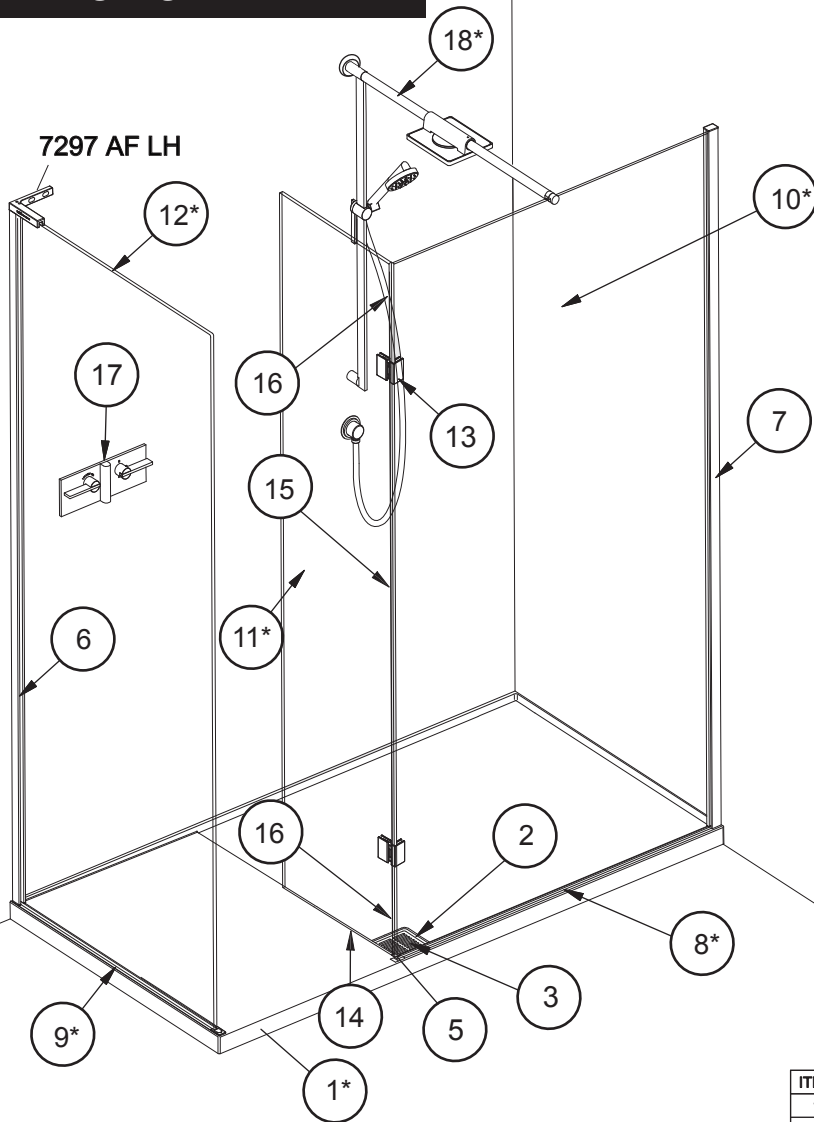

BOUTIQUE NW-H PARTS KIT 7296 AF.

ITEM	DESCRIPTION	PART No.	QTY
1	WALL MOUNT TOP CAP	5869 A SILVER	1
2	CORNER EXTRUSION TOP CAP LH	5870 A SILVER	1
3	TRAY CLAMP COVER CAP	5885 A SILVER	1
4	CORNER EXTRUSION TOP CAP RH	5868 A SILVER	1
5	GLASS LEVELLING BLOCK	5887 CLEAR	3
6	M4 x 8 CSK SOCKET HEAD SCREW	1499 A SILVER	1
7	WALL PLUG	1818 AF	5
8	No.8 x 32 PAN HEAD SELF TAPPING SCREW	1471 A SILVER	5
9	4mm ALLEN KEY	1166 AF	1
10	3mm ALLEN KEY	1167 AF	1
11	2.5mm ALLEN KEY	1168 AF	1
12	2mm ALLEN KEY	1286 AF	1
13	SILICON SEALANT 78g WITH LOGO	1967 AF	1
14	INSTALLATION INSTRUCTIONS	0964 AF	1
15	GUARANTEE BOOKLET	1061 AF	1

PARTS LIST				
ITEM	DESCRIPTION	PART NUMBER	QTY	LENGTH
* 1	NWCC/H 1700 X 900 LH / RH		1	
	NWCC/H 1700 X 800 LH / RH		1	
	NWCC/H 1500 X 900 LH / RH		1	
	NWCC/H 1200 X 900 LH / RH		1	
2	SQUARE WASTE FLANGE	5861 A SILVER	1	
3	SQUARE TRAY GRILL		1	
4	FAST FLOW WASTE WITH 70mm FLANGE	5880 A SILVER	1	
5	CORNER TRAY CAP	5882 A SILVER	2	
6	END PANEL MOUNT	5794 A SILVER	1	1979mm
7	WALL MOUNT	5792 A SILVER	1	1997mm
* 8	FRONT PANEL TRAY GASKET			
	MODEL 1500	2369 WHITE	1	935mm
	MODEL 1700	2370 WHITE	1	1085mm
* 9	ENTRANCE SIDE PANEL TRAY GASKET			
	MODEL 800	2325 WHITE	1	759mm
	MODEL 900	2326 WHITE	1	859mm
* 10	FRONT PANEL GLASS			
	MODEL 1200	8191 M CLEAR/PLAIN	1	608mm
	MODEL 1500	8184 M CLEAR/PLAIN	1	908mm
	MODEL 1700	8185 M CLEAR/PLAIN	1	1058mm
11	HINGE PANEL GLASS			
* 12	ENTRANCE SIDE PANEL GLASS			
	MODEL 800	7979 M CLEAR/PLAIN	1	2000 x 740mm
	MODEL 900	7978 M CLEAR/PLAIN	1	2000 x 840mm
13	NWH OPENING HINGE	7295 AF	2	
* 14	NWH HORIZONTAL SEAL 1500	2372 CLEAR	1	445mm
	NWH HORIZONTAL SEAL 1700	2373 CLEAR	1	495mm
15	BOUTIQUE CENTRE VERTICAL SEAL	2382 CLEAR	1	1196mm
16	BOUTIQUE VERTICAL SEAL	2383 CLEAR	2	378mm
17	EX20 ELIXIR MIXER	SW- EX20	1	
* 18	RISER, HANDSET, WALL OUTLET	NW 8696 KIT	1	
	OVERHEAD DELUGE, RISER, HANDSET	NW 80 KIT	1	
	OVERHEAD DELUGE, RISER, HANDSET	NW 90 KIT	1	

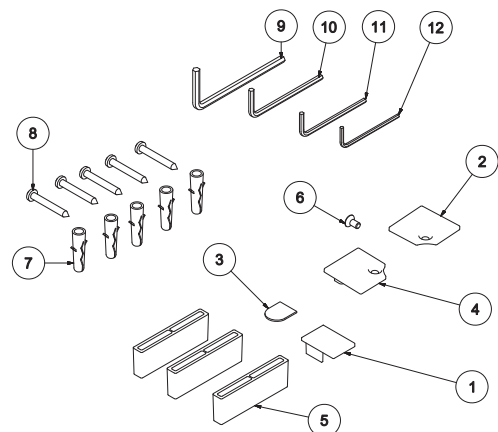

* ITEM VARIES DEPENDING ON MODEL

READ ONLY IF INSTALLING WITHOUT AN OVERHEAD DELUGE

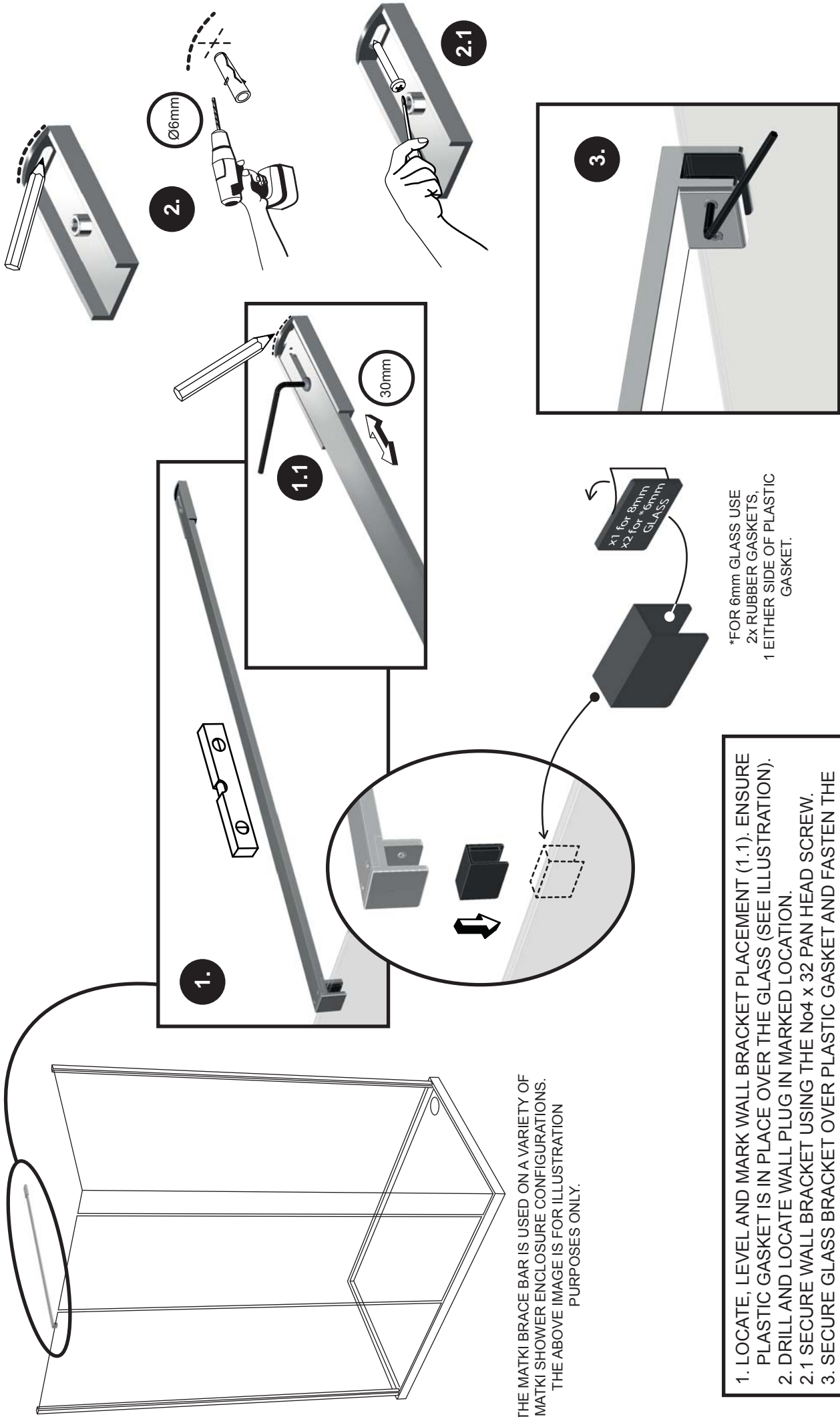

THE MATKI BRACE BAR IS USED ON A VARIETY OF MATKI SHOWER ENCLOSURE CONFIGURATIONS. THE ABOVE IMAGE IS FOR ILLUSTRATION PURPOSES ONLY.

1. LOCATE, LEVEL AND MARK WALL BRACKET PLACEMENT (1.1). ENSURE PLASTIC GASKET IS IN PLACE OVER THE GLASS (SEE ILLUSTRATION).
2. DRILL AND LOCATE WALL PLUG IN MARKED LOCATION.
- 2.1 SECURE WALL BRACKET USING THE No4 x 32 PAN HEAD SCREW.
3. SECURE GLASS BRACKET OVER PLASTIC GASKET AND FASTEN THE TWO GRUB SCREWS.

*FOR 6mm GLASS USE
2x RUBBER GASKETS,
1 EITHER SIDE OF PLASTIC
GASKET.

x1 for 8mm
x2 for 6mm
GLASS

Matki Glass Guard Easy Clean Surface Protection (optional) and General Cleaning Guide

Cleaning Instructions

Matki Glass Guard allows water to form minute beads which easily trickle off the surface of the glass. This makes the glass easier to clean - the glass does not need to be cleaned as frequently, but it does require occasional maintenance. As less cleaning is required the use of detergents can be minimised thus helping to protect the environment. The lifespan of the Matki Glass Guard is dependant on the frequency of use of the shower and the degree of water hardness.

The combination of alkaline materials and humidity affects glass in an extremely aggressive way. Do not use bleach, alkaline, acid-based or aggressive and abrasive glass cleaners, detergents or household cleaning products on the glass or frames.

We recommend that glass is washed down with clean water and a soft clean cloth or sponge and dried off with a microfibre cloth.

The special coating is only present on the inside of the glass.

Matki Glass Guard is guaranteed for 2 years provided that the guidelines and cleaning instructions are followed.

Aluminium and Chrome parts should be cleaned with a mild non scratch household cleaner and a soft cloth or sponge.

Do not use acidic-based descaler products or products which are unsuitable for cleaning enamelled surfaces, including abrasive cleaners or cleaners containing bleach or solvents, as the products will effect the anodised framework. Under no circumstances use cleaners with a pH level exceeding 8.

Matki does not recommend the use of 'Leave-on' shower cleaners on Matki Glass Guard Products.

Water Softeners and Glass Guard - Certain types of water softeners increase the alkalinity of the water due to a carry-over of Chloride during re-generation which can cause aggressive water spots on both untreated and Glass Guarded glass. If using a water softener we recommend a two-cylinder machine with automatic re-generation instead of a timer.

If a single-cylinder water softener with timer is already installed it is recommended that after each shower excess water is removed from the glass with a squeegee or with a micro-fibre cloth.



Wash down with clean warm water and a soft clean cloth or sponge.



Do not use bleach, alkaline or acid-based, aggressive or abrasive cleaning products.

Flash Bathroom Spray or Cif Bathroom Spray can be used on Matki Products.

Various specialist cleaning and glass dressing products are available from Ritec International Ltd Tel. 020 8344 8210 or www.ritec.co.uk. Matki Plc is not connected with Ritec International Ltd in any way and the contact details are supplied for information only. Read manufacturers label before using any cleaning materials.

IMPORTANT

Matki Glass Guard is guaranteed for 2 years. It is essential that the cleaning instructions are followed in order to maintain the hydrophobic properties of the glass coating. In the event of the failure to comply in any way with these instructions, any warranty or guarantee will be null and void.

MATKI PLC, CHURCHWARD ROAD, YATE, BRISTOL, BS37 5PL
TELEPHONE:01454 328816 (AFTER SALES) FAX:01454 328821 EMAIL: techsupport@matki.co.uk

