

FAST EASY FIXING SETS

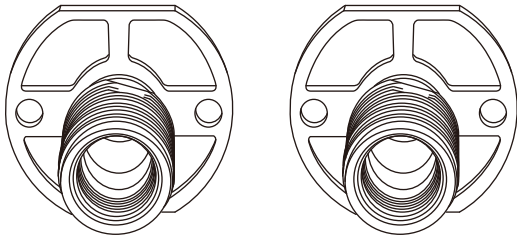

INSTALLING THE FAST FIT KIT

1. Identify all components are present prior to starting installation.
2. Using the template supplied with the fast fit kit mark out the position for the pipework and the fixings supplied.

⚠ Note: The Pipe centres required for this Thermostatic Mixing Valve are 150mm.



Before drilling into walls, check that there are no hidden electrical wires, cables or water supply pipes. This can be checked with the aid of an electronic detector.

- If power tools are used do not forget to;
- Wear eye protection
- Unplug equipment after use

3. Drill suitable holes in the wall surface at the marked positions to accommodate the supply pipework and fixings.

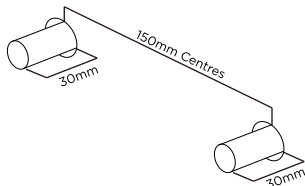

Fig.1

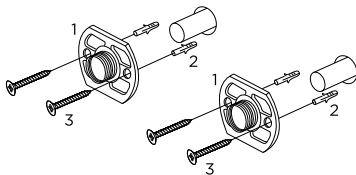

Fig.2

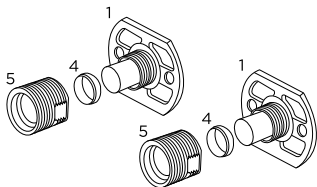

Fig.3

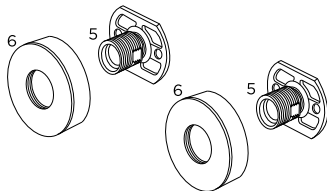

Fig.4

4. Terminate the pipework in the wall ensuring that there is at least 30mm of 15mm diameter pipework protruding from the finished wall surface (See Fig.1).

⚠ Important: The water supply pipes to the Thermostatic Mixing Valve must be with the Hot on the left and the Cold on the right when viewed from the front.

5. Place the wall plates (1) over the supply pipes. Using the wall plugs (2) and screws (3) provided fix the wall plates to the wall (See Fig.2).

6. Place the olives (4) onto the protruding pipework (See Fig.3).

⚠ Important: The pipework must not protrude past the olive (4) by more than 5mm.

7. Holding the flat edges of the wall plate (1) with a 47mm spanner screw the fixing bridge (5) onto the wall plate (1) using a 22mm spanner. Repeat this step on both sides (See Fig.3).

8. Screw the covers (6) over the wall plates / fixing bridges (5), so they are flush against the finished wall surface (See Fig.4).