

# FREE-STANDING BATH/SHOWER MIXER

## Installation and Maintenance Instructions

This mixer should be installed in compliance with Water Regulations. For further details contact your Local Water Authority.

**Fitting your new mixer is easy when you follow these simple step-by-step instructions.**

- (a) Identify all components.
- (b) Prior to installation, flush out pipework to remove debris.
- (c) Turn off water supply.
- (d) Place fixing plates (10) on the floor in required position and mark hole locations.
- (e) Drill holes in the floor and place the wall plugs (11) into the holes.
- (f) Connect the flexible pipes (12) to the hot & cold water supply and then match the holes.
- (g) Ensure taps are in the off position.
- (h) Turn on water supply and check for leaks around the flexible pipes (12).
- (i) Line the fixing plates up with the wallplugs (11) with the tap in the correct position.
- (j) Tighten the screws (9) until stand pipes (6) are held secure.
- (k) Tighten the nuts (8) to secure onto fixing plates (10).
- (l) Slide cover plates (7) down over fixing plates (10).
- (m) Fix shower hose (2) to the handset (1) and cradle, and then place the handset (1) to the cradle.
- (n) Test the tap for leaks.
- (o) Installed.

Item NO	Item NO	Qty
1	Handset	1
2	Shower Hose	1
3	Tap Body	1
4	Washers	2
5	Connectors	2
6	Stand Pipes	2
7	Cover Plates	2
8	Nuts	2
9	Screws	8
10	Fixing Plates	2
11	Wall Plugs	8
12	Flexible Pipes	2

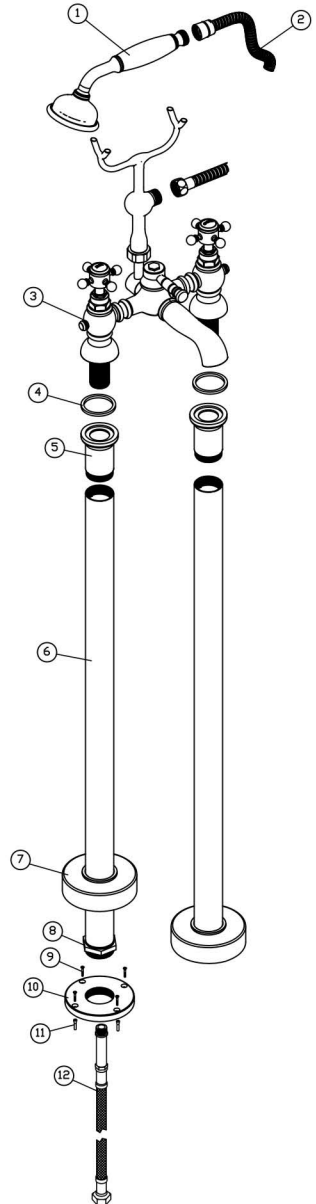

### Aftercare Instructions

Whilst modern plating techniques are used in the manufacture of this mixer, the surfaces will wear if cleaned incorrectly. Clean this item with a soft cloth and clean water. The use of any abrasive material will invalidate the guarantee.