

Geberit Xeno² cabinet for washbasin made of solid surface material, with two drawers

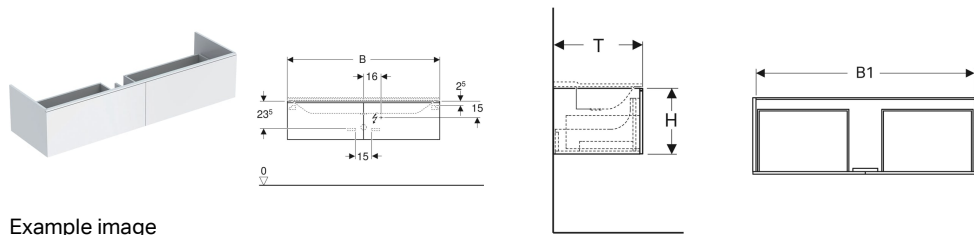

Example image

Characteristics

- Wall-hung
- With two drawers
- Opening with push-to-open mechanism
- Drawer with soft-closing
- Drawer with antislip mat
- Drawer with LED light
- LED lighting with proximity sensor
- Moisture-resistant
- Delivered preassembled

Technical data

Protection degree	IP44
Protection class	II
Nominal voltage	230 V AC
Mains frequency	50 Hz
Operating voltage	12 V DC
Product material	High-compressed three-layer chipboard
Energy efficiency class	A++
Light colour	6400 K

Scope of delivery

- Fastening material

Art. no.	Colour / surface	B	B1	Washbasin width	H	T	Power consumption	Luminous flux
500.346.01.1	white / matt coated	159.5 cm	156.2 cm	160 cm	35 cm	47.3 cm	15 W	1240 lm
500.347.00.1	white / matt coated	139.5 cm	135.4 cm	140 cm	35 cm	47.3 cm	13.5 W	1080 lm
500.346.00.1	greige / matt coated	159.5 cm	156.2 cm	160 cm	35 cm	47.3 cm	15 W	1240 lm
500.348.00.1	greige / matt coated	139.5 cm	135.4 cm	140 cm	35 cm	47.3 cm	13.5 W	1080 lm
500.346.43.1	scultura grey / wooden-textured melamine	159.5 cm	156.2 cm	160 cm	35 cm	47.3 cm	15 W	1240 lm
500.348.43.1	scultura grey / wooden-textured melamine	139.5 cm	135.4 cm	140 cm	35 cm	47.3 cm	13.5 W	1080 lm

Accessories

- Geberit Xeno² drawer insert, T-partition
- Geberit Xeno² drawer insert, H-partition
- Geberit towel rail for bathroom furniture, with right-angled corner
- Geberit towel rail for bathroom furniture, with radius corner