

Geberit Duofix frame for wall-hung WC, 112 cm, without cistern

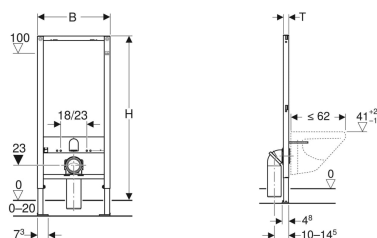

Example image



Application purposes

- For drywall construction
- For installation in part- or room-height prewall installations
- For installation in room-height installation walls
- For installation in part- or room-height Geberit Duofix system walls
- For wall-hung WCs with connection dimensions in accordance with EN 33:2011
- For wall-hung WCs with projection up to 62 cm
- For floor constructions 0–20 cm

Characteristics

- Self-supporting frame, powder-coated

- Frame with $\varnothing 9$ mm drilling holes for fastening in wood frame construction
- Frame prepared for support brackets for WC ceramic appliances with small contact surfaces
- Galvanized feet
- Feet adjustable 0–20 cm
- Non-slip leg supports
- Rotatable foot plates
- Foot plate depth suitable for installation in U-profiles UW 50 and UW75 and Geberit Duofix system rails
- Connection bend can be mounted without tools at different depths, adjustable range 45 mm
- Rotatable connection bend for connection piece for horizontal outlet to the rear
- Fastening for connection bend, sound-absorbing

Scope of delivery

- Set of wall anchors for single and system installation
- Connection set for WC, $\varnothing 90$ mm
- Connection bend 90° made of PVC, $\varnothing 90 / 100$ mm
- Protection plug
- 2 threaded rods M12
- Fastening material

Art. no.	B	H	T
111.321.00.1	50 cm	112 cm	4 cm

Accessories

- Geberit set of support brackets for WC ceramic appliances with small contact surfaces
- Geberit Duofix set of wall anchors for single installation, corner construction
- Geberit Duofix set of wall anchors for single installation
- Geberit Duofix set of wall anchors for single and system installation
- Geberit Duofix foot fastener set on rear wall
- Geberit Duofix fastening set for stud clearance 50–57.5 cm
- Geberit Duofix set of foot extensions for floor construction 20–40 cm
- Geberit Duofix set of leg supports with large foot plate
- Geberit concealed outlet for drywall and solid wall construction
- Reinforcing sheet for drywall construction, for Geberit Duofix frame for wall-hung WC, width 50 cm



- Any boarding must be fixed tight up against the face of the Duofix frame and screwed directly to the frame