

32 186 000 **VERIS BASIN MIXER 1/2"**  
**S-SIZE**

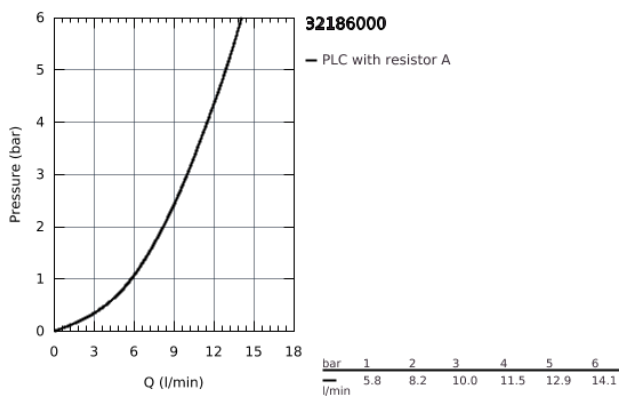

**PRODUCT DESCRIPTION**

- monobloc installation
- 28 mm ceramic cartridge  
with **GROHE SilkMove**
- **GROHE StarLight** chrome finish
- **SpeedClean** mousseur
- flexible connection hoses

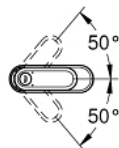
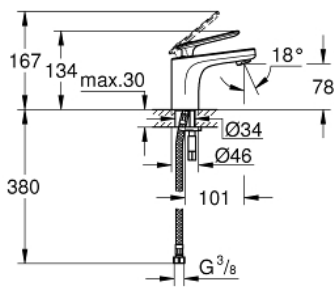

32 186 000 **VERIS BASIN MIXER 1/2"**  
**S-SIZE**

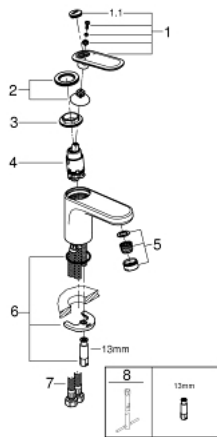

**SPARE PARTS**, August 2016 – now

- 1: Lever (Order-nr. 46661000)
- 1.1: Cover Cap (Order-nr. 46672000)
- 2: Shield for cross handle (Order-nr. 46662000)
- 3: Ring (Order-nr. 64571000)
- 4: Cartridge (Order-nr. 46580000)
- 5: Flow straightener (Order-nr. 64447000)
- 6: Shank mounting kit (Order-nr. 46671000)
- 7: Connection hose (Order-nr. 46255000)
- 8: Mounting wrench (Order-nr. 19017000)\*

\* Optional accessories