

20 575 000 BAUFLOW PILLAR TAP 1/2" XS-SIZE

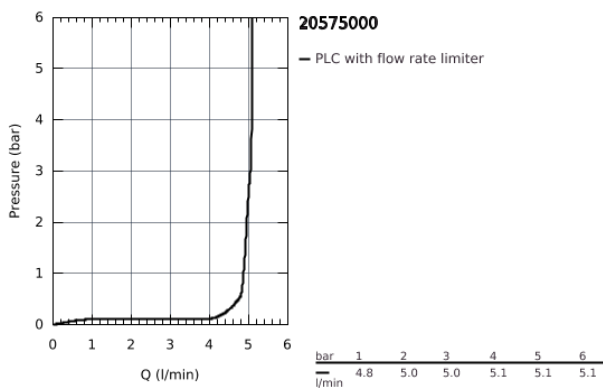

PRODUCT DESCRIPTION

- monobloc installation
- metal lever
- ceramic headpart
- **GROHE StarLight** chrome finish
- **GROHE EcoJoy** mousseur 5.7 l/min
- fixation nut G 1/2"

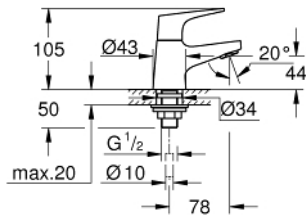

20 575 000 BAUFLOW PILLAR TAP 1/2" XS-SIZE

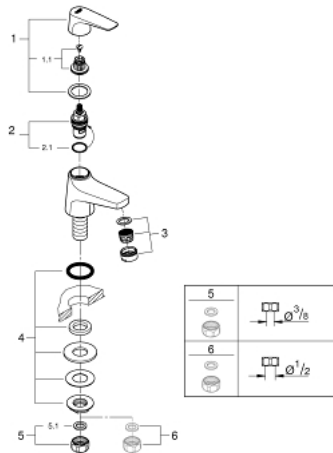

SPARE PARTS, May 2016 – now

- 1: Lever (Order-nr. 48030000)
- 2: Ceramic headpart, 1/2" (Order-nr. 45882000)
- 2.1: O-Ring $\varnothing 18,2 \times \varnothing 1,7$ (Order-nr. 0392400M)
- 3: Flow restrictor (Order-nr. 48159000)
- 4: Shank mounting kit (Order-nr. 45004000)
- 5: Coupling nut 1/2" x 10.5 mm (Order-nr. 1290100M)
- 5.1: Fibre seal dia. $\varnothing 18,5 \times \varnothing 12 \times 2$ (Order-nr. 0138900M)
- 6: Coupling nut 1/2" x 14.5 mm (Order-nr. 1290200M)*

* Optional accessories