

CM450F

COMPASS CLOAKROOM FLOOR MOUNTED UNIT

TAVISTOCK

INSTALLATION & AFTERCARE INSTRUCTIONS

Before You Start

It is recommended that the unit and basin are secured to a suitably reinforced wall to ensure stability. This can be done through the back rail. (Fixings not included).

Hinge Adjustment

The unit doors can be adjusted or removed if necessary. There are two adjustment screws on the hinges which make the adjustments shown in the image below. The quick release button on the back of the hinge can be used to remove the door completely.

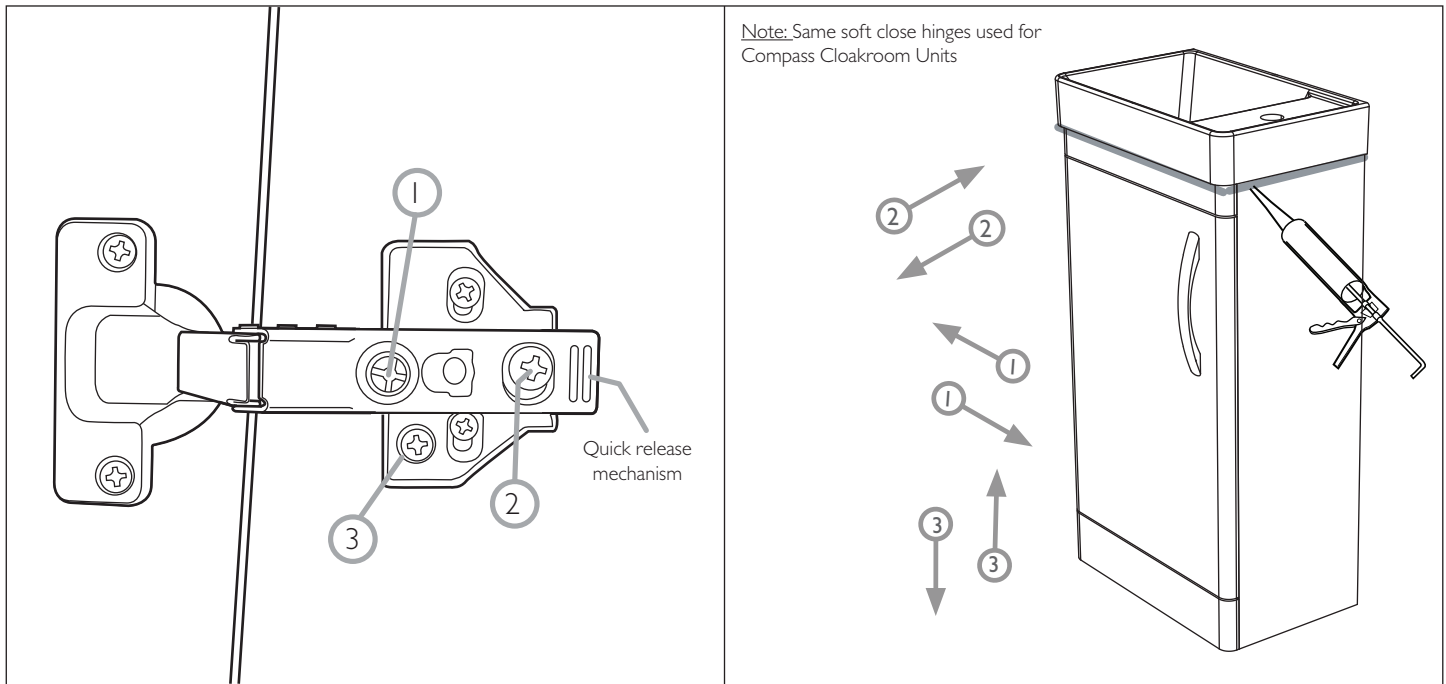

Fitting Handles

- A pilot hole located at the back of the door can be drilled if using a single screw knob.
- If you have chosen a pull handle with 2 screws then please pilot and then drill through the door with the handles in the desired location.
- Carefully drill any holes using a clamped block of wood to protect the front of door.
- The handles can simply be screwed into place using the screws supplied.
- If you choose third party handles please measure carefully before drilling.

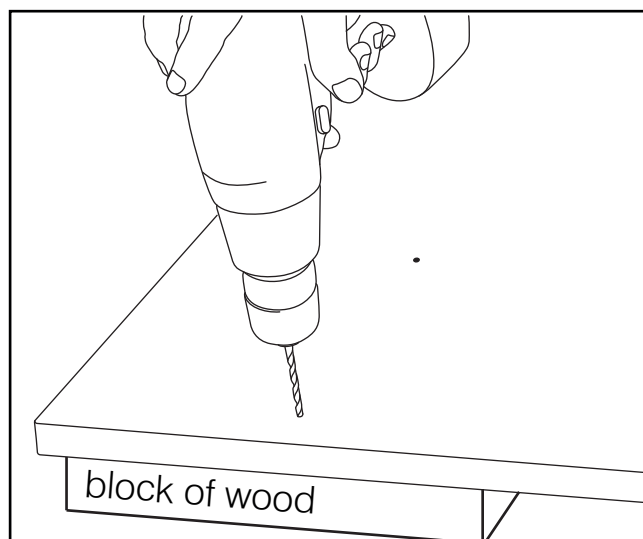

CM450F

COMPASS CLOAKROOM FLOOR MOUNTED UNIT

TAVISTOCK

FURNITURE AFTERCARE INSTRUCTIONS

As with all wooden furniture, this unit should be treated with care:

We recommend...



Wipe away any water splashes or condensation after use. Excessive exposure to water will deteriorate the furniture.

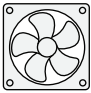

All bathrooms should be well ventilated with a suitable extractor fan.



Clean with a soft damp cloth only.



For removal of lime scale deposits use a suitable proprietary cleaner. If necessary test on an inconspicuous area first.

Please DO NOT...



Do not scrub or scour



Do not use abrasive cleaning agents

REPLACEMENT COMPONENTS

Should you require any replacement components for this product please contact Tavistock using the contact details below.