

Name	Memoria Illuminated Mirror Cabinet
Colour	Chestnut
Designer	Christophe Pillet
Assembly	Wall-Hung
Segments	Upper
Guarantee	2 Years
Lighting type	Sandblasted Led Lighting
Lighting	Yes
Finish-Body	Wood Veneer
Light Operation Type	Touch Sensor
Mounting	Fully Assembled
Width	150 cm
Depth	15 cm



Product Code: 56485

Description

150 cm, Chestnut, with Sliding Door

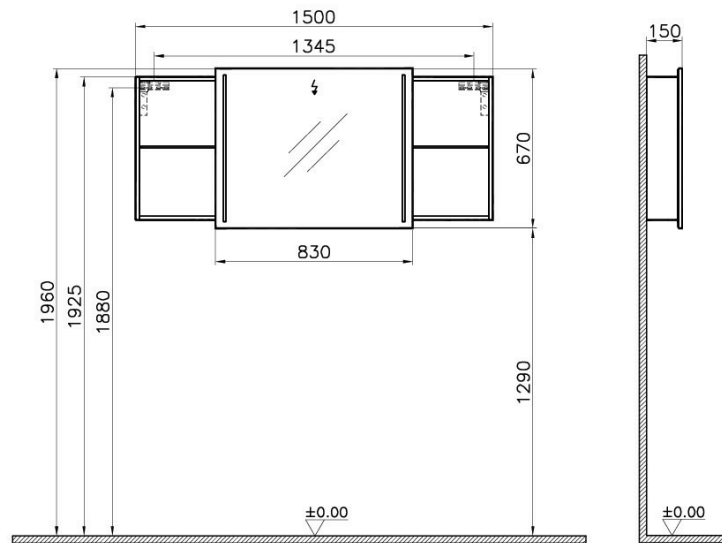

VitrA reserves the right to make changes in products and technical details without prior notice.

All drawings contain the necessary measurements which are subject to standard tolerances. For exact measurements, in particular for customized installation scenarios, it can only be taken from the finished ceramic product.