

GROHE RED MONO

Made in Germany

99.0830.031/ÄM 239072/06.17

www.grohe.com

Pure Freude an Wasser

GROHE

30 060

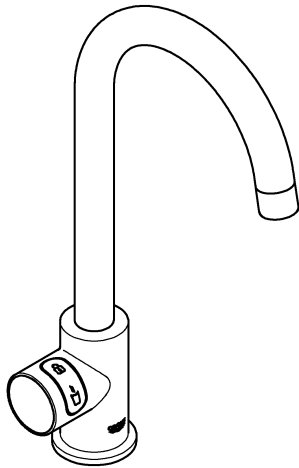

30 329

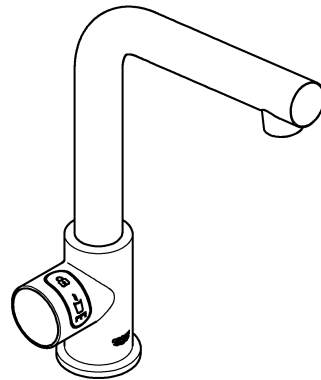

GB ..11

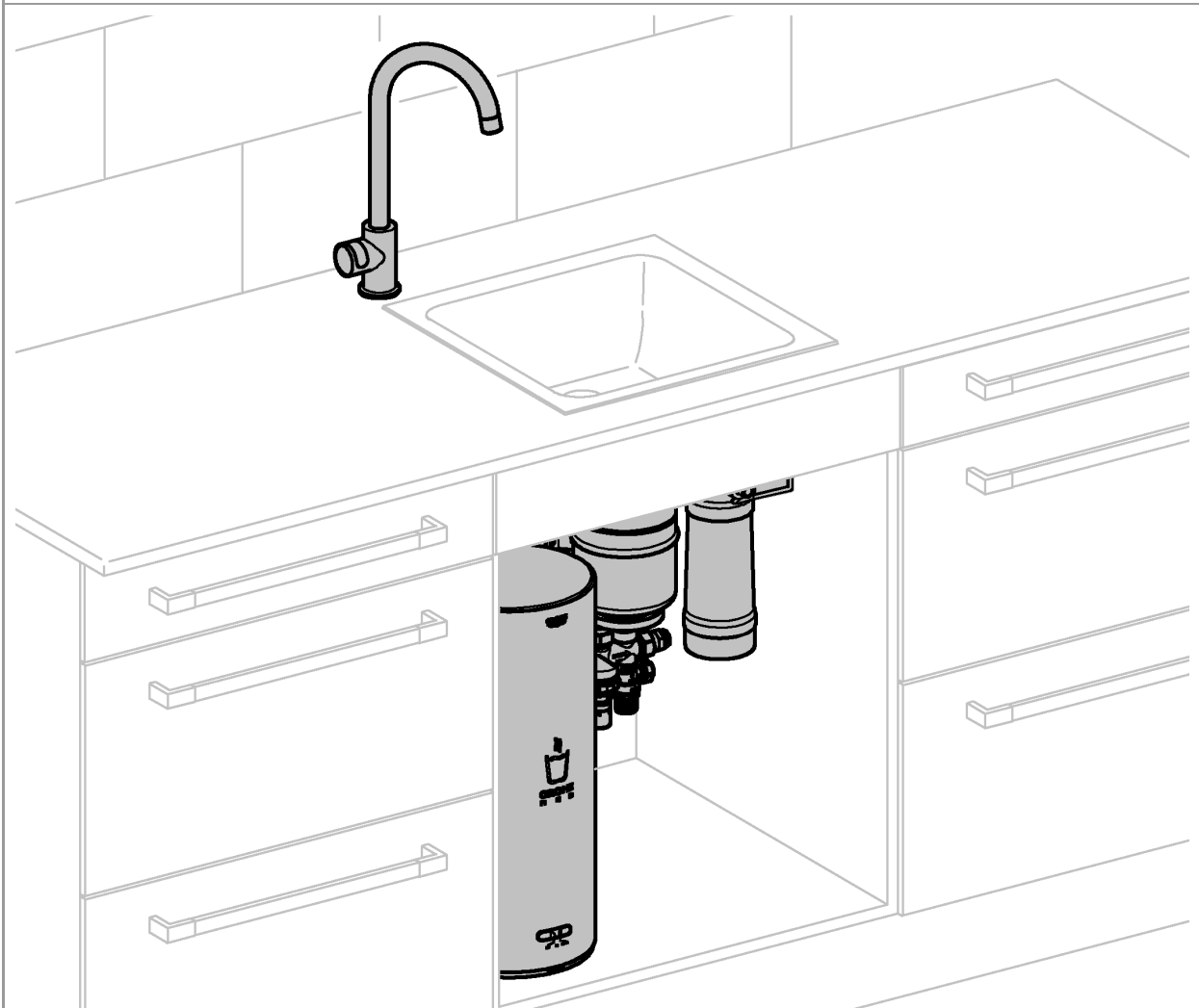

1



2



3 - 7

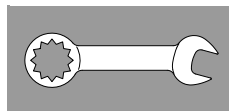

8



9



10

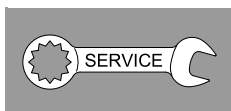

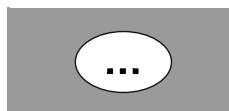

11 - 13



15

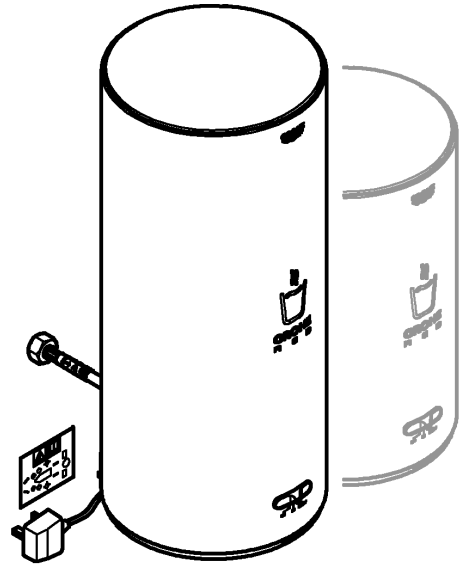
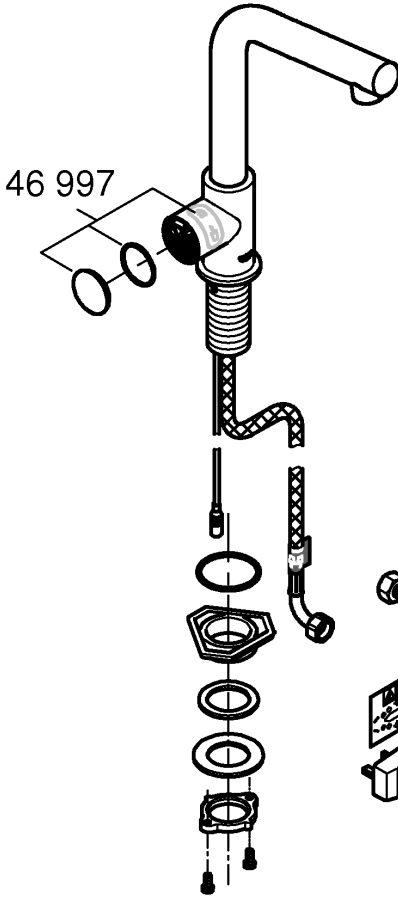
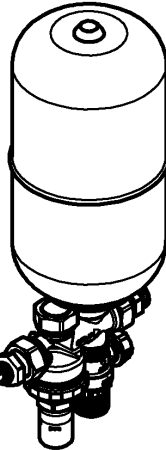
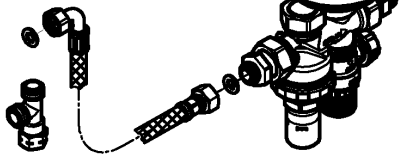
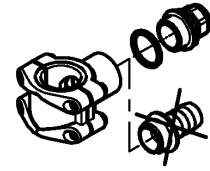
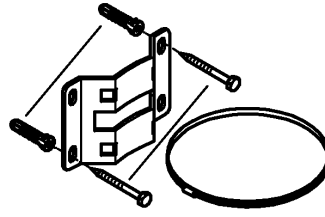
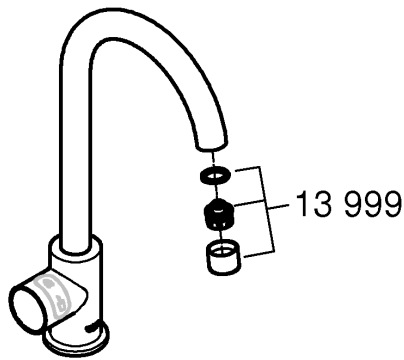



M		40 842
L		40 834

\*40 841

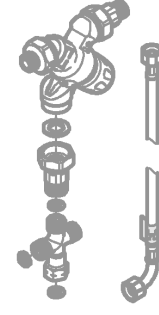

\*40 412 (L)

\*40 430 (M)

\*40 547 (AC)

\*40 575 (UltraSafe)

\*40 691 (Mg+)

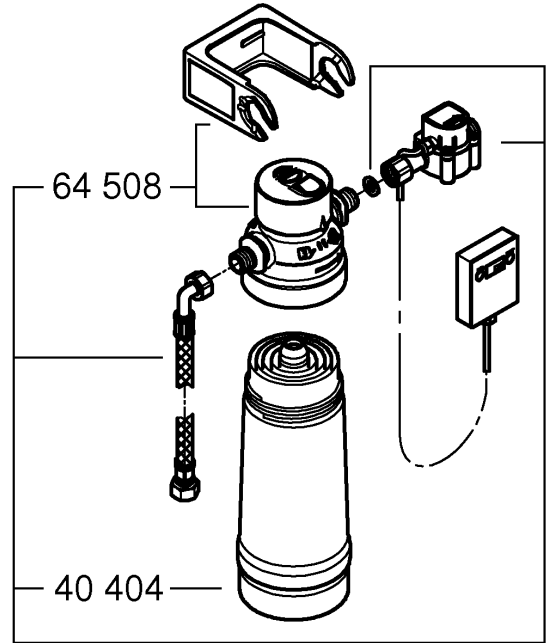

40 438

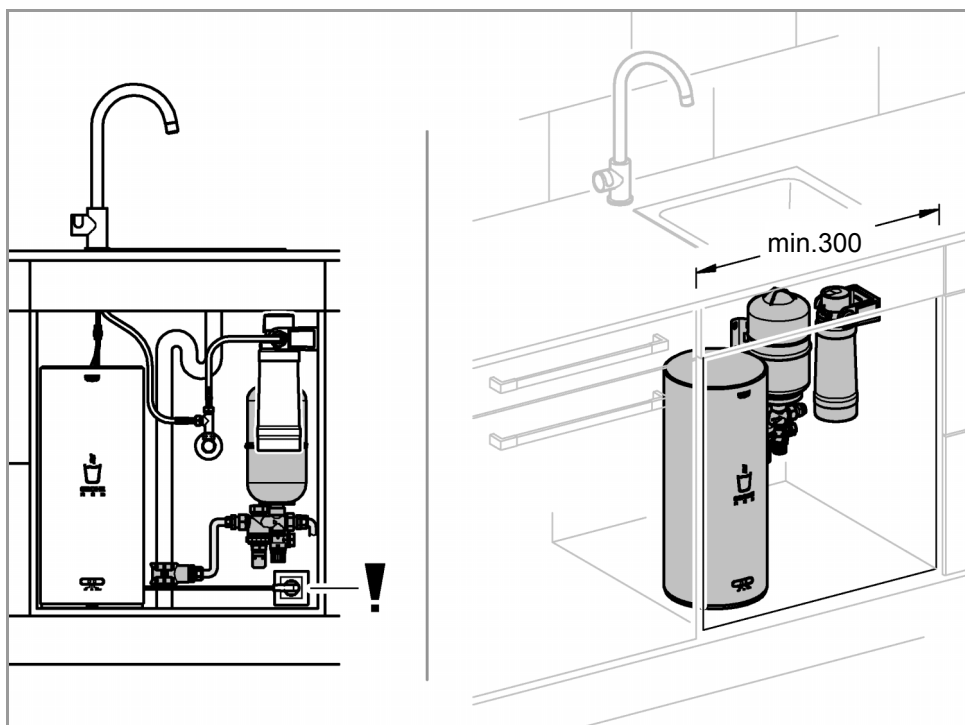
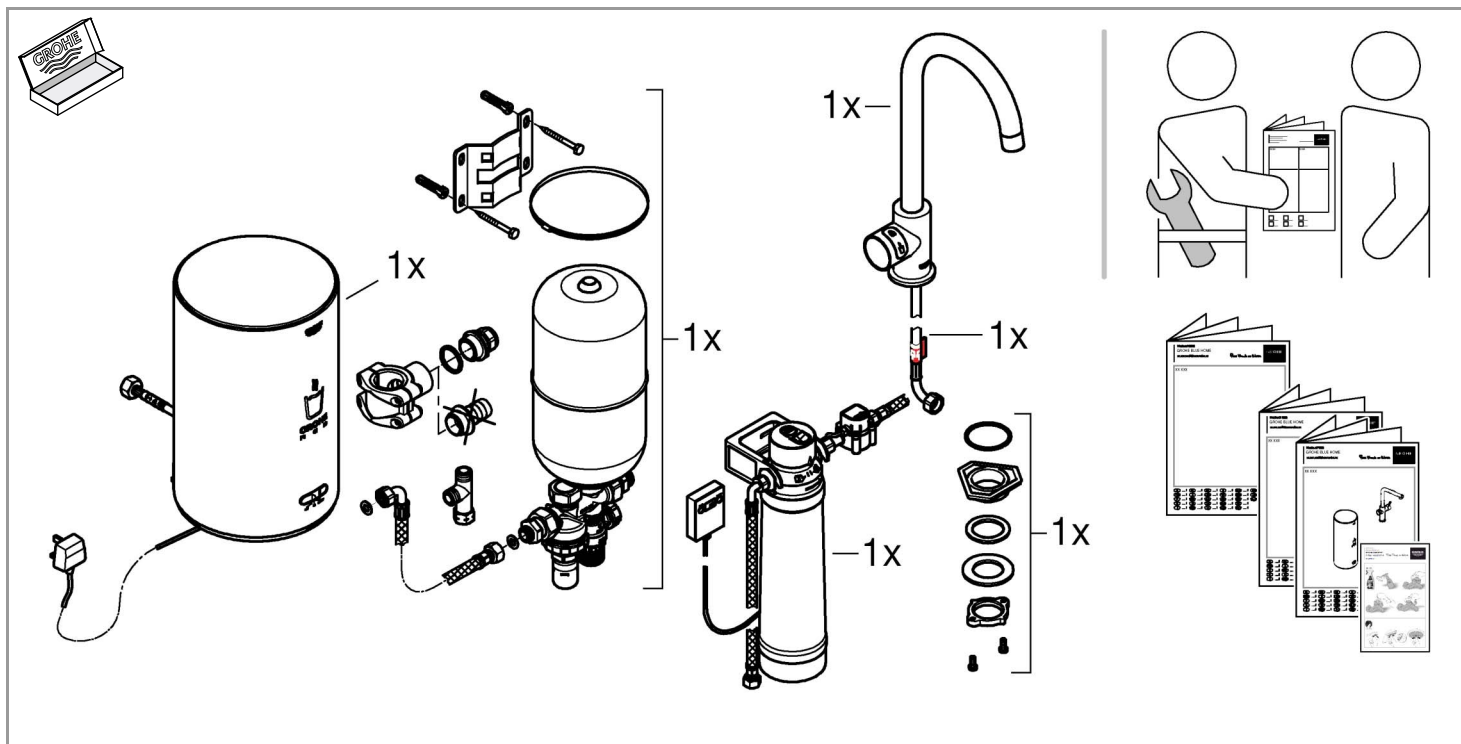

**GROHE**

Grohe AG  
Industriepark Edelburg  
58575, Germany

Grohe RED UK

■ L 1000 kPa  
230V~ 2200W  
IPx4

CE

~~WEEE symbol~~

Serialnr.

°KH	Filter class	Filter lifespan
< 7	3	3 months
7 - 24	2	6 months
> 25	1	12 months

Lokale Wasserhärte (°KH) ermitteln.  
Determine local water hardness (°KH).  
Déterminer la dureté de l'eau locale (°KH).

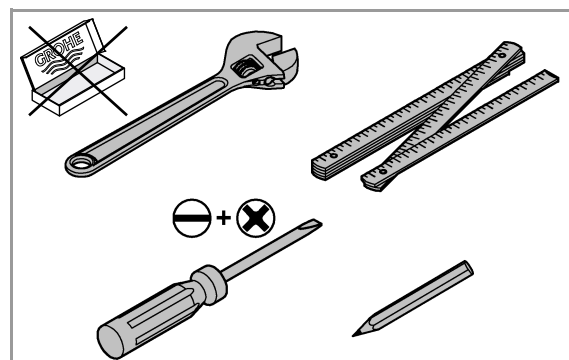

**GROHE** Deutschland Vertriebs GmbH  
Zur Porta 9  
D-32457 Porta Westfalica

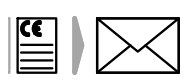

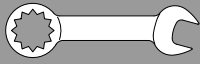

1

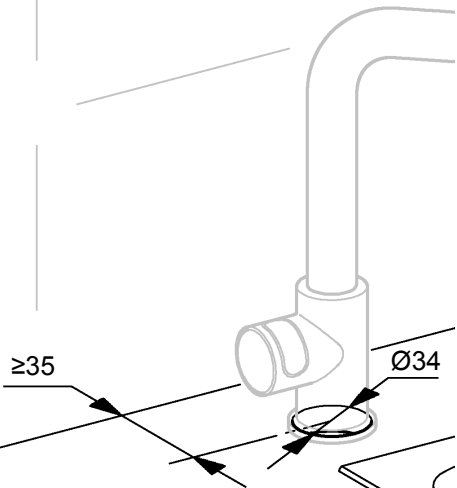

2

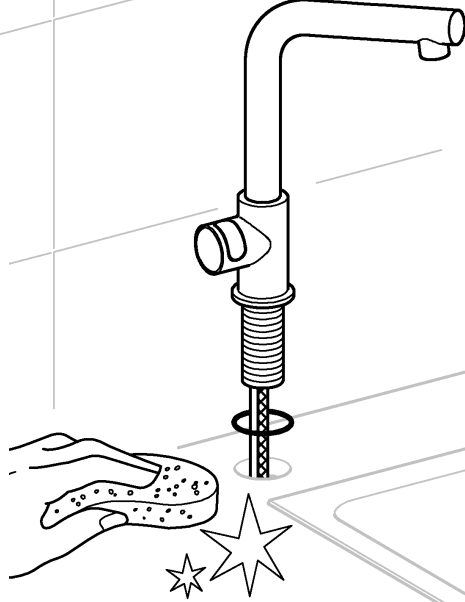

3

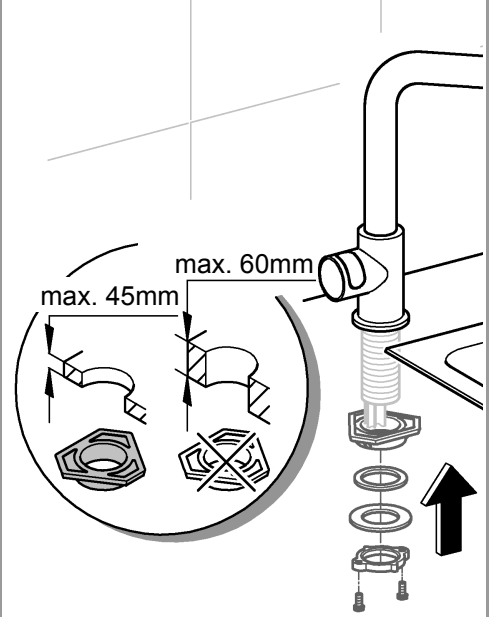

4a

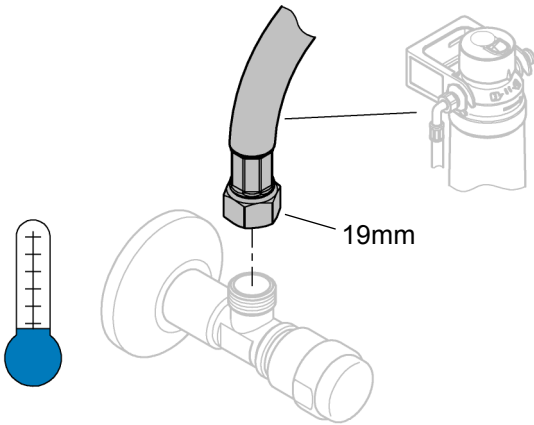
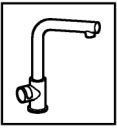

4b

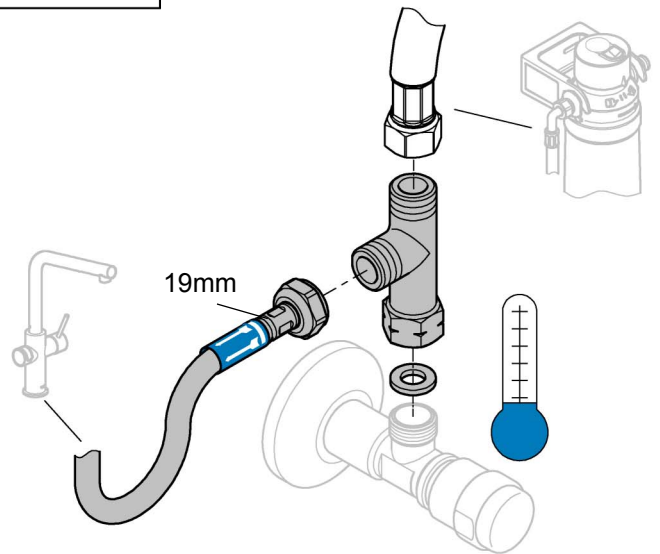
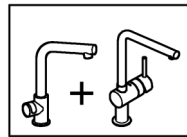

!

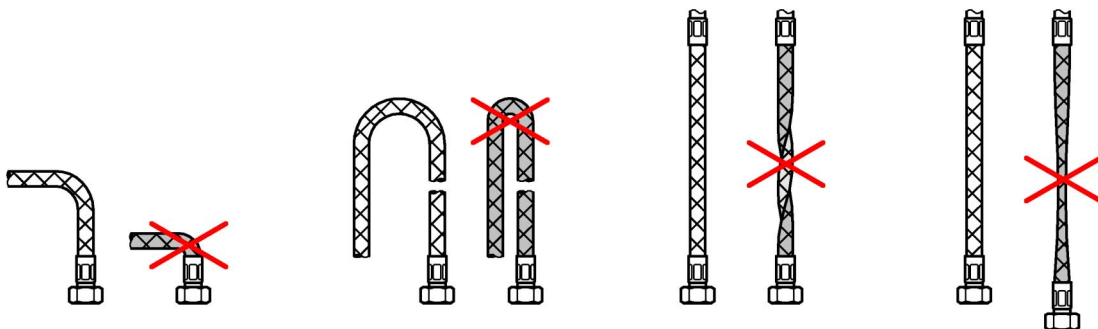

5

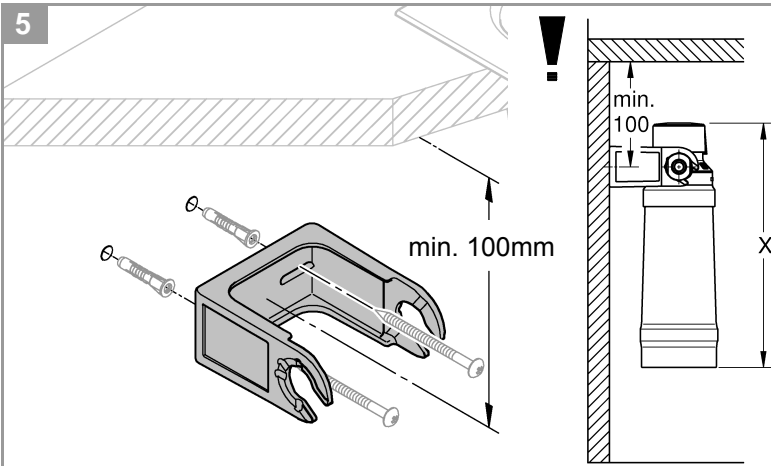

	X
40 404 S	350 13 <sup>3</sup> / <sub>4</sub> "
40 430 M	410 16 <sup>1</sup> / <sub>8</sub> "
40 412 L	465 18 <sup>5</sup> / <sub>16</sub> "
40 547 Ac	270 10 <sup>5</sup> / <sub>8</sub> "
40 575 UltraSafe	350 13 <sup>3</sup> / <sub>4</sub> "
40 691 Mg+	350 13 <sup>3</sup> / <sub>4</sub> "

6

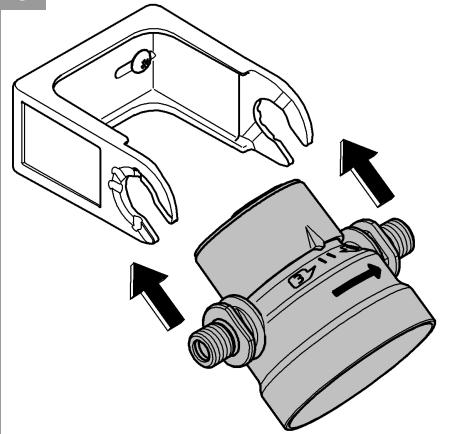

7

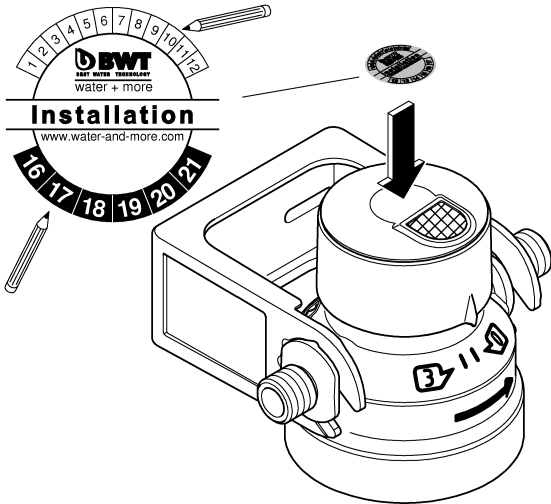

8

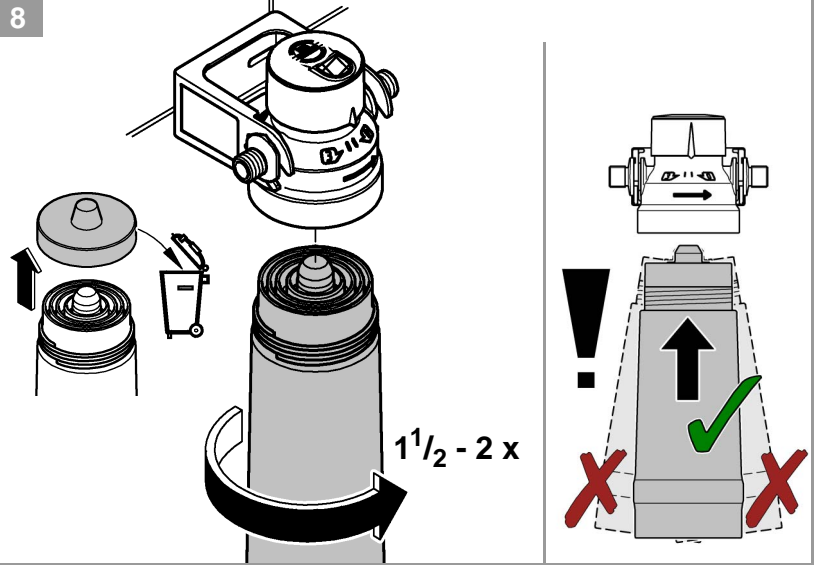

9

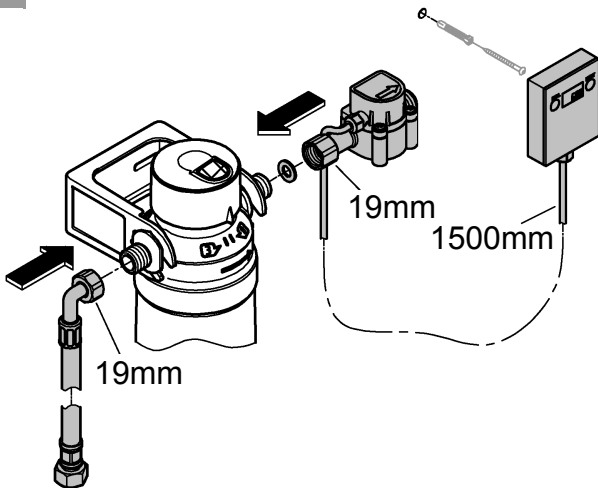

10

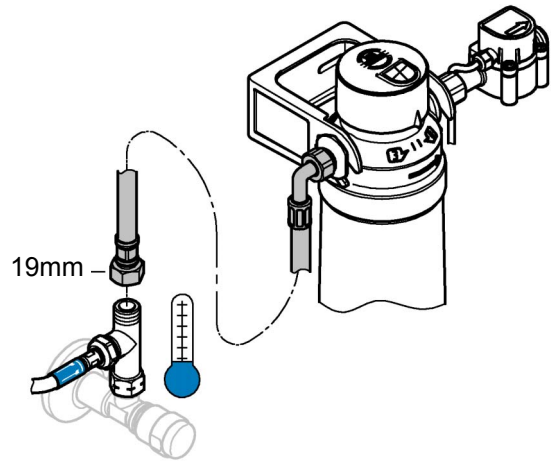

11

Lokale Wasserhärte (°KH) einstellen.  
Adjust local water hardness (°KH).  
Régler la dureté de l'eau locale (°KH).

°KH



°KH	Filter Cartridge
< 7	3
7 - 24	2
> 25	1

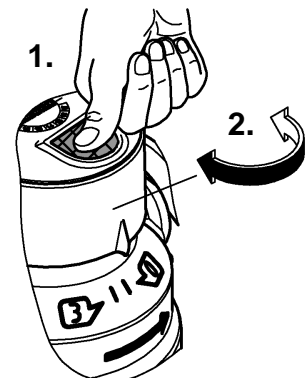

12

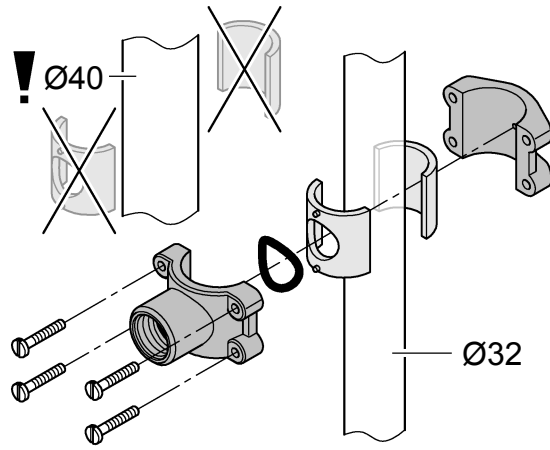
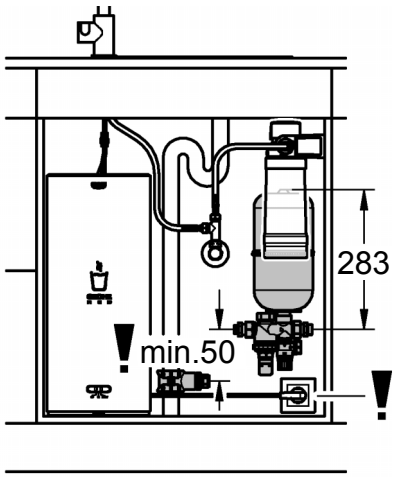

13

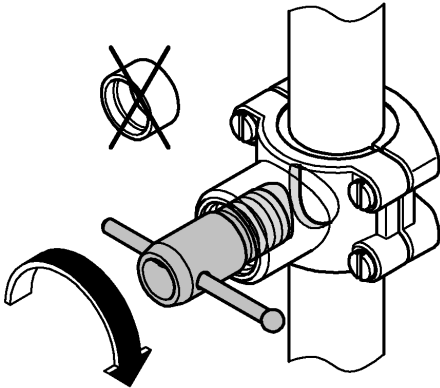

14

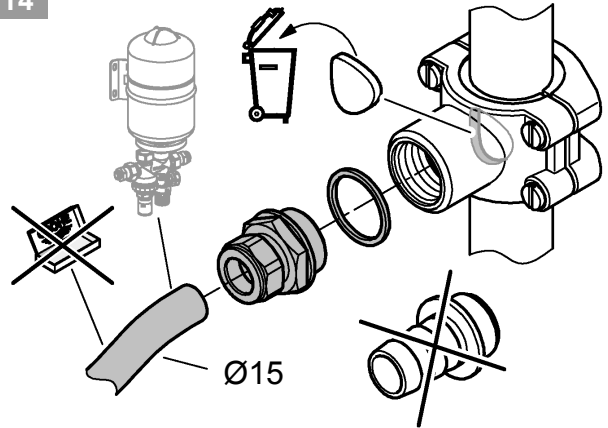

15

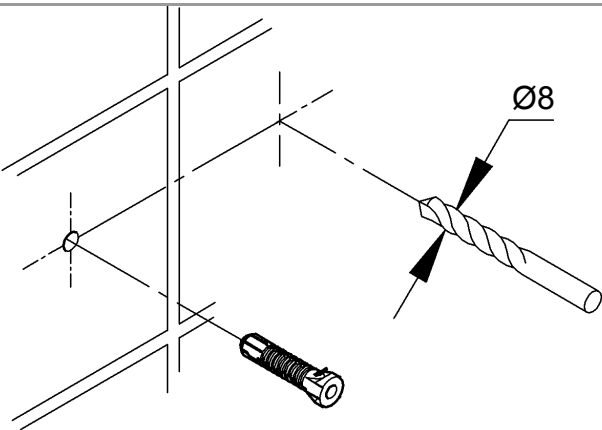

16

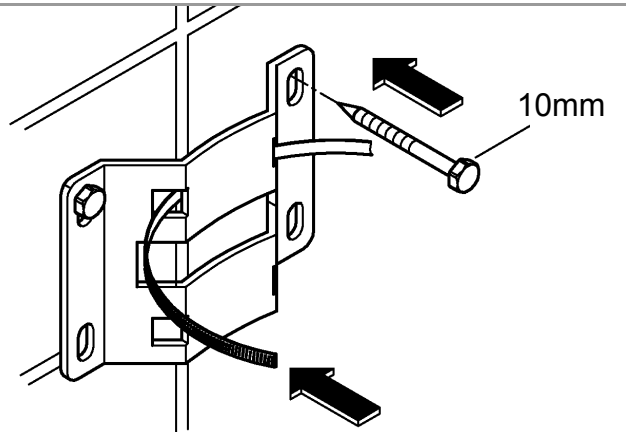

17

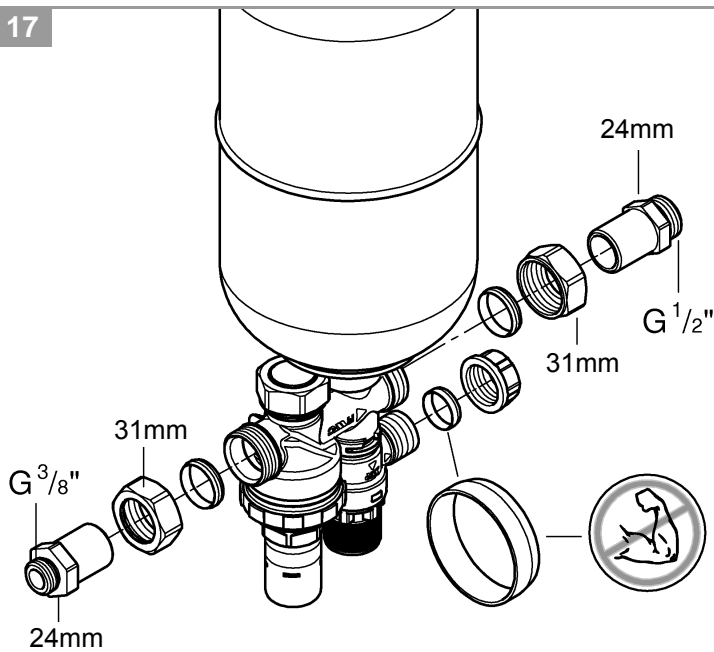

18

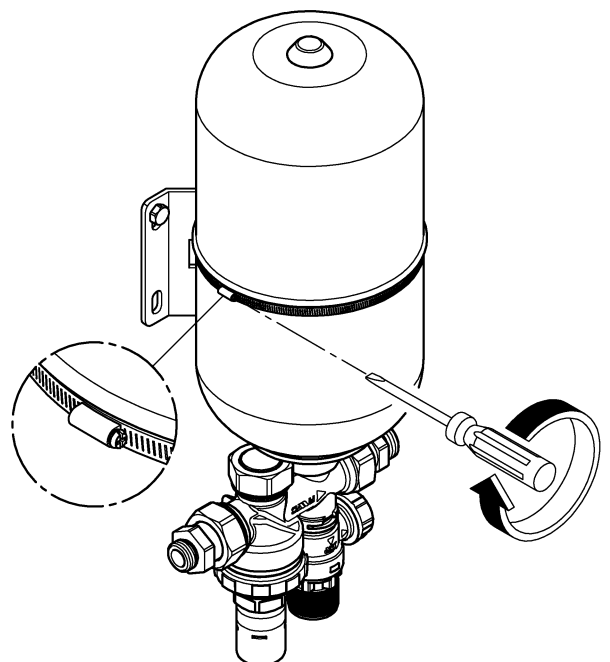

19

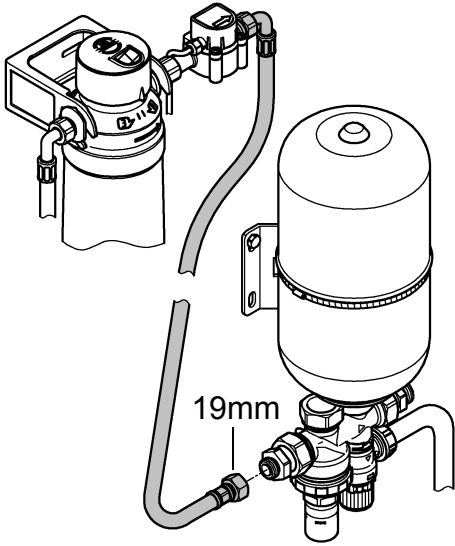

20

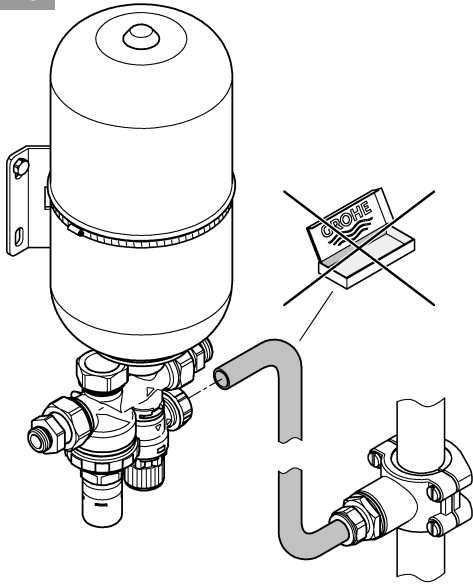

21

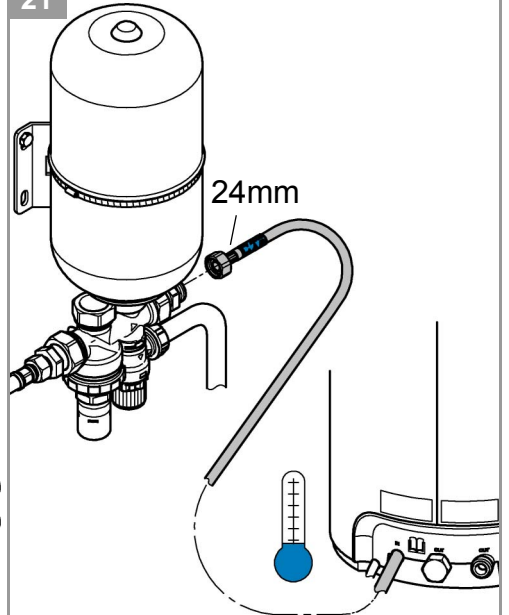

22

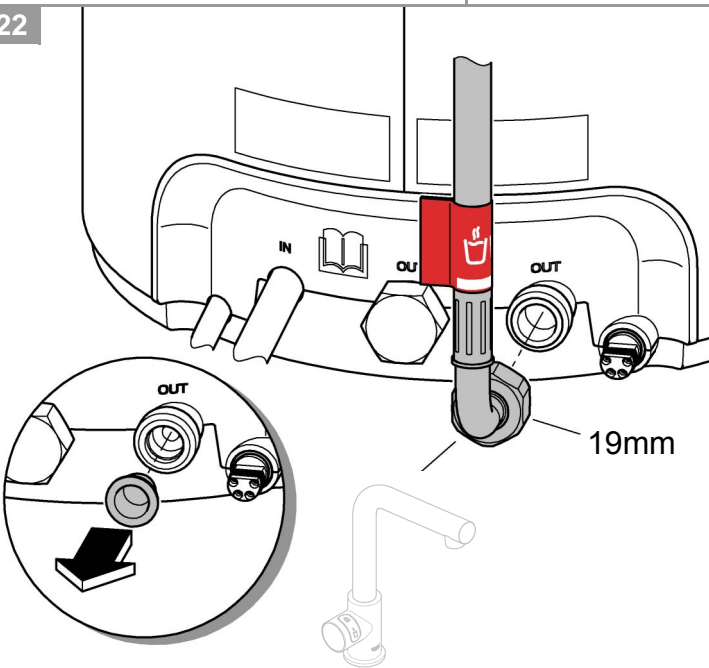

23

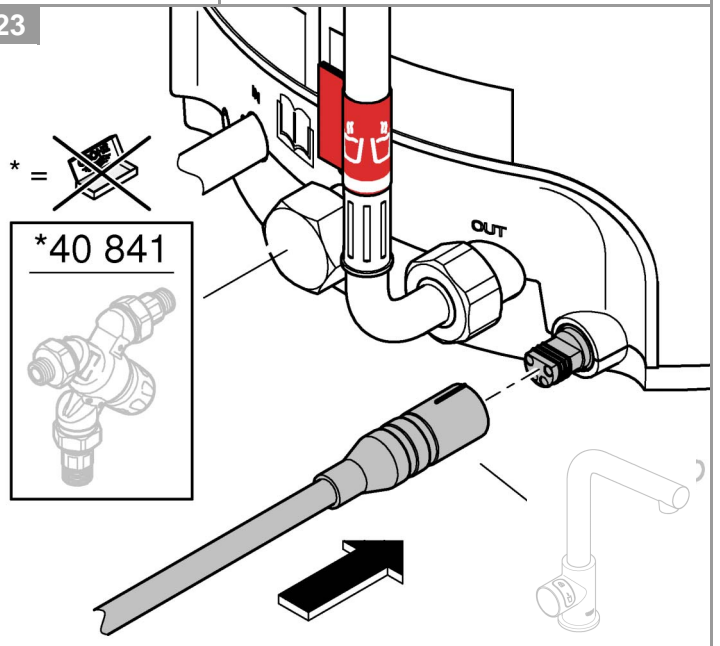

24

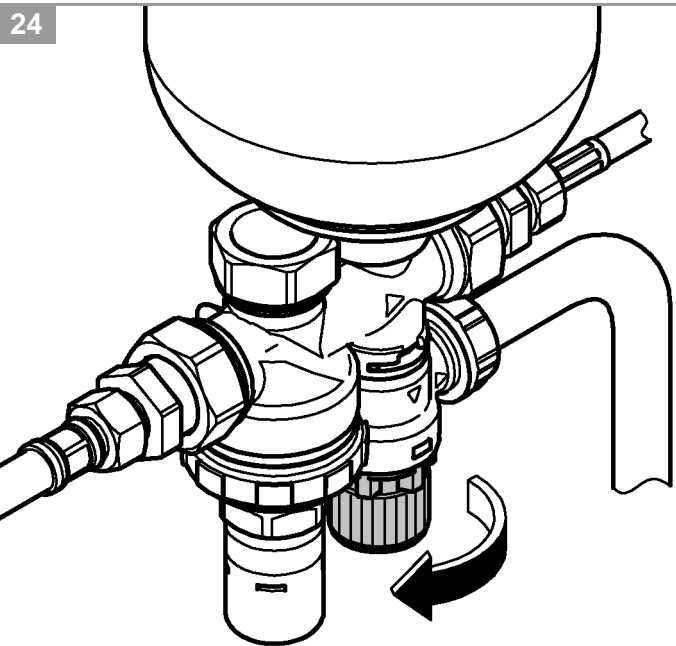

25

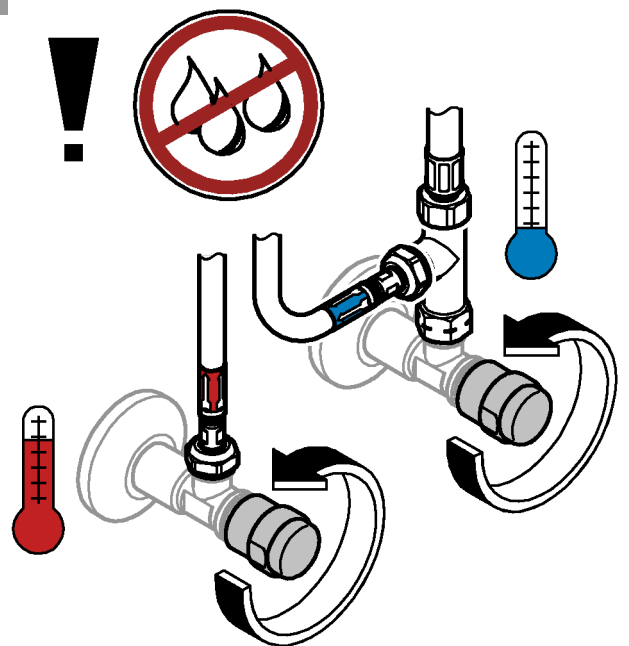

26

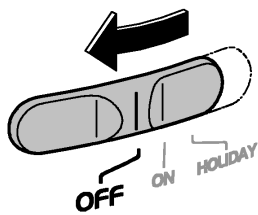

27

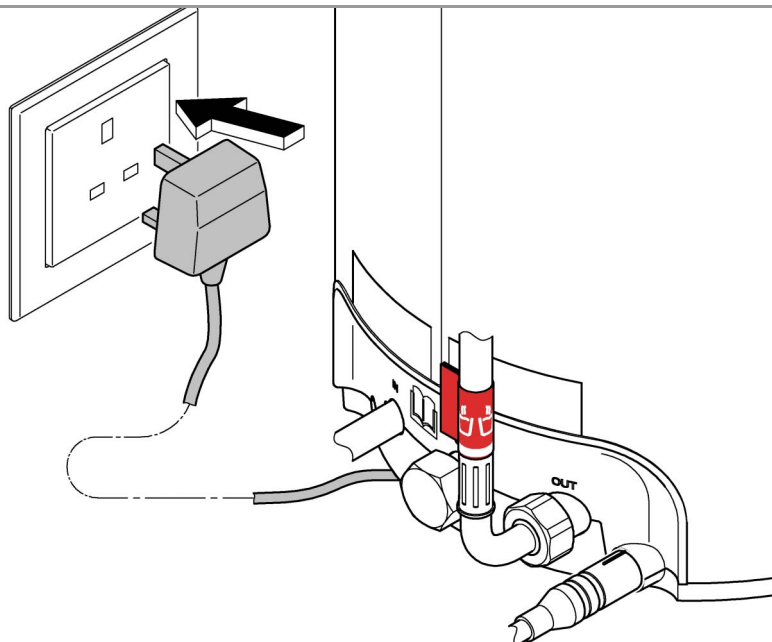

28

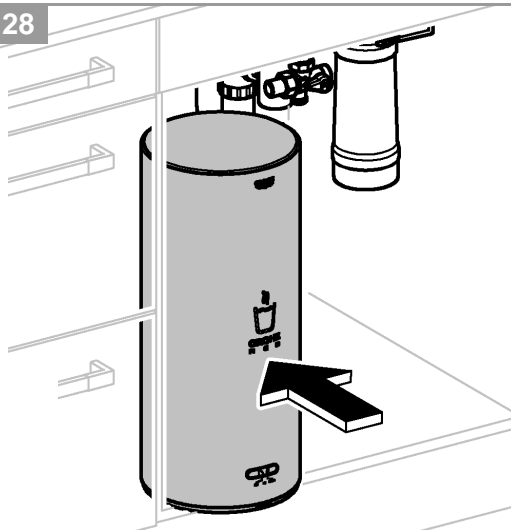

29

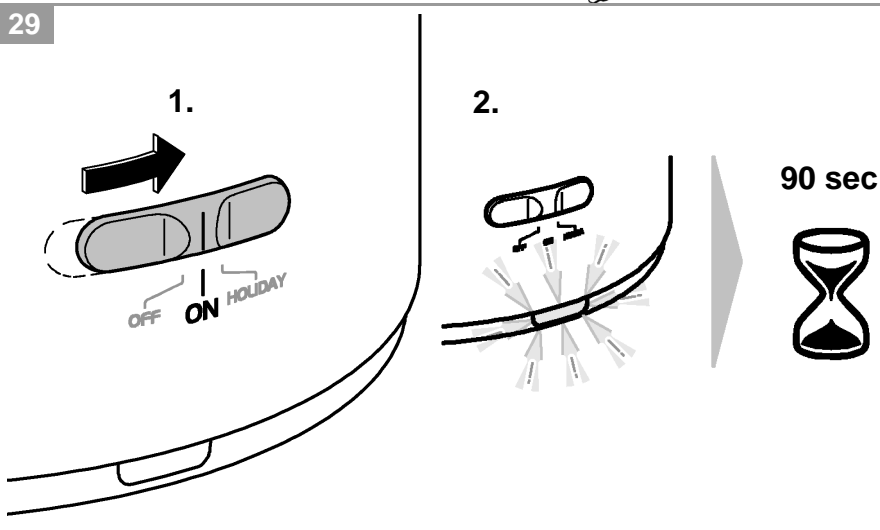

30

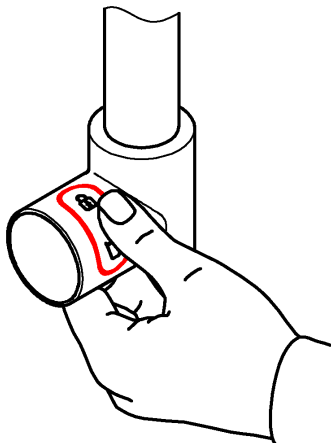

1.

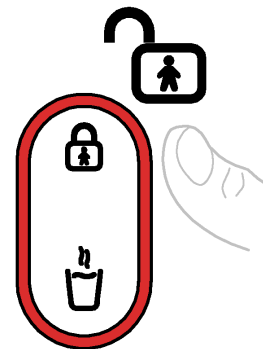
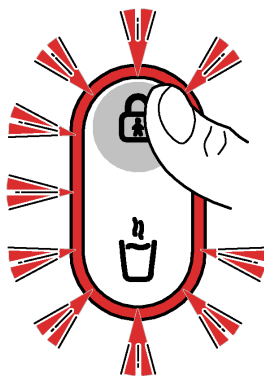
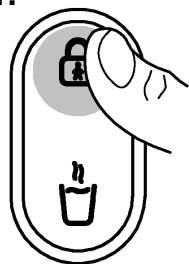

Press and hold.



Press repeatedly.



Let go.

2.







°KH	Filter Capacity					
	S-Size	M-Size	L-Size	Ac	UltraSafe	Mg+
	40404001	40430001	40412001	40547001	40575001	40691001
< 7	<b>2000</b>	<b>5000</b>	<b>7600</b>	<b>3000</b>	<b>3000</b>	<b>1600</b>
7 - 9	<b>1600</b>	<b>4000</b>	<b>6500</b>	-	-	<b>1200</b>
10 - 12	<b>1000</b>	<b>2500</b>	<b>4000</b>	-	-	<b>700</b>
13 - 16	<b>800</b>	<b>2000</b>	<b>3200</b>	-	-	<b>500</b>
17 - 20	<b>600</b>	<b>1500</b>	<b>2500</b>	-	-	<b>400</b>
21 - 24	<b>500</b>	<b>1300</b>	<b>2000</b>	-	-	<b>300</b>
25 - 28	<b>400</b>	<b>1000</b>	<b>1500</b>	-	-	<b>200</b>
29 - 32	<b>300</b>	<b>800</b>	<b>1200</b>	-	-	<b>100</b>
> 32	<b>200</b>	<b>650</b>	<b>1000</b>	-	-	

Setting the litre specification.



Press and hold.



Press repeatedly.



Let go.

Filter Capacity

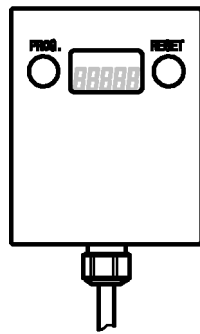
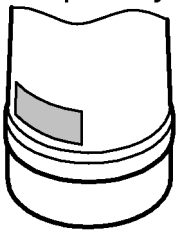

1

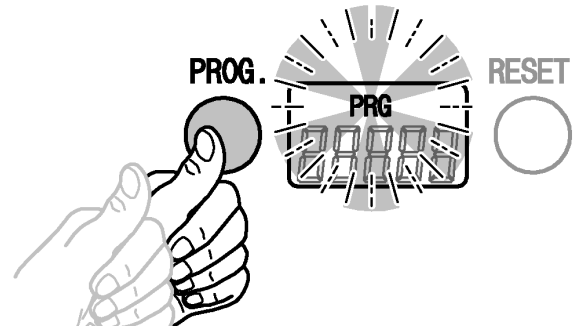

2

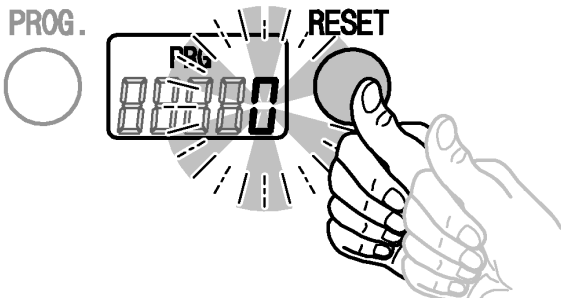

3

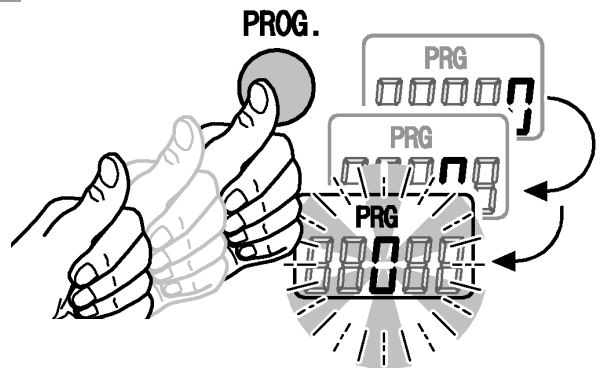

4

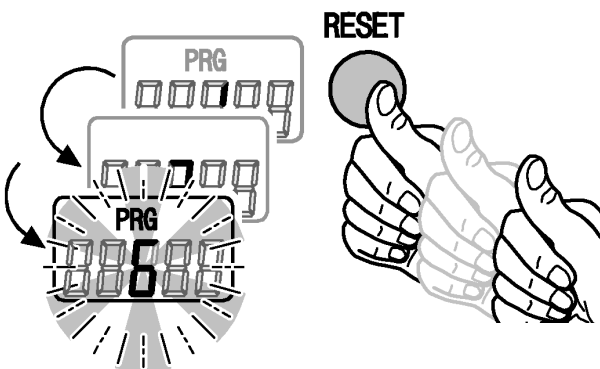

5

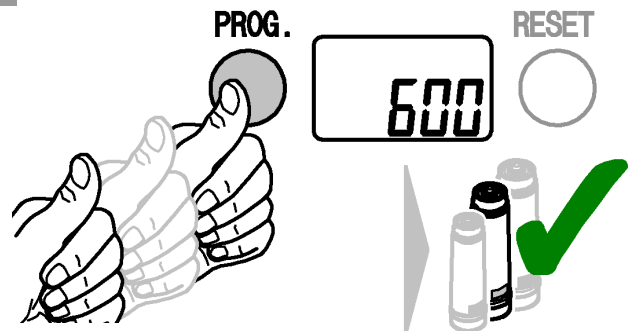



A

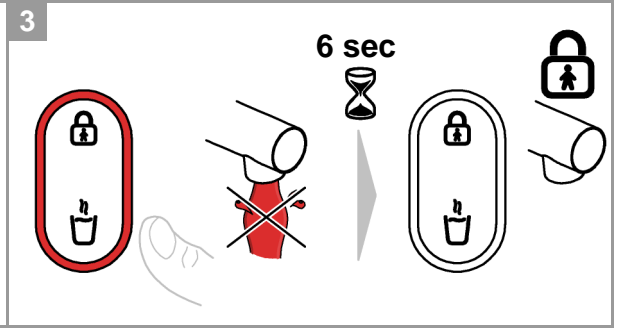
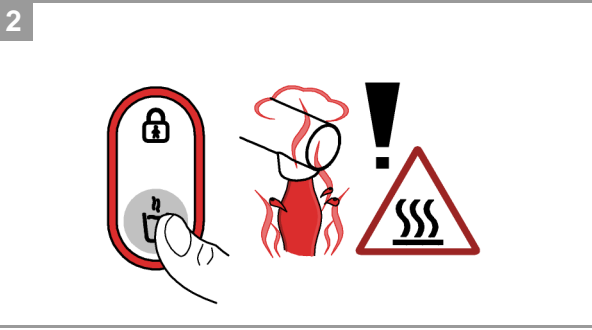
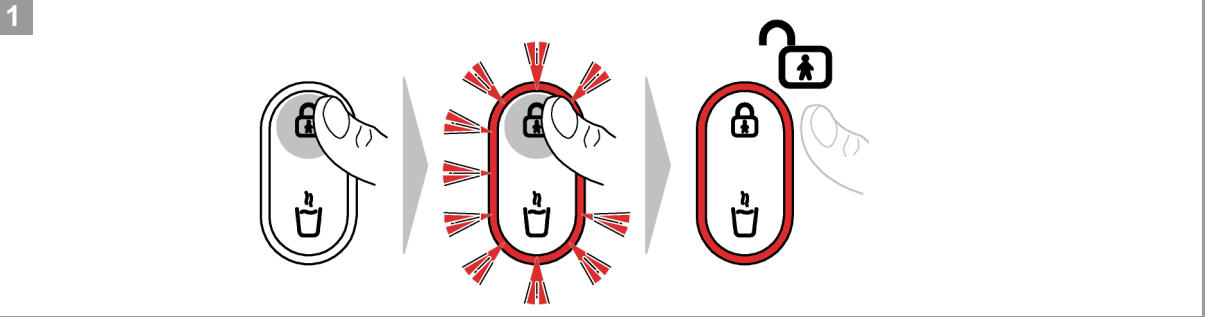

B

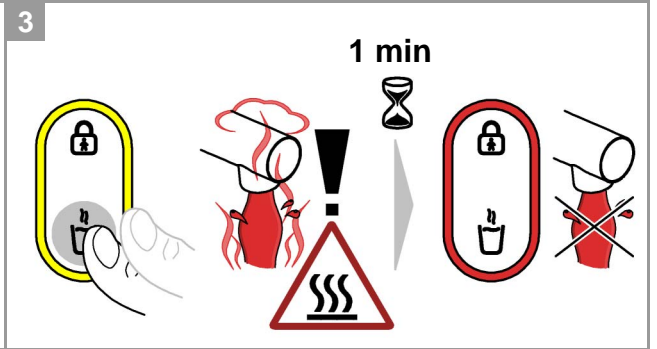
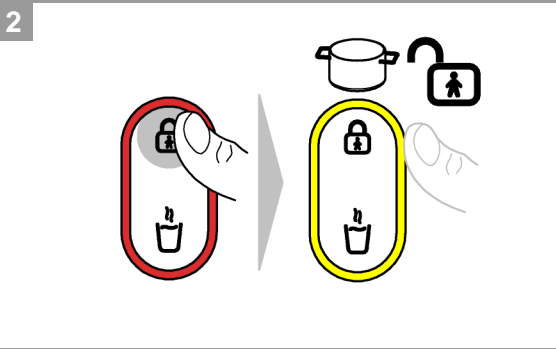
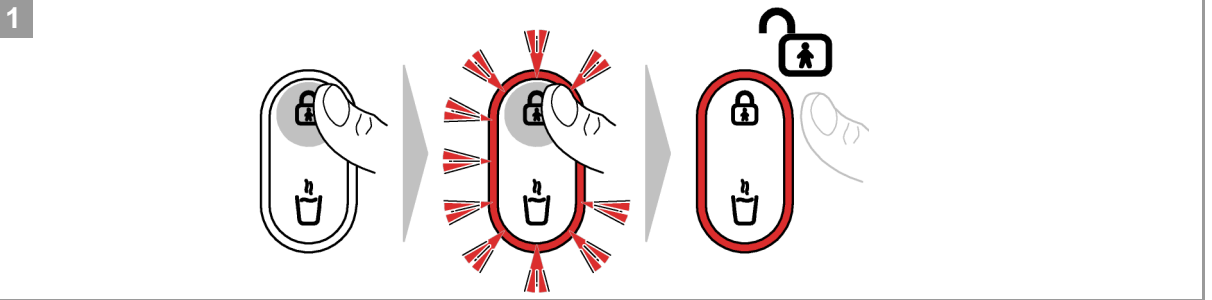

C

HOLIDAY

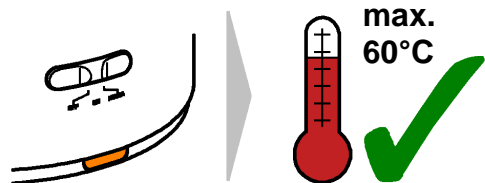
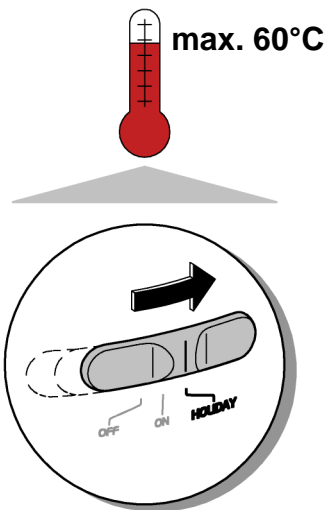
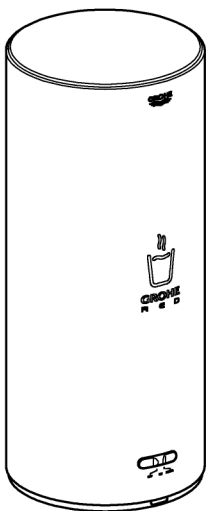

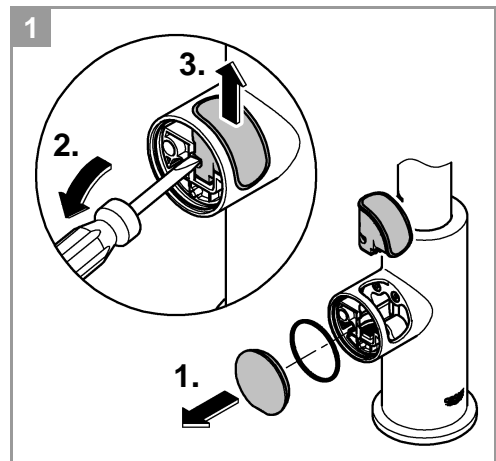
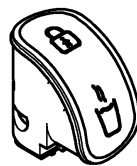
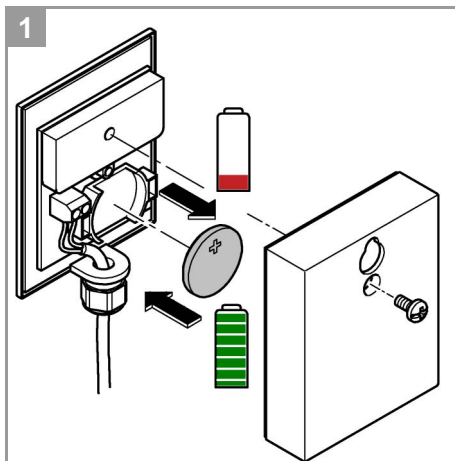
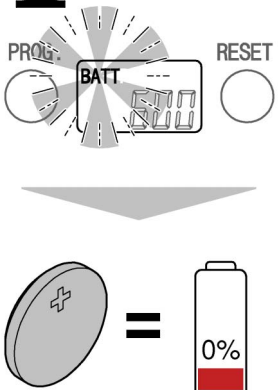
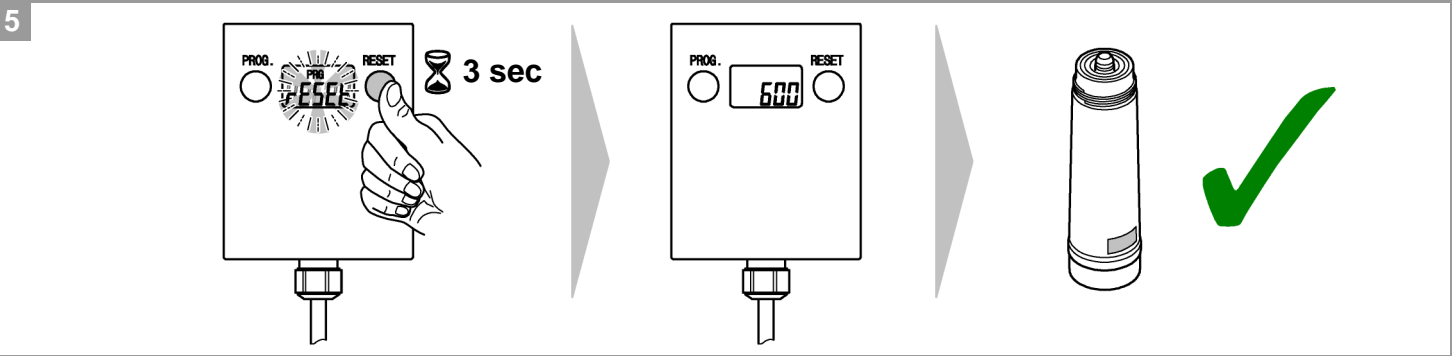
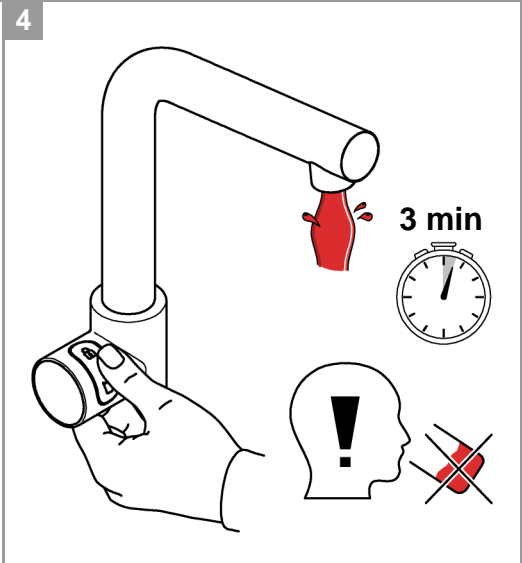
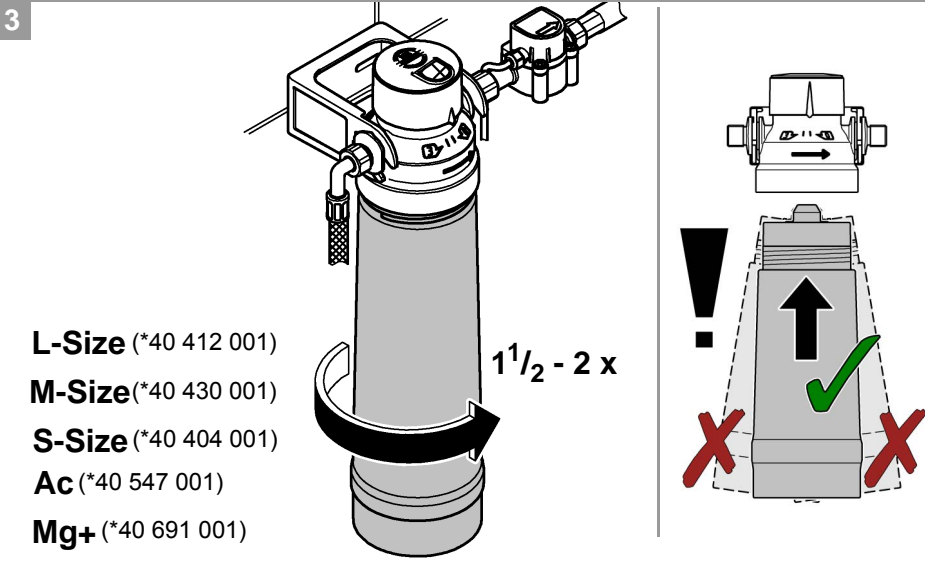
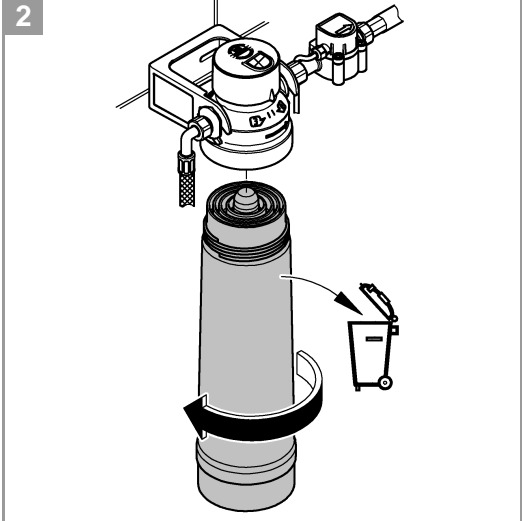
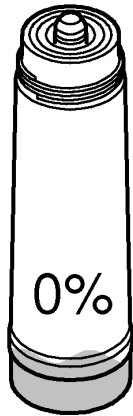

## Safety notes



This device may be used by **children** over 8 years of age, as well as persons with physical, sensory, or mental disabilities or inadequate experience and knowledge, if they are under supervision or were instructed in the safe use of the device and understand the resulting risks.

**Children must not** play with the device. Cleaning and **user maintenance must not** be carried out by **children** without supervision.

Prevent danger resulting from damaged power supply cables. In the case of damage, the mains cable **must** be replaced by the manufacturer or his customer service department, or an equally qualified person.



**Caution, risk of scalding!** Escaping water is boiling hot. **Never touch the end of the spout** in order to swivel the spout as it becomes extremely hot.

- The enclosed mains cable and a standard IEC connector box according to IEC 60320-C13 is to be connected exclusively to a hedged with at least 10A and FI protection switch appropriate electrical outlet. The connector must be freely accessible after installation.
- The boiling water storage heater **must** be connected to a permanent power supply.
- Installation of the fitting and boiling water storage heater with filter cartridge **is only permitted** in frost-free rooms.
- The boiling water storage heater is **only** suitable for indoor use.
- The boiling water storage heater **must** be placed in an upright position.
- Place the boiler on a hard, smooth and flat surface.
- Do not place the boiler in a tub or similar.
- During cleaning, do **not** spray the boiling water storage heater or the plug directly or indirectly with water.
- The boiling water storage heater **must not** be opened.
- Use **only genuine replacement parts and accessories**. The use of other parts will result in voiding of the warranty and the CE identification, and could lead to injuries.
- Do not operate a damaged device.
- The filter head **must** be replaced after 5 years by the **GROHE service**.
- Extension cables are **not** permitted between the electrical socket and boiling water storage heater connection.
- The boiling water storage heater **must** be operated with the supplied safety unit.
- The boiling water storage heater may only be operated with a GROHE Red faucet.
- If the operating pressure is not sufficient, the boiling water storage heater must be switched off.
- For transport the boiling water storage heater **must** be drained. For this, the safety unit must be disconnected from the storage heater. **Caution, risk of scalding!** Escaping water is boiling hot.

### Technical data boiling water storage heater:

- Connection: Wall socket with earth wire, protected via a 10 A fuse
- Installation high: max. 2000m above sea level
- Voltage supply: 230 V AC / 50 Hz
- Power consumption: 2200 W
- Type of protection: IP X4
- Relative humidity: max. 95%
- Standby power loss (switched on): M: 14 W  
L: 15,7 W
- Standby power loss (switched off): 1 W

### Sanitary data boiling water storage heater, fitting:

- Boiling water storage heater capacity: M: 4 l  
L: 7 l
- Available storage heater volume at 99 °C: M: approx 3 l  
L: approx 5.5 l
- Flow pressure:
  - min. 0.1 MPa
  - recommended 0.1 – 0.5 MPa
- Operating pressure: max. 0.2 – 0.8 MPa
- Test pressure: 1.6 MPa
- Flow rate at 0.3 MPa flow pressure
  - Mixed water: approx. 6 l/min
  - Boiling water: approx. 3 l/min
- Ambient temperature: 0 °C – 40 °C
- Boiling water temperature 99 °C  
The actual temperature may differ slightly due to different ambient pressures
- Heating time from 10 °C to 99 °C: M: approx. 20 min  
L: approx. 30 min
- Water connection at storage heater: Cold water
- Water connection at fitting: Cold water from service valve  
Boiling water from storage heater

In regions with a carbonate hardness above 10 °KH a filter system with ion exchanger **must** be used (S, M, L or MG+ filter)

The relevant water supplier can provide information on the water hardness.

**Thermal disinfection of the fitting is possible.**

### Signalisations

Status	Storage heater-LED	Fitting-LED
Initialisation	white, permanent	-
Boiler heating up	red, flashing	-
Ready for use	red, permanent	-
Holiday mode cooling down	orange, flashing	-
Holiday mode	orange, permanent	-
Child-lock deactivation process	-	red, flashing
Child-lock deactivated	-	red, permanent
Pot filler deactivation process	-	yellow, flashing
Pot filler	-	yellow, permanent
Error	purple, flashing/permanent	purple, flashing/permanent

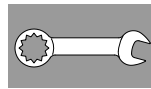

### Installation and commissioning

**Flush pipes thoroughly before and after installation** (observe EN 806).

If only a cold water service valve is available you need the mixing device 40 841 001 to generate warm tap water.

Check all connection systems for leakage and retighten if necessary.

**Adjust bypass of filterhead according to local carbonate hardness and connect filter cartridge.**

The carbonate hardness can be tested by using the enclosed test strip or the relevant water supplier can provide information on the carbonate hardness.

#### Important note

**The volume of water in the storage heater will expand as it is heated. The expansion water must drip out at funnel of safety assembly.**

**This process is necessary and normal.**

#### Control:

The cooler/carbonator is set for operation with the S-Size filter cartridge (Prod no.: 40 404 001) at the factory.

For operation with other filter cartridges the cooler/carbonator must be switched over, see also page 8.

Button		Display
PROG. 	Briefly press <b>PROG</b> button ( <b>PRG</b> flashes)	
RESET 	Briefly press <b>RESET</b> button to access programming for litre specification (00000)	
PROG. 	Keep pressing <b>PROG</b> button until required position is reached (00000 digit flashes)	
RESET 	Keep pressing <b>RESET</b> button until required digit is reached (00600 digit flashes)	
PROG. 	Keep pressing <b>PROG</b> button to exit menu ( <b>PRG</b> disappears and set value appears)	



### Operation, see page 9.

Unlock the child safety device to get boiling water, see **A**.

Key combination for filling pots with boiling water, see **B**.

To get cold or hot water, see **C**.

Activation of the holiday mode, see **D**.

#### Note:

In order to prevent incorrect operation and for protection against injury, we recommend affixing the sticker provided.



## Maintenance and Cleaning

### Important! Risk of damage!

- Always disconnect the power supply before carrying out maintenance work on the system. The plug-in connector can then be disconnected.

### In the case of interventions in the mains supply or maintenance work, the GROHE Red boiling system must be bled as steam jets could otherwise occur.

Close the service valve, switch off the storage heater and disconnect the mains plug.

Wait until the storage heater and the fitting have cooled down. Open the lever to depressurise the storage heater.

Inspect and clean all parts, replace as necessary and lubricate with special grease.

### Empty the storage heater:

- Wait until the storage heater and the fitting have cooled down
- Open the lever of the fitting and the rotary knob on the safety unit to depressurise the storage heater
- Remove the cap, or the hose to the mixing valve and drain the storage heater via the connecting hose to the safety unit



## Service

Fault ?	Cause !	Remedy ✓
<b>Water not flowing</b> <b>Handle flashes once purple</b>	<ul style="list-style-type: none"> <li>Filter not installed correctly</li> <li>Hoses kinked</li> <li>Water supply interrupted</li> </ul>	<ul style="list-style-type: none"> <li>Insert filter straight (1½ - 2 turns)</li> <li>Check hoses for kinks</li> <li>Open fully shut-off valves</li> </ul>
<b>Handle is permanently purple</b>	<ul style="list-style-type: none"> <li>System error</li> </ul>	<ul style="list-style-type: none"> <li>Contact GROHE customer service</li> </ul>

The GROHE boiling water storage heater may only be repaired by GROHE Service.

### Environment and recycling

For reasons of hygiene, it is not possible to recycle used filter cartridges.

Used filter cartridges can be disposed of hazard-free as residual waste.

The boiling water storage heater is an electrical device, to which return and take-back obligations apply in many countries. GROHE participates in such take-back systems in all relevant countries.



This category of device does **not** belong in the domestic waste, but **must** be disposed of separately in accordance with the relevant local national regulations.



A series of 25 horizontal lines spaced evenly down the page, providing a template for handwriting practice.

Pure Freude an Wasser

**GROHE**  
WAVES

**D**  
& +49 571 3989 333  
impressum@grohe.de

**A**  
& +43 1 68060  
info-at@grohe.com

**AUS**  
**Argent Sydney**  
& +(02) 8394 5800  
**Argent Melbourne**  
& +(03) 9682 1231

**B**  
& +32 16 230660  
info.be@grohe.com

**BG**  
& +359 2 9719959  
grohe-bulgaria@grohe.com

**CAU**  
& +99 412 497 09 74  
info-az@grohe.com

**CDN**  
& +1 888 6447643  
info@grohe.ca

**CH**  
& +41 448777300  
info@grohe.ch

**CN**  
& +86 21 63758878

**CY**  
& +357 22 465200  
info@grome.com

**CZ**  
& +420 277 004 190  
grohe-cz@grohe.com

**DK**  
& +45 44 656800  
grohe@grohe.dk

**E**  
& +34 93 3368850  
grohe@grohe.es

**EST**  
& +372 6616354  
grohe@grohe.ee

**F**  
& +33 1 49972900  
marketing-fr@grohe.com

**FIN**  
& +358 10 8201100  
teknocalor@teknocalor.fi

**GB**  
& +44 871 200 3414  
info-uk@grohe.com

**GR**  
& +30 210 2712908  
nsapountzis@ath.forthnet.gr

**H**  
& +36 1 2388045  
info-hu@grohe.com

**HK**  
& +852 2969 7067  
info@grohe.hk

**I**  
& +39 2 959401  
info-it@grohe.com

**IND**  
& +91 124 4933000  
customercare.in@grohe.com

**IS**  
& +354 515 4000  
jonst@byko.is

**J**  
& +81 3 32989730  
info@grohe.co.jp

**KZ**  
& +7 727 311 07 39  
info-cac@grohe.com

**LT**  
& +372 6616354  
grohe@grohe.ee

**LV**  
& +372 6616354  
grohe@grohe.ee

**MAL**  
& +1 800 80 6570  
info-singapore@grohe.com

**N**  
& +47 22 072070  
grohe@grohe.no

**NL**  
& +31 79 3680133  
vragen-nl@grohe.com

**NZ**  
& +09/373 4324

**P**  
& +351 234 529620  
commercial-pt@grohe.com

**PL**  
& +48 22 5432640  
biuro@grohe.com.pl

**RI**  
& +62 21 2358 4751  
info-singapore@grohe.com

**RO**  
& +40 21 2125050  
info-ro@grohe.com

**ROK**  
& +82 2 559 0790  
info-singapore@grohe.com

**RP**  
& +63 2 8041617

**RUS**  
& +7 495 9819510  
info@grohe.ru

**S**  
& +46 771 141314  
grohe@grohe.se

**SGP**  
& +65 6 7385585  
info-singapore@grohe.com

**SK**  
& +420 277 004 190  
grohe-cz@grohe.com

**T**  
& +66 2610 3685  
info-singapore@grohe.com

**TR**  
& +90 216 441 23 70  
GroheTurkey@grome.com

**UA**  
& +38 44 5375273  
info-ua@grohe.com

**USA**  
& +1 800 4447643  
us-customerservice@grohe.com

**VN**  
& +84 8 5413 6840  
info-singapore@grohe.com

**AL** **BiH** **HR** **KS**  
**ME** **MK** **SLO** **SRB**  
& +385 1 2911470  
adria-hr@grohe.com

**Eastern Mediterranean,  
Middle East - Africa  
Area Sales Office:**  
& +357 22 465200  
info@grome.com

**IR** **OM** **UAE** **YEM**  
& +971 4 3318070  
grohedubai@grome.com

**Far East Area Sales Office:**  
& +65 6311 3600  
info@grohe.com.sg