

**Geberit bathtub drain with push actuation PushControl, d52, length 26 cm, with ready-to-fit-set and straight connector**

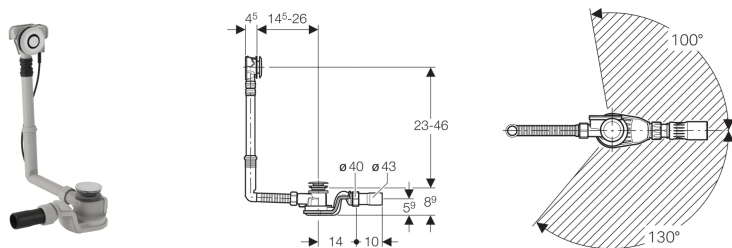

**Application purposes**

- For bathtubs made of steel, plastic or cast iron
- For standard-size bathtubs
- For bathtubs with valve hole  $\varnothing$  52 mm

**Characteristics**

- Quality-monitored in accordance with EN 274-3
- Push actuation aligned with bathtub surface
- With overflow
- Double-sided seals on drain and overflow
- Overflow head with extendible mount can be fastened

**Technical data**

Discharge rate	1 l/s
Overflow discharge rate	0.65 l/s
Depth of water seal	50 mm

**Scope of delivery**

- Waste outlet
- Trap
- Straight connector made of PE-HD,  $\varnothing$  43 mm
- Ready-to-fit set
- Protection box
- Fastening material

Art. no.	Surface / colour
150.770.21.1	gloss chrome-plated

Created with Geberit online product catalogue - 21/06/2018