

Swarm A30

Auto-Darkening Welding Helmet



Swarm A30

Welding Processes

- SMAW / MMA (Stick)
- MIG / MAG (GMAW)
- Manual Plasma Cutting (PAC)
- Air Carbon Arc and Cutting (CAC-A)
- Oxy-Fuel Cutting
- Grinding

When precision is a must, Swarm A30 delivers the accuracy needed to produce flawless welds. Using convenient internal dial controls, the auto-darkening filter (ADF) provides a sharp, clean view of the weld pool using true-color technology and highly-rated EN 1/1/1/2 optical performance. A handy grind setting is available to alleviate the need to swap PPE for finishing requirements.

The streamlined shell completes the helmet for lightweight, high-quality protection. Swarm A30's sleek design and advanced performance will take your welding to new heights.

- ADF viewing area: 98 x 43 mm (3.85 x 1.7 in.)
- Shade range: DIN 4/9–13
- Grind mode via internal switch
- CE Optical class: 1/1/1/2
- Arc sensors: 4
- Fast switching time of 0.08 millisecond
- Internally-mounted and fully-adjustable delay and sensitivity settings
- Replaceable 1 x CR2450 battery
- Low battery indicator LED
- ADF test button

Visit **esab.com** for more information.



*Lightweight, streamlined shell design
with 1/1/1/2 CE optical clarity ADF.*

Swarm A30

Specifications

Viewing Area	98 x 43 mm (3.85 x 1.7 in.)
Active Lens Shade (Adjustable)	9–13
Passive Lens Shade	4
Power Supply	1 x CR2450 battery, replaceable
Arc Sensors	4
Switch Time (Light to Dark)	0.08 ms
CE Optical Classification	1/1/1/2
Standards and Certifications	CE: EN175; EN379; EN166 ANSI: Z87.1 CSA: Z94.3
Weight	520g (1.1 lb)

Ordering Information

Description	Part Number
Swarm A30 Helmet	0700102044

Delivery includes: Full helmet assembly.

Spare Parts

1	Swarm A10 / A20 / A30 Front Cover Lens 5 PCS	0700102036
2	Swarm A30 Shell (PA)	0700102045
3	Swarm A30 Auto Darkening Filter (ADF)	0700102047
4	Swarm A30 Inner Cover Lens 5 PCS	0700102046
5	Swarm A30 Headgear	0700102050

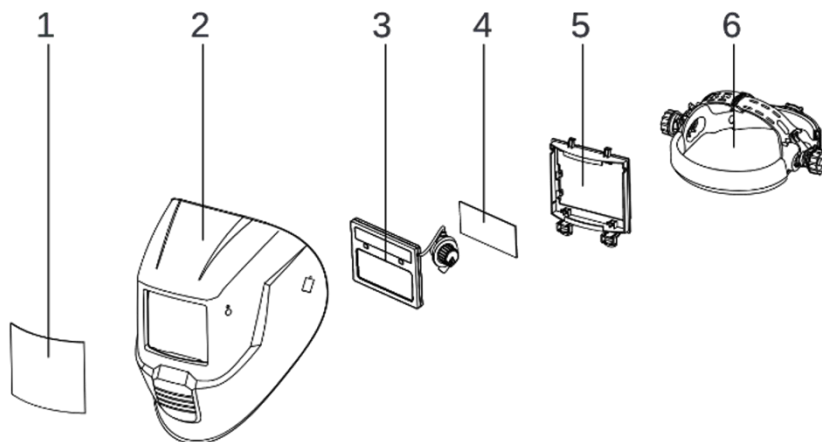

ESAB / esab.com

