

CUTTING CONFIGURATIONS

LC65 Parts

Standard

In the standard cutting configuration, the nozzle is designed for a user-maintained gap between the nozzle and the workpiece, unless the spacer is attached. Standard cutting allows maximum arc visibility and is recommended for higher current levels and thicker plate. Standard cutting parts are included with the torch.

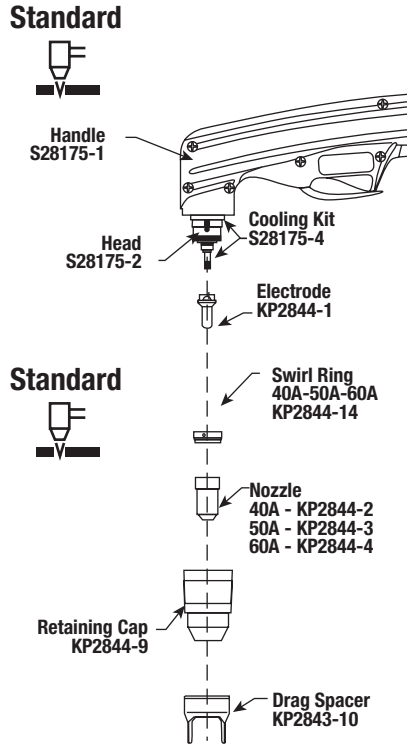

Direct Contact

Direct contact cutting uses special expendable parts that allow the torch to touch the work piece. This technique is recommended for low amperages and thinner plate thicknesses. A special optional nozzle is required for direct contact cutting. See consumables.

Shielded Contact

Shielded contact cutting uses special expendable parts that allow the torch to touch the work piece. A special optional nozzle and drag shield are required for shielded contact cutting. Recommended for 50-60 amp operation. See consumables.

Contact

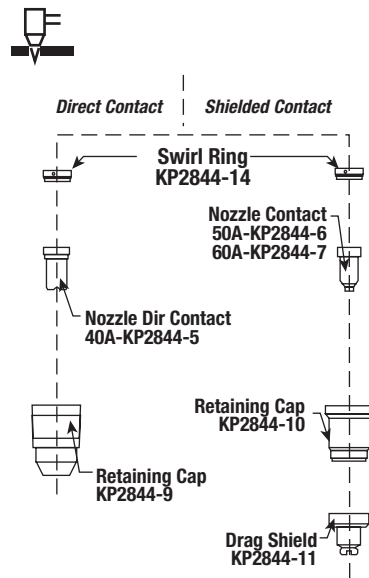

Gouging

When gouging metal, a special optional gouging nozzle is used in conjunction with a shield to protect the nozzle from molten metal blow back. See consumables.

Gouging

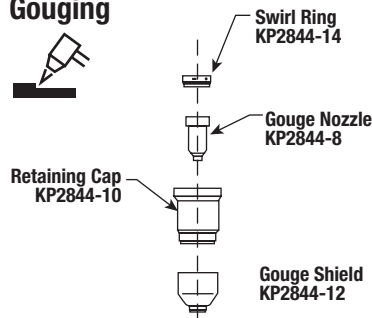

TOMAHAWK 1000 TORCH CONSUMABLES

Product Number	Description	
K2848-1	LC65 Handheld Plasma Torch 25 ft (7.5 m)	
K2848-2	LC65 Handheld Plasma Torch 50 ft (15 m)	
KP2844-1	Electrode (60A)	Standard
KP2844-4	Nozzle (60A)	Standard
KP2844-9	Retaining Cap (40A-60A)	Standard
KP2843-10	Drag Spacer	Standard
KP2844-14	Swirl Ring (40,50,60A)	Standard
Optional Nozzles & Related Accessories: (Not Included in K2848-1 or -2)		
KP2844-2	Nozzle (40A)	Optional
KP2844-3	Nozzle (50A)	Optional
KP2844-5	Nozzle (Direct Contact) (40A)	Optional
KP2844-6	Nozzle (Shielded Contact) (50A)	Optional
KP2844-7	Nozzle (Shielded Contact) (60A)	Optional
KP2844-8	Nozzle (Gouging)	Optional
KP2844-10	Retaining Cap (Shielded Contact or Gouging)	Optional
KP2844-11	Drag Shield (50,60A)	Optional
KP2844-12	Gouge Shield	Optional

- It is normal for the electrode to wear during operation.
- Electrodes should typically be replaced when erosion reaches 0.060 in. (1.5 mm).
- A green and erratic arc will indicate the end of electrode life. The electrode should be immediately replaced.
- It is recommended that the KP2844-1 Electrode and KP2844-4 Nozzle (60A) be replaced as a complete set.