

# Magnum<sup>®</sup> PRO Curve<sup>™</sup> Semiautomatic Guns

## Processes

MIG, Pulsed MIG, Flux-Cored

## Product Number

K2950-x Magnum<sup>®</sup> PRO Curve<sup>™</sup> 200  
K2951-x Magnum<sup>®</sup> PRO Curve<sup>™</sup> 300  
K2952-x Magnum<sup>®</sup> PRO Curve<sup>™</sup> 400  
K3055-x Magnum<sup>®</sup> PRO Curve<sup>™</sup> 400  
Short Neck

## Amperage Rating @ 60% Duty Cycle

Magnum<sup>®</sup> PRO Curve<sup>™</sup> 200: CO<sub>2</sub>: 200A

Magnum<sup>®</sup> PRO Curve<sup>™</sup> 300: CO<sub>2</sub>: 300A

Magnum<sup>®</sup> PRO Curve<sup>™</sup> 400: CO<sub>2</sub>: 400A

## Wire Diameter Range in. (mm)

.025 - 3/64 (0.6 - 1.2)

.025 - 5/64 (0.6 - 2.0)

.025 - 5/64 (0.6 - 2.0)

## Cable Length ft. (m)

See Table Below

## Semiautomatic Air-Cooled Guns

New Magnum<sup>®</sup> PRO Curve<sup>™</sup> guns for MIG or flux-cored welding combine our classic curved handle with our Copper Plus<sup>™</sup> contact tips and Magnum<sup>®</sup> PRO gun expendables to deliver long hours of fabrication welding with less frequent tip and gun expendable parts changes.

### FEATURES

- ▶ **Industrial Grade Construction** -
  - High quality copper parts ensure superior electrical contact and heat dissipation.
  - Four trigger leads are standard for fast field repair.
  - Patent-pending Anti-Seize<sup>™</sup> tip and diffuser thread design reduces tip and diffuser seizing.
- ▶ **Lincoln Electric Copper Plus<sup>™</sup> Contact Tips** - Larger tip diameter and mass improve heat dissipation to increase tip life.
- ▶ **Curve<sup>™</sup> Handle Design** - Our Curve<sup>™</sup> handle is lightweight and balanced, providing a comfortable grip to reduce fatigue.
- ▶ **Rotating Gun Tube and Gun Hanger Clip** - Allow any number of hand positions to reduce fatigue or fit into tight spaces.
- ▶ **Simplified Expendable Parts Selection**
  - 350A and 550A consumables are interchangeable across all gun models.
  - All models ship with 350A parts.
- ▶ **Upgrade your Magnum<sup>®</sup>** - Turn your existing gun into a Magnum<sup>®</sup> PRO Curve<sup>™</sup> by switching to Magnum<sup>®</sup> PRO gun tubes and expendable parts.



# MAGNUM<sup>®</sup> PRO

### WHAT'S INCLUDED

- ▶ Contact Tip (Qty. 1) (KP2744-045)
- ▶ 0.625 in. (15.9 mm) Thread-On Gas Nozzle with 1/8 in. (3.2 mm) recess (KP2742-1-62R)
- ▶ Thread-On Diffuser (KP2746-1)

### APPLICATIONS

- ▶ Shop Production
- ▶ Maintenance and Repair
- ▶ Construction

THE LINCOLN ELECTRIC COMPANY

22801 St. Clair Avenue • Cleveland, OH • 44117-1199 • U.S.A.  
PH: 216-481-8100 • www.lincolnelectric.com

## TOP FEATURES

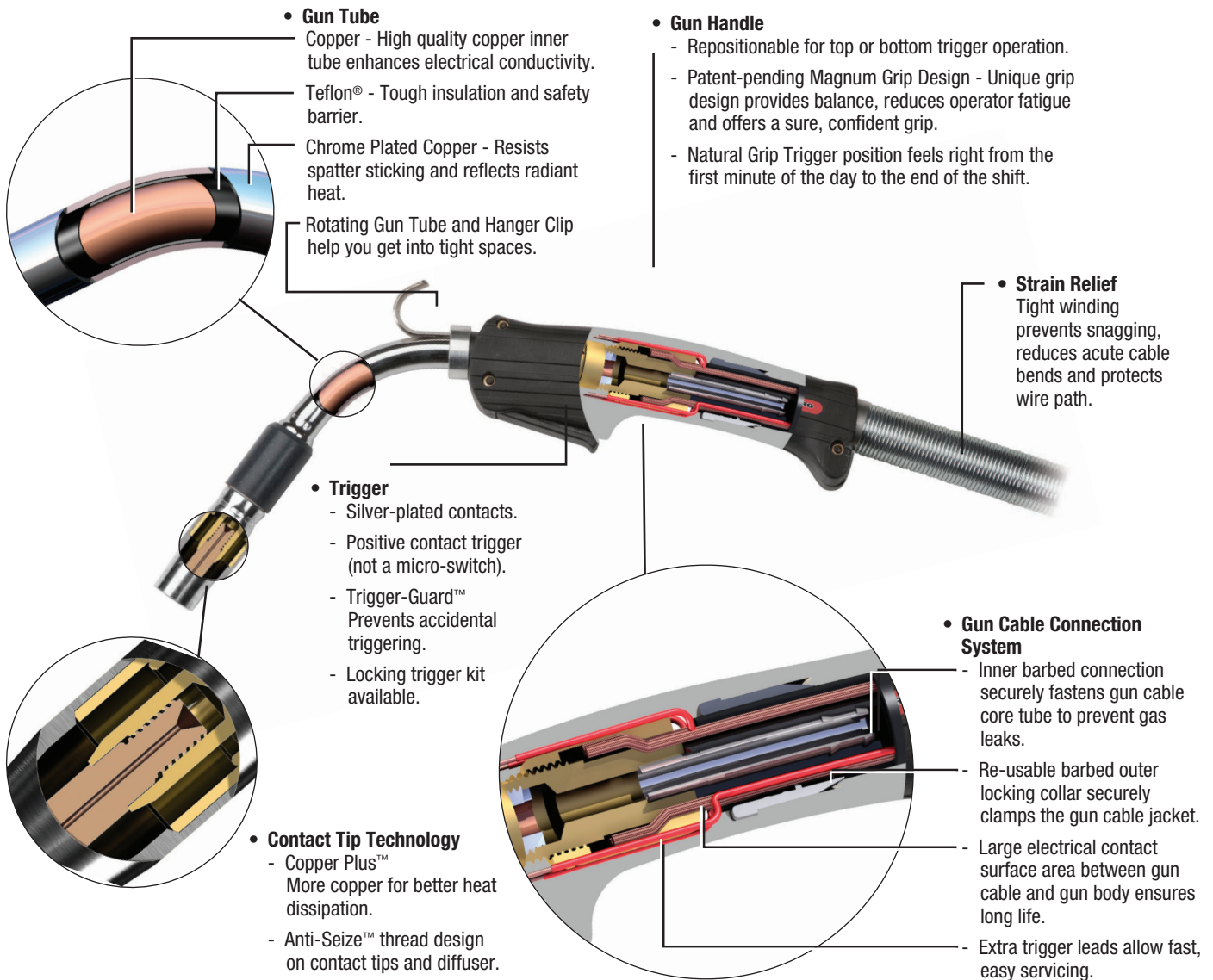

## CONTACT TIP TECHNOLOGY

### Copper Plus™ Contact Tips Compare Magnum® PRO tips to Standard Magnum® and Tregaskiss®

Larger Diameter Means More Copper.  
The Result? Greater Heat Dissipation and Longer Life.

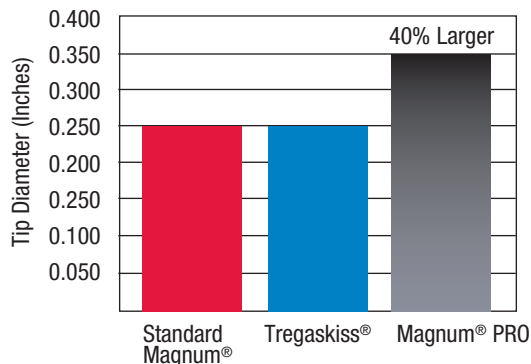

Tregaskiss is a trademark of Tregaskiss, wholly owned subsidiary of Illinois Tool Works.

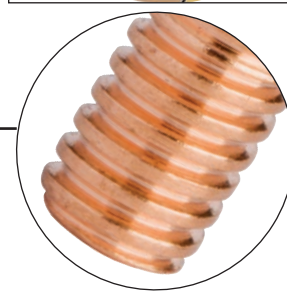
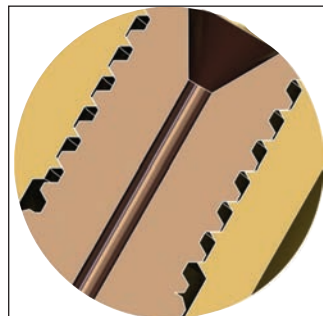

### Patent-pending Anti-Seize™ Thread Design

Flattened thread profile increases the thread cross-section where heat typically concentrates and tips fail. The result is reduced melting, fusion, seizing and extended contact tip service life. Longer life and fewer tip changes reduces expendable part and labor costs while increasing arc time. To extend contact tip life even more, optional chrome-zirconium Extended Life™ tips are also available.

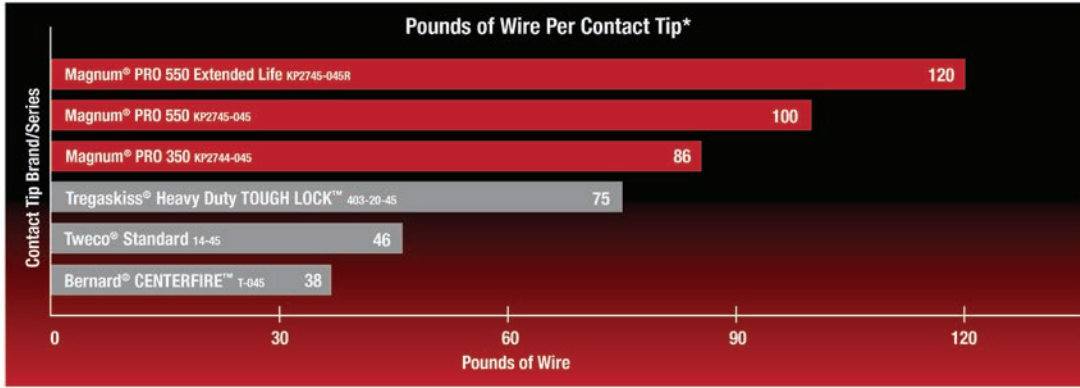

\* Results based on the following test parameters: .045 SuperArc® L-56 on 60 lb. spools. Two spools of wire per tip. Pulse program. 350 ipm Wire Feed Speed (approx. 16 welding hours per tip). 100% duty cycle. Contact tip usage values based on replacing tip after 10% wear. Your actual results may vary.

The trademark Tregaskiss® and Tough Lock™ are the property of Tregaskiss, wholly owned subsidiary of Illinois Tool Works Inc. Bernard® and Centerfire™ are trademarks of Illinois Tool Works Inc. The trademark Tweco® is the property of Thermadyne Industries Inc. Actual testing was completed by Lincoln Electric personnel in Cleveland, Ohio in December 2009. Testing results were complete and accurate at the time of publication in September 2010.

**EXPENDABLE PARTS**

**STEP 1 SELECT YOUR GUN CONNECTOR KIT**

GUN CONNECTOR KIT		
Manufacturer	Wire Feeder Model	Magnum® PRO 200/300/400
Lincoln Electric®	LN-7 Series, LN-8, LN-9, LN-25 [Up to .052 in. (1.4 mm) Wire]	K466-1
	LN-8, LN-9 Series, LN-25 [1/16 in. (1.6 mm) and Larger Wire]	K466-8
	LF-72, LF-74 Series, LN-25 PRO	K466-10
	Power Feed™ 10 and 25 series	K466-10
	POWER MIG® Series and Power Wave® C300	K466-6
Tweco® Adapted	No. 2, No. 3, No. 4 Guns (K466), No. 5 (K613)	K466-2
Miller®	Intellimatic, Sidekick, D-51A, Porto-Mig Millermatic 130, 200, MM-35, S-42GL, S-52A, S-54A, Swing Arc-Dual, Swing Arc-Single S-32S, 52D, 54D, 54E, 60 Series	K466-3



**STEP 2 SELECT YOUR LINER**

MAGNUM® PRO CURVE™ 200A in. (mm)				
ft. (m)	.025-.030 (0.6-0.8)	.030-.035 (0.8-0.9)	.035-.045 (0.9-1.2)	Aluminum <sup>(1)</sup> .035-3/64 (0.9-1.2)
15 (4.5)	KP42-25-15	KP42-3035-15	KP42-4045-15	KP44N-3545-15 <sup>(1)</sup>

MAGNUM® PRO CURVE™ 300A/400A in. (mm)				
ft. (m)	.035-.045 (0.9-1.2)	.052-1/16 (1.3-1.6)	1/16-5/64 (1.6-2.0)	Aluminum <sup>(1)</sup> .035-3/64 (0.9-1.2)
15 (4.5)	KP44-3545-15	KP44-116-15	KP44-564-15	KP44N-3545-15 <sup>(1)</sup>
26 (7.6)	KP44-3545-25	KP44-116-25	KP44-564-25	—

(1) Recommended for aluminum wire welding.

**EXPENDABLE PARTS CONTINUED**

350 A and 550 A Magnum® PRO Expendable Parts are interchangeable. Interchanging will require gun tube insulator and gas diffuser changes. Customers may choose to change expendable parts to standardize stocking parts or to make the gun more compact for tight spaces.

**Magnum® PRO 350A Expendables**



Contact Tip for up to 350A

<b>CONTACT TIPS 350A</b>				
Wire Diameter in. (mm)	Standard	Standard	Tapered Tip	Tapered Tip
	Pkg. Qty. - 10	Pkg. Qty. - 100	Pkg. Qty. - 10	Pkg. Qty. - 100
0.025 (0.6)	KP2744-025	KP2744-025-B100	KP2744-025T	KP2744-025T-B100
0.030 (0.8)	KP2744-030	KP2744-030-B100	KP2744-030T	KP2744-030T-B100
0.035 (0.9)	KP2744-035	KP2744-035-B100	KP2744-035T	KP2744-035T-B100
0.040 (1.0)	KP2744-040	KP2744-040-B100	KP2744-040T	KP2744-040T-B100
0.045 (1.2)	KP2744-045	KP2744-045-B100	KP2744-045T	KP2744-045T-B100
0.052 (1.3)	KP2744-052	KP2744-052-B100	KP2744-052T	KP2744-052T-B100
1/16 (1.6)	KP2744-116	KP2744-116-B100	KP2744-116T	KP2744-116T-B100
5/64 (2.0)	KP2744-564	KP2744-564-B100	KP2744-564T	KP2744-564T-B100

<b>GAS DIFFUSER 350A</b>				
Pkg. Qty.	Thread-on Standard Duty	Thread-on Light Duty	Thread-on Extended Reach	Slip-on
1	KP2746-1	KP3141-1 <sup>(1)</sup>	KP3360-1	KP2746-2
25	KP2746-1-B25	KP3141-1-B25 <sup>(1)</sup>	KP3360-1-B25	KP2746-2-B25



Gas Diffuser for 350A Thread-on



Gas Diffuser for 350A Slip-on



Extended Reach Gas Diffuser for 350A Thread-on

<b>GUN TUBE INSULATOR 350A</b>	
Pkg. Qty.	Part Number
1	KP2773-2
25	KP2773-2-B25



Gun Tube Insulator 350A

<b>GAS NOZZLE 350A</b>							
Gas Nozzle Diameter in. (mm)							
	Nozzle	Pkg. Qty.	Standard 0.375 (9.5)	Standard 0.5 (12.7)	Extended Reach 0.5 (12.7)	Bottleneck 0.5 (12.7)	Standard 0.625 (15.9)
Thread-on	1/8 (3.2) Recess	1	KP2742-1-38R	KP2742-1-50R	KP3359-1-50R	KP3160-1-50R	KP2742-1-62R
		25	KP2742-1-38R-B25	KP2742-1-50R-B25	KP3359-1-50R-B25	KP3160-1-50R-B25	KP2742-1-62R-B25
	Flush	1	KP2742-1-38F	KP2742-1-50F	—	KP3160-1-50F	KP2742-1-62F
		25	KP2742-1-38F-B25	KP2742-1-50F-B25	—	KP3160-1-50F-B25	KP2742-1-62F-B25
Slip-on	1/8 (3.2) Stickout	1	KP2742-1-38S	KP2742-1-50S	—	KP3160-1-50S	KP2742-1-62S
		25	KP2742-1-38S-B25	KP2742-1-50S-B25	—	KP3160-1-50S-B25	KP2742-1-62S-B25
	1/8 (3.2) Recess	1	—	KP2742-2-50R	—	—	KP2742-2-62R
		25	—	KP2742-2-50R-B25	—	—	KP2742-2-62R-B25
Slip-on	Flush	1	—	KP2742-2-50F	—	—	KP2742-2-62F
		25	—	KP2742-2-50F-B25	—	—	KP2742-2-62F-B25
	1/8 (3.2) Stickout	1	—	KP2742-2-50S	—	—	KP2742-2-62S
		25	—	KP2742-2-50S-B25	—	—	KP2742-2-62S-B25



Bottleneck Gas Nozzle for up to 350A Thread-on 1/8" (3.2 mm) Recessed



Gas Nozzle for up to 350A Thread-on 1/8" (3.2 mm) Recessed



Extended Reach Gas Nozzle for up to 350A Thread-on 1/8" (3.2 mm) Recessed

<b>GUN TUBE<sup>(2)</sup></b>				
Gun Tubes	45°	60°	82°	Flexible
Magnum® PRO Curve™ 200	KP2924-45	KP2924-60	—	—
Magnum® PRO Curve™ 300	KP2925-45	KP2925-60	—	—
Magnum® PRO Curve™ 400	KP2926-45	KP2926-60 / KP2926-60L <sup>(3)(4)</sup>	KP2926-82	KP3200-1

(1) For use with Magnum® PRO 100L KP3075-1-XXX nozzles only

(2) Can be used on existing Magnum® Guns

(3) Extended version.

(4) When using an extended gun tube and extended gas nozzle, a 25 ft. liner should be used.

**EXPENDABLE PARTS CONTINUED**

350 A and 550 A Magnum® PRO Expendable Parts are interchangeable. Interchanging will require gun tube insulator and gas diffuser changes. Customers may choose to change expendable parts to standardize stocking parts or to make the gun more compact for tight spaces.

**Magnum® PRO 550A Expendables**



Contact Tip for up to 550A

<b>CONTACT TIPS 550 A</b>				
Wire Diameter in. (mm)	Standard	Standard	Extended Life	Extended Life
	Pkg. Qty. - 10	Pkg. Qty. - 100	Pkg. Qty. - 10	Pkg. Qty. - 100
0.035 (0.9)	KP2745-035	KP2745-035-B100	KP2745-035R	KP2745-035R-B100
0.040 (1.0)	KP2745-040	KP2745-040-B100	NA	NA
0.045 (1.2)	KP2745-045	KP2745-045-B100	KP2745-045R	KP2745-045R-B100
0.052 (1.3)	KP2745-052	KP2745-052-B100	KP2745-052R	KP2745-052R-B100
1/16 (1.6)	KP2745-116	KP2745-116-B100	KP2745-116R	KP2745-116R-B100
0.068-0.072 (1.7-1.8)	KP2745-072	KP2745-072-B100	KP2745-072R	KP2745-072R-B100
5/64 (2.0)	KP2745-564	KP2745-564-B100	KP2745-564R	KP2745-564R-B100
3/32 (2.4) <sup>(1)</sup>	KP2745-332	KP2745-332-B100	KP2745-332R	KP2745-332R-B100
7/64 (2.8) <sup>(1)</sup>	KP2745-764	KP2745-764-B100	KP2745-764R	KP2745-764R-B100
1/8 (3.2) <sup>(1)</sup>	KP2745-18	KP2745-18-B100	NA	NA

(1) 550 only

<b>GAS DIFFUSER 550A</b>			
Type			
Pkg. Qty.	Thread-on Standard Duty	Thread-on 1/4 in. Recess	Slip-on
1	KP2747-1	KP3155-1	KP2747-2
25	KP2747-1-B25	KP3155-1-B25	KP2747-2-B25



Gas Diffuser for up to 550A Thread-on



Gas Diffuser for up to 550A Slip-on

<b>GUN TUBE INSULATOR 550A</b>	
Pkg. Qty.	Part Number
1	KP2773-1
25	KP2773-1-B25



Gun Tube Insulator 550A

<b>GAS NOZZLE 550A</b>					
Gas Nozzle Diameter in. (mm)					
	Nozzle	Pkg. Qty.	Standard 0.625 (15.9)	Bottleneck 0.625 (15.9)	Standard 0.750 (19)
	Thread-on	1/8 (3.2) Recess	1	KP2743-1-62R	KP3161-1-62R
25			KP2743-1-62R-B25	KP3161-1-62R-B25	KP2743-1-75R-B25
Flush		1	KP2743-1-62F	KP3161-1-62F	KP2743-1-75F
		25	KP2743-1-62F-B25	KP3161-1-62F-B25	KP2743-1-75F-B25
Slip-on	1/8 (3.2) Stickout	1	KP2743-1-62S	KP3161-1-62S	KP2743-1-75S
		25	KP2743-1-62S-B25	KP3161-1-62S-B25	KP2743-1-75S-B25
	1/8 (3.2) Recess	1	KP2743-2-62R	-	KP2743-2-75R
		25	KP2743-2-62R-B25	-	KP2743-2-75R-B25
Flush	1	KP2743-2-62F	-	KP2743-2-75F	
	25	KP2743-2-62F-B25	-	KP2743-2-75F-B25	
1/8 (3.2) Stickout	1	KP2743-2-62S	-	KP2743-2-75S	
	25	KP2743-2-62S-B25	-	KP2743-2-75S-B25	



Bottleneck Gas Nozzle for 550A Thread-on Recessed



Gas Nozzle for 550A Thread-on Recessed

## RECOMMENDED ACCESSORIES

### GENERAL OPTIONS



**Magnum® PRO Harness Adapter**  
 Required for use with  
 Magnum® PRO Dual Procedure  
 or Dual Schedule guns when  
 adapting to POWER MIG® products,  
 Power Wave® C300, or  
 Miller Electric® wire feeders.  
**Order K3159-1**

## SPECIFICATIONS

Product Name	Product Number	Amperage Rating 60% Duty Cycle		Wire Diameter Range		Cable Length ft. (m)	Gun Connector	Gun Liner
		CO <sub>2</sub>	Mixed	in.	(mm)			
Magnum® PRO Curve™ 200	K2950-1	200	150	.025 - 3/64	(0.6 - 1.2)	10 (3.0)	Order Separately	Order Separately
	K2950-2					15 (4.5)		
Magnum® PRO Curve™ 300	K2951-1	300	200	.025 - 5/64	(0.6 - 2.0)	10 (3.0)		
	K2951-2					15 (4.5)		
	K2951-3					20 (6.1)		
	K2951-4					25 (7.6)		
Magnum® PRO Curve™ 300 Dual Procedure (Switch Control)	K3130-1	300	200	.025 - 5/64	(0.6 - 2.0)	10 (3.0)		
	K3130-2					15 (4.5)		
	K3130-3					20 (6.1)		
	K3130-4					25 (7.6)		
Magnum® PRO Curve™ 300 Dual Schedule (Trigger Control)	K3092-1	300	200	.025 - 5/64	(0.6 - 2.0)	10 (3.0)		
	K3092-2					15 (4.5)		
	K3092-3					20 (6.1)		
	K3092-4					25 (7.6)		
Magnum® PRO Curve™ 400	K2952-1	400	400 @ 50% DC	.025 - 5/64	(0.6 - 2.0)	10 (3.0)		
	K2952-2					15 (4.5)		
	K2952-3					20 (6.1)		
	K2952-4					25 (7.6)		
Magnum® PRO Curve™ 400 Dual Procedure (Switch Control)	K3098-1	400	400 @ 50% DC	.025 - 5/64	(0.6 - 2.0)	10 (3.0)		
	K3098-2					15 (4.5)		
	K3098-3					20 (6.1)		
	K3098-4					25 (7.6)		
Magnum® PRO Curve™ 400 Dual Schedule (Trigger Control)	K3093-1	400	400 @ 50% DC	.025 - 5/64	(0.6 - 2.0)	10 (3.0)		
	K3093-2					15 (4.5)		
	K3093-3					20 (6.1)		
	K3093-4					25 (7.6)		
Magnum® PRO Curve™ 400A Short Neck	K3055-1	400	400 @ 50% DC	.025 - 5/64	(0.6 - 2.0)	10 (3.0)		
	K3055-2					15 (4.5)		
	K3055-3					20 (6.1)		
	K3055-4					25 (7.6)		
Magnum® PRO Curve™ 200 Ready-Pak®	K2950-2-10-45	200	150	.025 - 3/64*	(0.6 - 1.2)	15 (4.5)	K466-10	KP42-4045-15
Magnum® PRO Curve™ 300 Ready-Pak®	K2951-2-6-45	300	200	.025 - 5/64*	(0.6 - 2.0)	15 (4.5)	K466-6	KP44-3545-15
Magnum® PRO Curve™ 300 Ready-Pak®	K2951-2-10-45	300	200	.025 - 5/64*	(0.6 - 2.0)	15 (4.5)	K466-10	KP44-3545-15
Magnum® PRO Curve™ 300 Ready-Pak®	K2951-2-10-116	300	200	.025 - 5/64	(0.6 - 2.0)	15 (4.5)	K466-10	KP44-116-15
Magnum® PRO Curve™ 400 Ready-Pak®	K2952-2-10-45	400	400 @ 50% DC	.025 - 5/64*	(0.6 - 2.0)	15 (4.5)	K466-10	KP44-3545-15

\* Ready-Paks® come with .035-.045 liner

### CUSTOMER ASSISTANCE POLICY

The business of The Lincoln Electric Company is manufacturing and selling high quality welding equipment, consumables, and cutting equipment. Our challenge is to meet the needs of our customers and to exceed their expectations. On occasion, purchasers may ask Lincoln Electric for information or advice about their use of our products. Our employees respond to inquiries to the best of their ability based on information provided to them by the customers and the knowledge they may have concerning the application. Our employees, however, are not in a position to verify the information provided or to evaluate the engineering requirements for the particular weldment. Accordingly, Lincoln Electric does not warrant or guarantee or assume any liability with respect to such information or advice. Moreover, the provision of such information or advice does not create, expand, or alter any warranty on our products. Any express or implied warranty that might arise from the information or advice, including any implied warranty of merchantability or any warranty of fitness for any customers' particular purpose is specifically disclaimed.

Lincoln Electric is a responsive manufacturer, but the selection and use of specific products sold by Lincoln Electric is solely within the control of, and remains the sole responsibility of the customer. Many variables beyond the control of Lincoln Electric affect the results obtained in applying these types of fabrication methods and service requirements.

Subject to Change – This information is accurate to the best of our knowledge at the time of printing. Please refer to [www.lincolnelectric.com](http://www.lincolnelectric.com) for any updated information.

**LINCOLN**  
**ELECTRIC**  
 THE WELDING EXPERTS®