

FITTING GUIDE

W2 W4 WT WT+

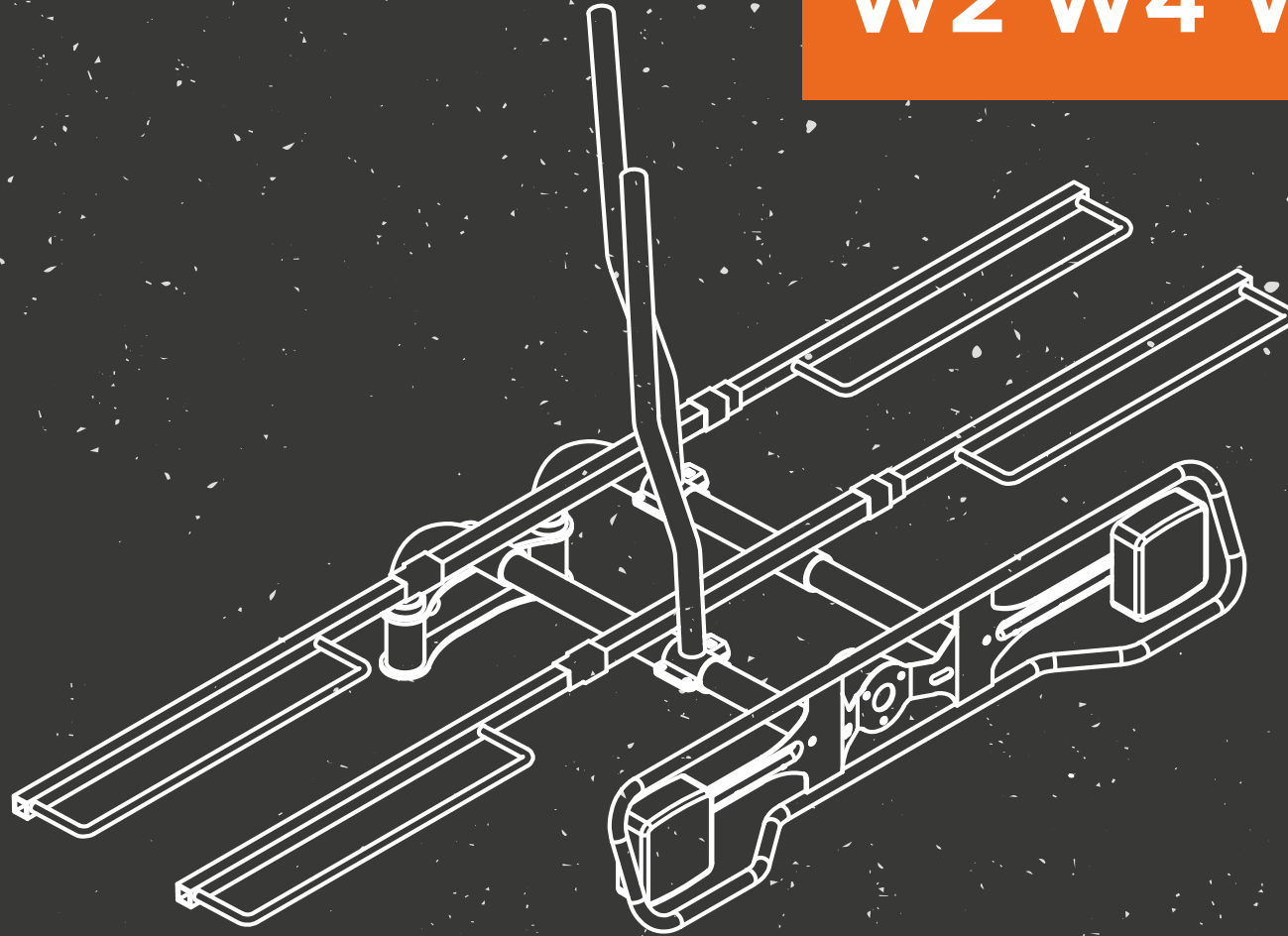

CONTENTS



Box Contents

Wheel Support	03
Block	04
LED Light Unit	05
Block Fixings	06
Rack Fixings	07
Straps	08
Tools	08

Fixing Guide

Mounting Block - On the ball	09
Mounting Block - Behind the ball	10
Fitting the Main Poles.....	12
Fitting the Chassis and D-Loops.....	14
Fitting the Vertical Supports	16
Securing LED Light Unit	19
Securing Bikes	20

Information

Important Information.....	21
Maintenance	21
Liability.....	22

BOX CONTENTS - WHEEL SUPPORT

Main Pole

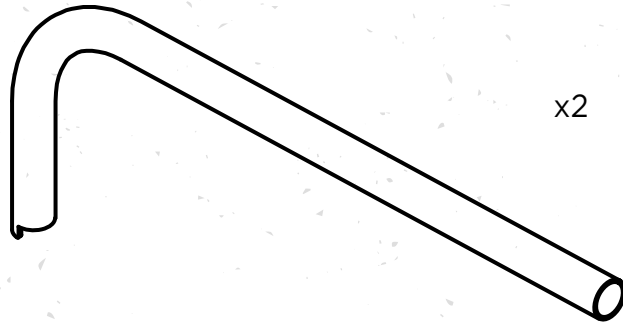

Chassis

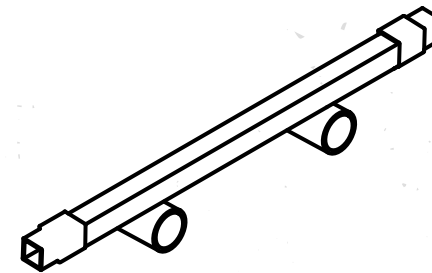

- W2 x2
- W4 x4
- WT x3
- WT+ x4

D-Loop

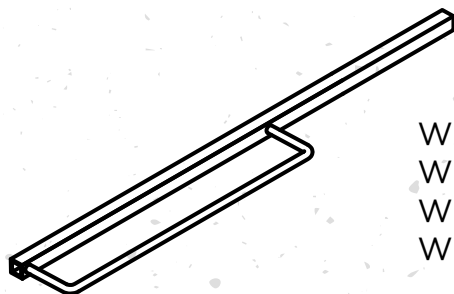

- W2 x4
- W4 x8
- WT x3
- WT+ x5

Vertical Support



- W2 x2
- W4 x4
- WT x0
- WT+ x1

Under Clamp



- W2 x2
- W4 x4
- WT x0
- WT+ x1

BOX CONTENTS - BLOCK

Universal Block

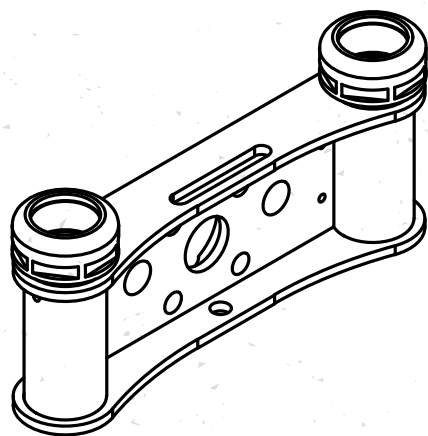

Tow Ball Clamp

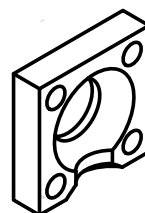

Security Plate

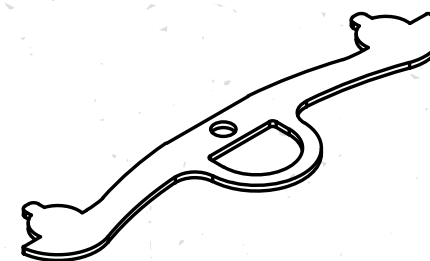

Single Light Plate

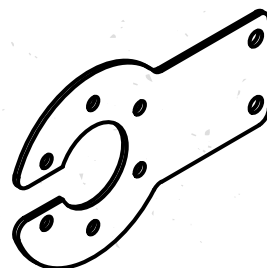

BOX CONTENTS - LED LIGHT UNIT

LED Light Unit

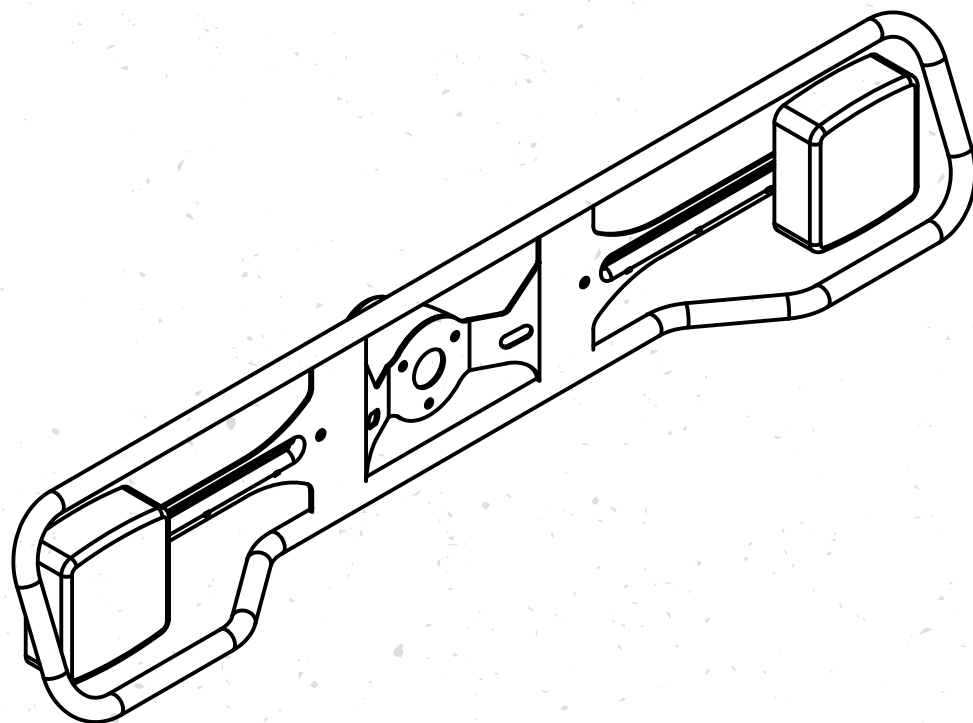

Cable

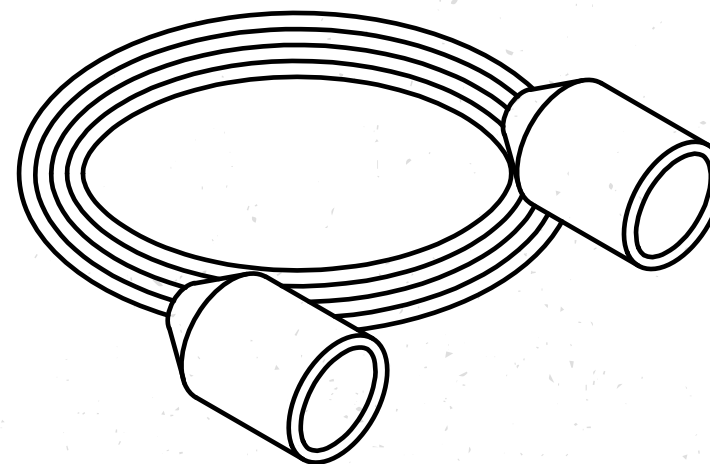

BOX CONTENTS - BLOCK FIXINGS

M6x12 Bolt

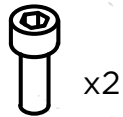

M10 Bolt

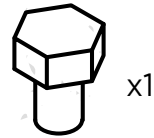

M10X65 Bolt

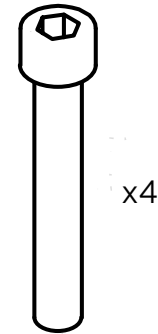

M16X60 Bolt

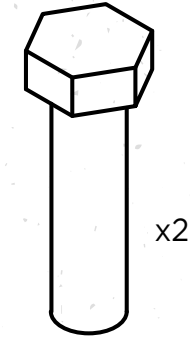

M16 Nyloc Nut

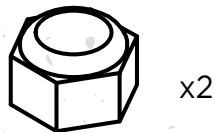

M5 Nyloc Nut



M10 Nut



M5X35 Screw

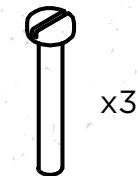

M16 Washer

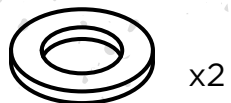

M10 Spring Washer



M5 Washer



BOX CONTENTS - RACK FIXINGS

Thumbscrew



W2	x4
W4	x8
WT	x6
WT+	x8

M6x16 Bolt



W2	x12
W4	x24
WT	x12
WT+	x18

M8x40 Cup SQ



W2	x2
W4	x4
WT	x0
WT+	x1

M6 Nut



W2	x4
W4	x8
WT	x0
WT+	x2

M8 Nut



W2	x2
W4	x4
WT	x0
WT+	x1

M6 Washer



W2	x4
W4	x8
WT	x0
WT+	x2

M8 Washer



W2	x2
W4	x4
WT	x0
WT+	x1

BOX CONTENTS - STRAPS

0.5m Strap

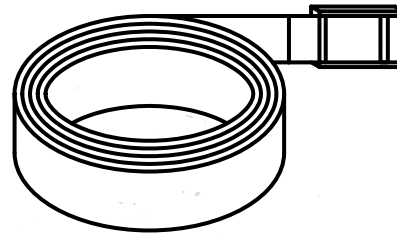

W2 x6
W4 x12
WT x3
WT+ x5

BOX CONTENTS - TOOLS

Spanner

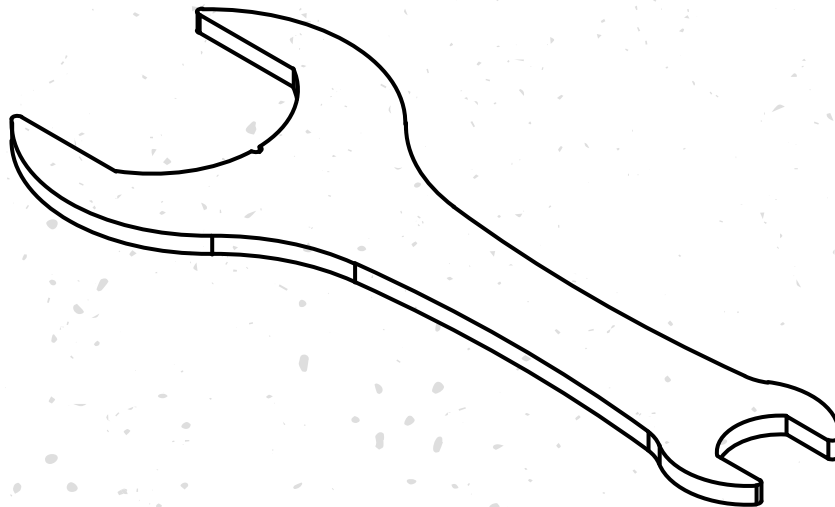

Allen Key



FITTING GUIDE

MOUNTING BLOCK - ON THE BALL

This mounting option suits the following tow bars - Swan neck, detachable and standard 2 bolt flange tow bars

YOU WILL NEED

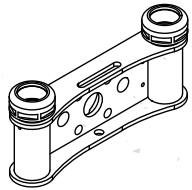

Universal Block

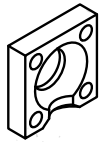

Tow Ball Clamp



x4

M10X65 Bolt



x4

M10 Nut



x4

M10 Spring Washer

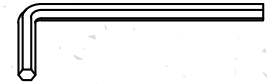

Allen Key

STEP 1

Push the **M10X65 bolts** through the 4 holes in the **universal block** at the front

STEP 2

Place the **universal block** onto the tow ball and slide the **tow ball clamp** over the bolts making sure the cut out is at the bottom

STEP 3

Put an **M10 Spring Washer** onto each of the bolts, followed by an **M10 Nut** - Use the **Allen Key** and a 17mm spanner to tighten the lower bolts to a torque of approximately 10Nm keeping the clamp plate parallel with the block.

STEP 4

Tighten the top bolts to an equal level, ensuring the universal block is correctly aligned. Finally tighten all 4 bolts to the recommended torque of 59Nm, we recommend tightening all 4 bolts in stages up to the final torque setting.

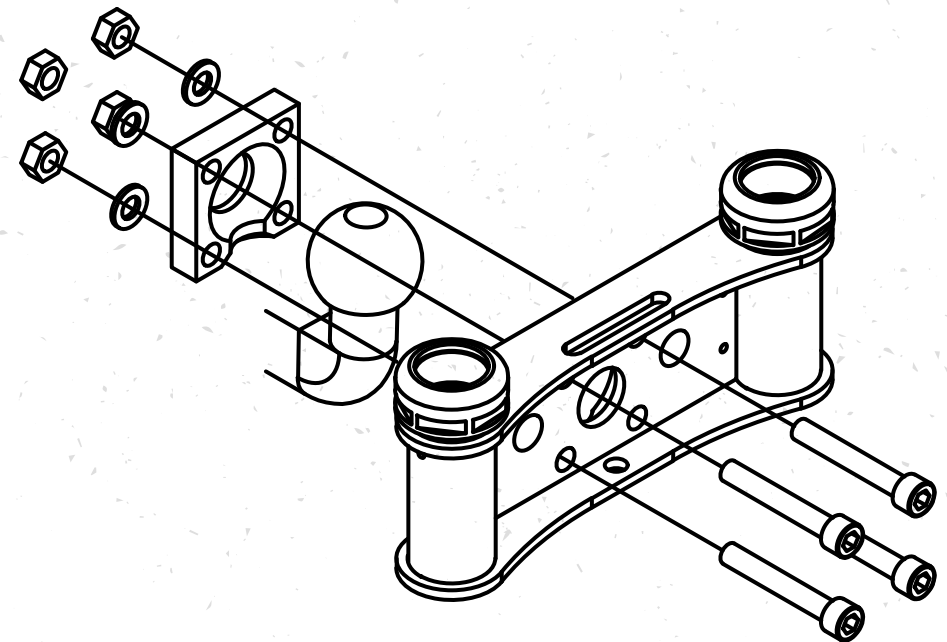

FITTING GUIDE

MOUNTING BLOCK - BEHIND THE BALL

This mounting option suits standard 2 bolt flange tow bars

YOU WILL NEED

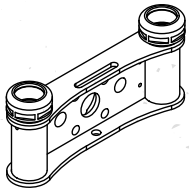

Universal Block

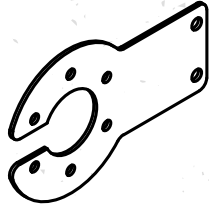

Single Light Plate

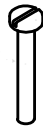

x3



x2



x3



x3

M5 Nyloc Nut

M5 Washer

STEP 1

FIT LIGHT PLATE TO BLOCK- The light plate replaces the existing electrical socket plate on your tow bar to make it accessible with the mounting block in place. We recommend that these plates are fitted to the block before attaching the block to the vehicle.

Secure the **Single Light Plate** to the back of the **Universal Block** using the two **M6X12 Bolts**

STEP 2

Secure your vehicles existing lighting socket to the Light Plate using the three **M5X35 Screws, M5 Washers** and **M5 Nyloc Nuts**. Any of the six holes in the Light Plate can be used for this purpose

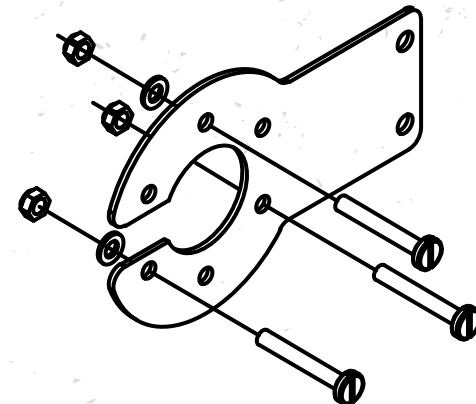
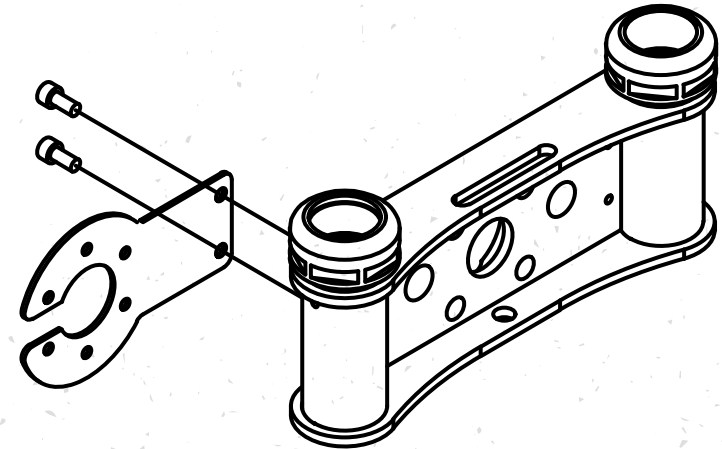

YOU WILL NEED



x2

M16X60 Bolt



x2

M16 Washer



x2

M16 Nyloc Nut

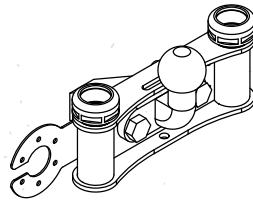

Universal Block
with Light Plate

STEP 3

Remove the bolts that are currently securing the flange tow ball to the vehicle.

STEP 4

Re-assemble the tow ball the the **universal block** sandwiched between the tall ball and existing bracket using the two **M16X60 Bolts**, **M16 Washers** and **M16 Nyloc Nuts**

YOU MUST USE THE BOLTS PROVIDED NOT THOSE REMOVED FROM FROM THE TOW BALL IN STEP 3

STEP 5

Tighten the **M16 Nyloc nuts**. (Recommended torque 249Nm)

The assembly remains as a permanent fixture. Check the tightness of the bolts after the first use of the rack and then re-check periodically.

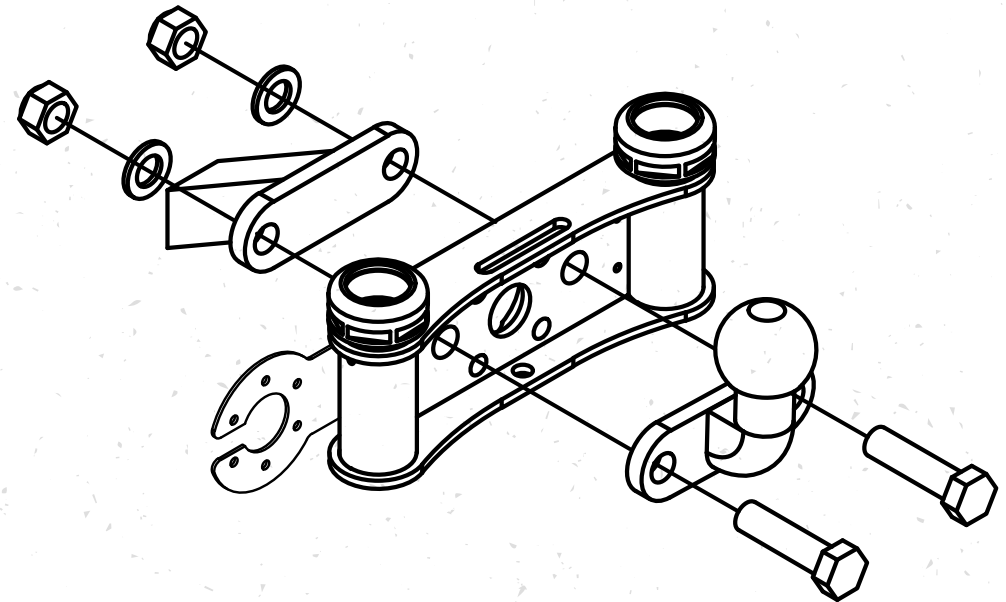

FITTING GUIDE

FITTING THE MAIN POLES

YOU WILL NEED

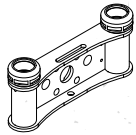

Universal Block
secured to tow ball

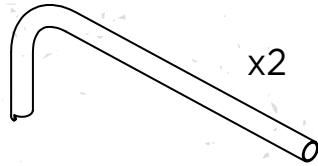

Main Pole

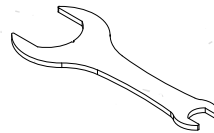

Spanner

STEP 1

Loosen off both of the orange socket caps on the **universal Block** using the **spanner** provided, leaving them on the last couple of threads on the sockets

STEP 2

Drop the **main poles** into the **universal block**, make sure they are seated into the bottom of the sockets.

Tighten the orange socket cap - leaving finger tight

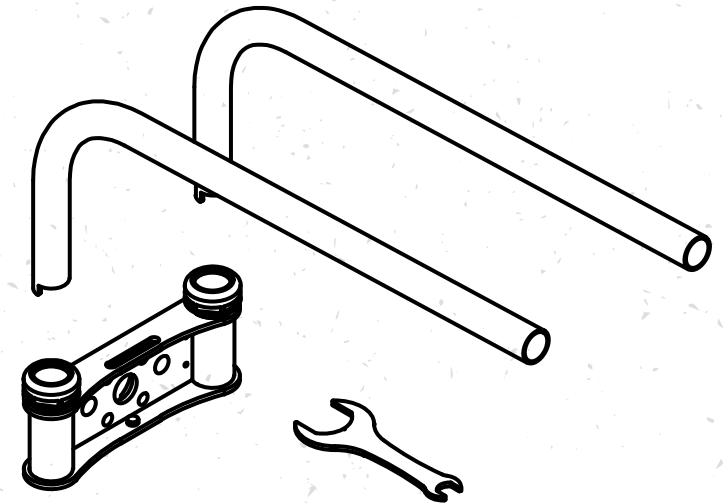

STEP 3

Slide the **security plate** onto the underside of the **universal block** so that it engages with both of the **arms**

STEP 4

Secure the plate using the **M10 Bolt** with the small end of the **Spanner**

STEP 5

Tighten both of the orange socket caps using the large end of the **Spanner**

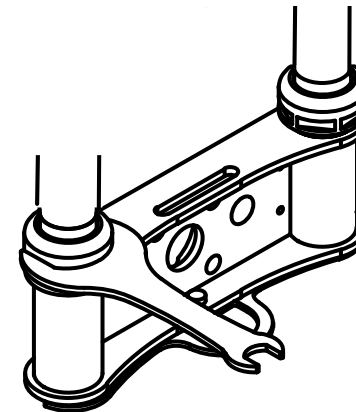
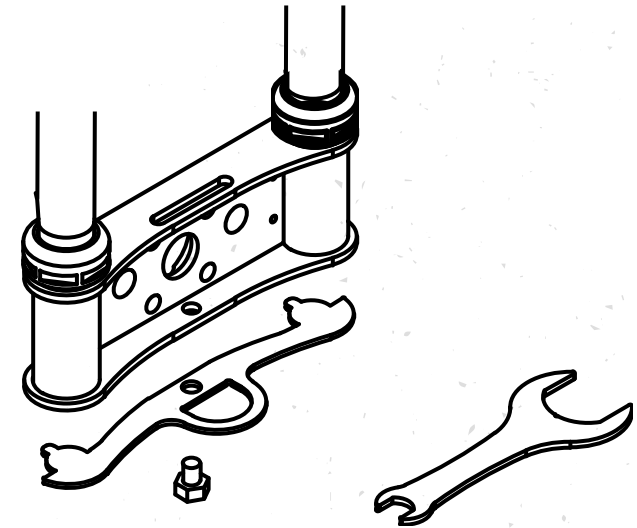

FITTING THE CHASSIS AND D-LOOPS

Chassis and D-Loops are used in the following configurations depending on the rack -

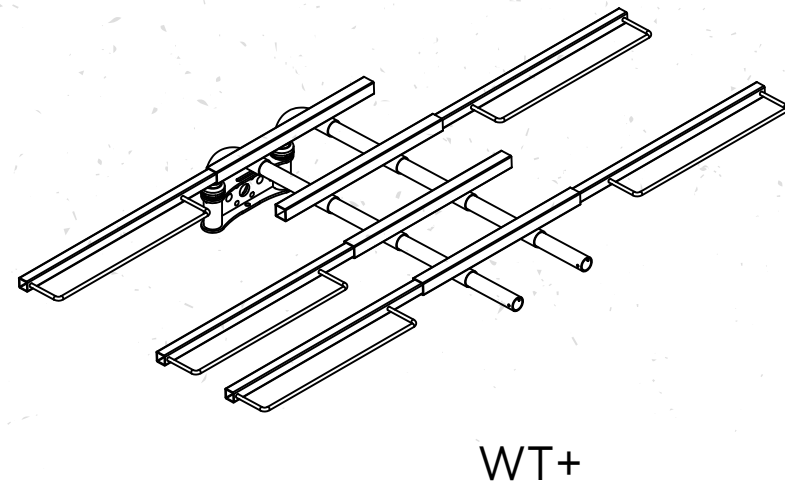
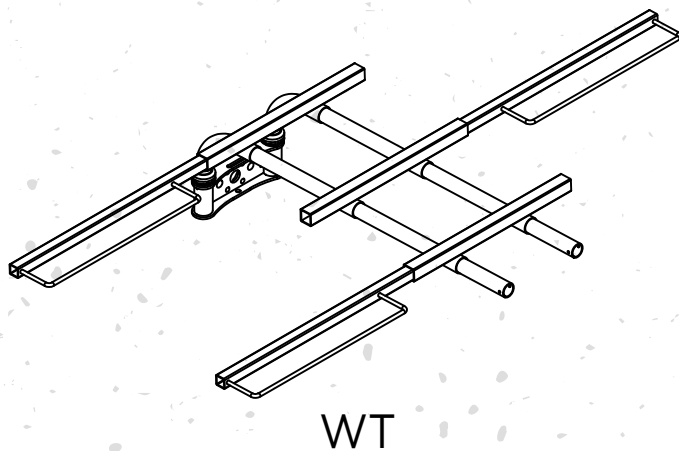
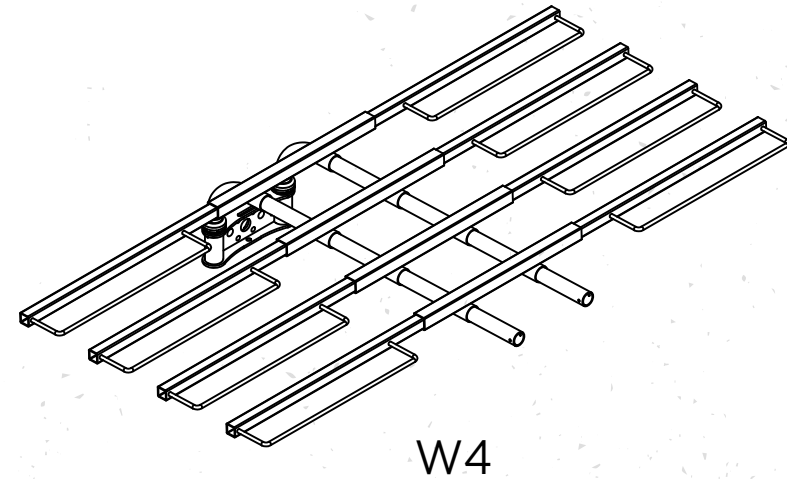
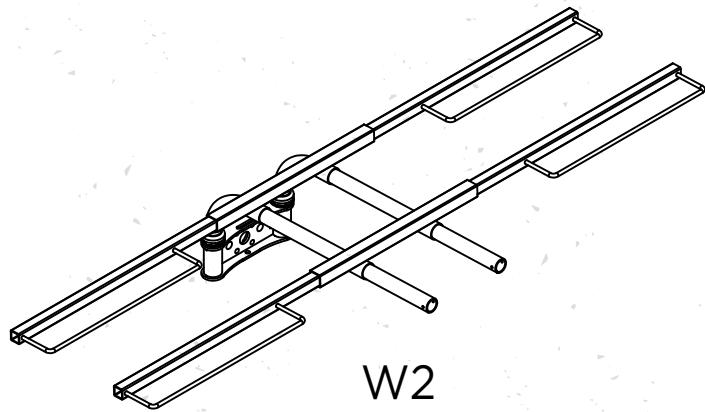

YOU WILL NEED

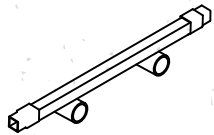

Chassis

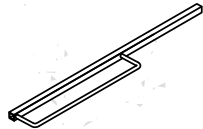

D-Loops



Thumbscrew

W2 x4
W4 x8
WT x6
WT+ x8



M6x16 Bolt

W2 x8
W4 x16
WT x12
WT+ x16

STEP 1

Slide a **Chassis** onto the **Main Poles** and tighten using 4 of the **M6x16 Bolts**

STEP 2

Slide the **D-Loops** into the **Chassis** and tighten with a **Thumbscrew**

The D-Loops may be adjusted to suit the wheelbase of your bike.

STEP 3

Repeat steps 1-2 for the remaining **Chassis** and **D-Loops**

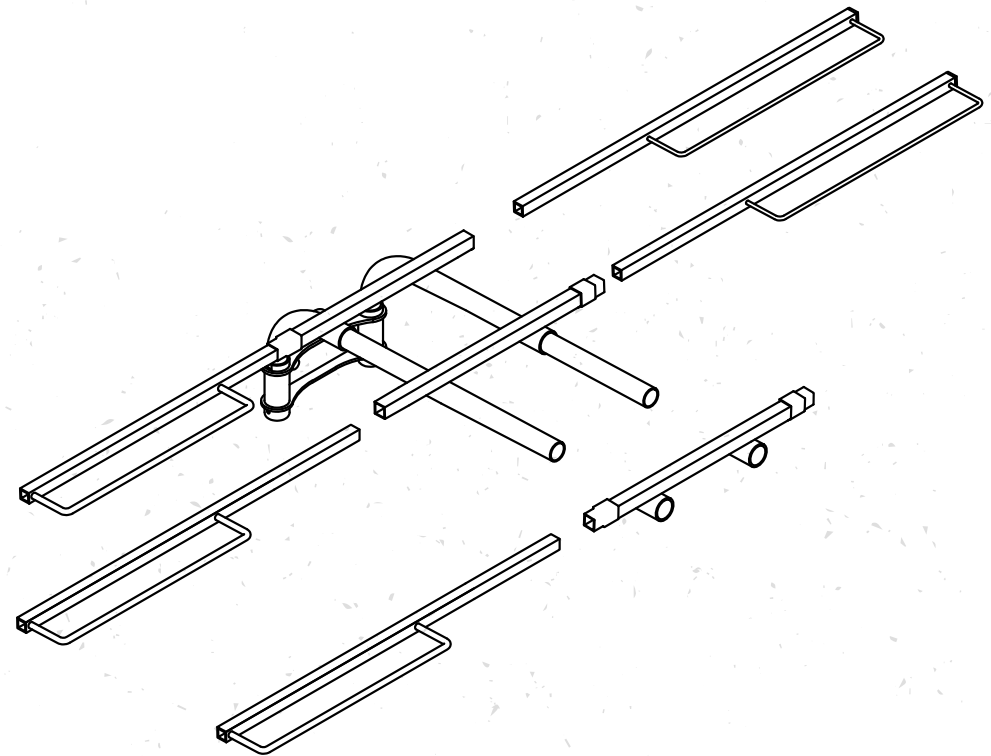

FITTING THE VERTICAL SUPPORTS

Vertical Supports are only used on the W2, W4 and WT+ racks, please skip this section if you have a WT rack

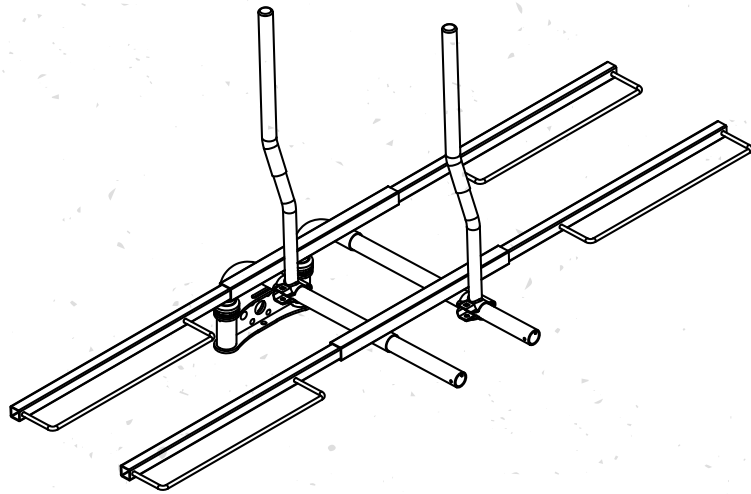

W2

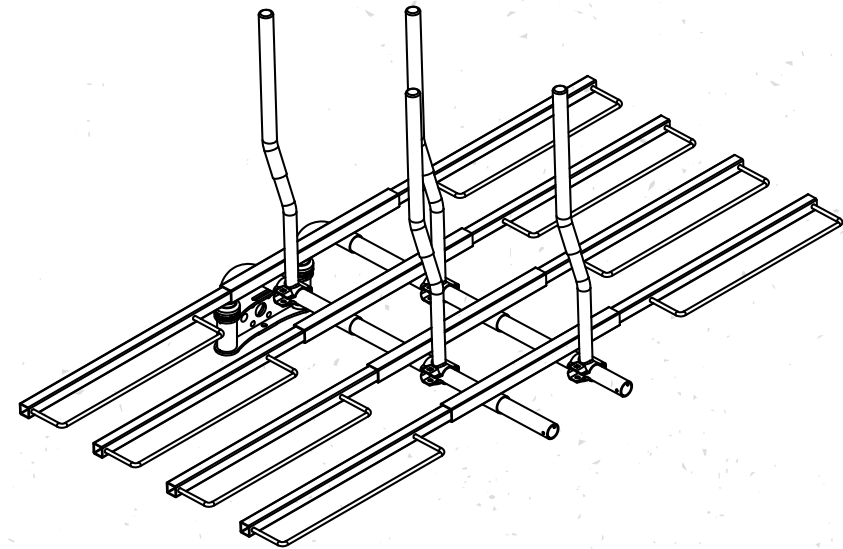

W4

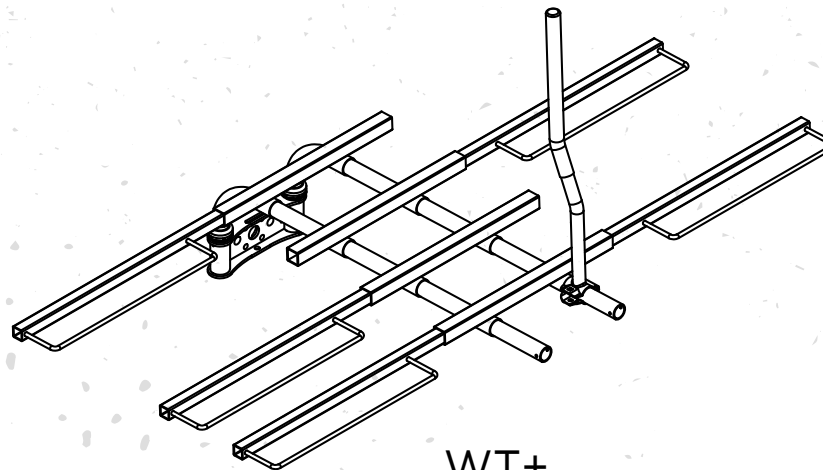

WT+

YOU WILL NEED



W2 x2
W4 x4
WT+ x1

Under Clamp



W2 x2
W4 x4
WT+ x1

Vertical Support

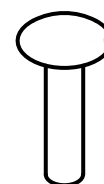

W2 x2
W4 x4
WT+ x1

M8x40 Cup SQ



W2 x4
W4 x8
WT+ x2

M6x16 Bolt



W2 x2
W4 x4
WT+ x1

M8 Nut



W2 x4
W4 x8
WT+ x2

M6 Nut



W2 x2
W4 x4
WT+ x1

M8 Washer



W2 x4
W4 x8
WT+ x2

M6 Washer

The following assembly instructions are to be used in conjunction with the full rack assembly drawings on page 16

STEP 1

Assemble the **Under Clamp** and **Vertical Support** on to a **Main Pole** using two **M6X16 Bolts**

STEP 2

Use an **M8X40 Cup SQ Bolt** with an **M8 Washer** and **M8 Nut** to tighten the clamp assembly around the **Pole**. Tighten firmly but allow enough slack that the vertical may be moved by hand to adjust.

STEP 3

Repeat steps 1-2 for the remaining **Vertical Supports**

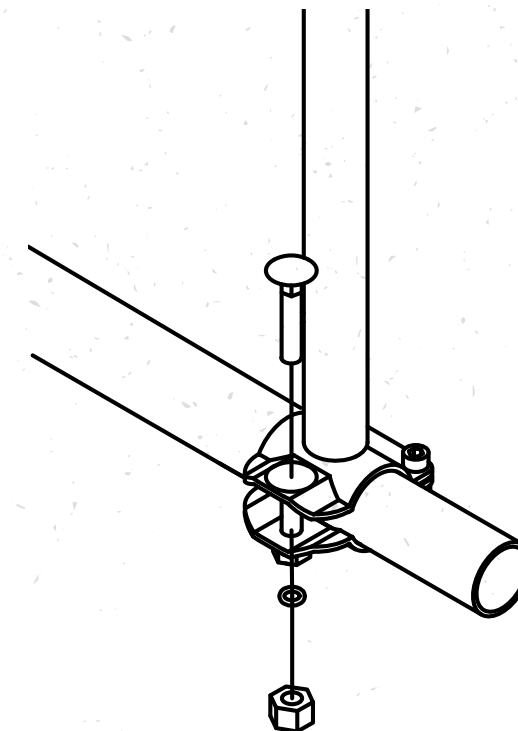
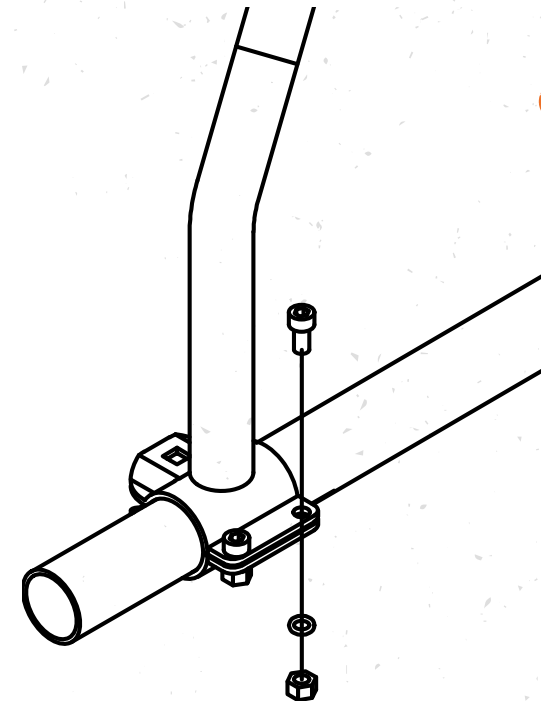

FITTING GUIDE

SECURING LED LIGHT UNIT

YOU WILL NEED

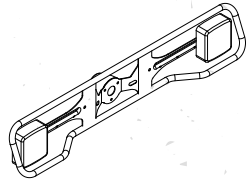

LED Light Unit

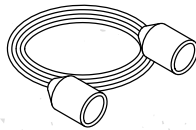

Cable

STEP 1

Slide the **LED Light Unit** frame on to the ends of the **Main Poles** and tighten the two bolts

STEP 2

Plug **cable** into the socket in the back of the **LED Light Unit** and run the cable down to the socket on the vehicle

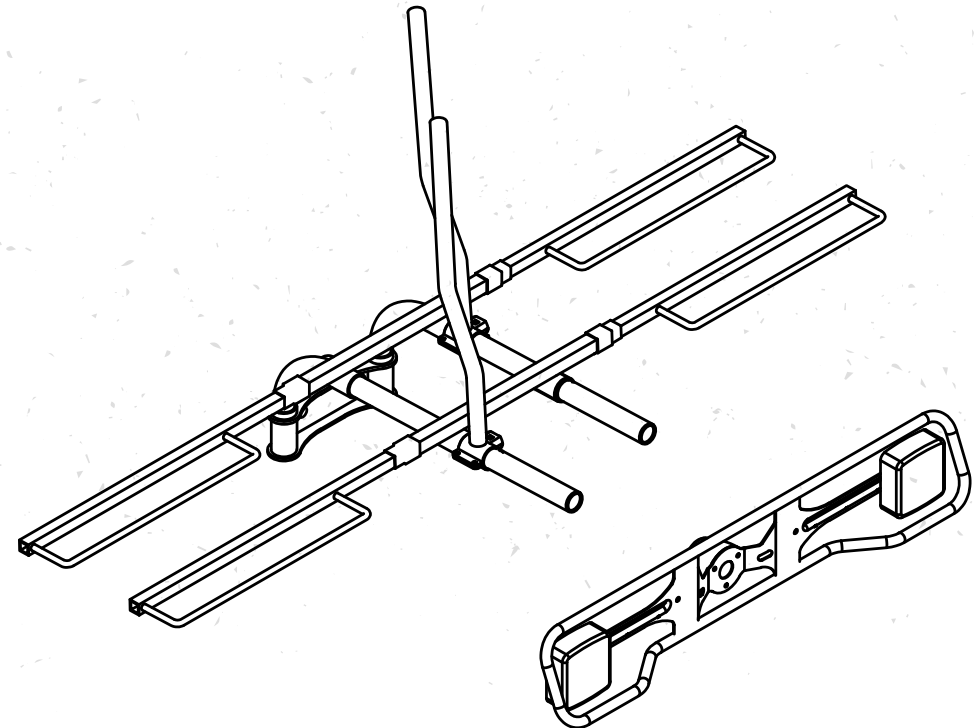

FITTING GUIDE

SECURING BIKES

YOU WILL NEED

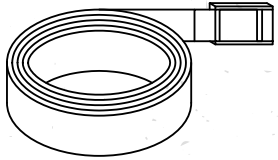

0.5m Strap

- W2 x6
- W4 x12
- WT x3
- WT+ x5

OPTIONAL EQUIPMENT

A strap back kit can be used to strap the rack back to the vehicle reduce movement

STEP 1

Fit the bikes in alternating directions to each other making sure that the handlebars and seatposts avoid each other.

The D-Loops may be slid to offset the bikes from each other.

STEP 2

Once fitted, secure the bikes with the **0.5m Straps**.

Strap each wheel to a D-Loop and strap the frame to the vertical support arm.

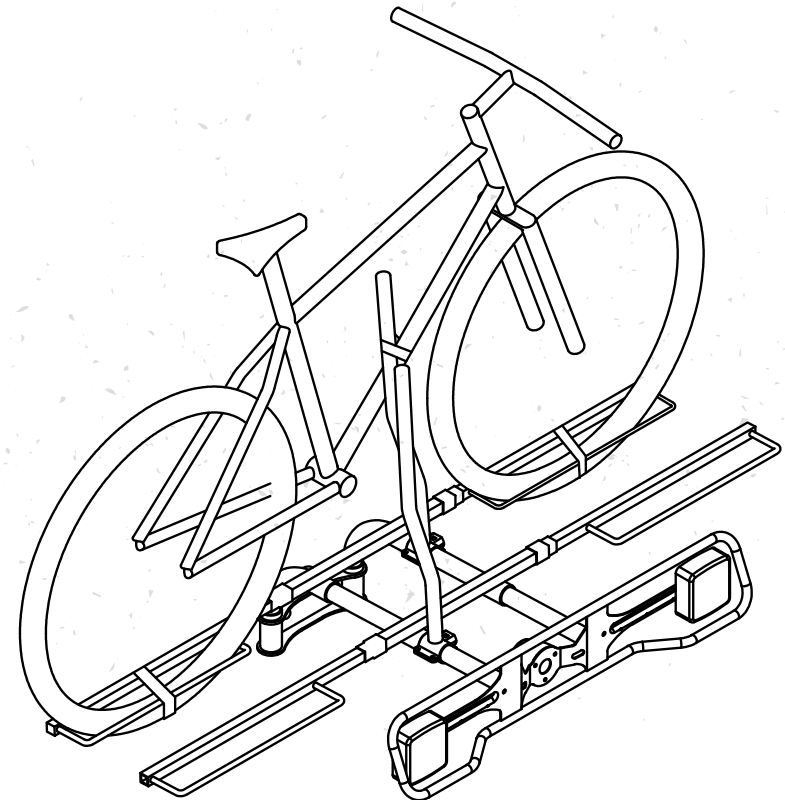

IMPORTANT INFORMATION



- Make sure that the rack is secured before travelling.
- Make sure all straps are tightened before travelling and check periodically.
- If any of the bike positions are not in use you must remove the d-loops for travel.
- Maximum load of rack 70Kg - ensure weight of rack and bikes does not exceed your tow bar nose weight.
- Lubricate the D Loops to prevent corrosion with a light coating of grease, clean and replace regularly.
- Keep these instructions in the car while travelling.
- It is illegal to have an unsafe rack.
- Drive carefully with the rack fitted. The load may affect your vehicles driving characteristics.
- If travelling outside the UK, check local regulations pertaining to bicycle carriers.
- Take care when negotiating rough surfaces, speed bumps and obstructions such as ferry ramps or narrow roads.
- Ensure LED Light Unit is functional prior to commencing journey

MAINTENANCE



We encourage regular maintenance and inspection of your rack to keep it in good condition. After use in wet conditions the rack should be dried before storage. We also recommend applying grease to sliding parts of the rack to prevent corrosion and seizing.

If you are in any doubts about the condition of parts that are worn or damaged they should be replaced. We stock a comprehensive range of spare parts that are available direct or via your local stockist.

LIABILITY

Pendle Bike Racks Ltd shall not be liable for any loss or damage, sustained or incurred, by the owner of a Pendle Bike Rack or any third party, or otherwise in relation to any incident directly or indirectly related to the use of a Pendle Bike Rack unless caused by the negligence of Pendle Bike Racks Ltd.

Pendle Bike Racks Ltd has taken every precaution to comply with the recommendations of Trading Standards directives, and have designed and manufactured our bike racks under the requirements of our ISO 9001:2000 approved Quality management system.



03330 155 575

help@pbr.co.uk

Pendle Industrial Estate

Southfield Street

Nelson

Lancashire

BB9 0LD