

FITTING GUIDE

ERGORACK

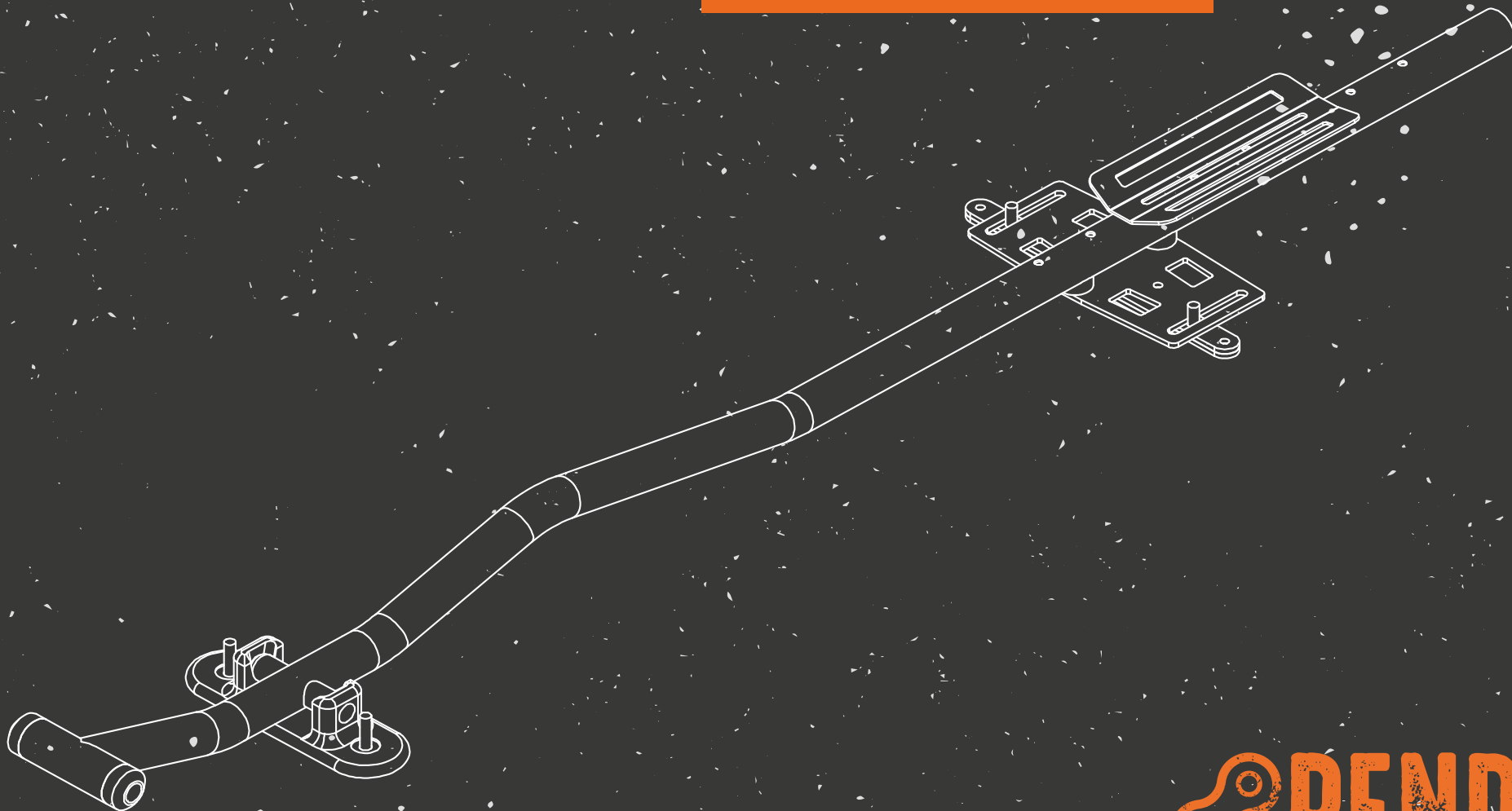

 **PENDLE**

CONTENTS

Box Contents

ErgoRack	03
Fixings and Tools	04

Fixing Guide

Setting up for the first time	05
Securing your bike to the ErgoRack	06
Fitting the ErgoRack to your vehicle	07

Information

Important Information	08
Maintenance	09
Liability.....	09

BOX CONTENTS - ERGORACK



Main Body

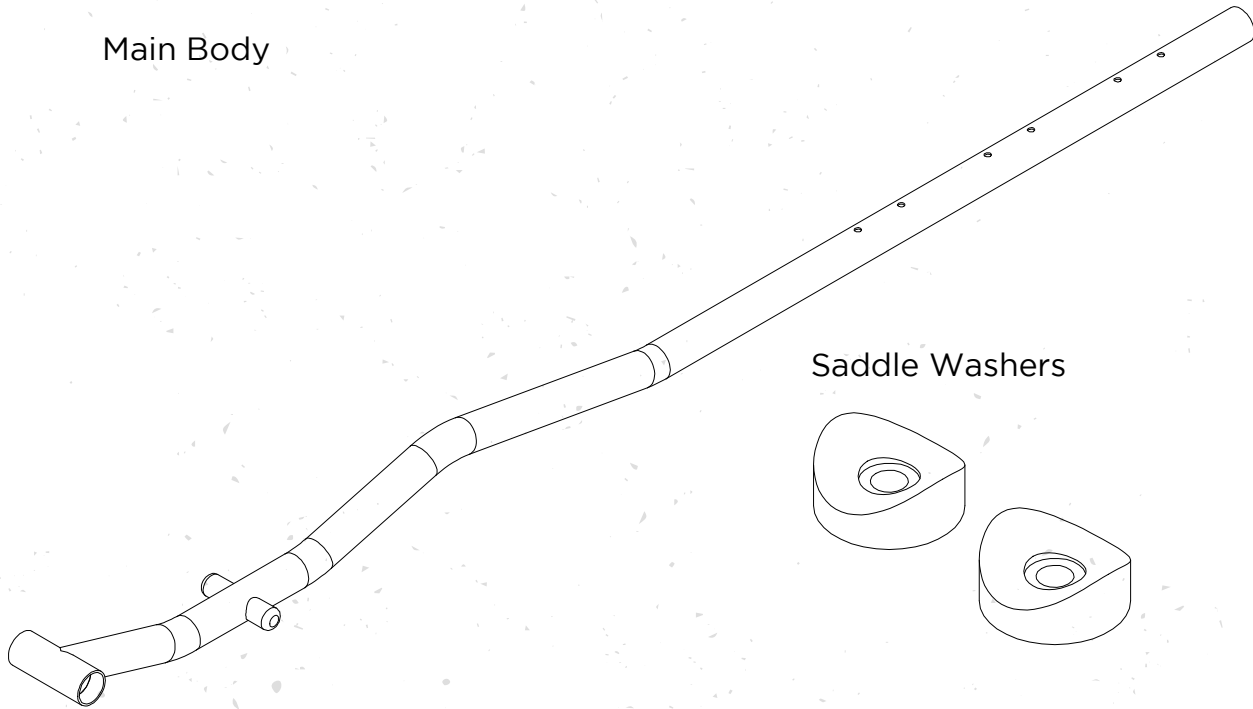

Rear Foot Plate

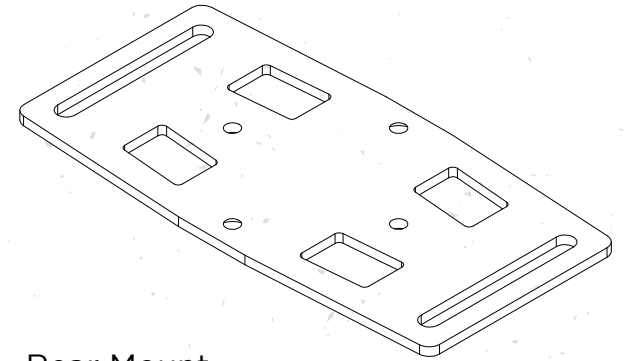

Saddle Washers

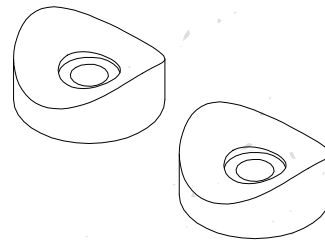

Rear Mount

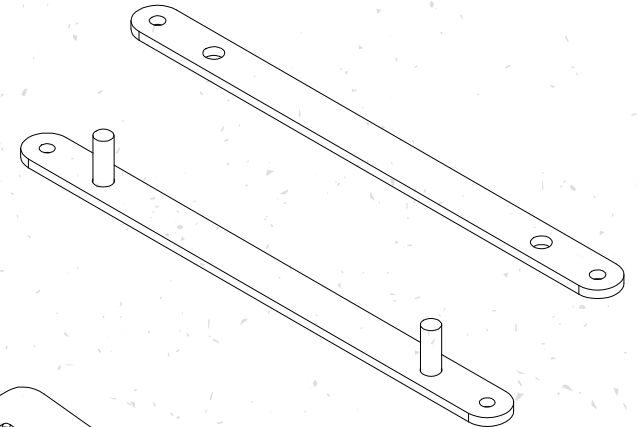

Front Mount

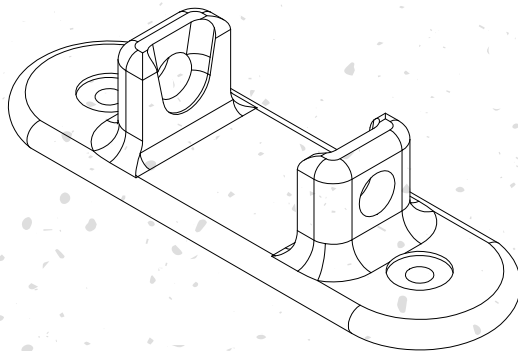

Axle Adaptors

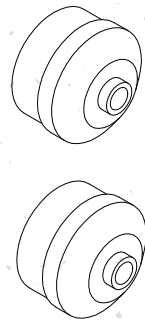

Wheel Tray

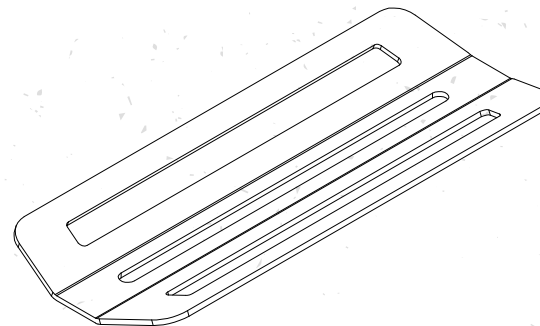

BOX CONTENTS - FIXINGS & TOOLS

Fixing Knob

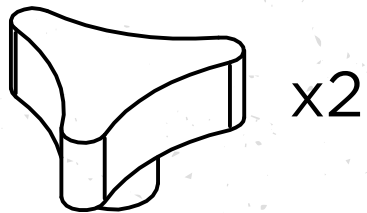

x2

M10X100 Bolt



x1

0.5m Strap

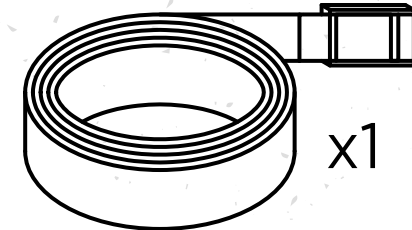

x1

M8 Nyloc Nut

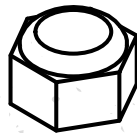

x2

M6 x16mm Countersunk Bolt



x2

M6X10 Socket Dome Screw



x15

M8 Washer



x2

M6 Washer



x4

Allen Key

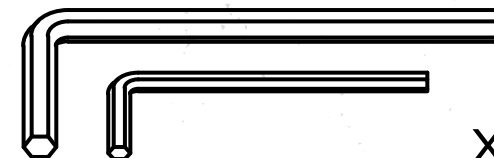

x2

FITTING GUIDE

SETTING UP FOR THE FIRST TIME

YOU WILL NEED

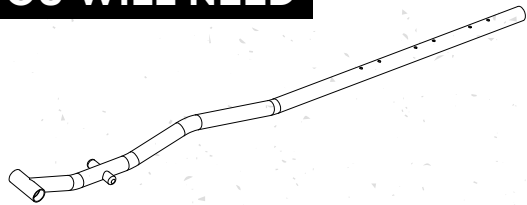

Main Body

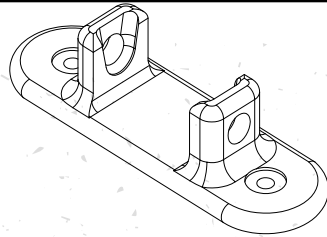

Front Mount

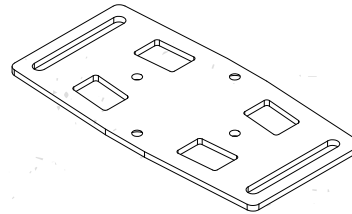

Rear Foot Plate

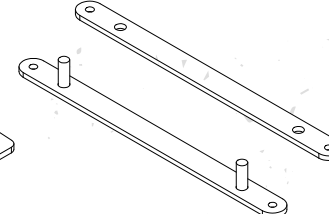

Rear Mount

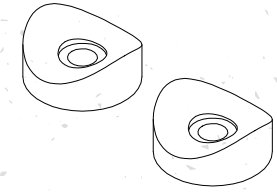

Saddle Washers

STEP 1

Slide the **Front Mount** into the T-Track of your front roof bar. Slide the **Rear Mount** into the T-Track of your rear roof bar (the studded plate slides into the track and the other plate sits on top before fixing with two **M6 x 10 Socket Dome Screws with M6 Washers**). Keep both mounts loose.

KEY POINT

This initial set-up stage **does not** involve your bike. The objective is to fix the **Front Mount** and **Rear Mount** in the correct positions on your roof bars.

STEP 2

Use the two **M6 x 16 Countersunk Bolts** and **Saddle Washers** to fix the **Rear Foot Plate** to the **Main Body** in a position that allows the **Foot Plate** to locate onto the **Rear Mount** studs when the **Main Body** is located into the **Front Mount**. (NB the **Rear Foot Plate** is bolted in the wrong orientation for shipping, it will need turning 90 degrees).

Position the **Front Mount** and **Rear Mount** in their respective T-Tracks so that the rack points straight. The rack can face either forwards or backwards to avoid handlebar clash.

Once complete, you don't need to adjust them again.

STEP 3

Remove the **Main Body** and tighten the **M8 Nyloc nuts** fixing the **Front Mount** and the two **M6 x 10 Socket Dome Screws** fixing the **Rear Mount**. These parts stay fixed to the roof bars under normal circumstances, so you don't need to set them up each time you use the rack.

Fix the **M10 Bolt** and two **Fixing Knobs** into place for safe-keeping. Trim rubber track fillers if preferred and replace around the mounts to reduce wind noise when travelling.

FITTING GUIDE

SECURING YOUR BIKE TO THE ERGORACK

YOU WILL NEED

Main Body

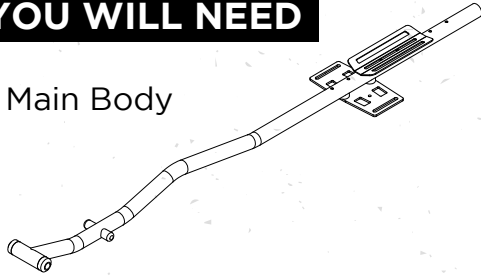

0.5m Strap

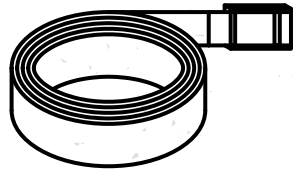

Axle Adaptors

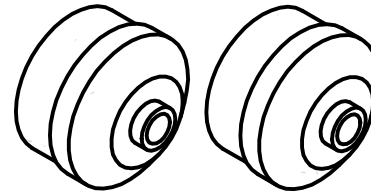

STEP 1

Remove the front wheel from your bike. This must be transported inside the vehicle. Retain your front axle - this will be needed.

Place the ErgoRack on a surface at a comfortable height with the kink up. You **do not need** to load your rack while fixed to your vehicle.

Screw the **Axle Adaptors** into the front of the **Main Body**.

STEP 2

Use two **M6 x 10 Socket Dome Screws with M6 Washers** to fix the **Wheel Tray** on top of the **Main Body** in a position to suit your bike. The **0.5m Strap** can be fixed between the **Wheel Tray** and the **Main Body** to hold it in place.

Fix an **M6 x 10 Socket Dome Screw** in all unused holes.

STEP 3

Bring the front fork of your bike towards the **Axle Adaptors** and fix in position using your bike's front axle. Different adaptors are available.

Finally secure the back wheel tightly down to the **Wheel Tray** with the **0.5m Strap**. Your bike is now secured to the ErgoRack.

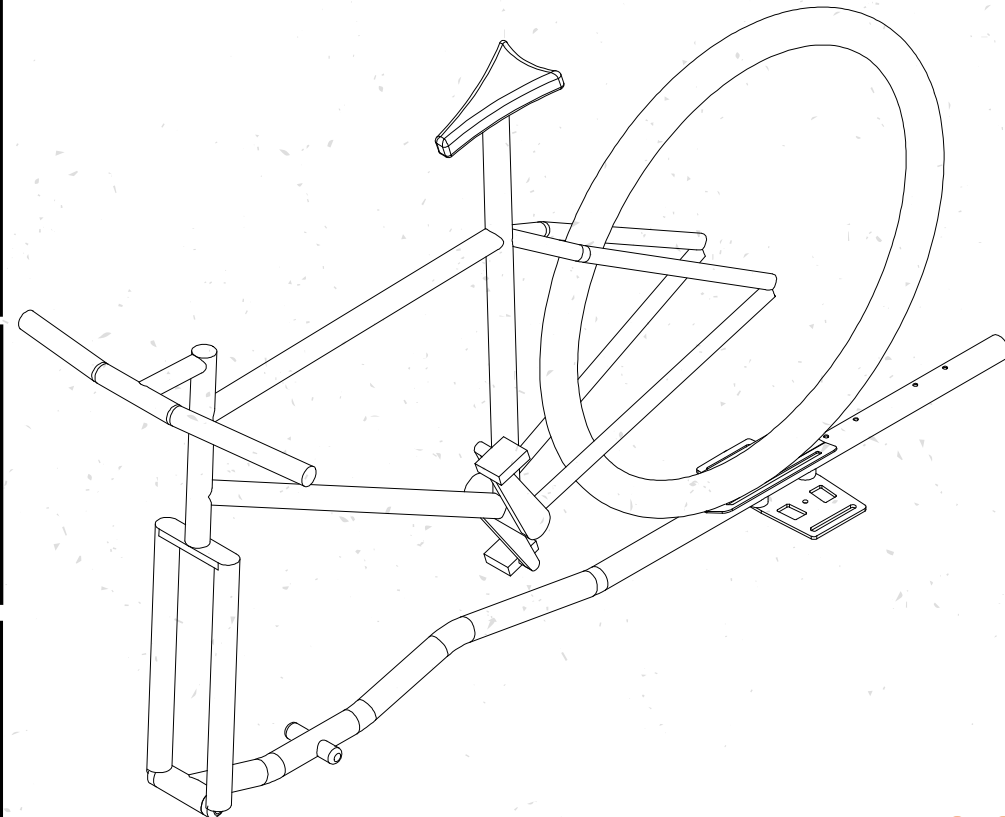

FITTING GUIDE

FITTING THE ERGORACK TO YOUR VEHICLE

YOU WILL NEED

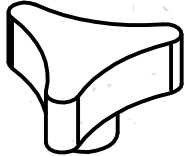

Fixing Knobs



M10 x 100 Bolt

STEP 1

Remove the **M10 Bolt** from the **Front Mount** and remove the **Plastic Knobs** from the **Rear Mount**.

STEP 2

Carefully lift your loaded Ergorack up to the roof of your vehicle. First drop the two fixing lugs of the **Main Body** into the **Front Mount** and screw in the **M10 x 100 Bolt** (not tight for now).

Hold the rear of the rack slightly above the Rear Mount to avoid knocking the threaded studs during this step.

STEP 3

Lower the **Main Body** carefully down onto the **Rear Mount** so that the **Rear Foot Plate** engages with the threaded studs.

Tighten the **Fixing Knobs** onto the studs. Tighten the **M10 Bolt**.

STEP 4

Check everything is secure and off you go. Have a great trip!

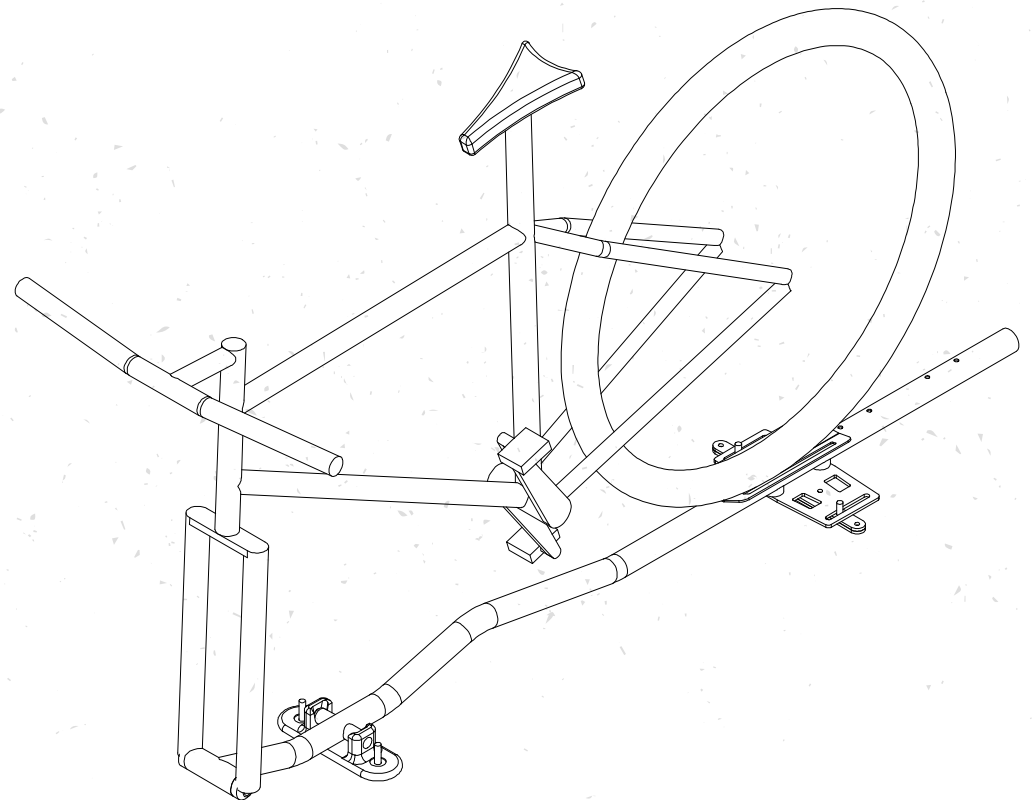

IMPORTANT INFORMATION



- If you wish to keep your ErgoRack on your vehicle permanently, take care when loading your bike to avoid vehicle damage.
- Do not overload your bike rack. This is unsafe practice and can result in increased wear on parts.
Recommended Maximum load = 23Kg total
- Do not use damaged or heavily worn straps. Check straps regularly to ensure that they do not show signs of wear - any worn straps should be replaced immediately.
- Tighten straps at regular intervals on long journeys, particularly if the road surface is uneven for any period of time.
- Remain mindful that you have a bike on your roof. Be careful entering car parks, garages etc.
- It should be noted that your vehicle handling, braking and fuel efficiency characteristics might be affected when carrying cycles.
- Lifting 25+ Kg on top of a vehicle can be difficult for some users. Do not attempt to load on your own unless you are confident of doing so safely to avoid injury or damage. Loading is carried out at your own risk.
- Take special care when negotiating extreme road surfaces, road humps and ferry ramps.
- Ensure all nuts/bolts/knobs are tight before each journey.

STORAGE SOLUTION, MULTI-CAR USE & TANDEM

- Order a spare **Front Mount** and fix to the wall in your home. The loaded ErgoRack can then double up as a vertical bike storage solution.
- Order a spare **Front Mount** and **Rear Mount** and transfer your loaded ErgoRack between two vehicles.
- Our **Tandem Adaptor** extends the ErgoRack for use with Tandem Bicycles. Load the rack facing the rear to clear tailgates.

MAINTENANCE



We encourage regular maintenance and inspection of your rack to keep it in good condition. After use in wet conditions the rack should be dried before storage. We also recommend applying grease to sliding parts of the rack to prevent corrosion and seizing.

If you are in any doubts about the condition of parts that are worn or damaged they should be replaced. We stock a comprehensive range of spare parts that are available direct or via your local stockist.

LIABILITY

Pendle Bike Racks Ltd shall not be liable for any loss or damage, sustained or incurred, by the owner of a Pendle Bike Rack or any third party, or otherwise in relation to any incident directly or indirectly related to the use of a Pendle Bike Rack unless caused by the negligence of Pendle Bike Racks Ltd.

Pendle Bike Racks Ltd has taken every precaution to comply with the recommendations of Trading Standards directives, and have designed and manufactured our bike racks under the requirements of a ISO 9001:2015 approved Quality management system.



03330 155 575

help@pbr.co.uk

Pendle Industrial Estate

Southfield Street

Nelson

Lancashire

BB9 0LD