

4 HUB TENT



6 HUB TENT

FREE SPIRIT
RECREATION

**FOUNDATION SERIES
HUB TENTS
4 SIDED AND 6 SIDED
INSTRUCTION MANUAL**

DEAR FREESPIRIT FAMILY,

As a family owned and operated business, it is our hope that as you get out there and use the Freespirit products, you feel like a part of our extended family and feel like we are all out there exploring this great planet *together*.

**Our goal at Freespirit Recreation has always been to re-invent the roof top tent from the ground up. We continue to do that, but we are now expanding to re-invent the pop-up, dome, ground tent from well...
the ground up too!**

**We work hard to create the best designs using the best products that allow for a fast and easy set-up.
We want you spending more time *exploring and enjoying life*.**

You have asked us to be innovative, to provide the best quality, to provide great customer service, and to keep creating products that *Elevate Your Adventure* so stay in touch with us!

Follow us on social media and on our website, www.gofsr.com.

**Have questions for us?
Reach out, we are here to help!
sales@gofsr.com**

**Oh, and because we have to put this in here...
PLEASE REVIEW THIS INSTRUCTION MANUAL BEFORE USING
YOUR NEW TENT.**

**From our family to you, *THANK YOU* for your purchase.
We hope that it really will *Elevate Your Adventure!***

**Renee Tewes, President
Tanner Tewes, E-Commerce and Marketing
Kristine Sewell, Dealer and OEM Sales
Ben Tewes, Business and Product Development**

TABLE OF CONTENTS:

PRODUCT OVERVIEW (PAGE 4)

PRODUCT SPECIFICATIONS (PAGE 5)

INCLUDED IN THE BAG (PAGE 6)

SETTING UP/TEARING DOWN YOUR HUB TENT (PAGE 7)

CARE INSTRUCTIONS AND IMPORTANT INFORMATION (PAGE 8)

PRODUCT OVERVIEW:

foun-da-tion (noun): a body or ground upon which something is built up or overlaid

and : an underlying base or support

The Foundation Series HUB Tents brings Freespirit Recreation into the world of ground tents. We developed and enhanced the HUB tents to be a ground tent, an ice fishing tent, a separate living area when out with your rooftop tent, or a separate sleeping area for friends or kids when they join you and you are sleeping in your rooftop tent.

The Foundation Series HUB Tents are available in two sizes. The 4 HUB is a four-sided tent that can sleep at least 2+ adults. The 6 HUB is a six-sided tent that can sleep at least 6+ adults.

PRODUCT SPECIFICATIONS:

4 HUB TENT

Floor Size	96"x96"
Interior Middle Height	80.7"
Interior Side Wall Height	71"
Weight	Roughly 33 lbs
Sleeping Capacity	2+ (2-4 persons)
Frame	Diameter 11mm Solid Fiberglass Poles, HUB Mechanism
Tent Fabric	210D Ripstop-Oxford, Clear PU Coating 1000mm, Water Resistance (WR), Fire Resistance (CPA)
Rainfly Material	150D Ripstop-Oxford, Clear PU Coating 1000mm, Water Resistance (WR), Fire Resistance (CPA)
Floor Material	600D Ripstop-Oxford, Clear PU Coating 1000mm, Water Resistance (WR), Fire Resistance (CPA)

6 HUB TENT

Floor Size Width	165.4"
Interior Middle Height	82.7"
Interior Side Wall Height	71.7"
Weight	Roughly 35 lbs
Sleeping Capacity	6+ (6+ persons)
Frame	Diameter 11mm Solid Fiberglass Poles, HUB Mechanism
Tent Fabric	210D Ripstop-Oxford, Clear PU Coating 1000mm, Water Resistance (WR), Fire Resistance (CPA)
Rainfly Material	150D Ripstop-Oxford, Clear PU Coating 1000mm, Water Resistance (WR), Fire Resistance (CPA)
Floor Material	600D Ripstop-Oxford, Clear PU Coating 1000mm, Water Resistance (WR), Fire Resistance (CPA)

Included in the Bag:

4 HUB TENT

Item:	Quantity:
Dome Tent 2+ Model	1
Ice Peg Stakes	4
Rope	4
Carrying Bag	1
LED Light Strips	2

Rain Fly/Floor for 4 HUB TENT

Item:	Quantity:
Rain Fly for Dome Tent 2+	1
Standard Stakes	4
Rope	4
Floor	1
Floor Carrying Bag	1
Rain Fly Carrying Bag	1

Ice Peg Stakes

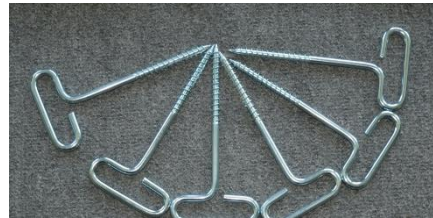

6 HUB TENT

Item:	Quantity:
Dome Tent 6+ Model	1
Ice Peg Stakes	4
Rope	6
Carrying Bag	1
LED Light Strips	3

Standard Stakes



Rain Fly/Floor for 6 HUB TENT

Item:	Quantity:
Rain Fly for Dome Tent 6+	1
Standard Stakes	6
Rope	6
Floor	1
Floor Carrying Bag	1
Rain Fly Carrying Bag	1

SETTING UP AND TEARNING DOWN FOUNDATION SERIES

4 HUB AND 6 HUB TENTS:

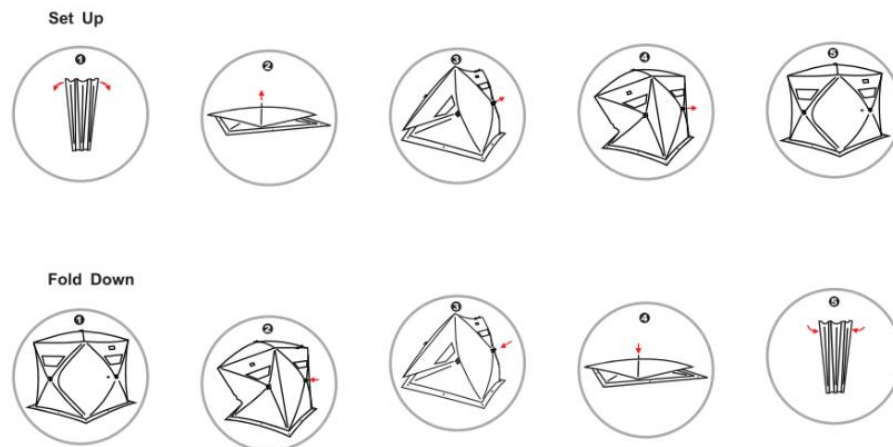

STEPS:

- 1. Remove all components from bags.**
- 2. Place tent in vertical position with bottom feet facing up.**
- 3. Drop each leg down so the tent is fully expanded flat on the ground.**
- 4. Pull loops on each side until the tent pops out.**
- 5. Continue all of the 4 or 6 sides [depending on model]. Go inside and push up on the middle roof of the tent to pop up the roof.**
- 6. Attach floor, it is optional depending on use.**
- 7. Line up the rain fly over the top of the dome tent, it is optional use depending on weather. Line up the corners and the rain fly should be over each dome tent window.**
- 8. Secure ropes for tent rain fly and tent floor with stakes provided. Stake into the ground.**
- 9. Turn on LED light strip as needed.**
- 10. Foundation Series HUB Tent set-up is now complete.**
- 11. To tear down the HUB tent, reverse the steps and store in provided carrying bags.**

CARE INSTRUCTIONS:

Do not wash. Wipe with a damp cloth and let air dry.

IMPORTANT INFORMATION:

1. Keep all flame and heat sources away from the tent fabric. This HUB tent meets the flammability requirements of CPAI-84. This tent is made of flame-resistant fabric. It is not fireproof. The fabric will burn if left in continuous contact with a flame source. The application of any foreign substance to the tent fabric may render the flame-resistant properties ineffective.

2. The HUB tent is in the most secure position when the corners and ropes are properly staked down. Exercise caution when moving tent parts. Adult supervision is required. Do not leave assembled for prolonged periods of time or in extreme weather. Keep all body parts clear of pole joints when in operation.