

**Characteristics:**

Safety lock buckle, easy installation.

**Technical index:**

Mounting type: Free hanging (In-Line)

Material of core: Laminated Silicon Steel

Applicable standards: GB20840-2014

Operating temperature:  $-25^{\circ}\text{C} \sim +70^{\circ}\text{C}$

Storage temperature:  $-40^{\circ}\text{C} \sim +85^{\circ}\text{C}$

Frequency range: 50Hz-60Hz

Dielectric strength: 3.5KV 50Hz 1min(enclosure/output)

Product picture printing is for reference only, subject to the actual product



Electrical parameters: The following parameters are typical values. The actual values shall be subject to the actual measurement of the product

Rated input	200	300	400	500	600	A	Specification of cable: 0.3mm <sup>2</sup> black and white twisted pair Length of cable: 100cm~105cm 
Rated output	100	100	100	100	100	mA	
Turns ratio	1 : 2000	1 : 3000	1 : 4000	1 : 5000	1 : 6000	-	
Sampling resistance	10	10	20	20	20	$\Omega$	
Accuracy	1					%	
Weight	245					g	
TVS Transient voltage suppressor(7.5V) current output type. The secondary is not allowed to open.							

**Dimensions (in mm  $\pm 0.5$ ) :**

Opening and closing mode: plug-type

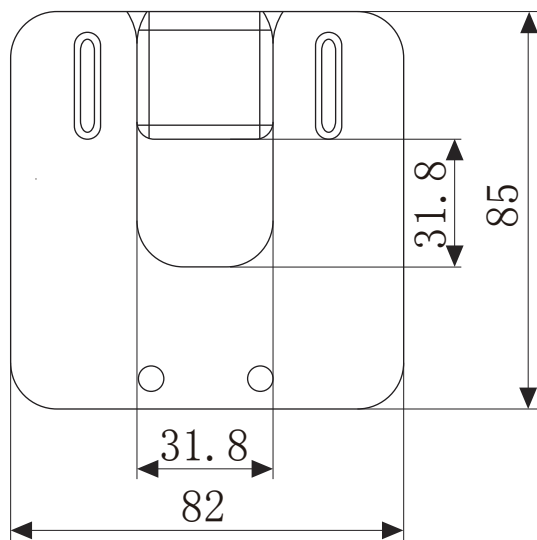

Front view

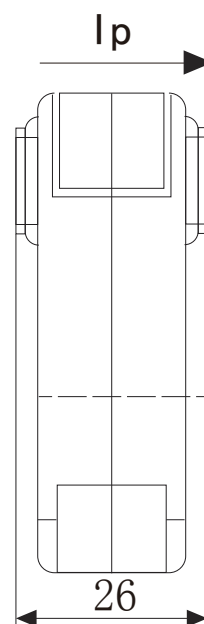

Side view