

# SCT019S (mA output type)



## Characteristics:

Safety lock buckle, easy installation.

## Technical index:

Mounting type: Free hanging (In-Line)

Material of core: Laminated Silicon Steel

Applicable standards: GB20840-2014

Operating temperature:  $-25^{\circ}\text{C} \sim +70^{\circ}\text{C}$

Storage temperature:  $-40^{\circ}\text{C} \sim +85^{\circ}\text{C}$

Frequency range: 50Hz-60Hz

Dielectric strength: 3.5KV 50Hz 1min(enclosure/output)

Product picture printing is for reference only,  
subject to the actual product

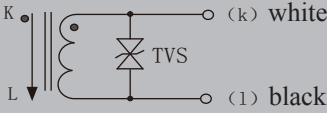

Electrical parameters: The following parameters are typical values. The actual values shall be subject to the actual measurement of the product

Rated input	100	200	300	A	Specifications of cable: 0.5mm <sup>2</sup> black and white twisted pair The length of cable: 200cm~205cm 
Rated output	33	33	33	mA	
Turns ratio	1:3000	1:6000	1:9000	-	
Sampling resistance	10	20	20	$\Omega$	
Accuracy	1			%	
Weight	107			g	

TVS Transient voltage suppressor(7.5V)  
current output type.  
Secondary is not allowed to open circuit

## Dimensions (in mm $\pm 0.5$ ):

Opening and closing mode: plug-type

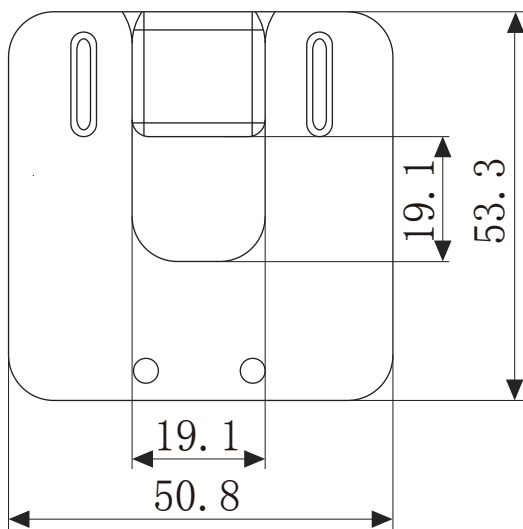

Front view

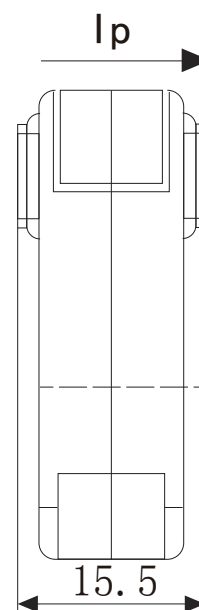

Side view