

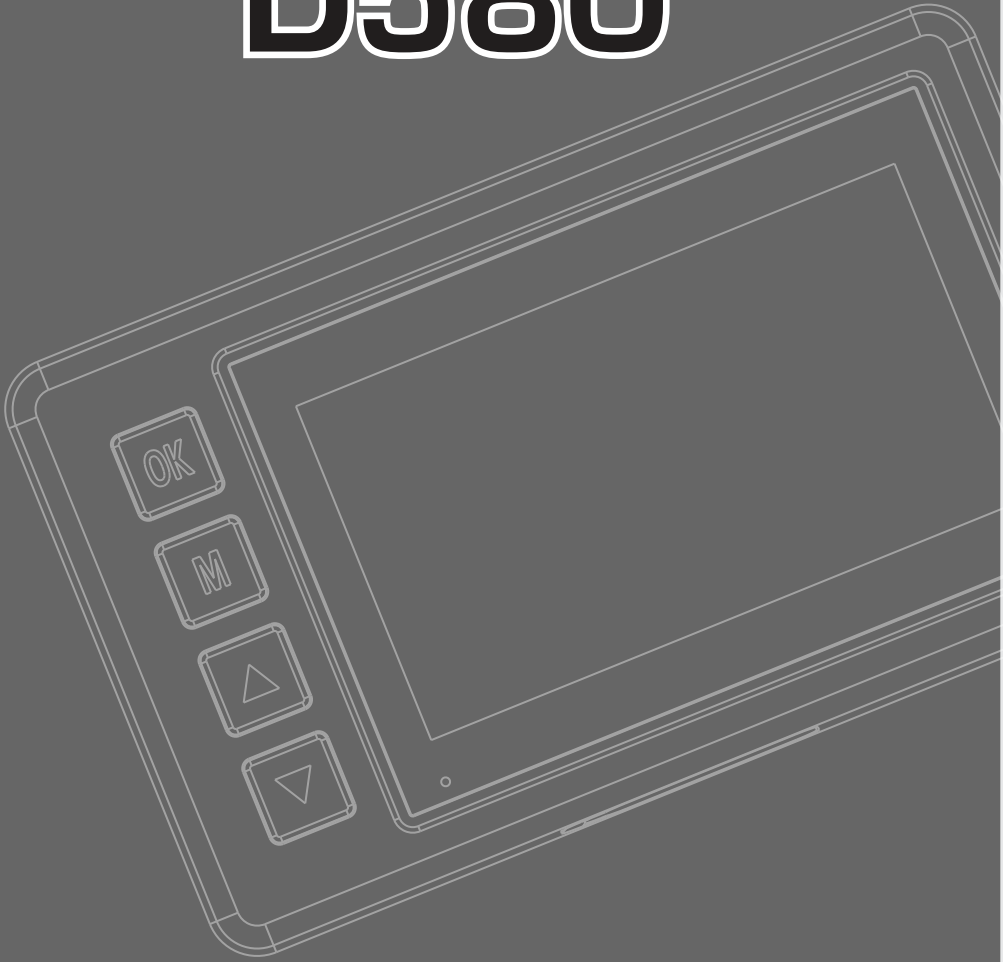

DIAMOND
AUDIO

D580



Owners Manual



Thank you for purchasing a Diamond Audio product for your vehicle audio system. You have chosen Diamond Audio because you deserve the best!

Diamond Audio products are designed and engineered to the highest quality standards in the industry to create the ultimate listening experience. For optimal performance of this product, it is highly recommended that you have it installed by an authorized Diamond Audio dealer.

Our authorized dealers have the necessary experience and installation equipment to ensure that your Motors Sport DVR will deliver maximum performance and explain all the details pertaining to our warranty coverage as well.

If you decide to install the product by yourself, please thoroughly read through this manual before getting it installed. This manual will help familiarize yourself with this Motors Sport DVR and guide you through the installation process and procedures.

Please contact your local authorized Diamond Audio dealer if you have any questions regarding the instructions in this manual or the product's operational capabilities. If you require additional assistance, please contact the Diamond Audio Technical Support Department during business hours (PST) at 213-212-3187.

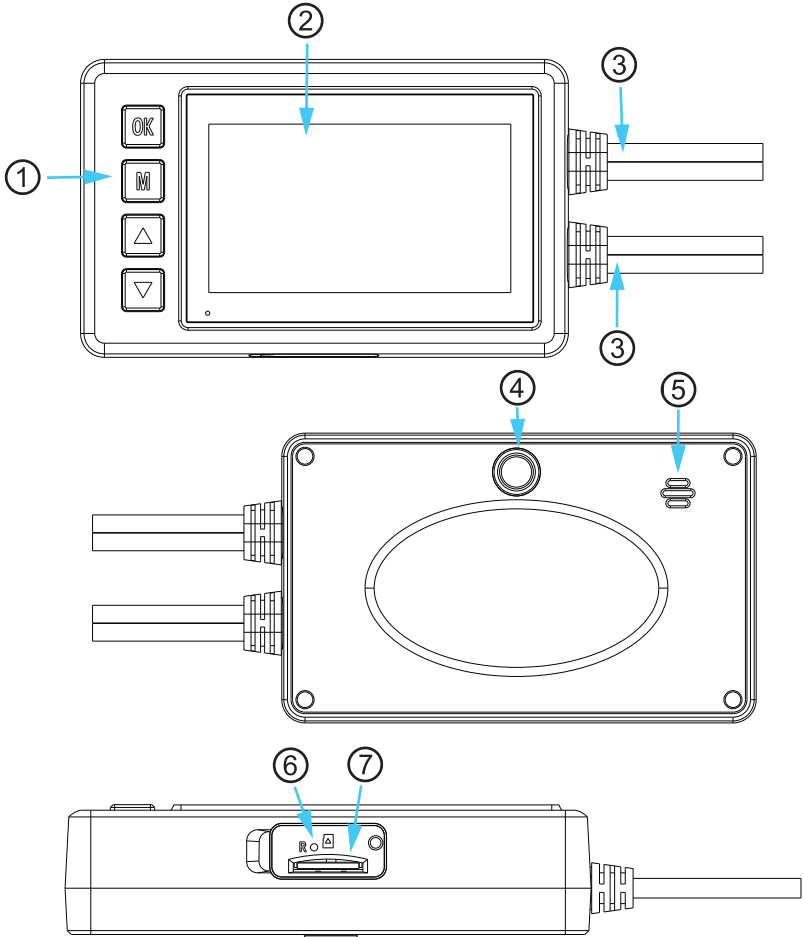

- ① Control Panel
- ② Display
- ③ Connection Ports
- ④ Mounting Hole
- ⑤ Speaker
- ⑥ Reset Button
- ⑦ Micro SD Card Slot

INSTALLATION

Please install according to the specific motorcycle environment and connect the power cable. The installation diagram is show as below:



- A. Main Unit
- B. Front and Rear Cameras
- C. Power Harness
(Red: Switch Power,
Yellow: Battery +,
Black: Ground or Battery)
- D. Remote Control Panel
- E. GPS Antenna









Selection of Memory Card

1. Memory card (micro SD card or micro SDHC card) not included. Please use the high-speed Micro SD card (over U1), with a capacity of 8GB to 128GB.
2. Insert memory card into card slot and press in with finger til it clicks in.
3. To remove the memory card, press in the card and let it slide out, remove with fingers gently.
4. Micro SD Card must be formatted before use.

Turn on/off





1. Short press  button for 1 second to turn on system.
2. Long press  button for 3 seconds to turn off system.

Video mode

- During recording, press the  button on the remote control to lock the current recording file. Press the  button again to unlock the locked video in the current recording. Press  to take a photo. Press  button to start recording, and the upper left side of LCD would show a recording mark  and the red mark would flashes during recording. Press  button again to stop recording, and the recording mark would disappear accordingly.

Note: During recording, the red light of cable control would flash.

Press  down button, to turn display off while recording. Press it again to turn the screen back on.

- Press  up key to turn off voice recording function. When the voice recording is off, there will be no audio recorded in the video. Press the  up button again to turn voice recording back on.
- Long press  up key for 3 seconds to switch the display picture of front and rear cameras.
- Long press  down key for 3 seconds to turn on the WIFI, press it again for 3 seconds to turn off the WIFI.



Viewing mode

Press the  button for 3 seconds to enter viewing mode. Press  or  to choose the "picture" or "video" press  key to view.

Press menu key  to return to the menu.

Then press menu key  to return to the camera screen.

System Setting

Note : Due to the camera's default setting, of automatically recording when powered on, press  to stop recording. Then press  button to enter the menu.

Movie Mode

Video mode: 1920x1080 FHD 30fps

Film cutting time: 3 minutes, 5 minutes, 10 minutes.

Voice recording: on/off

Explanatory note: record the sound simultaneously when the video is recorded.

When the voice recording is closed, it can ensure the video shot is silent.

General Settings

Key tone: on/off

Auto off: Never, 1 minute and 5 minutes

When set to 1 minute or 5 minutes the system will shut down automatically after no motion for this duration of time.

Clock setting: Set the current date and time

Date Format: Set how you want the date to appear

Stamp: on/off

Note: the left bottom will display the set date and time when recording or taking a picture.

Flicker frequency: 50Hz and 60 Hz

LCD Power Save: off, 1 minute or 3 minutes

Explanatory note: after the camera is not operated for X minutes, the camera will turn off the LCD screen. Press any key to display LCD screen.

Power Save Mode: Black/Time

Note: when set to time display will show the date and time.

Protect Level: closed, high, middle and low.

Note: the vibration video is locked, the greater the grade, the higher the sensitivity.

Time Zone Select: select current time zone (GMT+/-)

System reset: confirm and cancel

Note: after the system is reset, the function of camera will return to default state.

Format SD card: confirm and cancel

Note: confirm to format SD card in the camera.

Language

1. Language setting, press the  menu button

Enter the system setting menu, Press  up key or  down key to enter "Language Selection", press  button to select the language. Press  to exit.

2. Time and time zone settings:

For first use, please first go to system menu and access to "clock setting" optio to set the current date and time or connect the GPS module to automatically synchronizes the time.

3. Other personalized settings can be done in the system menu.

Connecting to WIFI

Please use your mobile phone to connect the camera's WIFI

(1) Long press  down key for 3 seconds to turn on the WIFI;
Camera's WIFI name: DA-D580-XXXX ;
Password: 1234567890

(2) After connecting the camera's WIFI, users could set the camera's setting on APP--CAR_DVR

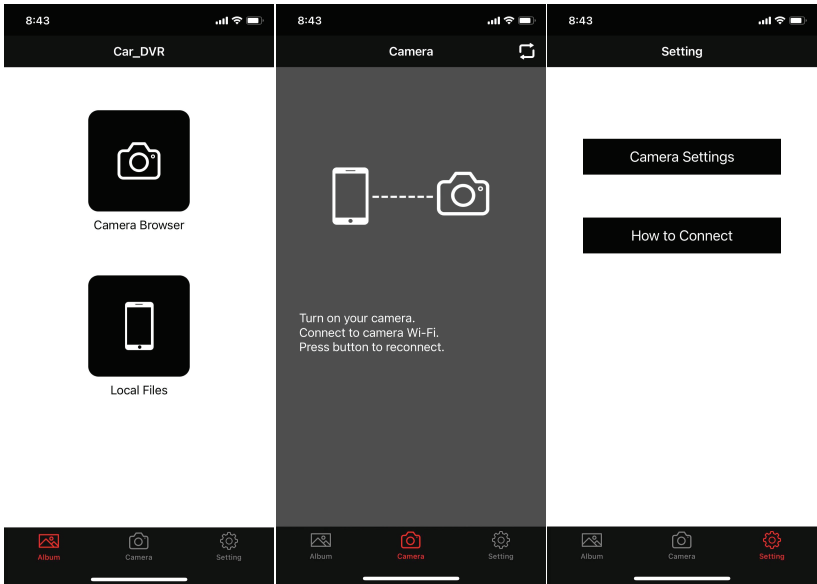

(3) Scan the below QR Code for download the APP:



Available on the **App Store**
iPhone ISO APP Download



Google play
Google Play Download

360 手机助手 HUAWEI
Android Phone Download
Huawei Phone Download

Google Drive
Android Phone Download
From Google Drive

 **2021 DashCam WiFi APP**
"Car_DVR" Download Link

GPS Location and Application

Plug the GPS, the display would show the red GPS mark  when the GPS locates successfully, the mark would turn to green  and the time would be synchronized automatically.

Video Player

1. Please download the player by below link:

Google :

<https://drive.google.com/open?id=1lgs5EHaCsY5kkyYMKSmogYC6J5HtqrdA>



MediaFire Share

http://www.mediafire.com/file/ca199784cl7xdsz/GVP_GPS_Player_English.msi/file



SPECIFICATIONS

Technical Specifications

LCD	2.7" (16:9) TFT LCD
Front cam	1080P-AHD
Language	English (Default) Spanish Russian Chinese
Video	1080P 30fps
Video Format	MOV
Mic/Speaker	Built-in
Light Source Frequency	50Hz/60Hz
GPS	External
Power Supply	5V 2A
Rearcam	1080P-AHD
Battery	Built-in Super capacitor.

Notes: the design and specification of the product are subject to the change without notice. If there is any inconsistency, in kind shall prevail.

NOTES

WARRANTY

Diamond Audio Technologies (DAT), a division of CV & DA Holdings Incorporated, warrants this product to be free from defects in material and workmanship for a period of one (1) year from the original date of purchase, provided it was purchased from an authorized DAT retailer within the United States. Product warranty period starts at the date of purchase or one year past the manufacture date whichever is first. However, upon purchase and completion of the on-line registration and installation by an authorized DAT dealer, warranty period will be extended to two (2) years. This warranty extension offer will only be recognized upon completion of the on-line registration of your product within thirty (30) days of the date of purchase.

THIS WARRANTY IS NOT TRANSFERABLE AND APPLIES ONLY TO THE ORIGINAL PURCHASER OF THIS PRODUCT IN ITS ORIGINAL INSTALLATION. Original purchaser must reside in the United States and be able to provide proof of purchase and installation with the sales receipt and completion of online registration from the authorized DAT retailer that sold and installed the product.

Should a manufacturing defect occur during above said warranty period, DAT will replace or repair the defective product with a product of the same or equivalent value and performance, at DAT's discretion.

Damage or failure caused by any of the following is not covered under this warranty policy: negligence, improper use, abuse, product modification, unauthorized repair attempts, accident, acts of God, misrepresentations by DAT retailers, and improper/inadequate packaging during return shipping.

Warranty is void if serial numbers have been removed, altered or defaced.

HOW TO OBTAIN WARRANTY SERVICE

In the event a DAT product should require service, you should visit the authorized DAT retailer you purchased the product from and they can expedite your claim. All claims must fall into the guidelines listed above and be accompanied by a copy of the original sales and installation receipt from that authorized DAT retailer.

Product returned for warranty service must be freight-prepaid, properly packaged and clearly marked with the Return Authorization (RA) number issued by DAT. Any product returned to DAT that is improperly packaged, does not have a RA number clearly marked on the package, or never received a RA number, may be refused upon delivery. DAT does not assume responsibility for lost or misdirected product.

Repair or replacement under this warranty is the exclusive remedy of the consumer. DAT shall not be liable for any incidental or consequential damages for breach of any expressed or implied warranty on this product. Some states do not allow the exclusion or limitation of incidental or consequential damages, or allow limitations on how long an implied warranty lasts, so the above limitations or exclusions may not apply to you. This warranty gives you specific legal rights and you may also have other rights that may vary from state to state.

Customers outside the United States should contact their local sales office to obtain information on pricing, exchange unit availability, instructions, service and warranty/non-warranty replacement or repair.

Diamond Audio Technologies

3761 S. Hill Street
LOS ANGELES, CA 90007
Tel: 213-261-4161
Fax: 213-947-4767
Web: diamondaudio.com

Service/Tech Support:

213-261-4161
Tech Support Email
helpdesk@dat-cvm.com



DIAMOND
AUDIO

3761 S. Hill Street
Los Angeles, CA 90007

©2021 Diamond Audio. All rights reserved.
(a division of CV & DA Holdings, Inc.)